

## **USER'S MANUAL**

**64in. ROOF RACK – 250 Lbs.**

**AT5565**

## DIAGRAM & PART LIST

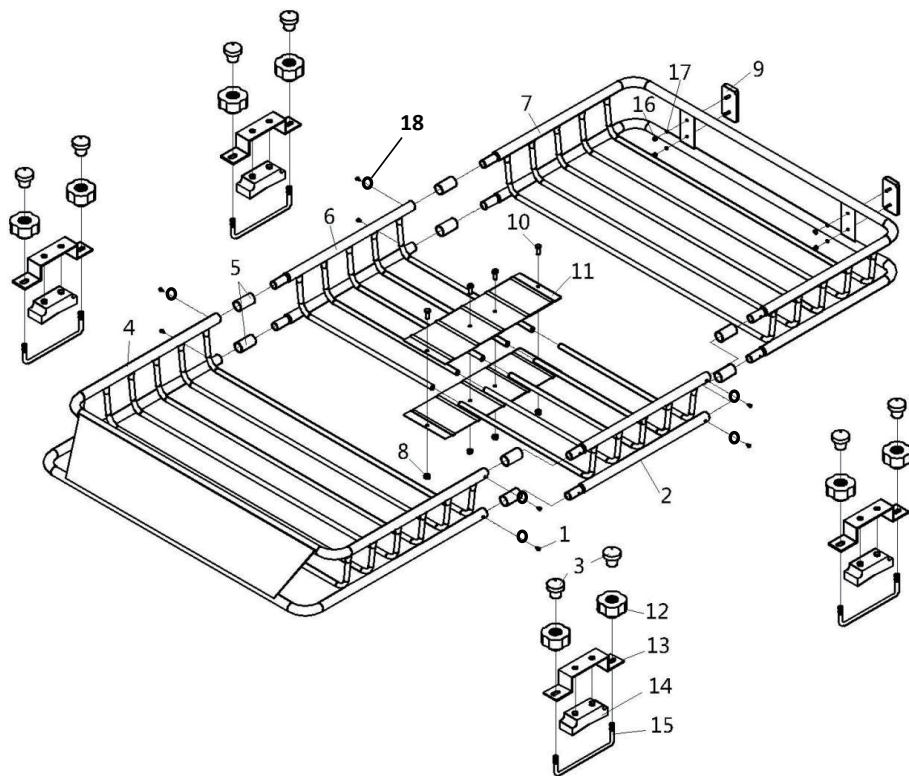

NO.	DECP.	QTY.	NO.	DECP.	QTY.
1	Screw	8	11	Middle Plate	2
2	Middle Section-Left	1	12	Knob	8
3	Knob Cap	8	13	Mounting Clip	4
4	Front Section	1	14	Mounting Block	4
5	Sleeve	8	15	U-Bolt	4
6	Middle Section -Right	1	16	M5 Nut	4
7	Rear Section	1	17	Spring Washer	4
8	Lock Nut	4	18	Nylon Washers	8
9	Reflector	2			
10	Bolt	4			

## WARNING:

1. Do not exceed rated weight capacity of Cargo Carrier, distributed evenly. **Be aware of dynamic loading!** Sudden load movement may briefly create excess load causing product failure.
2. Do not exceed rated weight capacity of roof. Add 35 lb. rack weight to cargo weight when determining roof cargo capacity. Refer to vehicle's Gross Vehicle Weight Rating.
3. Cargo must be distributed evenly, the center of gravity must be kept as low as possible.
4. Secure the load against slipping using appropriate straps (not elastic straps with or without hooks).
5. Before each use, and regularly during travel, check all mounting connections and connections of the roof bars and all other supports for tight fit and tighten if required.
6. Never attempt to carry a load that is wider than the vehicle.
7. Where specialized accessories are available for carrying loads, for example a bike carrier, they should be used.
8. Loads which produce significant lifting forces shall be carried in a way that lifting force is minimized, securing them independently to the front and rear of the vehicle using straps or other methods which are capable of withstanding the lifting forces.
9. Driving techniques must be altered to allow for changes in crosswind sensitivity, such as reducing speed and using greater braking distances.
10. Take additional height into account when driving into garages, under bridges, or in tunnels.
11. Use as intended only.
12. Inspect before every use; do not use if parts loose or damaged.
13. To maintain equipment, after every use, remove Cargo Carrier and wipe external surfaces with clean cloth. Store Cargo Carrier and straps in a clean, dry area.
14. This product is not a toy. Do not allow children to play with or near this item.
15. Maintain product labels and nameplates. These carry important safety information. If unreadable or missing, contact Customer Service for a replacement.
16. The warnings, precautions, and instructions discussed in this instruction manual cannot cover all possible conditions and situations that may occur. It must be understood by the operator that common sense and caution are factors which cannot be built into this product, but must be supplied by the operator.

## Specifications:

Load Capacity: 150 lbs (68kgs)

Rack Weight: 35 lb (16kgs)

Overall Dimensions with Extension: 64"(L) x 39"(W) x 6"(H), 162.5cm(L) x 99cm(W) x 15cm(H)

Overall Dimensions without Extension: 43"(L) x 39"(W) x 6"(H), 109cm(L) x 99cm(W) x 15cm(H)

## How to install?

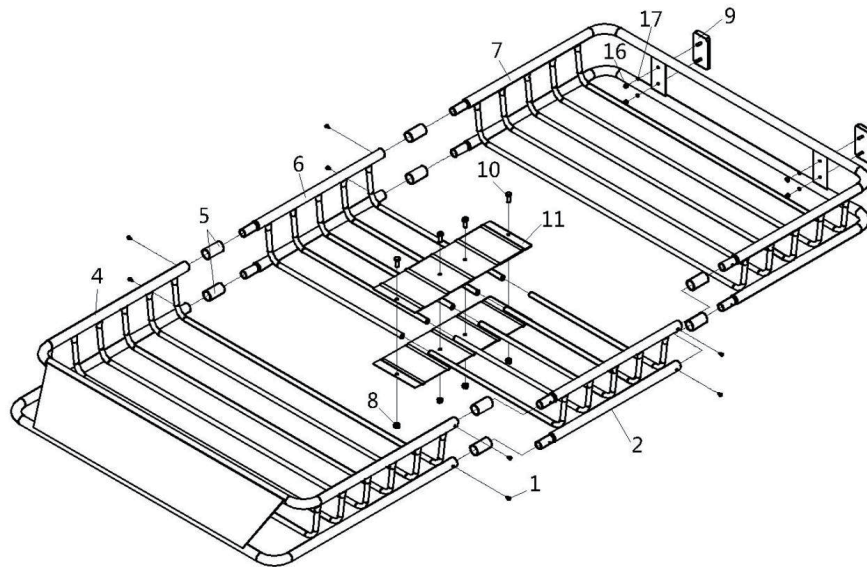

**Note:** Finger tighten all connections until assembly is done. Assemble on a flat, level, padded surface.

1. Lubricate insides of all Sleeves with thin film of petroleum jelly.
2. Connect Part (2) and Part (6) together, then use 2 Middle Plates (11) to secure all 4 joint pipes from the top and bottom, use Bolt (10) and Lock Nut (8) to tighten two plates as picture shows.
3. Slide four Sleeves (5) onto one end of Middle Section Assembly. Push Sleeves past Screw Holes.
4. Slide four Sleeves (5) onto one end of Front Section. Push Sleeves past Screw Holes.

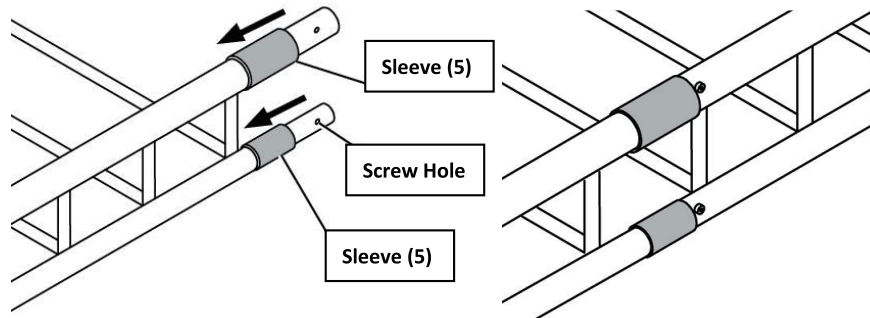

4. Attach Rear Section to Middle Section Assembly, securing connections with Washers and Screws.
5. Attach Middle Section to Front Section, securing connections with Washers and Screws.
6. Slide Sleeves next to Screws.
7. Tighten all connections securely.
8. Use spring washer and nut to mount the reflectors onto each side of the Rear Section.

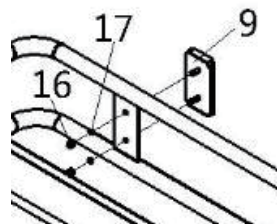

## TO PREVENT SERIOUS INJURY DURING INSTALLATION:

Park vehicle on a flat, level, hard surface well away from traffic. Place transmission in park/neutral and set parking brake.

Do not install the Cargo Carrier on recreational vehicles, trailers, towed vehicles, or off-road vehicles.

1. Snap Spacers to underside of Cargo Carrier. Place them as close to the edge as possible at each corner of Cargo Carrier.
2. Loosen vehicle's crossbars. Center to center distance between crossbars must be:
  - a. Minimum 17-3/4"b.
  - b. Maximum 31-7/8"
3. **With assistance,** lift Cargo Carrier onto top of vehicle. Center it on vehicle's crossbars.
4. Adjust crossbars and Spacers as necessary in order to center Spacers on crossbars.

**Note:** Do not place Spacers closer than 1/2" from crossbar brackets.

5. Place U-Bolt under crossbar.
6. Place Bracket over Spacer, line up holes in Bracket with tabs on Spacer. Press Bracket down until it snaps onto the Spacer.
7. Thread Knobs over U-Bolts, hand tighten.
8. Repeat for other corners.
9. Check the position of the Cargo Carrier, making sure all Spacers are properly aligned on crossbars. Make final adjustments as needed.
10. Tighten all Knobs securely, then push Caps firmly into Knobs.

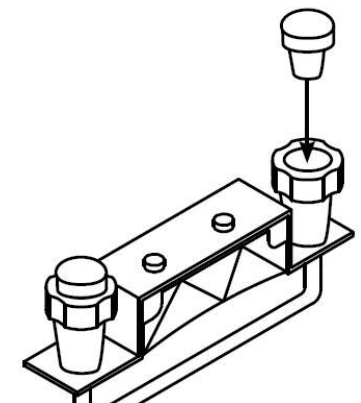
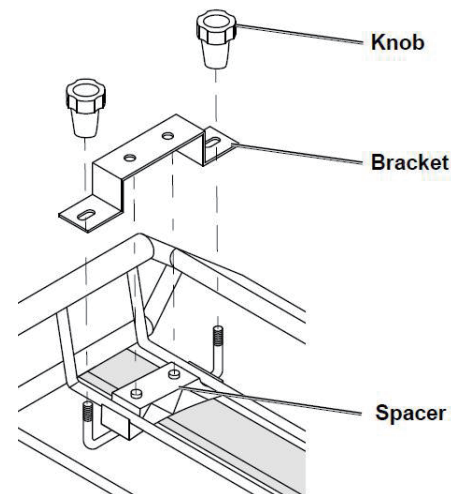
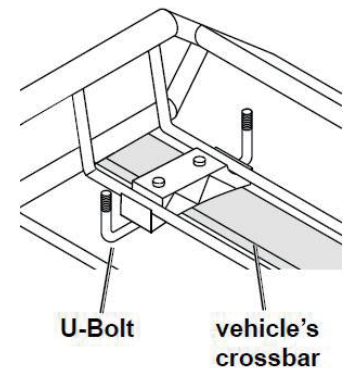
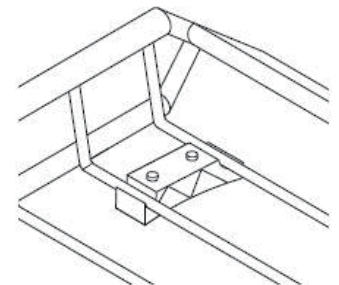

## **WARNING:**

### **TO PREVENT SERIOUS INJURY DURING OPERATION:**

**Park vehicle on a flat, level, hard surface well away from traffic. Place transmission in park/neutral and set parking brake.**

**Do not exceed rated weight capacity of roof. Add 26 lb. rack weight to cargo weight when determining roof cargo capacity. Refer to vehicle's Gross Vehicle Weight Rating.**

**Before each use, and regularly during travel, check all mounting connections and connections of the roof bars and all other supports for tight fit and tighten if required.**

**Driving techniques must be altered to allow for changes in crosswind sensitivity, such as reducing speed and using greater braking distances.**

1. Distribute cargo evenly, the center of gravity must be kept as low as possible.
2. Secure the load against slipping using appropriate straps (not elastic straps with or without hooks).
3. After each use, remove Cargo Carrier.

## **Maintenance and Servicing**

### **TO PREVENT SERIOUS INJURY FROM RACK FAILURE:**

**Do not use damaged equipment. If Rack is damaged or if abnormal noise or vibration occurs, have the problem corrected before further use.**

1. **BEFORE EACH USE**, inspect the general condition of the Cargo Carrier. Check for:
  - loose hardware,
  - misalignment or binding of moving parts,
  - cracked or broken parts, and
  - any other condition that may affect its safe operation.
2. **AFTER USE**, remove Cargo Carrier and wipe external surfaces with clean cloth. Store Cargo Carrier and straps in a clean, dry area out of children's reach.