

USER'S MANUAL

Tool Cabinet Combo

THIS INSTRUCTION BOOKLET CONTAINS **IMPORTANT** SAFETY INFORMATION. PLEASE READ AND KEEP FOR FUTURE REFERENCE.

Please give us a chance to make it right and do better!

Contact our friendly customer service department for help first.
Replacements for missing or damaged parts will be shipped ASAP!

Follow Costway
Visit us: www.costway.com



FLOOR AREA
2MX2M

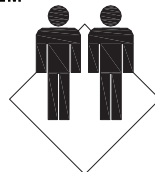

ASSEMBLED BY 2 ADULTS

Important

When you open the cartons, carefully check the contents and make sure there is no damage. If you have any problems or you find any parts damaged or missing, Please contact us first.

Do not return the product to the store before contacting us. Do not dispose of your cartons until you are completely satisfied with your products.

To reduce the risk of injury, the user should read and understand this owner's manual before assembling and using these products for the first time.

Safety Guidelines

- WARNING** Use two or more people to move, assemble, and install the product to avoid any injury.
- WARNING** DO NOT leave children unattended near the product.
- WARNING** DO NOT stand on the product or lean on the drawers or worktop.
- WARNING** WEAR SAFETY GLASSES when removing or repositioning the slides. The tools could slip, which may cause personal injury.
- WARNING** DO NOT alter the product in any manner. For example, do not weld external lock bars or attach unapproved electrical equipment. This may cause product damage, personal injury, or death.
- WARNING** DO NOT OVERLOAD PRODUCTS ! The components of the product are designed to maximum weight capacities 220lbs(100kgs).
- CAUTION** BE CAREFUL when opening more than one drawer. The product could become unstable and tip, which may cause product damage or personal injury.
- CAUTION** High risk of tipping if the product is not installed correctly. Securely attach the product to the wall to avoid serious injury.

Unpacking

1. Please make sure you have received all your packages for this product.
2. Start by placing the package on flat covered ground.
3. Remove all cardboard, honey comb board, foam packaging material and clear plastic bags.
4. Recycle all packaging materials.
5. Verify all the contents are included and gather the tools required.

Assembly Instructions

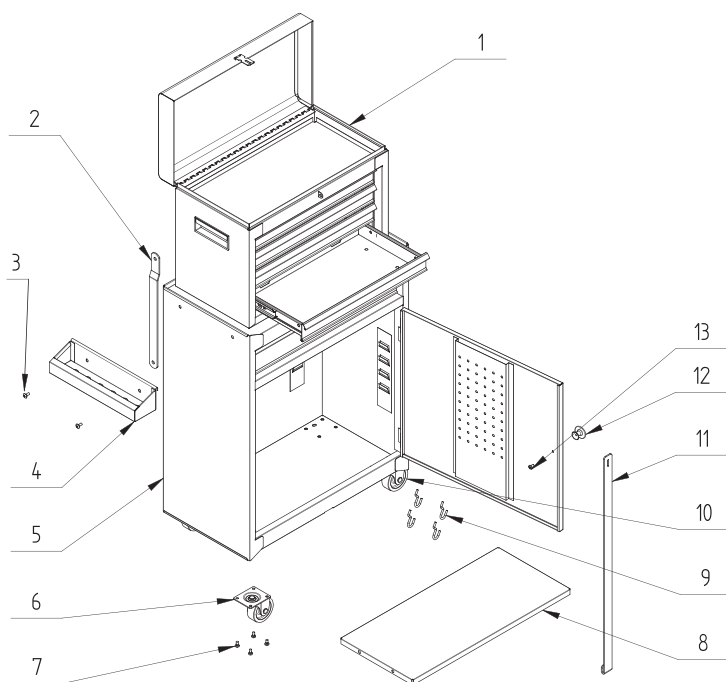

Parts List

No.	Description	Qty
1	Top chest	1
2	Short lock bar	1
3	M5x12 bolt	2
4	Tool holder	1
5	Bottom cabinet	1
6	Swivel caster without brake	2
7	M6x12 bolt	16
8	Shelf	1
9	Hook	4
10	Swivel caster with brake	2
11	Long lock bar	1
12	Door handle	1
13	M4x8 bolt	1
14	Washer	16
15	Spring washer	16
16	M6 nut	16

Remove the shelf

Open the carton, place cabinet on a level surface.
Get the shelf from the bottom of cabinet.

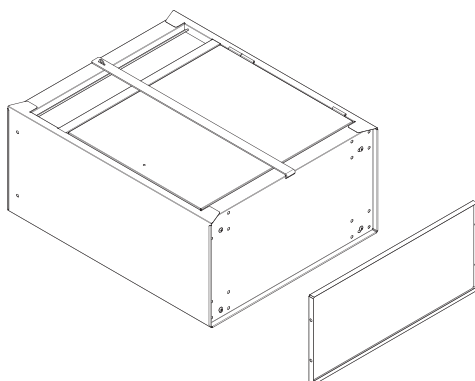

Remove the top chest

Place cabinet on a level surface.

Remove the bolts holding the chest inside the cabinet.

Slowly remove chest from the cabinet.

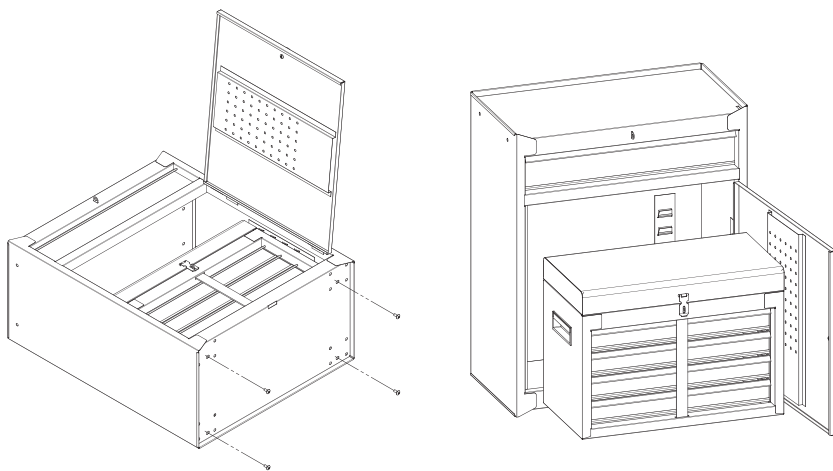

Caster Assembly

Use M6x12 bolts (7) with spring washers(15), washers (14) and M6 nuts(16)to assemble the casters. We recommend to put the casters with brake on the right side.

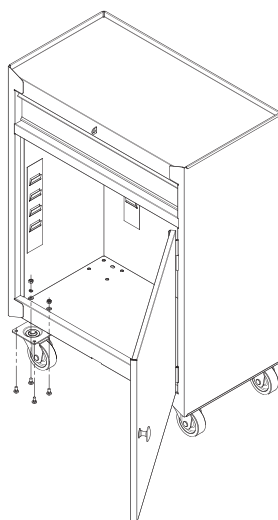

Tool Holder Assembly

Use M5x 12 bolts (3) to assemble the tool holder with a screwdriver.

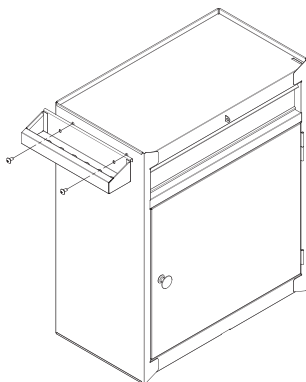

Shelf Assembly

Put the shelf (8) into the slot of roller cabinet.

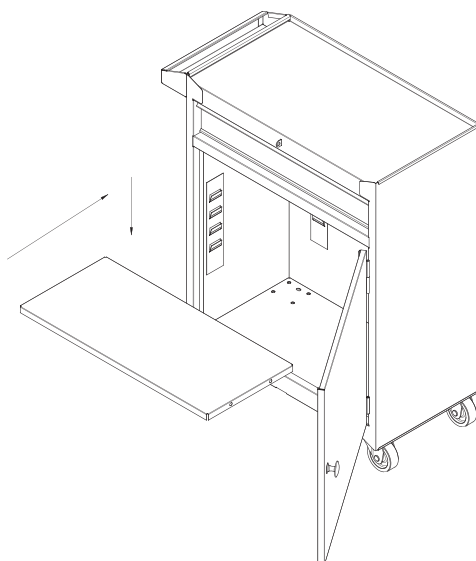

Door handle Assembly

Remove the M4x8 bolts (13) mounted on the door handle (12), assemble the door handle from inside to outside of the door again.

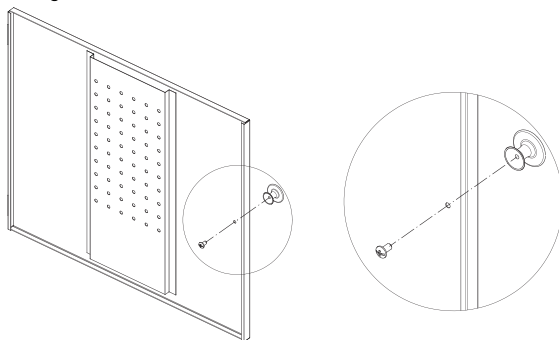

Lock Bar

Hide the lock bar when you don't need them.

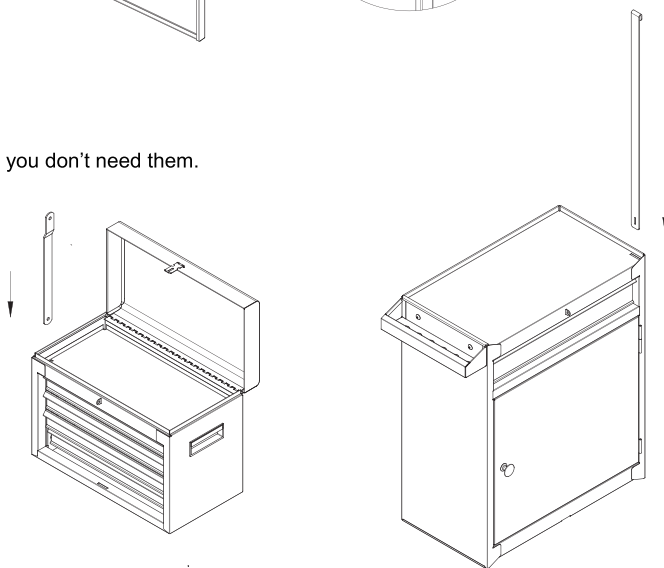

Maintenance

1. Periodically clean the work bench with mild detergent and water.
2. For safety, use a non-flammable cleaning fluid. Grease and oil can be removed with most standard cleaning fluids.
3. Do NOT allow water and other fluids to remain on the work bench for any length of time.
4. DO NOT OVERLOAD PRODUCTS ! The components of the product are designed to maximum weight capacities 220lbs(100kgs).

Welcome to visit our website and purchase our quality products!

Your suggestions and comments for COSTWAY are really important to us!

We sincerely solicit you to go back to our shop and leave a good rating in just a simple click. It would be quite encouraging if you could kindly do so like below:

★★★★★ Great products so far

February 24, 2019

Great products so far. Fast delivery, easy setup, and working without any issues.

With your inspiring rating, COSTWAY will be more consistent to offer you
EASY SHOPPING EXPERIENCE, GOOD PRODUCTS and EFFICIENT SERVICE!

US office: Fontana, California

UK office: Ipswich



- * Reward Points
- * Exclusive Customer Service
- * Personalized Recommendations
- * Permanent Shopping Cart
- * Order History

5 Star Rating



We would like to extend our heartfelt thanks to
all of our customers for taking time to assemble
this product and giving us valuable feedbacks.

THANK
you
😊

