



**COSTWAY®**



**USER'S MANUAL**  
**Folding Walker**  
**SP0601**

THIS INSTRUCTION BOOKLET CONTAINS **IMPORTANT** SAFETY INFORMATION. PLEASE READ AND KEEP FOR FUTURE REFERENCE.

**Please give us a chance to make it right and do better!**

Contact our friendly customer service department for help first.

Replacements for missing or damaged parts will be shipped ASAP!

**Follow Costway**

Visit us: [www.costway.com](http://www.costway.com)



# Contact Us!

## Do NOT return this item.

Contact our friendly customer service department for help first.



## Before You Start

- ⚠ Please read all instructions carefully.
- ⚠ Retain instructions for future reference.
- ⚠ Separate and count all parts and hardware.
- ⚠ Read through each step carefully and follow the proper order.
- ⚠ We recommend that, where possible, all items are assembled near to the area in which they will be placed in use, to avoid moving the product unnecessarily once assembled.
- ⚠ Always place the product on a flat, steady and stable surface.
- ⚠ Keep all small parts and packaging materials for this product away from babies and children as they potentially pose a serious choking hazard.



Axillary brace



Axillary support



Fixed Casters

Dear Customers:

- Thank you for using our standard walker.
- Before using it, please read the instruction manual carefully and store it in a safe place for future reference.
- If you need any further assistance, please contact us

## 1 Specification

Height (adjustable): 46.45"-58.26"/118-148cm  
 Suitable for Human Height : 4'7"-6'1" / 140 - 185 cm  
 Bearing Capacity: 397lb/180kg  
 Folding Size: 20.86"x33.46"x4.7"/53cmx85cmx12cm  
 Unfolding Size: 22.04"x20.47"x(46.45-58.26")/56cmx52cmx(118-148cm)  
 Fixed Casters size: 5 inch  
 Material: aluminum alloy  
 Type: walking frame  
 Applicable People: people with limited mobility, disabled people, rehabilitation workers, etc  
 Advantages: easy to carry, foldable, 2 wheels are light and easy to move  
 Applicable Occasions: home, senior apartment, nursing home, hospital  
 Additional Features: height adjustable

## 2 Safety Precautions

Before use follow the precautions below:

1. Ensure all the legs on the walker are set to equal heights and that this is the correct height for the user.
2. Ensure the snap buttons have been securely snapped into the slot individually (The snap button is completely exposed outside the slot, and an audible "click" will be heard. Or the walker cannot remain steady.

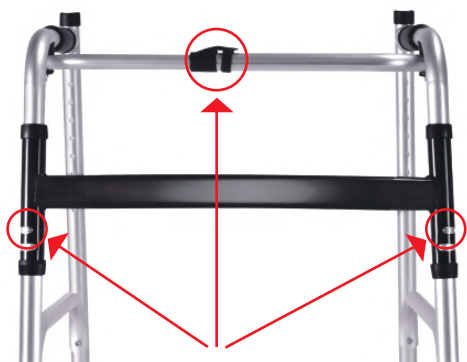

3. Do not exceed the weight limit of 440 lbs / 200 kg
4. Inspect the walker regularly for signs of damage or wear(see care and maintenance section)

## 3 Usage

### 3.1 Setting the walker



①



②



③



④



⑤



⑥

1. Swing both side frames out away from the front cross brace until both snap buttons on them are fully exposed and stuck into the slot (If it cannot be stuck, turn the side frame back and forth until the hidden button on the side frame is completely exposed and stuck in the slot).
2. Pull the bar outward with both hands to fully expose the snap button on the beam and stuck it into the slot. Or the walker cannot remain steady
3. Connect the left side front wheeled tube with the walker, press down snap button and slide on, line up pin and hole so pin pops through walker hole completely. Repeat for the right side front wheeled tube.
4. Position the left side forearm platform up, connect it with the walker, press down snap button and slide on, line up pin and hole so pin pops through walker hole completely. In the meantime, fit the clip on the frame tube. Repeat for the right side forearm platform.
5. Install the armrest, adjust the position and insert the snap.
6. installation is complete.

### 3.2 Folding the walker



Find the plastic piece on the top of the front beam, there is a snap button under it. Press it down and fold the side frames in toward the front cross brace.

### 3.3 To adjust the handgrip

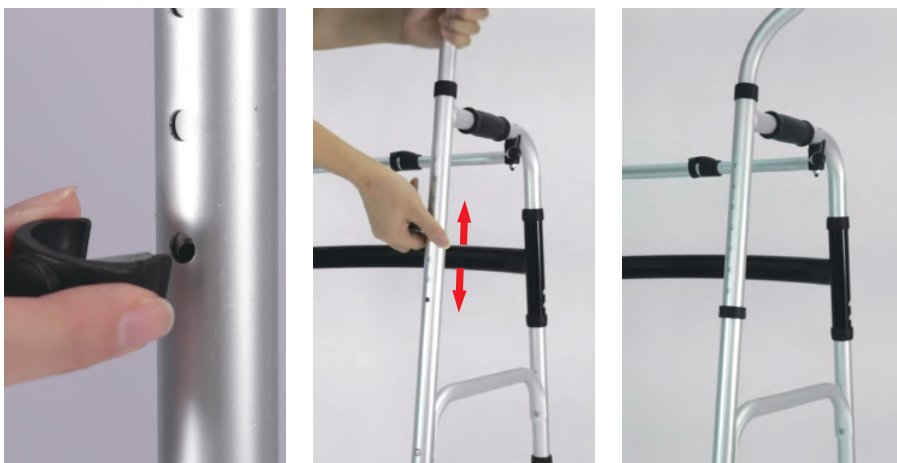

Unscrew the handgrip adjustable knob to release the handgrip. Move the handgrip horizontally to the required position. Screw the handgrip adjustment knob back in, ensuring the handgrip is secure and cannot move. Repeat for the other handgrip ensuring the handgrip are in the same position.

### 3.4 To adjust the height



1. Press the snap button, extend or retract the leg to raise or lower the height.
2. Adjust the leg extension to the desired height and allow the snap button to snap into the height adjustment hole. (An audible "click" will be heard)
3. Make sure that the walker is level.  
Repeat for the other legs, ensuring all legs are securely in position and all adjusted to the same height.

### 3.5 Fixing / Interactive adjustment



**Fixed Movement**



**Interactive Movement**

1. Fixed movement mode: press both the snap buttons into upper hole. Will be moved forward with lifting walker. **Fixed mode is recommended when using 2 wheels.**
2. Interactive movement mode: press both the snap buttons into lower hole. Will be moved forward one side at a time, in step with the user. It allows the side frames of the walker to have a certain left and right movement space. **ONLY Suitable for using 4 walker sticks /legs, not for using wheels.**  
Direction for use: Move one side forward in step at a time. Lift the left side of the walker, move the left foot forward, and then lift the right side, and move the right foot forward.
3. When using the walker, please ensure that both left and right snap buttons are set to the same mode (on the same horizontal line), or the walker will not be balanced.

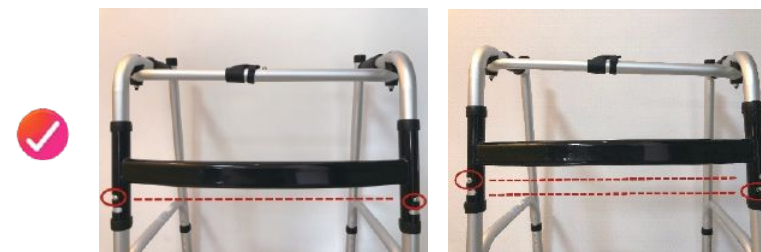



### 3.6 To use the walker

The user(or carer) place their forearm on the platform and their hand around the handgrip. Repeat for the other arm and adjust the height if required and the position of the handgrip to suit the user.



## 4 Care And Maintenance

Maintenance should be done at least every six months.  
DO NOT use an abrasive detergent, cleaner or cloth to clean or dry the walker.

1. Regular cleaning of the walker is recommended. Wipe all surfaces with a damp cloth and allow all surfaces to dry before use.
2. Regular inspection of parts including hardware, brackets, and plastics, for deformation, corrosion, breakage, wear or compression is recommended. Replace the walker if any of these conditions exist.
3. If rubber tips are worn or cracked, replace the rubber tips IMMEDIATELY

## 5 How to Deal With the Unstable Problem With The Walker

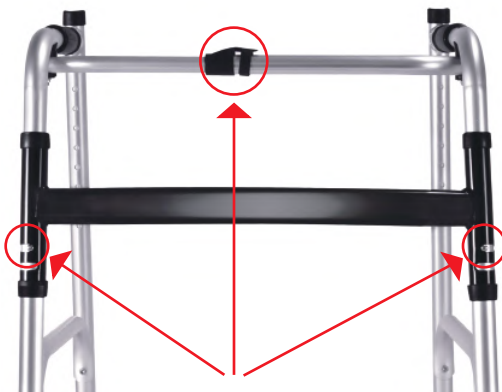

There are three snap buttons related to the stability of the walker. Please make sure that these three buttons are fully exposed and stuck into the slot.

### No. 1

Pull the bar outward with both hands to fully expose the snap button on the beam and stuck it into the slot. Or the walker cannot remain steady.



### No. 2

When using the walker, please ensure that both left and right snap buttons are set to the same mode (on the same horizontal line), or the walker will not be balanced.



### No. 3



Fixed Movement

**Fixed Movement Mode:**  
Press both the snap buttons into upper hole. Will be moved forward with lifting walker. **When using walker with 2 wheels, please use the fixed mode, otherwise the walker will be difficult to control.**



Interactive Movement

**Interactive Movement Mode:**  
Press both the snap buttons into lower hole. Will be moved forward one side at a time, in step with the user. It allows the side frames of the walker to have a certain left and right movement space. **ONLY Suitable for using 4 walker sticks /legs, not for using wheels.**  
Direction for use: Move one side forward in step at a time. Lift the left side of the walker, move the left foot forward, and then lift the right side, and move the right foot forward.

Welcome to visit our website and purchase our quality products!

With your inspiring rating, COSTWAY will be more consistent to offer you  
EASY SHOPPING EXPERIENCE, GOOD PRODUCTS and EFFICIENT SERVICE!

US office: Fontana, California

UK office: Ipswich



- \* Reward Points
- \* Exclusive Customer Service
- \* Personalized Recommendations
- \* Permanent Shopping Cart
- \* Order History

*5 Star Rating*



We would like to extend our heartfelt thanks to  
all of our customers for taking time to assemble  
this product and giving us valuable feedbacks.

