



USER'S MANUAL

Rolling Steam Cleaner
EP24668

Rolling Steam Cleaner

Model No.: EP24668

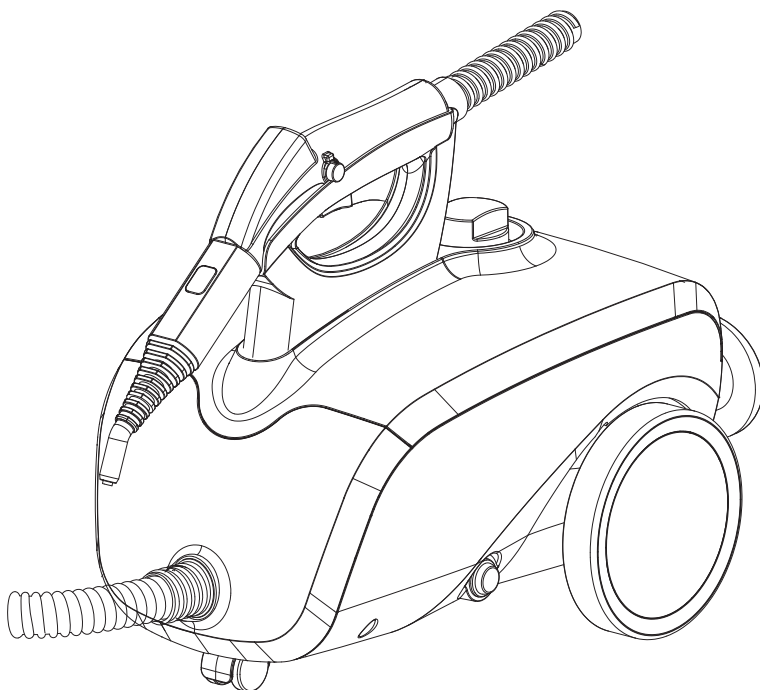

Please read this user manual before using this steam cleaner, and store it after reading in order for future reference.

Important Safety Instructions

Please carefully read the safety instruction as below:

INTENDED USE: this product is intended to be used indoors for household cleaning. This product is not intended for commercial or industrial uses. The manufacture assumes no responsibility for damage or injury due to unauthorized use of product modification. Failure to follow these directions will void the product warranty.

Directions to reduce risk of fire, electric shock, and injury:

1. Read all instructions before use.
2. Before plugging power cord into electrical outlet, be sure that all electrical information on rating label agrees with your power supply.
3. To reduce likelihood of circuit overload, DO NOT operate another high wattage appliance in the same circuit as this unit.
4. To protect against risk of electric shock, do not immerse unit in water or other liquids. DO not use power cord as handle, let it hang over edges of counters, or be crimped or closed in doors.
5. Never yank power cord to disconnect from outlet; instead, grasp plug and pull to disconnect.
6. Do not operate unit with a damaged power cord or if the unit has been dropped or damaged. To avoid risk of electric shock, do not disassemble unit; must contact designated service center staff or equally qualified electrician people confirm replacement. Incorrect reassembly can cause a risk of electric shock when unit is used.
7. A loose fit between wall outlet and plug may cause overheating and distortion of the plug. Discontinue use of the product in this outlet. Contact a qualified electrician to replace loose or worn outlets.
8. Do not leave unit unattended while plugged in.
9. Do not use unit where aerosol-based products are being used, or where oxygen is being administered.
10. Unit is only meant to be used with recommended (model PEROLSTM) accessories. Using other types of attachments may cause damage to unit or injury.

11. If lighted On/Off switch does not illuminate when set to “ON” position while power cord is plugged in, unit is not operating normally. Immediately disconnect cord from power supply, and then refer to troubleshooting guide on Page of this manual for assistance.
12. Always turn unit off and unplug power cord before filling boiler with water. Do not attempt to use unit without properly filling boiler.
13. When filling boiler, only water should be used in unit-other cleaning agents could damage unit or cause injury. Distilled or de-mineralized water is highly recommended, in order to minimize potential build-up of mineral deposits. Do not fill boiler with more than 1500ml of water.
14. Not allow using any cleaner or chemicals in the water tank.
15. Before adding water to the tank, please turn off the power switch first, pulled out the plug from outlet.
16. Please place the power cord far away from any hot surfaces.
17. In order to avoid scald, please do not touch the nozzle part when it is under operation.
18. When appliance is under operation, must pay attention to watch it to prevent steam spray from burn danger and avoid injury.
19. In order to avoid scald, please do not let the children or someone operate the appliance that is not familiar with the method of use.
20. Please store this machine indoors and do not let this machine outdoor in the rain or the wind.
21. Do not attempt to repair, dismantle the appliances, when found that appliances have a problem; please send it to designated service center to repair timely.
22. The appliance has to be unplugged after use and before cleaning or user maintenance of the appliance.
23. Liquid or steam must not be directed towards equipment containing electrical components, such as the interior of ovens.

Important Safety Instructions



24. : Hot steam.

25. To avoid burns from escaping steam when removing boiler cap to refill unit:
- Always allow unit to cool for 5-10 minutes.
 - Press and hold steam button to release all remaining steam pressure
26. To reduce risk of contact with hot water emitting from the nozzle, check appliance before each use by positioning it away from body and turning it on. Do not operate unit if the nozzle is blocked.
27. Burns can occur from touching hot metal parts, hot water, or steam. Do not touch the Nozzle or attempt to connect accessories while unit is in use. Do not touch bottom of mop head or attempt to attach a microfiber pad by hand while unit is in use. Be careful when you turn unit upside-down – there may be hot water in boiler.
28. Be careful when using unit on uneven surfaces, such as stairs.
29. When steaming any surface for the first time, it is recommended that you consult the manufacturer's guidelines for material being steamed. For items in question, test on an inconspicuous area before proceeding.
30. Steaming unsealed hardwood or unglazed ceramic surfaces is not recommended, and may result in warping or damage to the surface. Steam may remove the sheen from surfaces treated with wax.
31. When steam mopping, never leave unit resting in one spot on any surface for any period of time – prolonged exposure to heat and moisture may damage floor surface.
32. Do not allow power cord to touch hot surfaces during use. Bundle cord loosely when storing.
- Always allow Steam cleaner to cool (at least 30mins for complete cooling) and empty boiler before storing. Do not store unit with a damp microfiber pad still attached.

WARNING: Changes or modifications to this unit not expressly approved by the party responsible for compliance could void the user's authority to operate the equipment.

33. This appliance is not intended to be used by children and persons with reduced physical, sensory or mental capabilities or lack of experience and knowledge unless they have been given supervision or instruction concerning use of the appliance in a safe way and understand the hazards involved. Children shall not play with the appliance. Cleaning and user maintenance shall not be made by children without supervision.

Attention: In replace any accessories operating, please make sure machines have shut off the power and no steam extrusive. And let the machine cooling 30 minutes, to prevent burns.

SAVE THESE INSTRUCTIONS

Product Information

The following features and accessories are included with your steamer cleaner,.
Carefully inspect the packing material for all parts listed below.

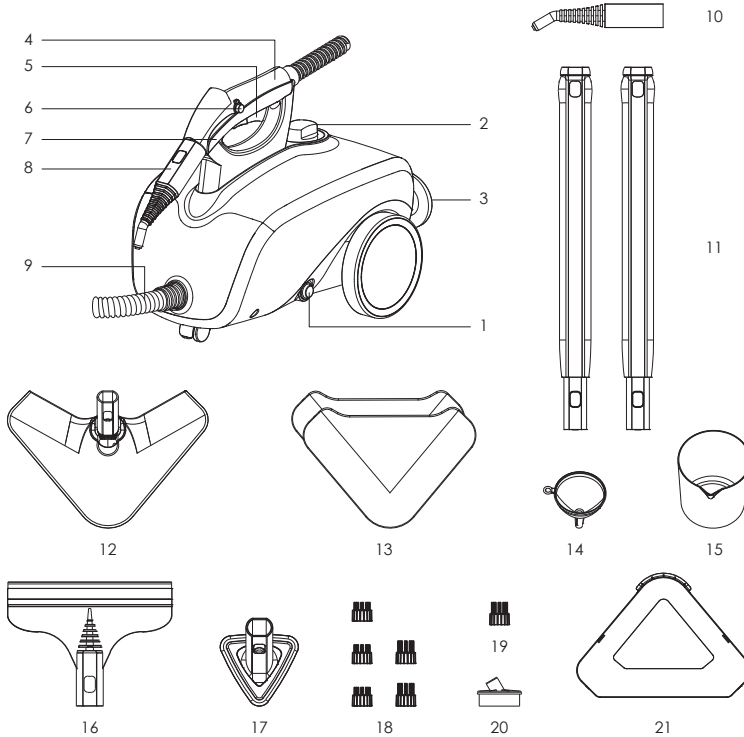

01. Lighted On/Off Switch	12. Mop Head
02. Boiler & Safety Cap	13. Microfiber Pads
03. Back Cord Wrap	14. Water Funnel
04. Handle	15. Measuring Cup
05. Steam Lock Switch	16. Squeegee
06. Steam Button	17. Triangle Brush
07. Carrying Handle	18. Nylon Utility Brushes
08. Main Nozzle	19. Brass Utility Brush
09. Steam Hose	20. Scrub Pad
10. Steam Jet Nozzle	21. Carpet Glider
11. Extension Wands	

1. The Lighted On/Off Switch (1) activates and deactivates the unit, and illuminates to provide a clear visual indication of whether the unit is powered on.
2. The Boiler with Cap (2) is the internal reservoir in which water is stored and heated. It is accessed by removing the boiler cap. There must be a sufficient amount of water in the boiler in order for the unit to properly function.
3. The Back Cord Wrap (3) is designed to hold the power cord when not in use, and includes a compartment for storing small accessories.
4. The Handle (4) is designed to stay cool while providing the optimum amount of safety and user comfort.
5. The Steam Lock Switch (5) is pushed forward to lock the steam button down and provide continuous, hands-free steaming.
6. The Steam Button (6) provides full steam-on-demand control, releasing hot, penetrating steam from the Main Nozzle when pressed.
7. The Carry Handle (7) functions as a convenient holder for the Main Nozzle, and is designed for carrying the unit up stairs and over obstacles.
8. The Main Nozzle (8) emits a powerful flow of steam when the Steam Button is pressed.
9. The Steam Hose (9) safely channels the flow of steam from the Boiler to the Main Nozzle.
10. The Steam Jet Nozzle (10) focuses the flow of steam from the Main Nozzle, and serves as the base to which the Utility Brushes and Scrub Pad connect.
11. The Extension Wands (11) connect to the Main Nozzle, allowing for floor mopping as well as easier cleaning in high or hard-to-reach places.
12. The Mop Head (12) connects to the Extension Wands, and is designed for steam cleaning a variety of hard floor surfaces.
13. The Microfiber Pads (13) attach to the Mop head, and are designed for removing scuffs and stains from hard floors. The Pads are reusable and machine washable.

Product Information

14. The Water Funnel (14) and the Measuring Cup (15) are provided to assist in easily and consistently filling the Boiler with the optimum amount of water (17-52 oz. /500-1,500ml.).
15. The Squeegee (16) connects to either the Main Nozzle or Extension Wands, and can be used to clean mirrors, windows and other smooth glass surfaces.
16. The Triangle Brush (17) connects to the Main Nozzle or Extension Wands, and is designed for cleaning corners and other difficult angles.
17. The assorted Nylon Utility Brushes (18) connect to the Steam Jet Nozzle, providing extra scrubbing power for removing exceptionally tough dirt and stains.
18. The Brass Utility Brush (19) connects to the Steam Jet Nozzle and is designed for removing tough stuck-on grease and grime from durable surfaces such as ovens and grills.

NOTE: Use careful judgement when deciding what surface to clean with the Brass Utility Brush. Some delicate surface, such as stainless steel, may be scratched or damaged by the brass bristles. If you are unsure whether or not a surface will be damaged, it is recommended that you test a small inconspicuous spot before proceeding.

19. The Scrub Pad (20) connects to the Steam Jet Nozzle and is designed to scrub tough dirt and scuffs from surfaces.

Assembling Your Steam Cleaner

STEAM MOPPING ACCESSORIES

WARNING: Do not try to connect accessories while unit is emitting steam.

EXTENTION WANDS

1. Select one of the Extension Wands, and align rear end of wand with Main Nozzle.
Rectangular hole in wand should align with orange lock / release button on nozzle.
2. Press down on orange lock/release button. While continuing to hold button down, slide Extension Wand onto Main Nozzle (FIGURE 1-A). Push wand over button, and continue pushing until button snaps through hole on wand.
3. Slide second Extension Wand onto end of the one you just connected, this time lining up rectangular hole of second wand with orange lock/release button of first wand. Press and hold button, and firmly push second wand onto end of first wand until button snaps through hole (FIGURE 1-B). Both Extension Wands should now be connected to the Main Nozzle.

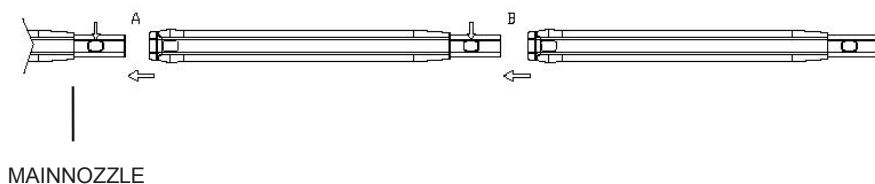

FIGURE 1

Assembling Your Steam Cleaner

MOP HEAD

1. Align Mop Head with end of second Extension Wand, so that rectangular hole in Mop Head neck aligns with orange lock/release button on wand.
2. Press down on orange lock/release button. While continuing to hold button down, slide Mop Head neck onto Extension Wand FIGURE 2-A). Press on firmly until button snaps through hole (FIGURE 2-B).

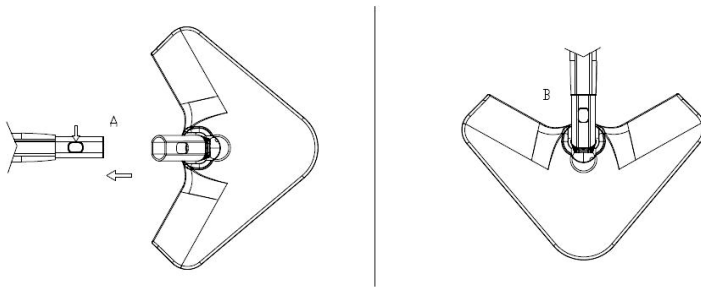

FIGURE 2

MICROFIBER PADS

1. Lay on Microfiber Pad on flat surface, with two fastener strips for facing upward.
2. Align Mop Head above Microfiber Pad. Make sure Mop Head is oriented with pad as shown, and centered as best as possible (FIGURE 3-A).
3. Fastener strips will adhere to pad grips on underside of Mop Head. Microfiber Pad should now be attached and ready for use (FIGURE 3-B).

CAUTION: Use care when handling a recently used Microfiber Pad, as it may still be hot.

NOTE: Microfiber Pads are machine washable. To avoid picking up lint, washing separately from other fabrics is recommended. Only use liquid detergent. Avoid using any fabric softeners or bleach. Air drying is recommended; machine drying on a low heat or air dry setting is acceptable as well.

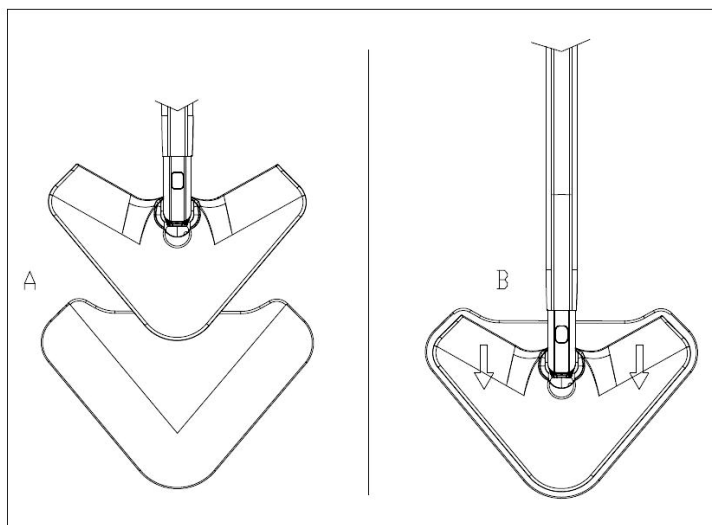

FIGURE 3

The Mop Head and Microfiber Pads are perfect for use on these hard floor surfaces:

- | | | |
|--------------------|------------|----------|
| ● Sealed Hardwood | ● Linoleum | ● Marble |
| ● Stained Concrete | ● Ceramic | ● Vinyl |
| ● Sealed Laminate | ● Granite | ● Tile |

IMPORTANT: Do not use on unsealed hardwood or unglazed ceramic surfaces. Surfaces that are not properly sealed may be warped or damaged by exposure to heat and moisture.

Care should also be taken when steaming sealed hardwood floors, as prolonged exposure to steam in a single spot may cause damage and discoloration. To avoid this, keep the Mop Head in constant motion on these surfaces.

Steam may remove the sheen from some floors that have been treated with wax. Extremely rough textured floors may tear or damage Microfiber Pads.

Assembling Your Steam Cleaner

STEAM CLEANING ACCESSORIES

WARNING: Do not try to connect accessories while unit is emitting steam.

STEAM JET NOZZLE/SQUEEGEE/TRIANGLE BRUSH

1. Select one of the three accessories (Steam Jet Nozzle, Squeegee or Triangle Brush-Steam Jet Nozzle shown as example), and align rear end of accessory with Main Nozzle. Rectangular hole in accessory should align with orange lock/release button on Main Nozzle.
2. Press down on orange lock/release button (FIGURE 4-A). While continuing to hold button down, slide accessory onto Main Nozzle (FIGURE 4-B). Push accessory over button, and continue pushing until button snaps through rectangular hole.

NOTE: The Steam Jet Nozzle, Squeegee and Triangle Brush can be connected to the end of an Extension Wand for reaching high or difficult spots. Connect the Extension Wand (or Wands) as outlined on Page 8, then connect your desired accessory to the Wand in the same way as you would normally connect it to the Main Nozzle.

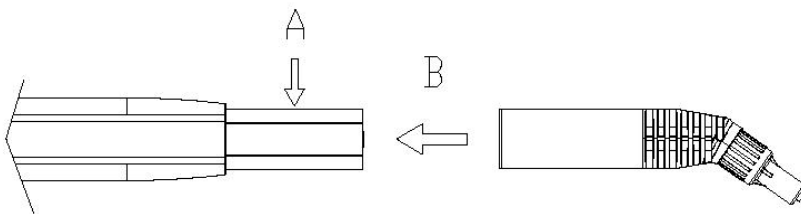

FIGURE 4

UTILITY BRUSHES

NOTE: Utility Brushes connect to the Steam Jet Nozzle, not the Main Nozzle.

1. Align guide tab on inside of Utility Brush (FIGURE 5-A) with groove in bottom of Steam Jet Nozzle tip (FIGURE 5-B).
2. Firmly press Utility Brush onto tip of Steam Jet Nozzle. Press it on as far as possible to prevent steam leakage (FIGURE 5-C).
3. To remove Utility Brush, simply grip it firmly and pull it off of Steam Jet Nozzle.

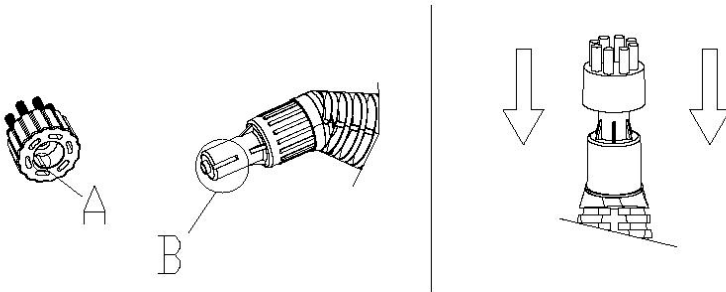

FIGURE 5

SCRUB PAD

NOTE: Scrub Pad connects to the Steam Jet Nozzle, not the Main Nozzle.

1. Place Scrub Pad over tip of Steam Jet Nozzle, and firmly press it on Steam Jet Nozzle as far as possible. (FIGURE 6)
2. To remove Scrub Pad, simply grip it firmly and pull it off of Steam Jet Nozzle.

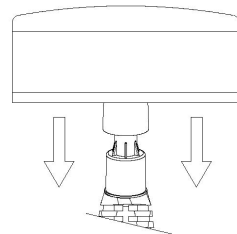

FIGURE 6

Using Your Steam Cleaner

FILLING BOLIER

1. Place Steam Cleaner on a flat, level surface.
2. Make sure Lighted On/Off Switch is set to "OFF" position and grounded power cord is unplugged from electrical outlet.
3. Cautiously unscrew and remove Boiler cap, and drain any water remaining inside Boiler into a sink or tub.

NOTE: Boiler should be emptied after each use-this will help minimize mineral build-up and prevent over-filling.

4. Fill Measuring Cup to maximum fill line (17 oz./ 500ml.) with water.

NOTE: In order to significantly reduce mineral build-up and prolong the life of your Steam Cleaner, use of distilled or de-mineralized water in the unit is highly recommended. Refer to Page 16 for more information about mineral build-up.

5. Using Water Funnel, carefully pour water from Measuring Cup into Boiler through fill hole.

CAUTION: Water Funnel should always be used to fill Boiler, to prevent spilled water from entering unit housing and damaging electrical components.

6. Depending on how long you intend to steam, you may repeat steps 4 & 5 up to two more times, up to a maximum of 52 oz.(1,500 ml.)of water. See chart for a comparison of the amount of water vs. approximate steam time.

Amount of water	Duration of Steam
17 oz (500ml.)	Approximately 15mins
35 oz (1000ml.)	Approximately 30mins
52 oz (1500ml.)	Approximately 45mins

7. Replace Boiler cap, ensuring that it is screwed on tightly to prevent hot steam from escaping and causing injury.



REFILLING BOILER

If unit has been in use, always use the following safety precautions before removing the Boiler cap to add water:

- Allow unit to cool for 5-10 minutes.
- Press and hold Steam Button to release all remaining steam. **Steam can remain pressurized inside Boiler for up to an hour after use.**

WARNING: Failure to follow these precautions may result in burns from escaping steam when the Boiler cap is removed.

GENERAL OPERATION

NOTE: Be sure that Boiler has been filled and that all desired accessories are connected before following these steps.

1. For first time use, remove protective plastic cover from electrical plug. Plug power cord into a convenient electrical outlet.
2. Switch Lighted On/Off Switch to "ON" position.
3. The water will heat 8-10 minutes (depending on how much water in Boiler), and then ready to begin steaming.
4. Direct nozzle (and any connected accessories) towards surface you desire to steam, and press Steam Button. To sanitize surfaces, point nozzle, press Button and hold approximately 1/2 inch from surface for at least 5 seconds. This will insure that you have killed germs and bacteria.

CAUTION: Always be sure that nozzle and any accessories are pointed in a safe direction (away from yourself, other people, pets, and plants) before pressing Steam Button.

5. Keep Steam Button pressed for a continuous flow of steam. You may also slide the Steam Lock Switch forward while pressing the Steam Button to lock it down. This will allow a continuous flow of steam without need of holding the Button down manually.
6. Using a slight back-and-forth motion over the area you are steaming will further enhance the cleaning process. Wipe steamed areas with a clean cloth to remove loosened dirt and grime. Wiping the area while it is still wet is recommended, but use caution when wiping surfaces such as metal that may still be hot.

Using Your Steam Cleaner

7. Once steaming tasks are complete, immediately set Lighted On/Off Switch to "OFF" position and unplug grounded power cord from electrical outlet. Follow steps under Proper Storage procedure on Page 16 of this manual.

STEAM MOPPING

NOTE: Be sure that Boiler has been filled and that all steam mopping accessories are connected before following these steps.

It is recommended to sweep or vacuum hard floors before mopping.

1. Follow STEPS 1-3 of General Operation section above.
Refer to Page 10 for a listing of hard floor surfaces that are recommended for cleaning with the Steam Cleaner.
2. For best results, use a steady back-and-forth motion over floor surface, pushing the Mop Head away and pulling it back towards you. Work your way backwards over the floor, in order to avoid walking over freshly mopped areas.
NOTE: To avoid warping or damage caused by heat and moisture, do not use on unsealed hardwood or unglazed ceramic surfaces. Steam may remove the sheen from some floors that have been treated with wax.
3. To effectively kill bacteria and microorganisms, repeatedly mop a single small area (approximately 3' x 3' for best results) for at least 2 minutes.
4. The Microfiber Pad will absorb dirt and moisture during mopping. However, when you are finished you may find some residual moisture has been left behind. In this case, it is recommended to allow floor time to air-dry. A fan may be directed towards mopped area to facilitate drying.

Storage, Care & Product Support

PROPER STORAGE

Preparing your Steam Cleaner for storage is quick and simple. When you have finished your steaming tasks, follow the steps listed below.

1. Set Lighted On/Off Switch to “OFF” position and unplug power cord from electrical outlet.
2. Allow unit to cool (at least 30 minutes for complete cooling).
3. Press and hold Steam Button to release all remaining steam pressure.
4. Remove all accessories from unit.
5. Remove Boiler cap, drain any remaining water from Boiler into a sink or tub-this will help to minimize mineral build-up and prevent over-filling during your next use. Loosely replace Boiler cap.
6. Store accessories safely away, near Steam Cleaner. Utility Brushes can be conveniently stored in the Back Cord Warp.
7. Store Steam Cleaner in a cool ,dry location .

MINERAL BUILD-UP

A common maintenance need for steam appliances is the removal of build-up caused by high mineral content in many municipal water supplies. This mineral build-up may limit the effectiveness and reduce the life of your Steam Cleaner.

The best way to minimize mineral build-up is to use distilled or de-mineralized water when using your Steam Cleaner. If you are unable to use distilled water, it is recommended that the following procedure be followed monthly to help remove any mineral build-up:

Storage, Care & Product Support

1. Set Lighted On/Off Switch to “OFF” position and unplug power cord from electrical outlet.
2. Allow unit to cool (at least 30 minutes for complete cooling).
3. Press and hold Steam Button to release all remaining steam pressure.
4. Remove all accessories from unit.
5. Remove Boiler cap and drain water from Boiler into a sink or tub.
6. Fill Measuring Cup with 17 oz.(500 ml.) distilled vinegar.
7. Carefully pour vinegar into Boiler. Slowly shake or move unit around to agitate vinegar.
8. Allow to stand for at least 40 minutes, or more if possible.
9. Drain vinegar from Boiler.
10. Rinse Boiler with fresh water, drain and repeat until vinegar odor dissipate.
11. Loosely replace Boiler cap and follow steps under Proper Storage procedure on Page 16 of this manual.
12. Replace the boiler safety cap.

Troubleshooting

PROBLEM	POSSIBLE CAUSE	SOLUTION
Unit fails to heat up. Lighted On/Off Switch DOES NOT illuminate when set to “ON” position.	Unit is not plugged in.	Plug power cord into electrical outlet.
	Household circuit breaker/ ground fault interrupter has tripped or blown a fuse.	Reset circuit breaker/ground fault interrupter, or replace fuse. If you need assistance, contact a licensed electrician.
	Unit is damaged or otherwise in need of repair.	Immediately cease usage and unplug. Contact Consumer Service for further assistance

Troubleshooting

PROBLEM	POSSIBLE CAUSE	SOLUTION
Unit fails to heat up. Lighted On/Off Switch DOES illuminate when set to "ON" position.	Boiler is empty.	Refer to Filling Boiler procedure on page 13
	Mineral build-up in unit.	Refer to Mineral Build-up section on page 16 for cleaning procedure.
	Unit is damaged or otherwise in need of repair.	Immediately cease usage and unplug. Contact Consumer Service for further assistance
Steam output is weak or intermittent.	Water level in Boiler is running low.	Refer to Filling Boiler procedure on Page 13.
	Mineral build-up in unit.	Refer to section on Page 16 for cleaning procedure.
Excessive amount of water in steam.	Water condensation in Steam Hose.	Point nozzle towards sink, tub or ground and shake while pressing Steam Button. Continue until excess water is released.
NOTE: Unit produces moist steam-it is normal for steam to contain some amount of water.	Boiler has been overfilled.	Drain some water out of Boiler. Always use included Measuring Cup to fill Boiler with correct amount of water (see Page 13 for details).
	Unit has not heated to full operating temperature.	Wait long time about 10 minutes when the steam is ready
Accessories do not stay firmly connected to Main Nozzle.	Accessories not properly installed.	Check to make sure that accessories are properly connected, per procedures on Pages 9-10
Floor surfaces appear cloudy or streaky after steaming.	Microfiber Pad is dirty.	Replace Microfiber Pad with a clean one.
	Hard water residue on floor.	Switch to distilled or de-mineralized water.

Product Specifications

PRODUCT SPECIFICATIONS

MODEL	EP24668
VOLTAGE	120V
WATTAGE	1500W
AMPERAGE	12.5A
WATER CAPACITY	52 OZ. (1,500 ML.)
HEATING TIME	8~10 MIN. (APPROXIMATE)
CONTINUOUS STEAM TIME	45 MIN. (APPROXIMATE)
NET WEIGHT	10.1 LBS. (4.6KG)
UNIT DIMENSIONS	15.7" x 11.1" x 13.1" (40 x 28.2 x 33.5 CM)
POWER CORD LENGTH	16.4'(500.0CM)



TIPS:

Your suggestions and comments for Costway are really important to us!

We sincerely solicit you to go back to our shop and leave a good rating in just a simple click. It would be quite encouraging if you could kindly do so like below:

★★★★★ Great products so far

February 24, 2018

Great product so far. Fast delivery, easy setup, and working without any issues.

With your inspiring rating, Costway will be more consistent to offer you
EASY SHOPPING EXPERIENCE, GOOD PRODUCTS and EFFICIENT SERVICE!

US office:Fontana

UK office:Ipswich

