

USER'S MANUAL

kids Ride On Dump Truck TY327741

THIS INSTRUCTION BOOKLET CONTAINS **IMPORTANT** SAFETY INFORMATION. PLEASE READ AND KEEP FOR FUTURE REFERENCE.

Please give us a chance to make it right and do better!

Contact our friendly customer service department for help first.

Replacements for missing or damaged parts will be shipped ASAP!

Follow Costway

Visit us: www.costway.com



EN

DE

FR

ES

IT

PL

Contact Us!

Do NOT return this item.

Contact our friendly customer service department for help first.



Before You Start

Please read all instructions carefully and keep it for future reference.

Warnings:

Attention! Use it with protective equipment.

Attention! Not use it in the traffic.

Attention! The product is not suitable for the children under 3 years.

General Warnings:

- ⚠ The product must be installed and used under the supervision of an adult.
- ⚠ Read through each step carefully and follow the proper order.
- ⚠ Remove all packaging, separate and count all parts and hardware.
- ⚠ Please ensure that all parts are correctly installed, incorrect installation can lead to a danger.
- ⚠ We recommend that, where possible, all items are assembled near to the area in which they will be placed in use, to avoid moving the product unnecessarily once assembled.
- ⚠ Ensure a secure surface during construction, and place the product always on a flat, steady and stable surface.
- ⚠ Please use the product carefully, as the product requires great skill, avoid accidents by the user or others, by fall or collision.
- ⚠ Please wear suitable protective equipment during use, e.g. protective helmet, gloves, knee pads, elbow pads etc.

Styles and colors may vary

- ◎ Suitable age for 3+ Years
- ◎ Maximum user weight: 66 lbs.
- ◎ Adult assembly required

1. Specification

On the purchase of your new Ride-On

Suitable age	37-96 months
Load Capacity	Under 66 lbs.
Speed	3-5km/hr
Charge time	8-12 hours
Size of car	42.5" x 25.5" x 23"
Battery life	300 recharges
Power way	Charging type

BATTERY INFORMATION

- Non-rechargeable batteries are not to be recharged.
- If removable rechargeable batteries are used, they are only to be charged under adult supervision.
- Remove rechargeable batteries from the product before charging.
- Do not mix old and new batteries. Do not mix different types of batteries: alkaline, standard (carbon-zinc) or rechargeable (nickel-cadmium).
- Insert batteries as indicated inside the battery compartment, anode to anode, cathode to cathode.
- Remove batteries during long periods of non-use. Always remove exhausted batteries from the product. Battery leakage and corrosion can damage this product. Dispose of batteries safely.
- Never short circuit the battery terminals

2. Parts List

Number	Name	Quantity	Remark
		Two motors	
1	Car bucket	1	
2	Seat (plastic) / (leather)	1	choose
3	Steering wheel	1	
4	Steering wheel trim	2	
5	Chimney	1	
6	Wheel (front wheel)	2	
7	Wheel (rear wheel)	2	
8	Wheel cap	4	
9	Steering iron	1	
10	Steering rod	1	
A	Ø10 nuts	4	Install on the front and rear axles
B	Ø10 gasket	8-9	
C	M4×12 screw	8-9	Seat *2/ Car bucket *5
D	Ø8 gasket	1	Install on the Steering wheel
E	Ø8 nuts	1	Install on the Steering wheel
F	Cotter pin	1	Install on steering rod

※ Assembly tools required



Screwdriver
(not included)



Spanner
(included)



Spanner
(included)

3. Parts Diagram

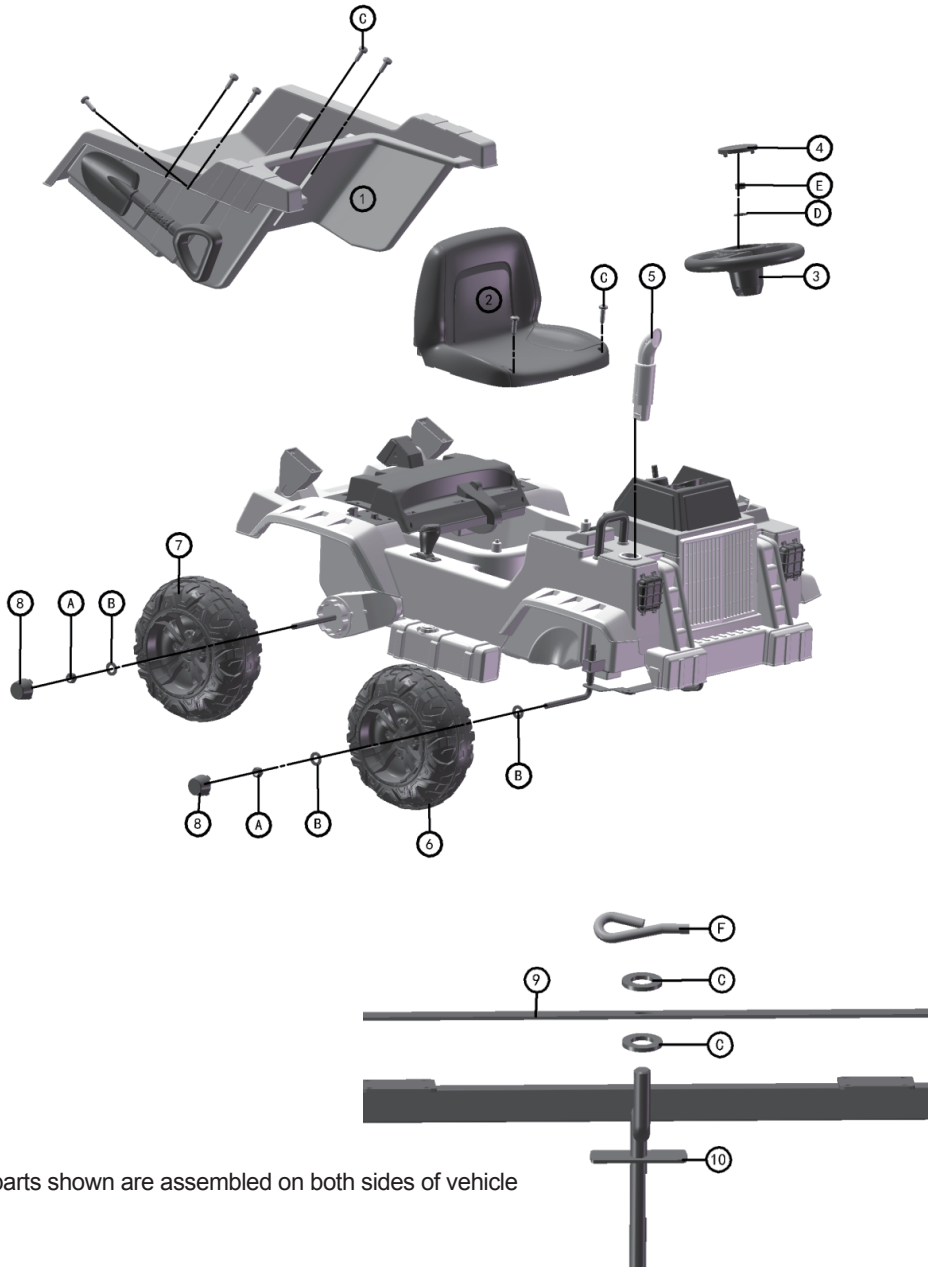

NOTE:

Some parts shown are assembled on both sides of vehicle

4. Safety



PREVENT INJURIES AND DEATHS:

- NEVER LEAVE CHILD UNATTENDED.ADULT DIRECT SUPERVISION IS REQUIRED.Always keep child in view when child is in vehicle.

- This toy should be used with caution since skill is required to avoid falls or collisions causing injury to the user or third parties.

- Protective equipment should be worn.

- Never use in roadways,near cars,on or near steep inclines or steps,swimming pools or other bodies of water.

- Always wear shoes,always sit on the seat.

CHOKING HAZARD! NOT suitable for children under 37 months.

- ADULT ASSEMBLY REQUIRED.

Rules for Safe Riding

- Keep children within Safe Riding Areas:

Never use in roadway near motor vehicles, on lawn space, on or near steep inclines or steps swimming pools or other bodies of water;

- Use the toy only on flat surfaces. Such as inside your house, garden or playground.

- Never use in the dark .A child could encounter unexpected obstacles and have an accident.

Operate the vehicle only in the daytime or a well-lit area.

- It is prohibited to change the circuit or add other electric parts

- Inspect wires and connections of the vehicle periodically.

- Do not let any child touch the wheels or be near them when the car is moving.

- This vehicle has adjustable play seat belts. Please instruct children how to tie the safety belt before using ;guarantee the security.

5. Operation

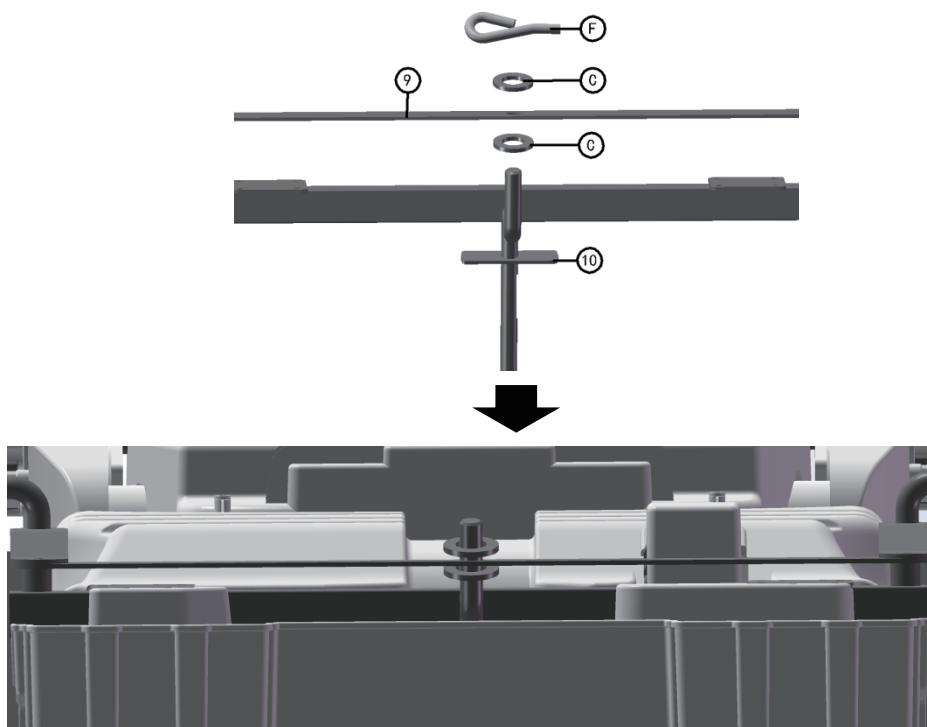

Turn the car back up

- 1.Insert $\varnothing 10$ gasket into the steering rod ;
- 2.Insert the hole of steering iron into the steering rod (either one can be inserted first) ;
- 3.Install $\varnothing 10$ gasket into the steering rod ;
- 4.Fixed the Cotter pin ;

6. Operation Instruction



Turn the car back up

- 1.Put an $\varnothing 10$ gasket into the front axle
- 2.Install the front wheel;
- 3.Put another $\varnothing 10$ gasket;
- 4.Fixed with $\Phi 10$ nuts;
- 5.Install the wheel cap;

Use the same way to install the front wheel on the other side

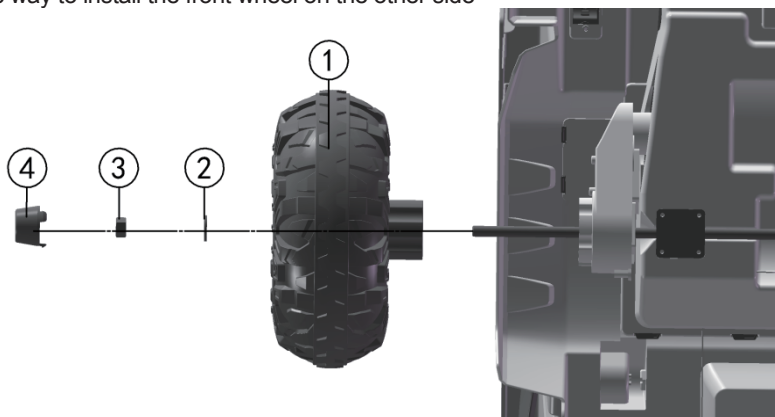

- 1.Install the driving wheel on the rear axle to ensure that the driving wheel is stuck into the motor's slot;
- 2.Put an $\varnothing 10$ gasket
- 3.Fixed with $\Phi 10$ nuts;
- 4.Install the wheel cap;

Use the same way to install the rear wheel on the other side

7. Operation Instruction



1. Insert the chimney into the slot of the car body, as shown in the picture;
2. Insert the steering wheel into the steering rod;
3. Put an Φ gasket;
4. Fixed with $\Phi 8$ nuts;
5. Insert the Steering wheel trim into the steering wheel;

8. Operation Instruction

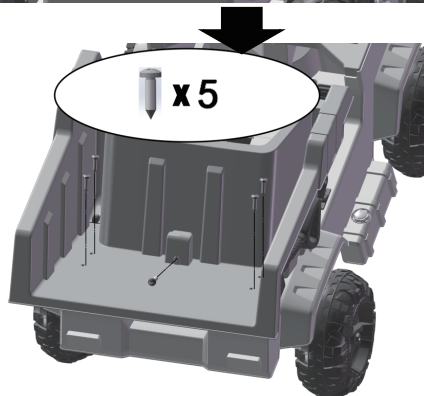
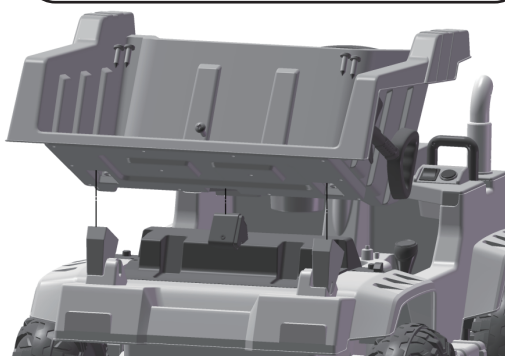

1. Insert the car bucket into the slot of the car body as shown in the picture; Fixed with M4*12 screws;

9. Operation Instruction

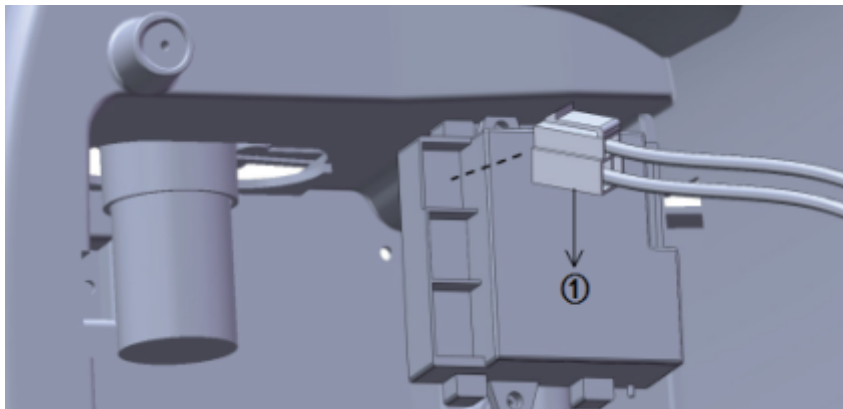

1. Find the main power wires and insert the plug-in of the wires into the slot of the receiver.

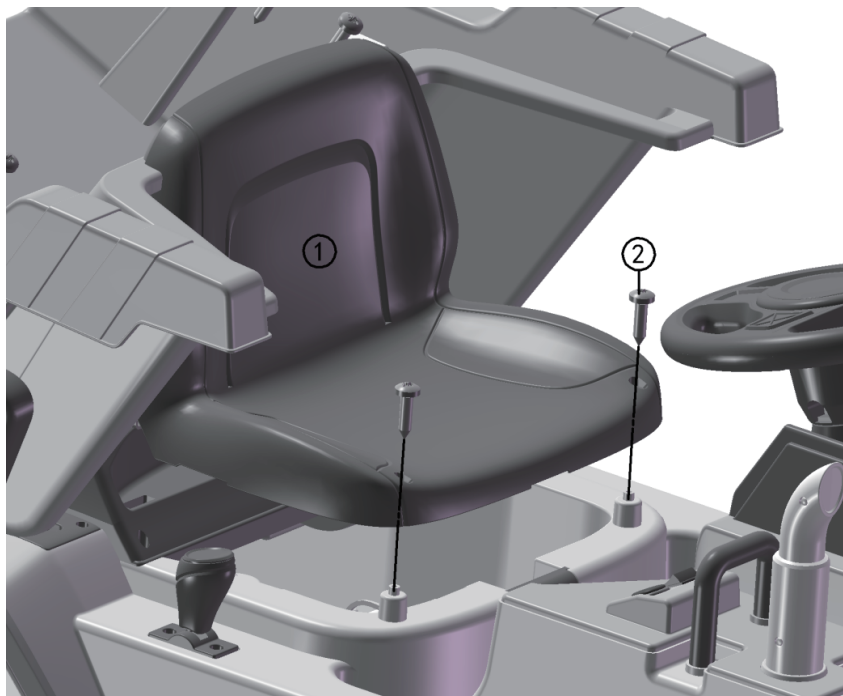

1. Insert the seat into the car body;
2. Fixed with M4*12 screws;

10. Operation Instruction

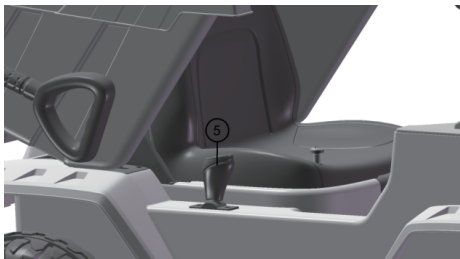
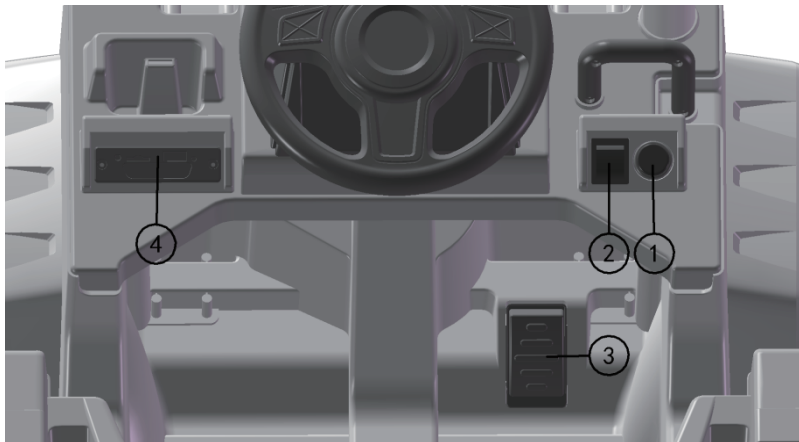

1. Power button: turn on or off the power supply of the product;
2. Forward/backward switch: control the moving direction of the product, forward or backward; Stop switch in the middle;
- 7.3. Foot pedal : step on the pedal, the car moves, release and the car will brake slowly;
4. Central control panel;
5. Car bucket switch: control bucket to rise or fall;
6. Charging hole: the charger can be connected to charge the car (please read the instructions carefully before charging);

11. Function Instruction

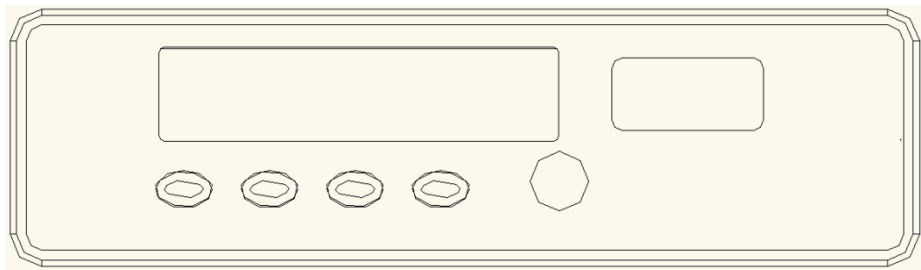

Central control panel:

- 1.Power display: Clearly see the battery power, in order to charge; the smaller the number, the lower the voltage. Please charge in time;
- 2.Last song/Volume decrease: Switch songs, and long press will decrease volume;
- 3.Play or pause switch;
- 4.Next song/Volume increase: Switch songs, and long press will increase volume;
- 5.Mode switch: press to switch mode/music mode/radio mode/bluetooth mode;
- 6.MP3: the data cable can be connected to other devices and play music;
- 7.USB: need connect your USB device;



BATTERY WARNING!

- Non rechargeable batteries can not be charged.
- Only an adult can charge and recharge the battery.
- Different types of batteries can not be mixed.
- Batteries need to be put in the right polarity.
- The exhausted battery should be removed from the toy.
- Power terminals must not be short circuited.
- Do not provide dry batteries.

12. Use the Remote Control

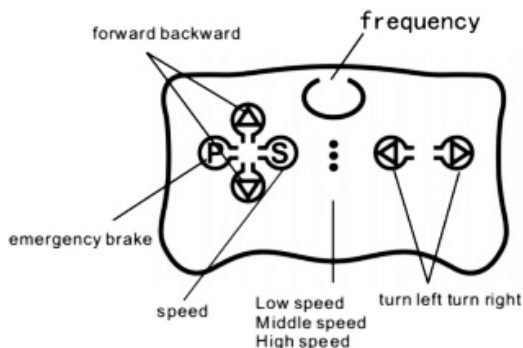

WARNING!

Only allow adult to use remote control,
can not let the children touch

Note: Batteries not included

Operation Manual : For the first time to use (Or Replace the battery)Need to bind frequency

- Take out the remote control, lift the battery compartment cover on the back of the controller and insert two AAA batteries. install the battery
- Long press on the frequency key 2-4 seconds, Low speed LED light flashing
- Turn on the power of the car, Low speed LED light keep flashing to long lighting, then frequency bind succeed
- If the frequency bind failed (Low speed LED light flashing) , remove the battery and repeat steps 1~3
- remote control without operation after 10 seconds, indication light will off into power saving mode

●Button Description: \triangle forward ∇ backward \triangleleft turn left \triangleright turn right S: Speed , P: emergency brake, Press it and the running function will fail, press again, it will release

NOTE:1.Non-rechargeable batteries are not to be recharged,

2.Different type of batteries or new and used batteries are not to be mixed ,

3.Batteries need to be inserted with the correct polarity

4.Exhausted batteries need to be removed from the toy ,

5.The supply terminals are not to be short-circuited

13. Charge

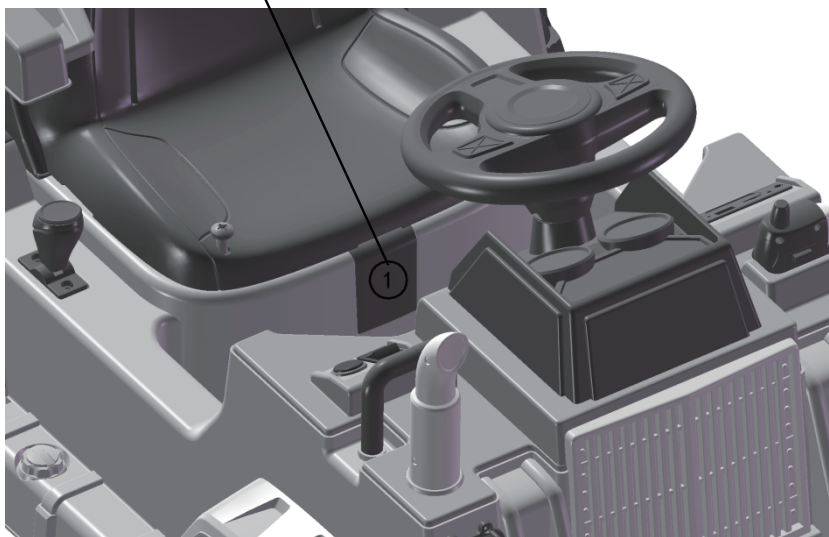
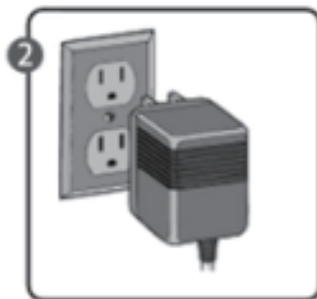
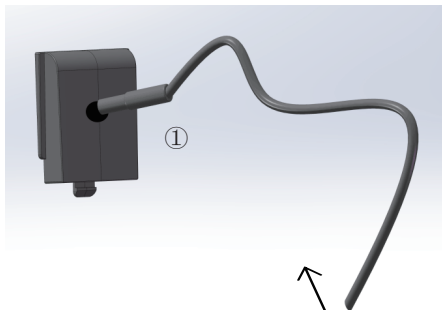

1. Insert the charger jack into the charging hole of the car.
 2. Plug the charger plug into the stable matching AC power supply as shown in the picture.
- ATTENTION:** Only an adult can charge and recharge the battery!
Please Charge the vehicle when the power less then 10.5V

14. Charging

ONLY AN ADULT CAN CHARGE AND RECHARGE THE BATTERY!

WARNING!

●**PREVENT FIRE AND ELECTRIC SHOCK:**

- Use the only rechargeable battery and charger supplied with your vehicle. NEVER substitute the battery or charger with another brand. Using another battery or charger may cause a fire or explosion.
- Do not use the battery or charger for any other product. Overheating, fire or explosion could occur.
- NEVER modify the electric circuit system.. Tampering with the electric system may cause a shock, fire or explosion or may permanently damage the system.
- Do not allow direct contact between battery terminals. Fire or explosion can occur.
- Do not allow any type of liquid on the battery or its components.
- Explosive gasses are created during charging. Do not charge near flammable materials. Charge the battery in a well-ventilated area ONLY.

-rechargeable batteries are only to be charged under adult supervision

rechargeable batteries are to be removed from the toy before being charged

Must confirm before using that following work which is already finished:

Important! Before using the vehicle for the first time, the battery needs to be charged for 4 to 6 hours , no more than 15hours. Only an adult can charge and recharge the battery.

Check all the screws, cap nuts and protective coverings regularly and tighten as required.

Rules for Safe Riding

●**Keep Children within safe riding areas:**

Never use in roadway, near motor vehicles, on lawn space , on or near steep inclines or steps swimming pools or other bodies of water;

●Use the toy only on flat surfaces. Such as inside your house, garden or playground

●Never use in the dark . A child could encounter unexpected obstacles and have an accident. Operate the vehicles only in the daytime or well-lit area.

●It is prohibited to change the circuit or add other electric parts.

●Inspect wires and connections of the vehicle periodically

●Do not let any child touch the wheels or be near them when the car is moving.

15. Maintenance of protector

Protector

This product is equipped with self-reset protector, when overloaded or improper use, self-reset protector will automatically cut off the power supply for 15-20 seconds, and then restart. The self reset protector of the car is installed under the seat.

TO avoid losing power, follow these guidelines:

- Do not overload the vehicle, maximum 66 LBS..
- Do not tow anything behind the Vehicle.
- Do not immerse water or other liquids in electrical components, such as wiring, batteries, etc
- Do not tamper with the electric system. replacement must be conducted by professionals or under the guidance of technicians.

BATTERY REPLACEMENT AND DISPOSAL

- Check the charger's wires, plugs, housing and other components before use. Stop using the charger when damage is found until it is repaired.
 - After a period of time, lubricate the parts of the vehicle with a small amount of lubricating oil to prevent wear and rust.
 - Vehicles should be placed far away from fire sources and avoid long-term illumination. Keep it flat and facing upwards, not upside down or tilted; in wet weather, parked indoors or covered with waterproof cloth.
 - Vehicles should be kept away from hot objects such as stoves and heaters. Plastic parts may melt. When charging, keep away from inflammable materials to prevent fire.
 - After use, please charge in time, charging must be adult operation. If you don't have to charge the battery for a long time, then charge it at least once a month to extend the battery life.
 - Wipe the vehicle with dry soft cloth. Non-waxy furniture polishing material can also be used instead of soft cloth to wipe plastic parts to achieve surface finish effect. Do not use chemical solvents to wipe plastic parts of toys. Do not use soap and water to clean vehicles. Do not drive in rainy or snowy weather. Water can damage motors, electrical systems and batteries.
 - When you stop using or placing the product, please cut off the power supply of the product and dial all switches to the stop or close position.
 - Please do not use fuse that is not in conformity with the specifications of this product.
- Do not alter the structure and circuit system of the product without authorization. Maintenance work must be carried out under the guidance of professional or technical personnel.

Welcome to visit our website and purchase our quality products!

Your suggestions and comments for COSTWAY are really important to us!

We sincerely solicit you to go back to our shop and leave a good rating in just a simple click. It would be quite encouraging if you could kindly do so like below:

★★★★★ Great products so far

February 24, 2019

Great products so far. Fast delivery, easy setup, and working without any issues.

**With your inspiring rating, COSTWAY will be more consistent to offer you
EASY SHOPPING EXPERIENCE, GOOD PRODUCTS and EFFICIENT SERVICE!**

US office: Fontana, California

UK office: Ipswich



- * Reward Points
- * Exclusive Customer Service
- * Personalized Recommendations
- * Permanent Shopping Cart
- * Order History

5 Star Rating



We would like to extend our heartfelt thanks to
all of our customers for taking time to assemble
this product and giving us valuable feedbacks.

THANK
YOU
😊

