

142*210MM

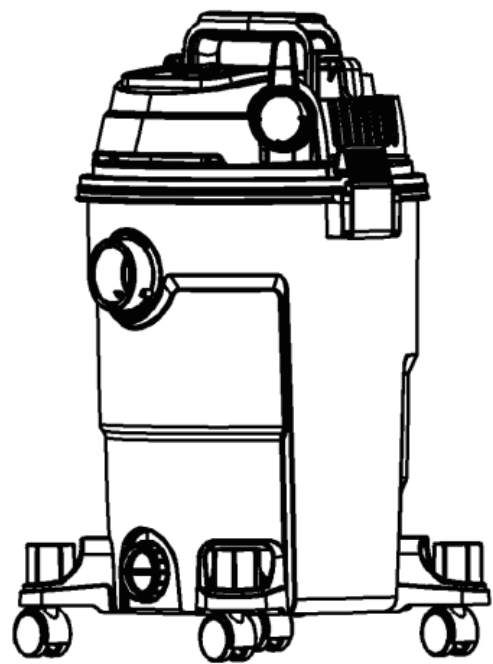

USER'S MANUAL
Vacuum cleaner
EP24963

Congratulations on the purchase of this high-quality product. Please read this operating instruction attentively, before you take the appliance in operation. It gives important notes for security, the use and maintenance of the appliance. If you have further questions, please contact our customer service.

Contents:

- Description of the appliance
- Appliance figure
- Important safety instructions
- Assembly
- Operation
- Cleaning and maintenance
- Error detection
- Technical data
- Circuit illustration

Description of the appliance:

- Powerful and compact.
- Wet & Dry
- Multiple air filter system guarantees a hygienic cleaning.
- With special air-blowing function.
- Special parking position for easy use and space saving.
- Airflow control on handle.
- Rotary wheels facilitate moving and running.
- Divers accessories.
- User-friendly design.

Appliance figure:

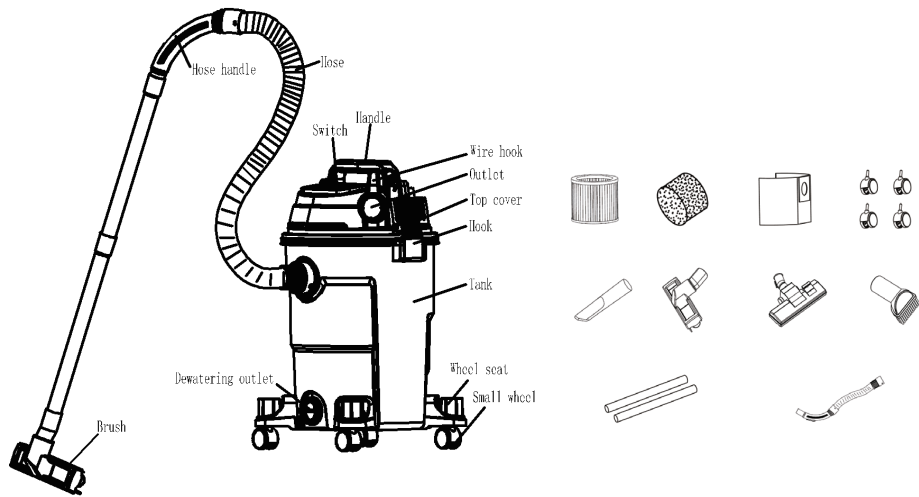

Important safety instructions:

If the supply cord is damaged, it must be replaced by a special cord or assembly available from the manufacturer or its service agent .

This appliance is not intended for use by persons(including children)with reduced physical, sensory or mental capabilities or lack of experience and knowledge, unless they have been given supervision or instruction concerning use of the appliance by a person responsible for their safety. Children should be supervised to ensure that they do not play with the appliance.

01

	Do not vacuum any sharp-edged, hot or incandescent materials.	
	The appliance should not be exposed to heat.	
	Unplug the appliance from the mains supply socket after use and before every cleaning. Pull the plug instead of the power cord to disconnect the appliance from the mains.	
	Do not put any object into openings. Do not use with any opening blocked. Keep free of dust, lint, hair etc.	
	Do not use the vacuum cleaner without dust container or dust filter in place.	
	Do not vacuum any flour, cement etc, in order to avoid the overloads.	
	The appliance should only be cleaned with a dry or damp cloth; it should never be immersed in water. Do not use any solvents for cleaning.	
	This appliance is intended for domestic use only and cannot be used for commercial applications.	
	Avoid the nozzle or brush touching the surface of the furniture.	
	Do not use the power cord to carry the appliance. Do not pull the power cord over sharp edges.	

02

Assembly:

Assemble the wheels to the tank base, then fixed with screws.	
Tank: Attach the head onto tank.	
Flexible hose: To use the flexible hose, insert the end of the hose into the suction hole. Make sure to snap it into the place.	
Accessories: Choose your desired accessory (brush or nozzle) and attach it to the suction hole.	

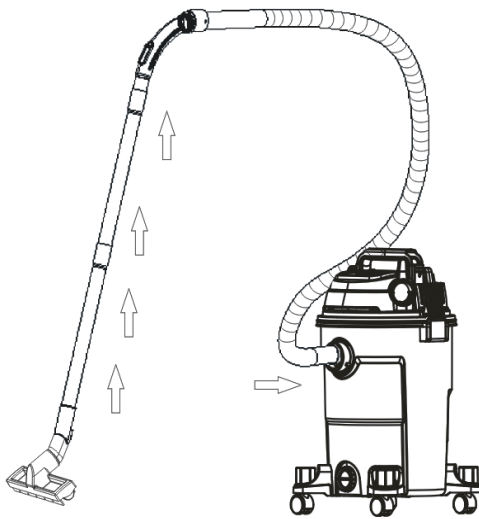

03

Operation:

	Before you start the appliance, make sure that the hose assembly is in the position, or else the appliance had mangled.
	Fix the hose into position ① for dust cleaning function. Fix the hose into position ② for air blowing function.
	Unwind the power cord.
	Plug in the appliance and switch on.
	Unplug the appliance after use.

Attach the desired accessories to the vacuum cleaner.

04

Cleaning and maintenance:
Paper bag:

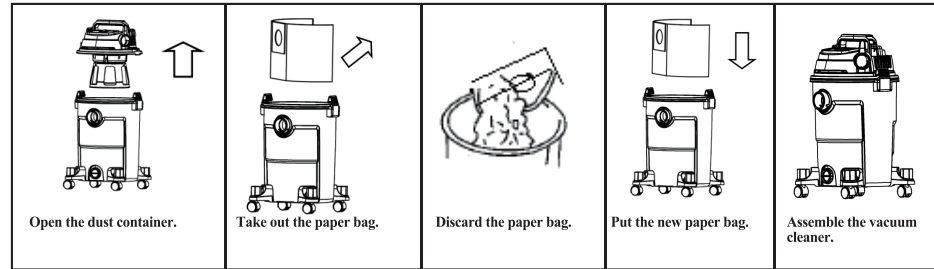

HEPA filter:

1 Open the dust container.	5 If necessary, rinse the dust filter with cleaning water.
2 Take out the HEPA filter.	6 Dry up the HEPA filter.
3 Clean the HEPA Filter by knocking off the ash.	7 Reassemble the vacuum cleaner.
4 Empty the dust container.	

05

Error detection:

Before you contact our service center, please check the following:

Problem	Possible reason	Advice
Motor does not start	-Power cord not firmly plugged into outlet. -Outlet damaged. -Cleaner not switched on.	-Plug unit firmly. -Check the Outlet. -Switch on the appliance
Suction power is weaker	-Unit clogged -Paper filter needs to be replaced	-Remove the blockage. -Replace the paper filter.

Guarantee:

This product is guaranteed for a period of one year from the date of purchase. During this period we will remedy all defects free of charge, which can be demonstrably attributed to material or manufacturing defects, by repair or exchange.

This guarantee is only valid if the appliance has been used in accordance with the instructions and provided that it has not been modified, repaired or interfered with, by any unauthorized person, or damaged through misuse.

Correct Disposal of this product



This marking indicates that this product should not be disposed of with other household wastes throughout the EU. To prevent possible harm to the environment or human health from uncontrolled waste disposal, recycle it responsibly to promote the sustainable reuse of material resources. To return your used device, please use the return and collection systems of contact the retailer where the product was purchased. They can take this product for environmental safe recycling.

Rated voltage: 120V AC

Rated frequency: 60Hz

Rated power: 10A 1200W

Operating pressure: ≥ 16 kPa

Sound level: <84dB(A)

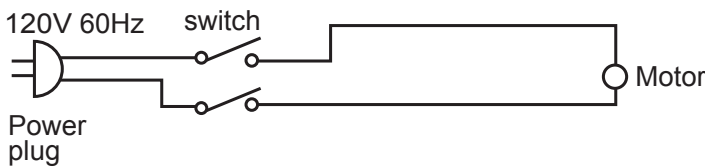

06



With your inspiring rating, COSTWAY will be more consistent to offer you EASY SHOPPING EXPERIENCE, GOOD PRODUCTS and EFFICIENT SERVICE!

Mit Ihrer inspirierenden Bewertung wird COSTWAY konsistenter sein, um Ihnen EIN SCHÖNES EINKAUFSERLEBNIS, GUTE PRODUKTE und EFFIZIENTEN SERVICE zu bieten!

Avec votre évaluation inspirante, COSTWAY continuera à fournir une EXPÉRIENCE D'ACHAT PRATIQUE, des PRODUITS DE QUALITÉ et un SERVICE EFFICACE !

Con su calificación inspiradora, COSTWAY será más consistente para ofrecerle EXPERIENCIA DE COMPRA FÁCIL, BUENOS PRODUCTOS y SERVICIO EFICIENTE.

Con la tua valutazione incoraggiante, COSTWAY sarà più coerente per offrirti ESPERIENZA DI ACQUISTO FACILE, BUONI PRODOTTI e SERVIZIO EFFICIENTE!

Dzięki twojej opinii COSTWAY będzie mógł oferować jeszcze WYGODNIEJSZE ZAKUPY, LEPSZE PRODUKTY i SPRAWNIEJSZĄ OBSŁUGĘ KLIENTA.

US office: Fontana
UK office: Ipswich
DE office: FDS GmbH, Neuer Hältigbaum 36, 22143 Hamburg, Deutschland
FR office : 26 RUE DU VERTUQUET, 59960 NEUVILLE EN FERRAIN, FRANCE

