

COSTWAY

USER'S MANUAL

kids Battery-Powered Ride On Car TQ10037

THIS INSTRUCTION BOOKLET CONTAINS **IMPORTANT** SAFETY INFORMATION. PLEASE READ AND KEEP FOR FUTURE REFERENCE.

Please give us a chance to make it right and do better!

Contact our friendly customer service department for help first.

Replacements for missing or damaged parts will be shipped ASAP!

Follow Costway



Contact Us!

Do NOT return this item.

Contact our friendly customer service department for help first.



Before You Start

Please read all instructions carefully and keep it for future reference.

Warnings:

Attention! Use it with protective equipment.

Attention! Not use it in the traffic.

Attention! The product is not suitable for the children under 3 years.

General Warnings:

- ⚠ The product must be installed and used under the supervision of an adult.
- ⚠ Read through each step carefully and follow the proper order.
- ⚠ Remove all packaging, separate and count all parts and hardware.
- ⚠ Please ensure that all parts are correctly installed, incorrect installation can lead to a danger.
- ⚠ We recommend that, where possible, all items are assembled near to the area in which they will be placed in use, to avoid moving the product unnecessarily once assembled.
- ⚠ Ensure a secure surface during construction, and place the product always on a flat, steady and stable surface.
- ⚠ Please use the product carefully, as the product requires great skill, avoid accidents by the user or others, by fall or collision.
- ⚠ Please wear suitable protective equipment during use, e.g. protective helmet, gloves, knee pads, elbow pads etc.

- ◎ **Suitable age for 3+ Years**
- ◎ **Maximum user weight: 77lbs.**
- ◎ **Adult assembly required**

This diagram is for reference only

OWNER'S MANUAL

with Assembly Instructions

Read and understand this entire manual before using!

**Please keep this manual for future reference as it contains important information
time use, charge the battery for at least 4-6 hours.**

On the purchase of your new Ride-On



“Maserati”, **MASERATI** , and the design of the enclosed product are subject to intellectual property protection owned by Daimler AG. They are used by Pinghu Little Sun Childs Vehicles CO , LTD

Specification

Suitable age:	3+ Years
Battery:	12V4.5AH x1
Charge time:	8~12 hours
Charge:	Input: depend on local voltage Output: 12V 900mA
Load capacity:	Under 77 LBS
Size of car:	48" x 28.5" x 19.5"
Speed:	3~5 km/h

BATTERY INFORMATION

- Non-rechargeable batteries are not to be recharged.
- If removable rechargeable batteries are used, they are only to be charged under adult supervision.
- Remove rechargeable batteries from the product before charging.
- Do not mix old and new batteries. Do not mix different types of batteries: alkaline, standard (carbon-zinc) or rechargeable (nickel-cadmium).
- Insert batteries as indicated inside the battery compartment, anode to anode, cathode to cathode.
- Remove batteries during long periods of non-use. Always remove exhausted batteries from the product. Battery leakage and corrosion can damage this product. Dispose of batteries safely.
- Never short circuit the battery terminals.

Parts List

Number	Name	Quantity
1	Windshield	1
2	Seat	1
3	Steering wheel	1
4	Reflector	2
5	Wheel	4
6	Wheel hub	4
7	Remote control	1
8	Charger	1
9	Sleeve wrench	2
A/F	Ø12 gasket	6-7
B	M10 nut	4-5
C	M4×12 screw	2-4
D	M5 screw	1
E	M5 nut	1

Assembly tools required:

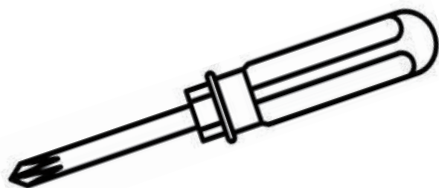

Screwdriver
(not included)



Sleeve wrench
(included)

Parts Diagram

NOTE: Some parts shown are assembled on both sides of vehicle

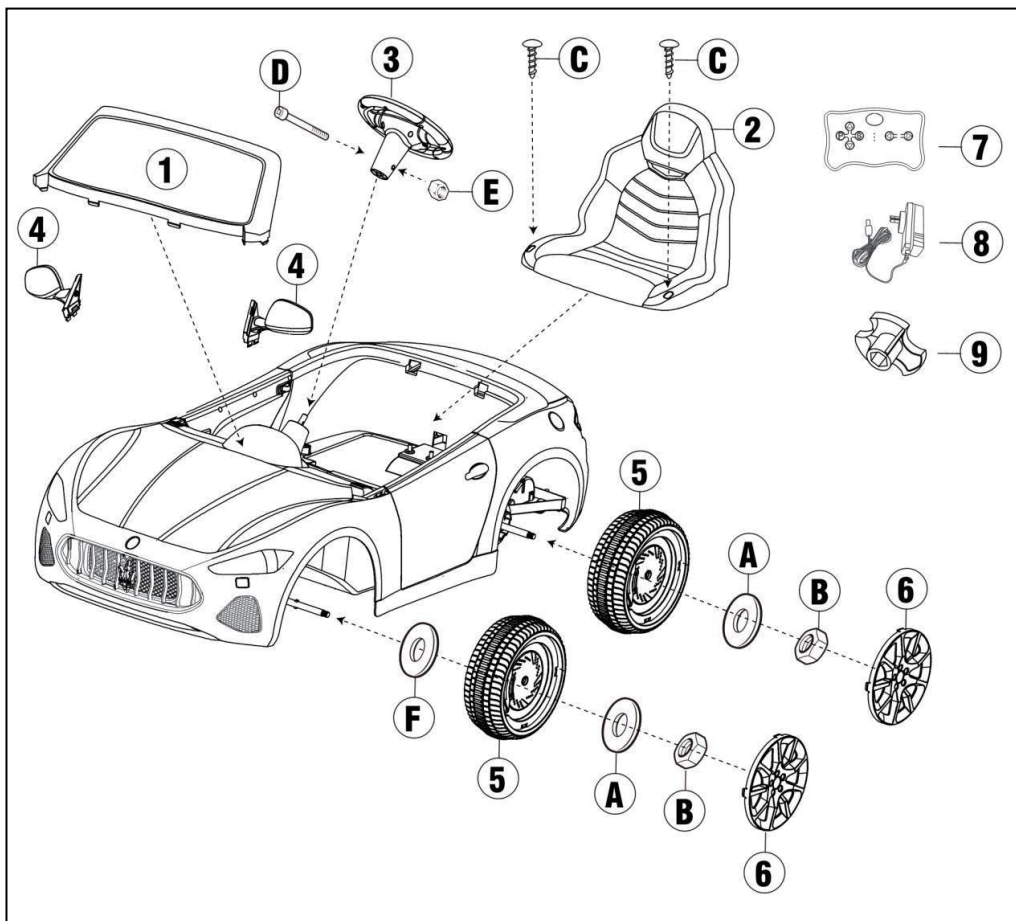

Safety



PREVENT INJURIES AND DEATHS:

● **NEVER LEAVE CHILD UNATTENDED. ADULT DIRECT SUPERVISION IS REQUIRED.** Always keep child in view when child is in vehicle.

● This toy should be used with caution since skill is required to avoid falls or collisions causing injury to the user or third parties.

● Protective equipment should be worn.

● Never use in roadways, near cars, on or near steep inclines or steps, swimming pools or other bodies of water.

● Always wear shoes, always sit on the seat.

● Not to be used in traffic.

● This toy is unsuitable for children under 36 months due to its maximum speed; Maximum user weight is 77 lbs.

● This toy has no brake.



WARNING:

● **CHOKING HAZARD!** NOT suitable for children under 37 months.

● **ADULT ASSEMBLY REQUIRED.**

Rules for Safe Riding

- Keep children within Safe Riding Areas:
Never use in roadway near motor vehicles, on lawn space, on or near steep inclines or steps, swimming pools or other bodies of water;
- Use the toy only on flat surfaces. Such as inside your house, garden or playground.
- Never use in the dark. A child could encounter unexpected obstacles and have an accident. Operate the vehicle only in the daytime or a well-lit area.
- It is prohibited to change the circuit or add other electric parts.
- Inspect wires and connections of the vehicle periodically.
- Do not let any child touch the wheels or be near them when the car is moving.
- This vehicle has adjustable play seat belts. Please instruct children how to tie the safety belt before use to guarantee the security.

Operation Instruction

(A) Install the front and rear driving wheel

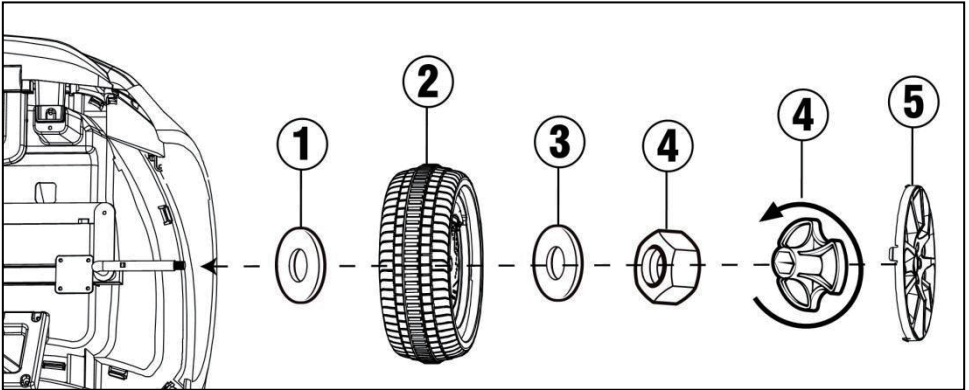

Turn the car upside down

1. Put an Ø12 gasket into the front axle
2. Install a front wheel
3. Put an Ø12 gasket again after the wheel
4. Use a sleeve wrench to fix the M10 nut
5. Install the wheel hup

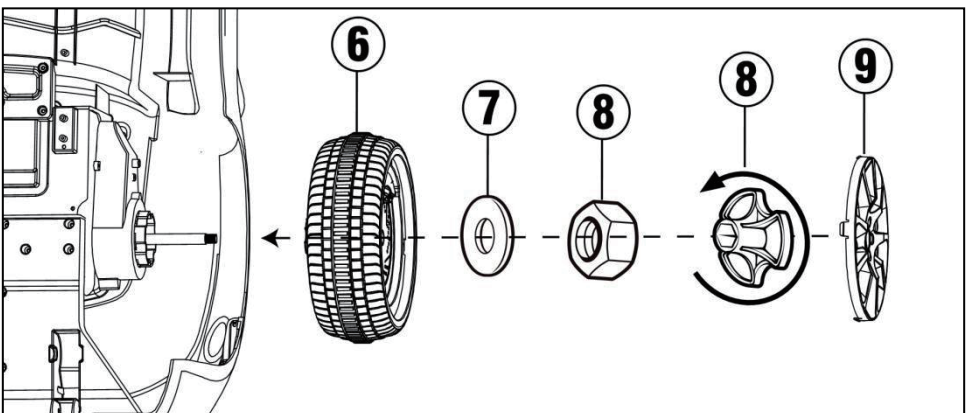

6. Put the driving wheel on the rear axle
7. Put an Ø12 gasket into the rear axle
8. Use a sleeve wrench to fix the driving wheel with screw
9. Install the wheel hub

Use the same way to install the wheel on the other side

(B) Install the steering wheel and windshield

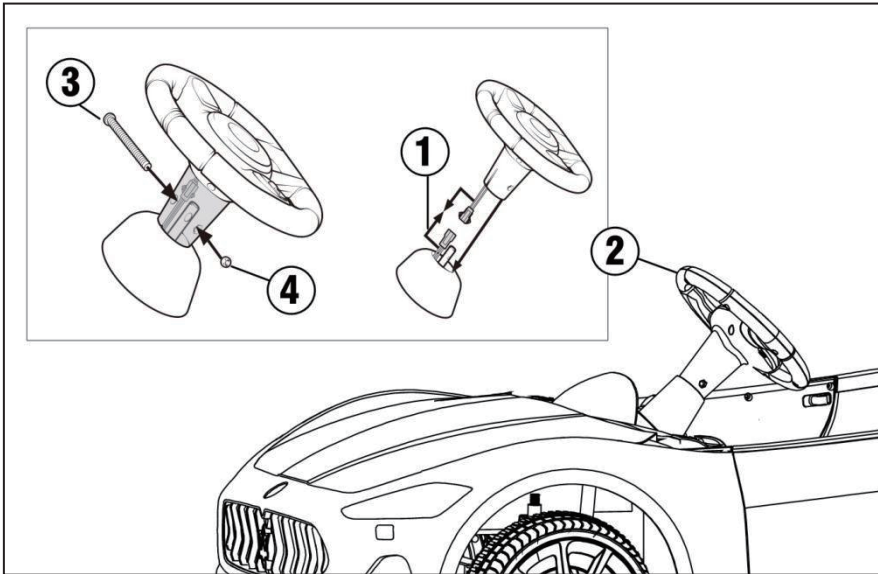

1. Remove the M5*37 screw and M5 nut, then connect the steering wheel line with the main body line
2. Install the steering wheel to the end of the steering rod; align the hole on the steering wheel and the hole on the steering rod
3. Insert M5*37 screw
4. Twist the M5 nut on the other side
5. Insert the reflector into the hole of the right and left hole of the car body (notice that the reflector has a right or left side)
6. Fix the windshield into the hole of the car body

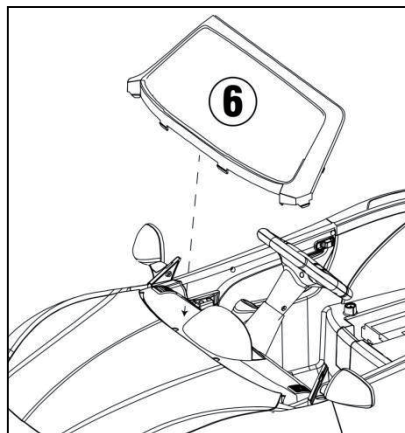
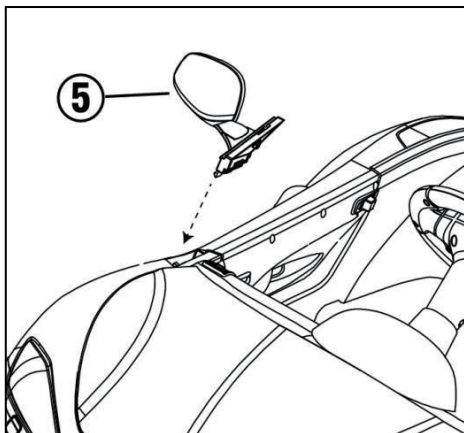

(C) Install the Reflector and connect the battery

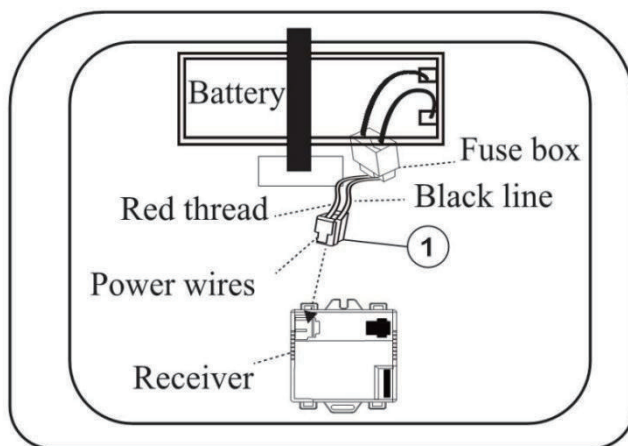

1. Find out the main power cord and insert the plug-in into the corresponding socket of the receiver.

(D) Install the seat

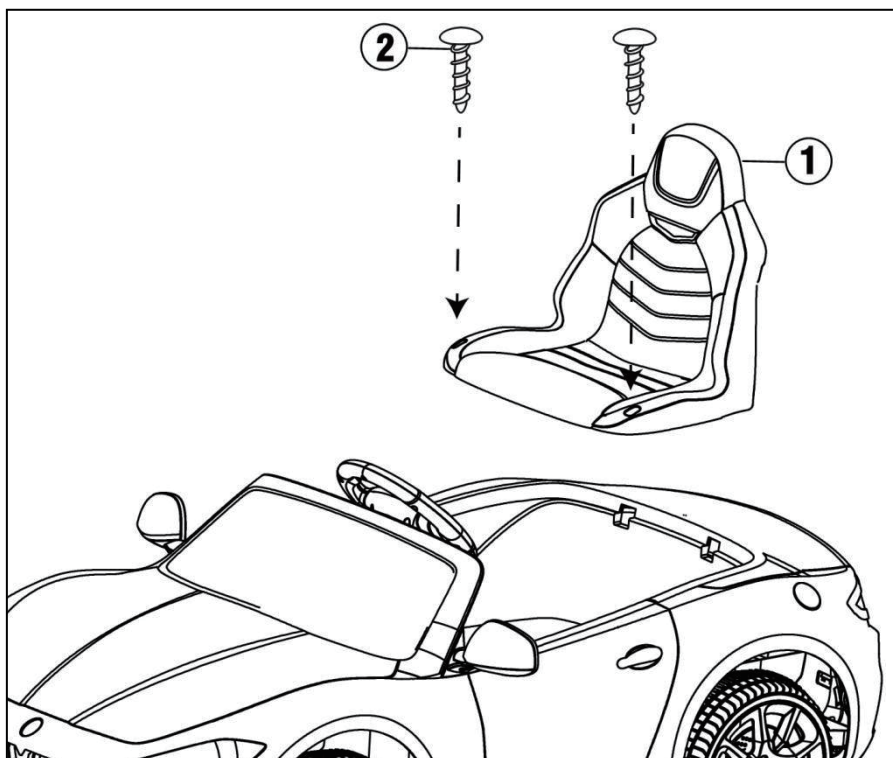

1. Install and fix the seat
2. Fix the seat with M4*12 screw

(E) Function

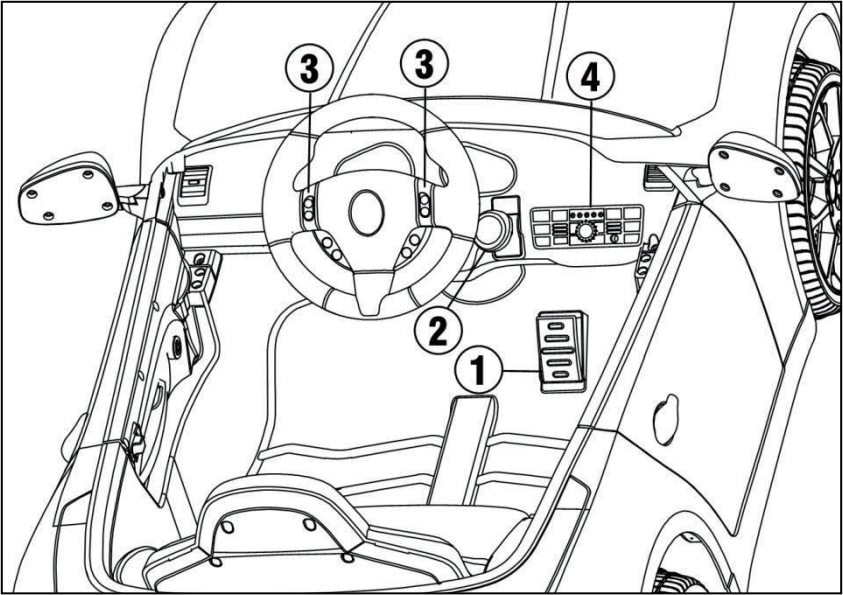

1. Pedal button: Step on the button , the car will move when release,the car will slowly stop .
2. Shift switch: Change the direction of the car , Forward-Backward
3. Horn sound button: Press it for horn sounds .
4. Control board:

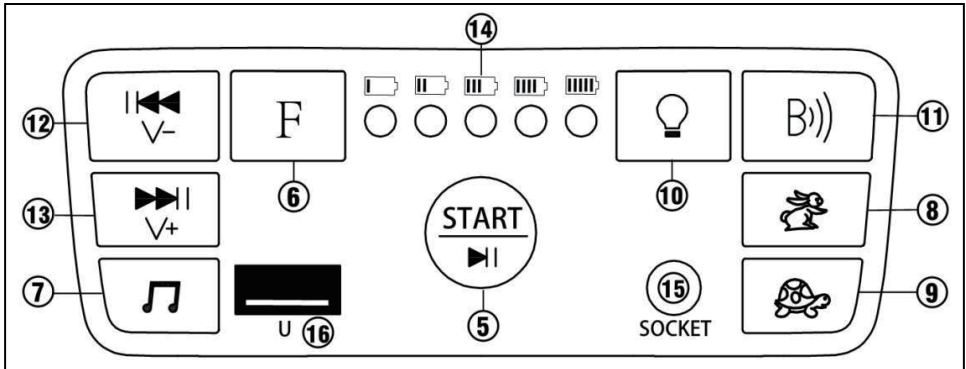

5. Power button: Long press it for 3 seconds, turn the vehicle on and off
6. F: Radio, long press it for 2-3 seconds, the light of FM button will flash and search automatically, when the search completes, the FM key stops flashing
7. Music button: Play music
8. High speed button: Change the speed of the car more quickly
9. Slow speed button: Change the speed of the car more slowly
10. Light button : Turn on or off the light
11. Wireless Technology: After connecting your mobile phone and the wireless device, the car can play music from your mobile phone
12. Last song: Switch songs, and long press will increase volume
13. Next song: Switch songs, and long press will decrease volume
14. Power display: Clearly see the battery power, in order to charge in time.
15. Socket : Charge
16. USB port

Use the Remote Controller

NOTE: This product does not included the AAA(1.5v) batteries. Only adults are allowed to use the remote control, and children are not allowed to touch it.

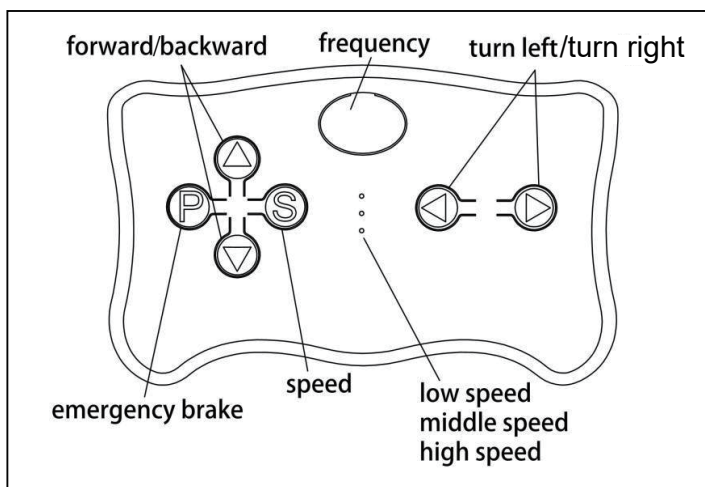

Operation manual: frequency binding is required for the first use (or after replacing the battery).

1. Take out the remote control, lift the battery compartment door on the back of the controller and insert two AAA batteries. install the battery
2. Long press on the frequency key 2-4 seconds, Low speed LED light flashing
3. Turn on the power of the car, if the low-speed LED light keeps flashing until it stays on, then the frequency binding is successful.
4. If the frequency binding failed (Low speed LED light flashing) , remove the battery and repeat steps 1~3
5. If the remote control is not operated for 10 seconds, the indicator light will go out and enter the power saving mode.
6. Button description: \triangle forward ∇ backward \triangleleft turn left \triangleright turn right
S: Speed , P: emergency brake, press it and the running function will fail, press again, it will release.

NOTE: Non-rechargeable batteries are not to be recharged
Different type of batteries or new and used batteries are not to be mixed
Batteries are to be inserted with the correct polarity
Exhausted batteries are to be removed from the toy
The supply terminals are not to be short-circuited

Charge&PULL HANDLE

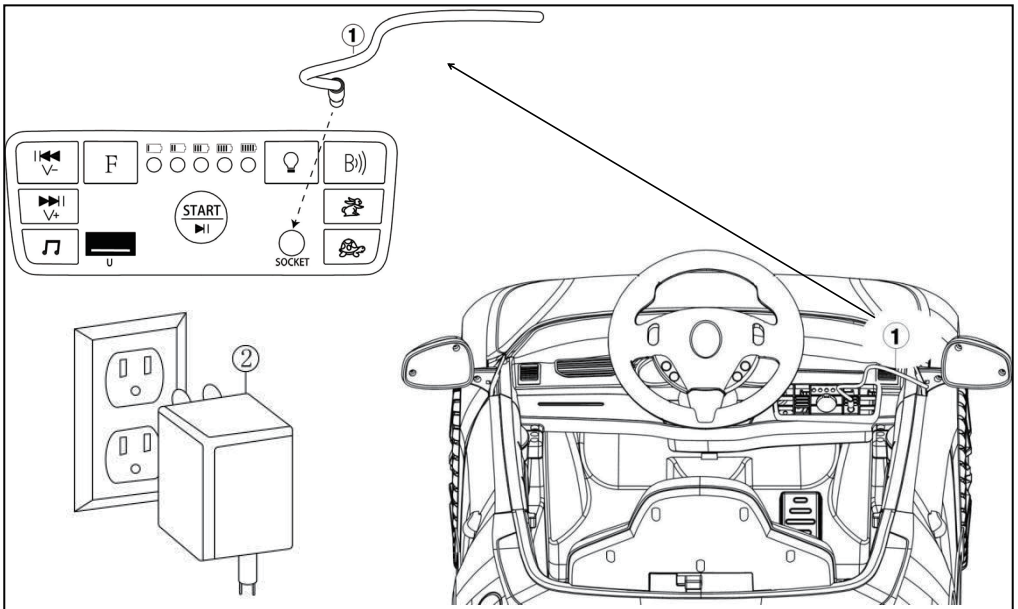

ONLY AN ADULT CAN CHARGE AND RECHARGE THE BATTERY!

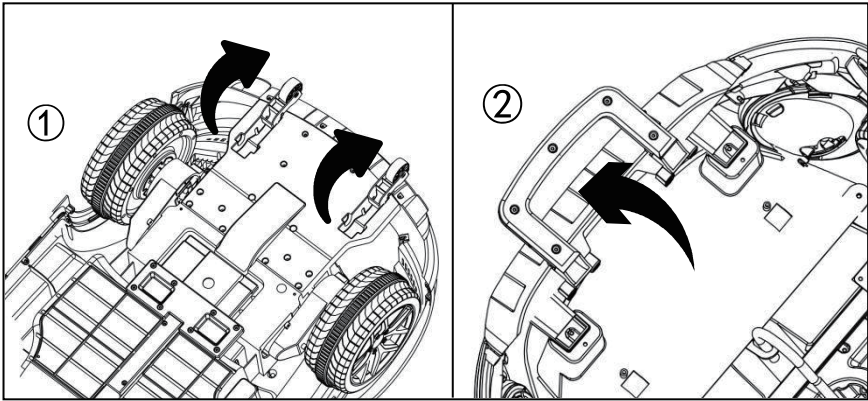

HOW TO USE THE PULL HANDLE

1. Rotate the support wheels out.
2. Rotate the Pull handle out.
3. You can move the vehicle by pulling.

Charging

ONLY AN ADULT CAN CHARGE AND RECHARGE THE BATTERY!

WARNING!

● **PREVENT FIRE AND ELECTRIC SHOCK:**

- Use the only rechargeable battery and charger supplied with your vehicle. NEVER substitute the battery or charger with another brand. Using another battery or charger may cause a fire or explosion.
 - Do not use the battery or charger for any other product. Overheating, fire or explosion could occur.
 - NEVER modify the electric circuit system. Tampering with the electric system may cause a shock, fire or explosion or may permanently damage the system.
 - Do not allow direct contact between battery terminals. Fire or explosion can occur.
 - Do not allow any type of liquid on the battery or its components.
 - Explosive gasses are created during charging. Do not charge near or flammable materials. Charge the battery in a well-ventilated area ONLY.
 - Rechargeable batteries are only to be charged under adult supervision. Rechargeable batteries are to be removed from the toy before being charged. Must confirm before using that following work which is already finished. Important! Before using the vehicle for the first time, the battery needs to be charged for 4 to 6 hours, no more than 10 hours. Only an adult can charge and recharge the battery.
- Check all the screws, cap nuts and protective coverings regularly and tighten as required.

- Rules for Safe Riding

● Keep Children within safe riding areas:

Never use in roadway, near motor vehicles, on lawn space, on or near steep inclines or steps, swimming pools or other bodies of water;

- Use the toy only on flat surfaces. Such as inside your house, garden or playground.
- Never use in the dark. A child could encounter unexpected obstacles and have an accident. Operate the vehicles only in the daytime or well-lit area.
- It is prohibited to change the circuit or add other electric parts.

- Inspect wires and connections of the vehicle periodically.
- Do not let any child touch the wheels or be near them when the car is moving.

NEVER pick up the battery by the wires or charger. Damage can occur to the battery and may cause a fire. Pick up the battery by the case ONLY.

- Charge the battery in a dry area ONLY.

- Battery posts, terminals and related accessories contain lead and lead compounds, chemicals known to the State of California to cause cancer and reproductive harm. **Wash hands after handling.**
- Do not open the battery. Battery contains lead acid and other materials that are toxic and corrosive.
- Do not open the charger. Exposed wiring and circuitry inside may cause electric shock. Only adults may handle or charge the batter. NEVER allow child to handle or charge the battery. Battery is heavy and contains lead acid (electrolyte).
- Do not drop the battery. Permanent damage to the battery could occur or cause serious injury.
- Before charging the battery, check for wear or damage to the battery, charger, its supply cord and the connectors. DO NOT charge the battery if any damage to parts has occurred.
- Do not allow the battery to drain completely. Recharge the battery after each use or once a month if not used regularly.
- Do not charge battery upside down.
- Always secure the battery with bracket, Battery can fall out and injure a child if vehicle tips over.
- The POWER SWITCH must be turned in OFF position when charging.
- Before the first use, you should charge the battery for 4-6 hours. Do not recharge the battery for more than 10 hours to avoid overheating the charger.

- When the vehicle begins to run slowly, recharge the battery.
- After each use or once a month minimum recharge times as 8 to 12 hours, less than 20 hours at most.

Battery Replacement Charging

If the fuse is broken, there has a spare fuse in the fuse box under the seat or behind the body of the car. Replace and restart.

To avoid losing power , follow these guidelines:

- Do not overload the vehicle.
- Do not tow anything behind the vehicle.
- Do not drive up steep slopes.
- Do not drive into fixed objects, which may cause the wheels to spin, causing the motor to overheat.
- Do not drive in very hot weather, components may overheat.
- Do not allow water or other liquid to come in contact with the battery or other electric components.
- Do not tamper with the electric system. Doing so may create a short-circuit, causing the fuse to trip.

Battery Replacement and Disposal

The battery will eventually lose the ability to hold a charge . Depending on the amount of use , and varying conditions, the battery should operate for one to three years. Follow these steps to replace an dispose the battery:

1. Remove the car seat .
 2. Disconnect the battery connectors.
 3. Remove the metal battery bracket.
 4. Remove the battery cover
 5. Carefully lift the battery
- Depending on the condition of the battery (i.e.: leakage) you may want to wear protective gloves before removal.

- Do not lift the battery by its connectors or cables
- 6. Place the dead battery in a plastic bag.
Important! Recycle the dead battery responsibly. The battery contain lead(electrolyte) and must be disposed of properly and legally. It is illegal in most areas to incinerate lead acid batteries or dispose of them in landfills. Take it to a federal or state-approved lead acid battery recycler, such as local automotive battery retailer.
Do not throw the battery away with your regular household waste!
- 7. Replace the battery and reconnect the connectors.
- 8. Replace the metal battery bracket.
- 9. Replace the seat.

Troubleshooting Guide

Problem	Possible Cause	Solution
Vehicle does not run	Battery low on power	Recharge battery.
	Thermal fuse has tripped	Reset fuse, see <Fuse>
	Battery connector or wires are loose	Check that the battery connectors are firmly plugged into each other. If wires are loose around the motor contact our customer service please.
	Battery is dead	Replace battery, contact our customer service please.
	Electrical system is damaged	Contact our customer service please.
	Motor is damaged	Contact our customer service please.
Vehicle does not run very long	Battery is under charged	Check that the battery connectors are firmly plugged into each other when recharging
	Battery is old	Replace battery, contact our customer service please.
Vehicle runs sluggishly	Battery low on power	Recharge battery, contact our customer service please.
	Battery is old	Replace battery, contact our customer service please.
	Vehicle is overload	Reduce weight on vehicle.
	Vehicle is being used in harsh conditions	Avoid using vehicle in harsh conditions, see <Safety>.
Vehicle needs a push to go forward	Poor contact of wires or connectors	Check that the battery connectors are firmly plugged into each other. If wires are loose around the motor, contact our customer service please.
	"Dead Spot" on motor	A dead spot means the electric power is not being delivered to the terminal connection and the vehicle needs repair. Contact our customer service please.
Difficult shifting from forward to reverse or vice-versa	Attempting to shift while the vehicle is in motion	Completely stop the vehicle and shift, see <Use Your Ride-On>
Loud grinding or clicking noises coming from motor or gear box	Motor or gears are damaged	Contact our customer service please.
Battery will not recharge	Battery connector or adapter connector is loose	Check that the battery connectors are firmly plugged into each other.
	Charger not plugged in	Check that the battery charger is plugged into a working wall outlet.
	Charger is not working	Contact our customer service please.
Charger feels warm when recharging	This is normal and not a cause for concern	

Completely read through this manual and the troubleshooting guide table before calling. If you still need help resolving the problem **Contact our customer service please.**

Maintaining & Fuse

- It is parents' responsibility to check main parts of the toy before using. Must regularly examine for potential hazard, such as the battery, charge, cable or cord, plug, screws are fastening enclosure of other parts and that in the event of such damage, the toy must not be until that damage had been properly removed.

Make sure the plastic parts of the vehicle are not cracked or broken.

- Occasionally use a lightweight oil to lubricate moving parts such as wheels.
- Park the vehicle indoors or cover it with a tarp to protect it from wet weather.
- Keep the vehicle away from sources of heat, such as stoves and heaters. Plastic parts may melt.
- Recharge the battery after each use. Only an adult can handle the battery. Recharge the battery at least once a month when the vehicle is not being used.
- Do not wash the vehicle with a hose. Do not wash the vehicle with soap and water. Do not drive the vehicle in rainy or snowy weather. Water will damage the motor, electric system and battery.
- Clean the vehicle with a soft, dry cloth. To restore shine to plastic parts, use a non-wax furniture polish. Do not use car wax. Do not use abrasive cleaners.
- Do not drive the vehicle in loose dirt, sand or fine gravel which could damage moving parts, motors or the electric system.

When not using, all the electrical source should be turned off. Turn off the power switch and disconnect the battery connection

FCC Statement

Caution:

This device complies with Part 15 of the FCC Rules. Operation is subject to the following two conditions: (1) this device may not cause harmful interference. (2) this device must accept any interference received, including interference that may cause undesired operation.

Changes or modifications not expressly approved by the party responsible for compliance could void the user's authority to operate the equipment.

This equipment has been tested and found to comply with the limits for a Class B digital device, pursuant to part 15 of the FCC Rules. These limits are designed to provide reasonable protection against harmful interference in a residential installation. This equipment generates uses and can radiate radio frequency energy and, if not installed and used in accordance with the instructions, may cause harmful interference to radio communications. However, there is no guarantee that interference will not occur in a particular installation. If this equipment does cause harmful interference to radio or television reception, which can be determined by turning the equipment off and on, the user is encouraged to try to correct the interference by one or more of the following measures:

- Reorient or relocate the receiving antenna.
- Increase the separation between the equipment and receiver.
- Connect the equipment into an outlet on a circuit different from that to which the receiver is connected.
- Consult the dealer or an experienced radio/TV technician for help.

