

COSTWAY<sup>®</sup>

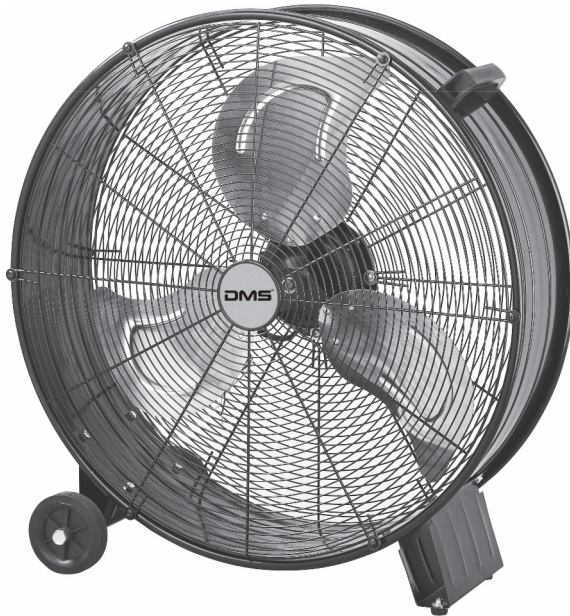

## USER'S MANUAL

### Drum Fan ES10117US

THIS INSTRUCTION BOOKLET CONTAINS **IMPORTANT** SAFETY INFORMATION. PLEASE READ AND KEEP FOR FUTURE REFERENCE.

# Notes

Before first use, always read the safety instructions and warnings included in this guide.

Failure to observe the below mentioned safety warnings and safety guidelines may cause electric shock, fire and/or serious injuries.

Keep safety instructions and warnings at hand for future reference.

---

## GENERAL SAFETY GUIDELINES

This appliance is not intended for use by children under the age of 8 without assistance or supervision, or other persons if their physical, sensory or mental capabilities prevent them from using it safely or by persons without experience and knowledge on the use. People using this product must understand the risks related to the use of the appliance. Do not allow children to use the appliance as a toy. Cleaning and maintenance by children without supervision is not allowed. Children are not aware of dangers that may arise during the use of electric devices. Keep the appliance and corresponding cord out of the reach of children under the age of 8. Children should be supervised to ensure that they do not play with the appliance.

1. Do not operate the appliance with a damaged cord.
2. Damaged power cord must be replaced by manufacturer or other qualified persons in order to avoid risk.
3. The plug must fit the socket.
4. The plug must not be modified in any way.
5. Do not allow the power cord to touch sharp edges or hot surfaces. Damaged cord poses a risk of electric shock.
6. Do not place the appliance on hot surfaces.
7. Do not use outside. Do not expose to rain. Protect against humidity. Do not operate with wet hands.
8. During operation, keep clothing and long hair away from the moving parts of the appliance.
9. Do not plug the device in unless it is fully assembled.
10. Do not use the device with broken or damaged blades.
11. Do not remove any parts of the housing.

12. Do not use the device in the immediate vicinity of a bathtub, shower or swimming pool.
13. Prevent the cord and plug from any contact with water or moisture. Do not spray any liquid on the device.
14. Unplug the device holding the plug; do not pull the cord.
15. Unplug the device if it is to be moved or is not going to be used for a longer time.
16. Do not use the device with the protection grid removed.
17. Transport in an original package protecting from mechanical damages.
18. The appliance must be repaired by a qualified person using only original spare parts.
19. Despite operating the unit in accordance with its intended use and in accordance with all safety guidelines, it is impossible to eliminate all residual risk factors.
20. The appliance is intended for home use only.
21. The appliance should only be used for private use, as intended for the appliance. This appliance is not intended for commercial use.
22. Before assembly and disassembly of the device, always make sure that it is disconnected from its power source.

---

## Parts List

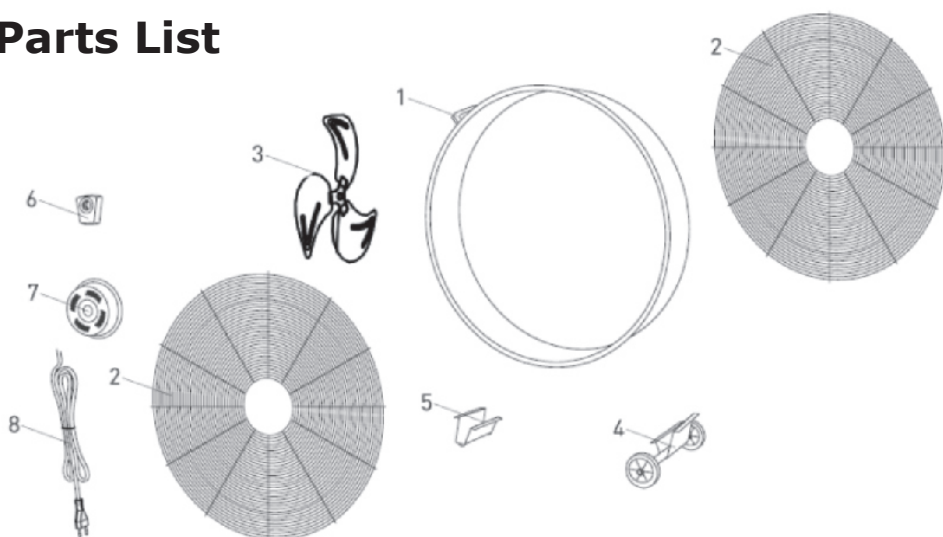

1	Drum hoop with handle	5	Support
2	Protection grid	6	Switch
3	Fan blade	7	Motor
4	Wheel	8	Power cord

-----

**Cleaning and care:** Before starting the maintenance, ensure the fan is unplugged. Clean the fan with moist (never wet) cloth with a neutral detergent. Do not use petrol or other solvents.

**Maintenance and storage:** Before putting the device away, wait until it cools down. Keep and store in a package protecting from humidity and mechanical damages.

**Troubleshooting:** If the fan does not start, check the power supply. Repairs must be carried out solely by the qualified and professional personnel.

The manufacturer reserves the right to introduce technical modifications!



The symbol presented indicates that the used equipment cannot be placed together with other household waste. The user is obliged to bring this item to the waste electrical and electronic equipment collection point where a suitable system is created to allow safe disposal of these items. Dangerous components present in electrical and electronic equipment have negative consequences for the environment and human health therefore correct handling of the equipment is very important. Certain substances which may adversely affect the environment over the life of the product and after use have been limited in this device.

-----

---

**EN**

With your inspiring rating, COSTWAY will be more consistent to offer you EASY SHOPPING EXPERIENCE, GOOD PRODUCTS and EFFICIENT SERVICE!

---

**DE**

Mit Ihrer inspirierenden Bewertung wird COSTWAY konsistenter sein, um Ihnen EIN SCHÖNES EINKAUFSERLEBNIS, GUTE PRODUKTE und EFFIZIENTEN SERVICE zu bieten!

---

**FR**

Avec votre évaluation inspirante, COSTWAY continuera à fournir une EXPÉRIENCE D'ACHAT PRATIQUE, des PRODUITS DE QUALITÉ et un SERVICE EFFICACE !

---

**ES**

Con su calificación inspiradora, COSTWAY será más consistente para ofrecerle EXPERIENCIA DE COMPRA FÁCIL, BUENOS PRODUCTOS y SERVICIO EFICIENTE.

---

**IT**

Con la tua valutazione incoraggiante, COSTWAY sarà più coerente per offrirti ESPERIENZA DI ACQUISTO FACILE, BUONI PRODOTTI e SERVIZIO EFFICIENTE!

---

**PL**

Dzięki twojej opinii COSTWAY będzie mógł oferować jeszcze WYGODNIEJSZE ZAKUPY, LEPSZE PRODUKTY i SPRAWNIEJSZĄ OBSŁUGĘ KLIENTA.

**US** office: Fontana

**UK** office: Ipswich

**AU** office: Truganina

**DE** office: Hamburg

**FR** office: Saint Vigor d'Ymonville

**PL** office: Gdańsk