



TIPS:

Your suggestions and comments for infans are really important to us!
We sincerely solicit you to go back to our shop and leave a good rating in just a simple click. It would be quite encouraging if you could kindly do so like below:

★★★★★ Great products so far

February 24, 2018

Great product so far. Fast delivery, easy setup, and working without any issues.

With your inspiring rating, infans will be more consistent to offer you
EASY SHOPPING EXPERIENCE, GOOD PRODUCTS and EFFICIENT SERVICE!

infans®

infans®

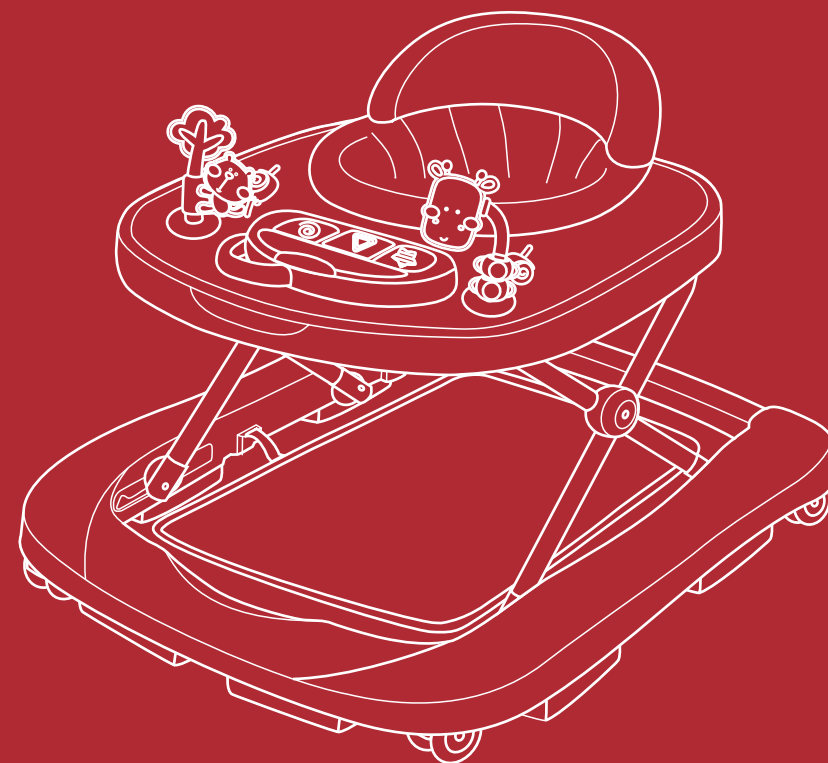

USER'S MANUAL

**Baby Walker
BB5555**

Parts List

Check that you have all the parts for this model BEFORE assembling your product.
No tools required.



A. 2 front wheels



B. 2 rear wheels

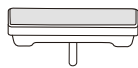

C. 6 safe rubbers



D. Baby walker frame

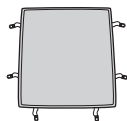

E. Footrest



F. Toy set



G. Electronic play tray

! WARNING

Read the instructions carefully before use and keep them for future reference.
The child may be hurt if you do not follow these instructions.

Before using, remove and dispose of any plastic bags and other packaging (e.g. fasteners, fixing ties, etc.) and keep them out of reach of children.

- Before using, check that the product and all of its components have not been damaged during transportation. Check regularly that the product is not broken or damaged. If the product is broken or damaged, keep out of reach of children.
- The product must only be assembled by an adult. For the correct assembly of the product, please refer to the following instructions.

! WARNING

STAIR HAZARD: Avoid serious injury or death.
Block stairs/step securely before using walker.

- Use only on flat surfaces free of objects which could cause the walker to tip over.
- Never leave child unattended. Always keep child in view while in walker.

! WARNING

The child will be able to reach further and move rapidly when in the walking frame.

Prevent access to stairs, steps and uneven surfaces, slopes or unstable floors, swimming pools or other sources of water.

- To avoid burns, keep the child away from hot liquids, ranges, radiators, space heaters, fireplaces, etc.
- Prevent collisions with glass in doors, windows and furniture.
- Do not use the baby walking frame if any components are broken or missing.
- This baby walking frame should be used only for short periods of time (e.g. 20mins).
- This baby walking frame is intended to be used by children who can sit unaided, approximately from 6 months. It is not intended for children weighing more than 25LBS.
- Do not use replacement parts other than those approved by the manufacturer or distributor.
- Do not use until baby can sit up by itself.
- Clean (friction components) regularly to maintain stopping performance.

Assembling Procedures

Step 1

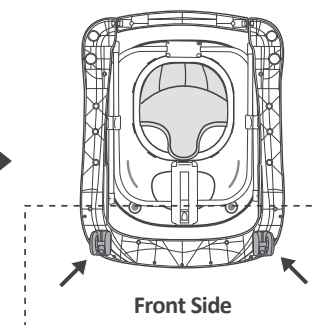
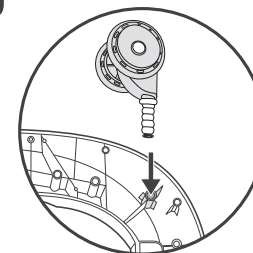

Front Side

1. Turn the baby walker frame upside down. Fix the wheels in the appropriate housings. Ensure that the wheels are firmly pushed all the way into the housing on the down base of the walker.

Step 2

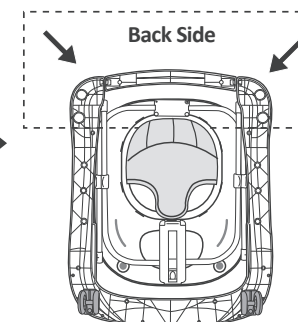
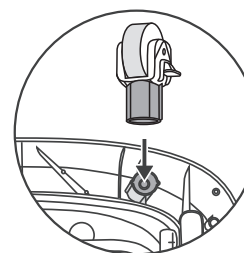

Back Side

2. Fix the rear fix wheels in the appropriate housings. Ensure that the wheels are firmly pushed all the way into the housing on the down base of the walker.

Step 3

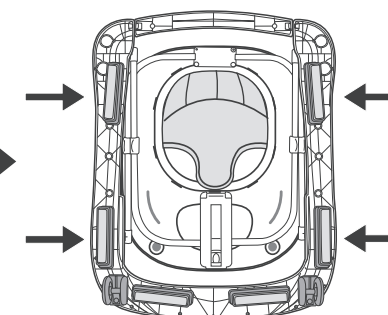
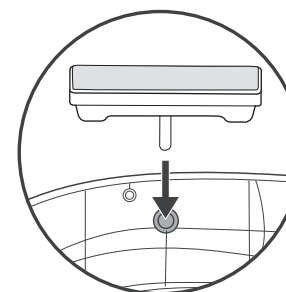

3. Fix the safe rubbers in the appropriate housings. Ensure that the safe rubbers are firmly pushed all the way into the housing on the down base of the walker.

Step 4

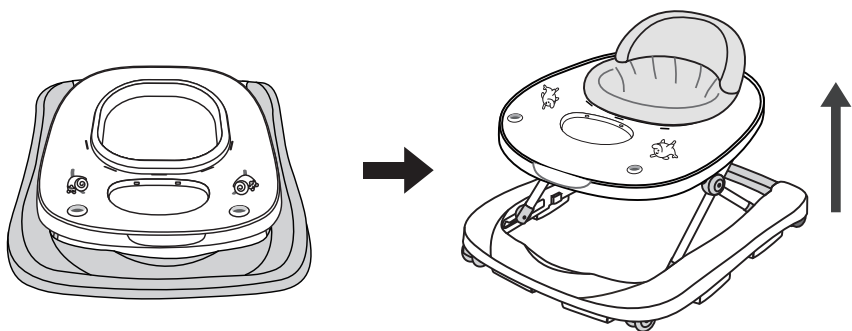

4. Open the baby walker frame in the in-use position, ensuring that all wheels touch the floor. Slowly raise the tray by pulling it in an upward direction, until a click indicates that the frame has been locked correctly in one of the three positions.

Step 5

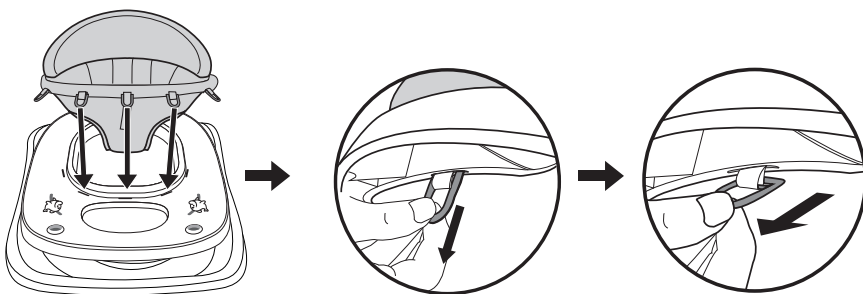

5. The seat pad is already Partly installed,pls install the rest parts and ensure that they are all correctly locked in the position and can not recede out of the slot.

Step 6

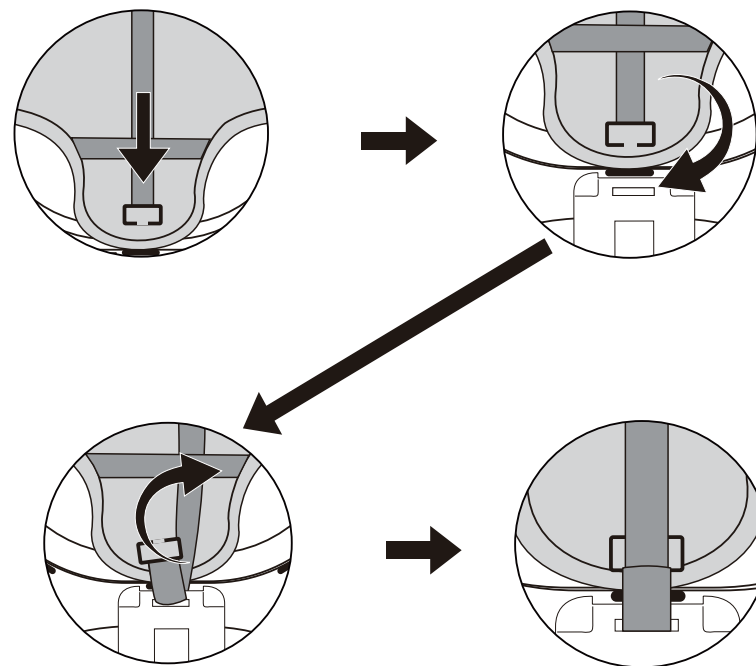

6. The belt under the seat is a dual safety measure just in order to protect the baby from falling to the ground if the seat is not being fixed well .If this belt got loose,pls fix again according to the pictures above.

Step 7

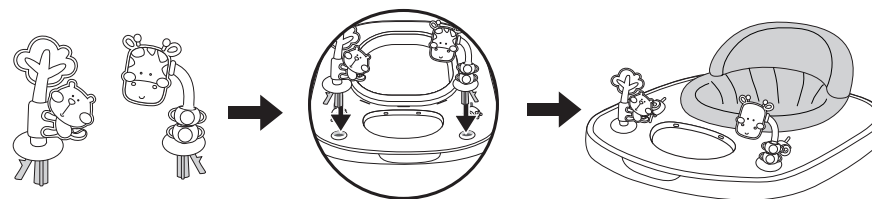

7. Insert the toys bar into the two holes on the upper tray.

Step 8

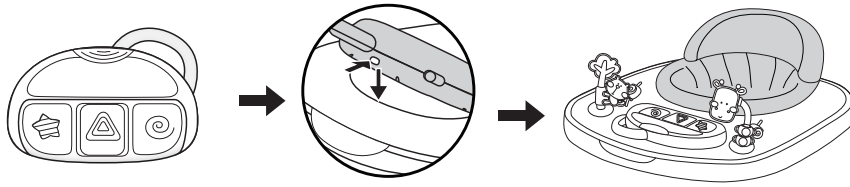

8. Put the music toy board onto the groove on the upper tray, listen for 3 clicks to make sure it's installed firmly.

DISASSEMBLY

Pull the ring of the music toy tray onward the seat, then pull up with certain strength to disassemble the music toy tray from the upper tray.

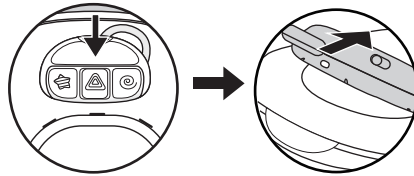

Step 9

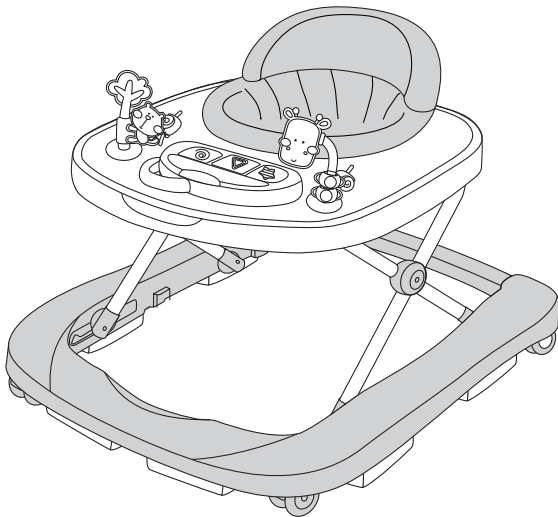

9. Completely assembled.

How to Change Walker to U Shape

Step 10

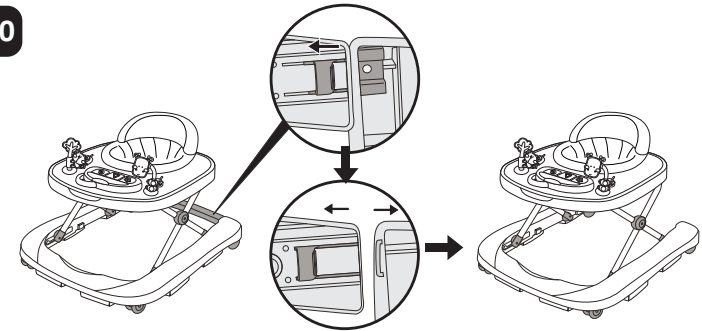

10. Pull the device at both ends back as the picture showed and make the cross bar away from the walker, it becomes U shape walker for baby pushing.

Step 11

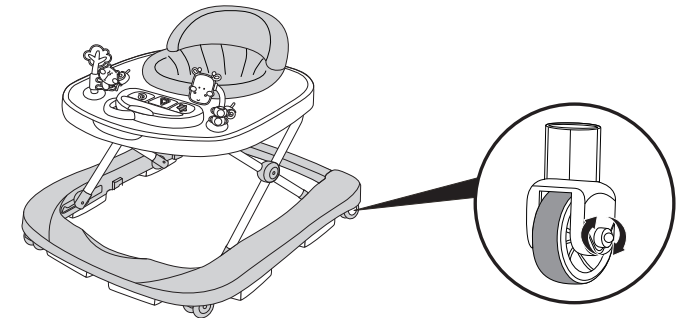

11. These two rear wheels are speed-adjustable by twisting the screw aside with your hands .

Step 12

! WARNING

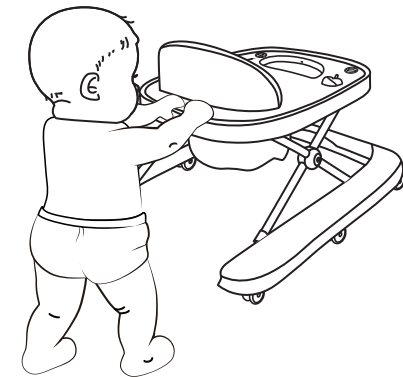

12 . When take off the detachable bar behind for baby to push for walking, please twist tightly the wheels for safety consideration

Step 13

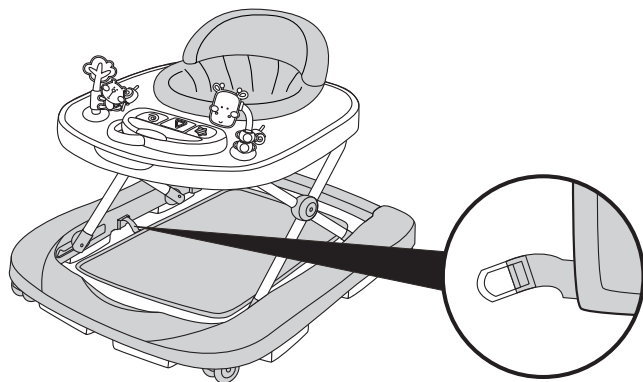

13. If you want to keep your baby in walker, not going anywhere and have a small jumping game inside. You can assemble footrest on walker as below. insert the white hook of foot rest into the corresponding position, and make sure the hook fully across the position hole and lock stably.

How to Adjust the Height of Baby Walker Frame

! WARNING

When opening, closing or adjusting the walker, ensure that your child is at a safe distance. Before placing the child in the walker, ensure that the secondary lock button is correctly locked again.

Step 14

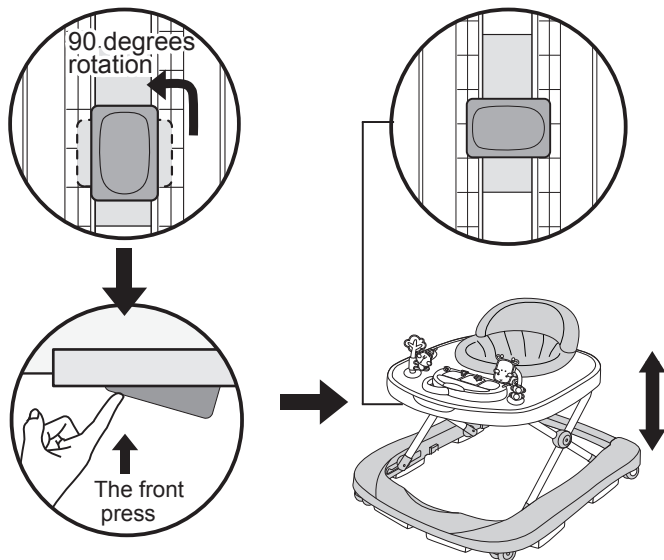

14. To adjust the seat's height, remove the child from the baby walking frame, pull up the safe button located under the small tray table and rotate it to 90 degrees. keep the safe button pressed, then raise or lower the small table until the desired position is reached, then pull up the safe button and rotate it to 90 degrees again to lock the small table. (If it is a automatic secondary lock, please make sure the lock is rotated to 90 degrees.)

How to Fold the Walker

Step 15

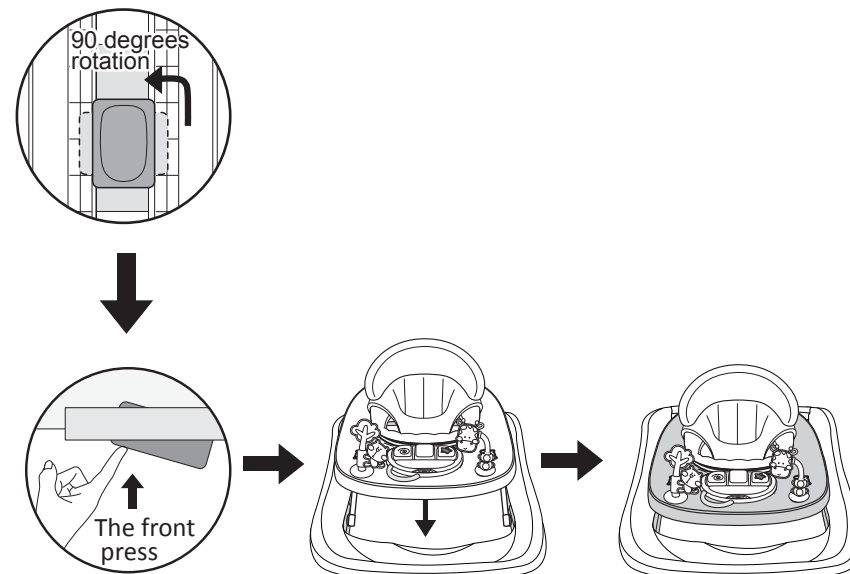

15. Firstly, pull down the button under top tray, make sure the button finally parallel to the adjusted-device (see 1st picture). Meanwhile, press up the front position (see 2nd picture), and press down the top base till the end. The frame folds up completely.

Using Electronic Play Toy Tray

! WARNING

The walker includes one electronic play tray and one toy set that attached to the walker frame. The function and use are shown here.

Step 16

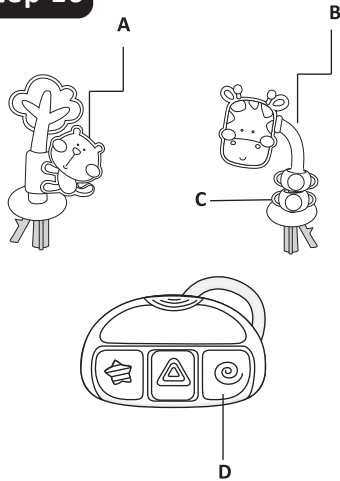

- A** Rotate the kitty from left to right 360 degrees.
- B** Rotate the giraffe from up to down 360 degrees.
- C** Rotate the beads 360 degrees.
- D** Press buttons, lights twinkle with splendid music.

Fitting and / or Replacing Batteries

! WARNING

The toy of the walker frame requires 2X"AA" 1.5Volt alkaline type batteries(not included).

- Batteries must only be fitted by an adult.
- To fit and/ or replace batteries: loosen the screw on the battery compartment cover with a suitable screwdriver, press the tab and remove the battery compartment cover. Then remove the spent batteries and fit new ones, ensuring that they have been fitted in the correct polarity, as shown inside the battery compartment. Replace the battery cover and tighten the screw.

- Always keep batteries and tools out of reach of children.
- Always remove spent batteries from the toy to avoid the danger of possible leakage from the battery damaging the product.
- Always remove the batteries if the toy will not be used for a long period.
- Only use alkaline batteries of the same type of equivalent to the type recommended for the correct function of this product.
- Never mix new and old batteries, or different types of batteries.
- Do not burn or dispose of spent batteries into the environment. Dispose of spent batteries at an appropriate differentiated collection point.
- Do not short-circuit the battery terminals.
- Do not attempt to recharge non-rechargeable batteries: they might explode.
- The use of rechargeable batteries is not recommended and cannot be used.

Product Care and Maintenance

- Check regularly the walker frame for signs of damage or wear.
- Clean the plastic parts, including the stoppers, with a damp cloth.
- Clean the seat with brush or family soap and neutral scour
- Dry the metal parts to prevent the formation of rust.
- Prolonged exposure to direct sunlight may cause the fabric to fade.

Read all instructions before assembly and use of the walker.

Keep instructions for future use.

The child may be hurt if you do not follow these instructions.

IMPORTANT! KEEP FOR FUTURE REFERENCE.

WARNING! TO BE ASSEMBLED BY AN ADULT!