

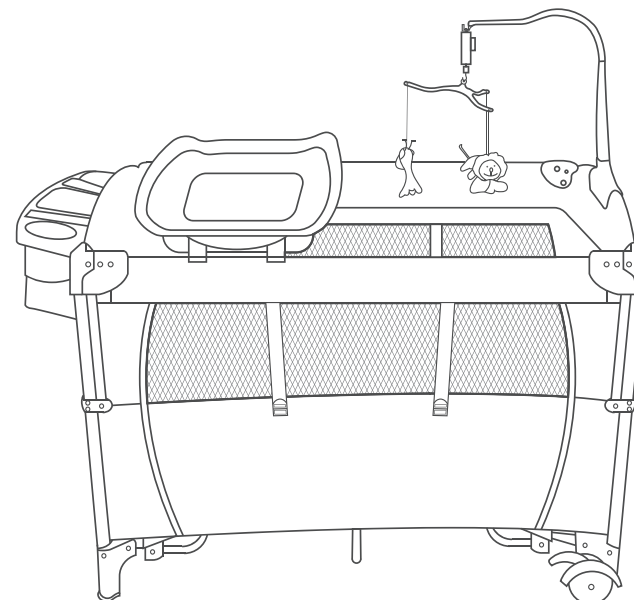

Please give us a chance to make it right and do better !

Contact our friendly customer service department for help first.
Replacements for missing or damaged parts will be shipped ASAP !

US office: Fontana UK office: Ipswich AU office: Truganina



Contact Us !

Do NOT return this item.

Contact our friendly customer service department for help first.



US: cs.us@costway.com
UK: cs.uk@costway.com
AU: cs.au@costway.com

USER'S MANUAL

Baby Playard BB0505

THIS INSTRUCTION BOOKLET CONTAINS **IMPORTANT** SAFETY INFORMATION. PLEASE READ AND KEEP FOR FUTURE REFERENCE.



Before You Start

Please read all instructions carefully and keep it for future reference.

General Warnings:

- ⚠ Attention: To prevent possible injury by entanglement, remove this toy when the child starts trying to get up on its hands and knees in a crawling position.
- ⚠ Danger! Keep all small parts and packaging materials for this product away from babies and children, otherwise they may pose a choking hazard.
- ⚠ The product must be installed and used under the supervision of an adult.
- ⚠ Read through each step carefully and follow the proper order.
- ⚠ Remove all Packaging, separate and count all parts and hardware before installation.
- ⚠ Please ensure that all parts are correctly installed, incorrect installation can lead to a danger.
- ⚠ We recommend that, where possible, all items are assembled near the area in which they will be placed in use, to avoid moving the product unnecessarily once assembled.
- ⚠ Ensure a secure surface during installation, and place the product always on a flat, steady and stable surface.

IMPORTANT!

IMPORTANT!

To ensure safe operation of your baby playard, please follow these instructions and keep for future reference.

IMPORTANT!

Before assembly and each use, inspect this product for damaged hardware, loose joints, missing parts or sharp edges.
Never use if any parts are missing or broken.

⚠ **WARNING: Infants can suffocate:**

1. In gaps between the mattress and the sides of the baby playard.
Ensure that the mattress is the correct size for your baby playard.
* You should not be able to fit more than 2 fingers between the sides of the baby playard and the sides of the mattress.
2. On soft bedding, loose pillows, duvets, cot bumpers. Soft toys should be removed from baby's sleep space.

⚠ **WARNING: Failure to follow these warnings and the instructions could result in serious injury or death.**

PRODUCT LIST

WHEN OPEN THE PARCEL, PLEASE CHECK IF IT HAS CONTAINED THEM ALL LIKE BELOW:

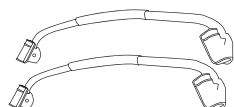

Rocking tubes

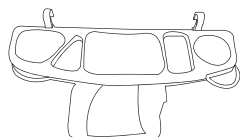

Side storage tray



Mattress

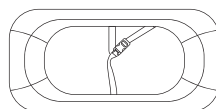

Changing table



Second layer tubes

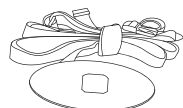

Safety belt

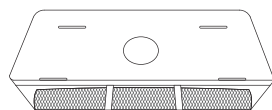

Second layer with zipper

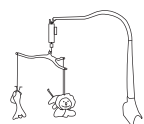

Music & toys rack

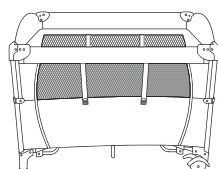

Basic playard

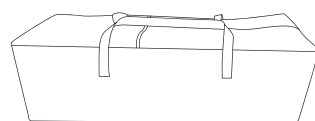

Carry bag

HOW TO OPEN THE BED

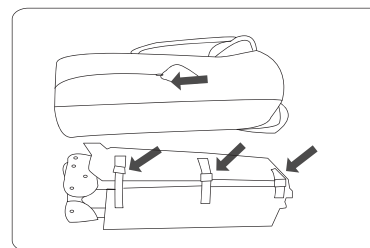

1. Unzip the carry bag and take out all items.

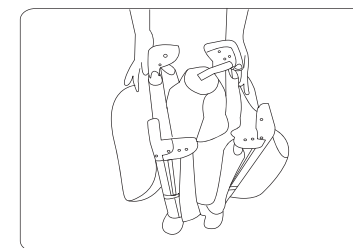

2. Expand out 4 feet.

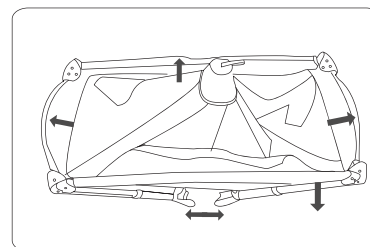

3. Pull up two short sides, and then pull up two long sides.

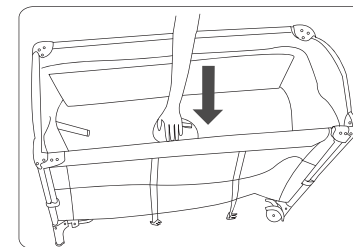

4. Press down from the middle.

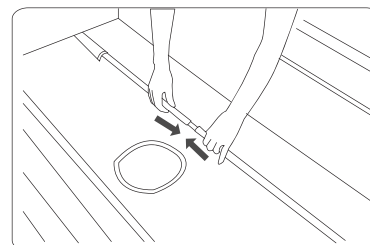

5. Connect 4 tubes.

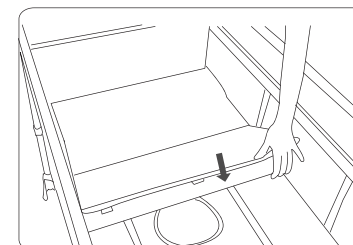

6. Put the mattress on the second layer.

HOW TO ASSEMBLE ROCKING TUBES

Like following pictures and process, assemble rocking tubes at two bottom short sides. If you want to cancel the rocking tubes, just fold the rocking tubes inside, no need to remove the rocking tubes.

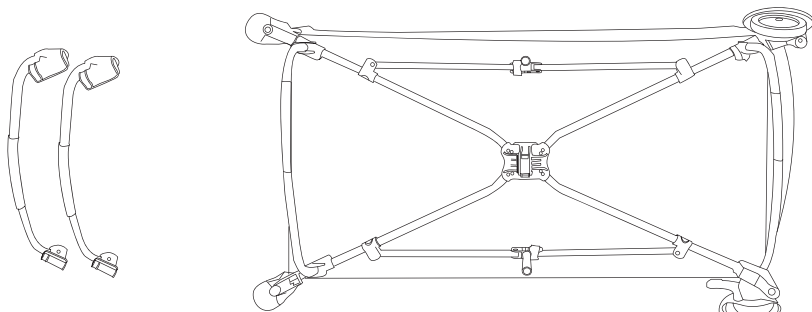

Rocking Tubes

General view after assembly well

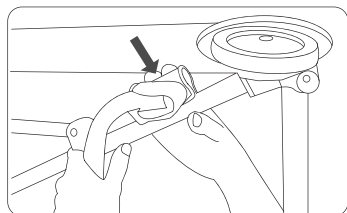

1. Locate the place at two bottom short sides.

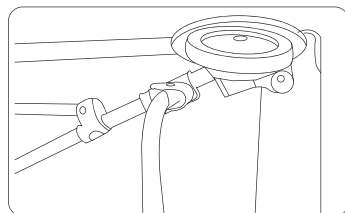

2. Press it to connect the bed's tubes at bottom.

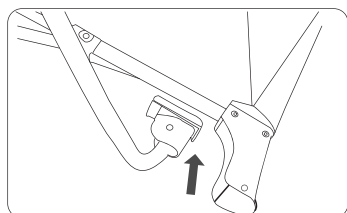

3. Like above picture 1.

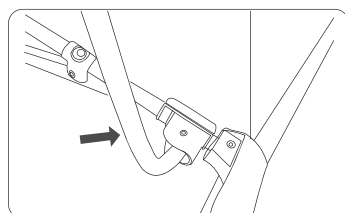

4. Like above picture 2.

HOW TO ASSEMBLE MUSIC&TOYS RACK

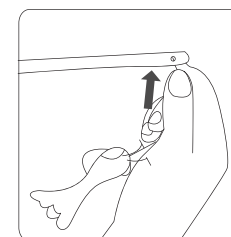
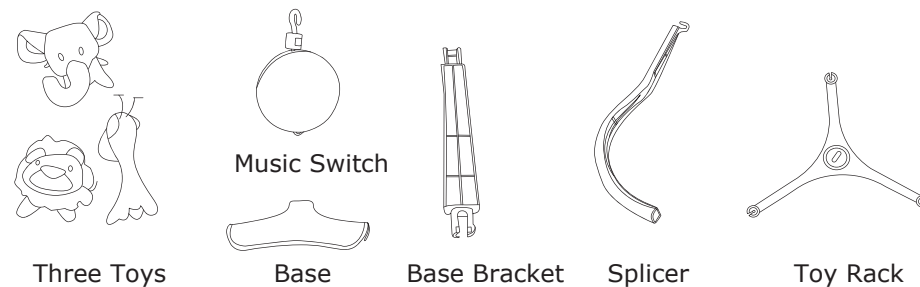

1. Put toys on toy rack.

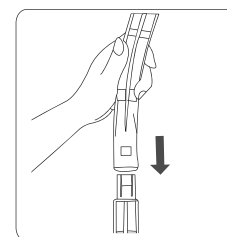

2. Connect two splicers well.

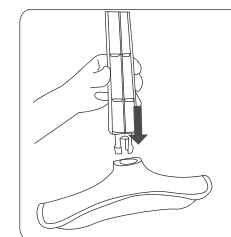

3. Connect base and splicer well.

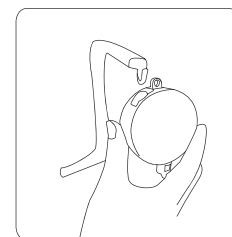

4. Put on music switch.

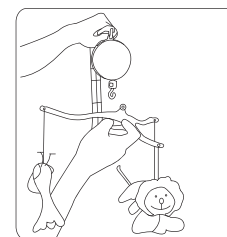

5. Put on bracket with toys.

Insert the 3 toys, toy bars and music box as the shown.

HOW TO ASSEMBLE CHANGING TABLE

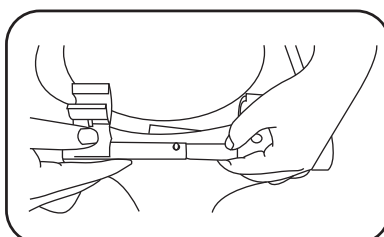
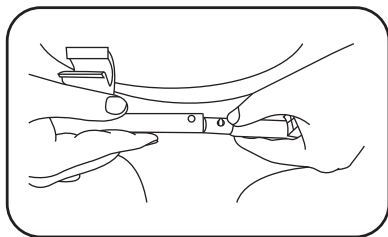

1. Connect two short tubes as shown, and repeat step one.

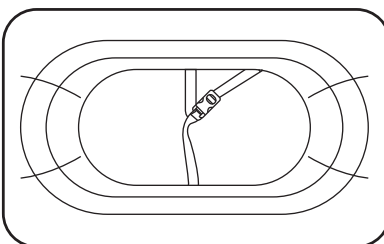
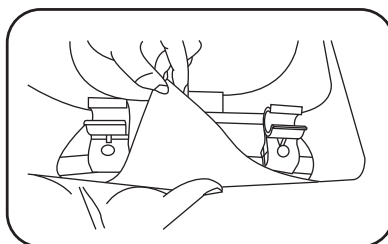

2. Fasten together with velcro straps as shown.

WARNING :

DO NOT LEAVE YOUR CHILD UNATTEND IN THE CHANGING TABLE .
NEVER LEAVE CHANGING TABLE IN PLACE WHEN CHILD IN
THE BABY PLAYARD.

UPGRADE TO USE AS CO-SLEEPING BED

One side of bed can be lifted up or down to connect with adult bed by 4 different heights.

No.1 height is the heights of double layer.

No.2&No.3 is other two height as your personal favourite.

No.4 is the height of baby bed.

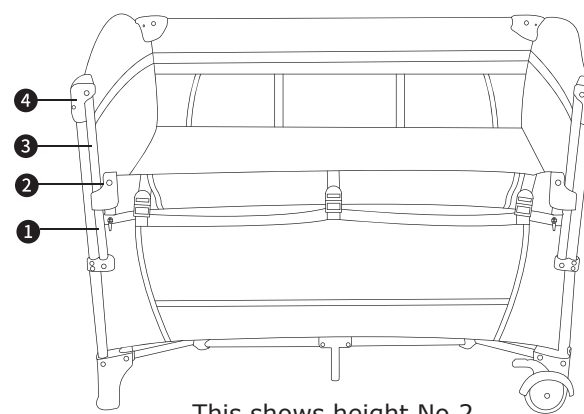

This shows height No.2

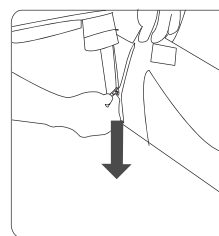

1. Pull zipper down to the height of No.1-No.4

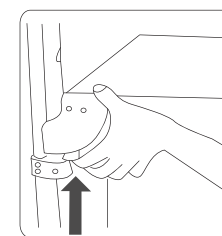

2. Pull up plastic at two sides to the height of No1-No.4

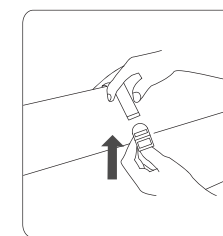

3. Roll up fabric and bind it with velcro

HOW TO CONNECT ADULT BED

To connect the baby bed with adult bed and keep baby from dropping down and harm, we strongly suggest to do like below:

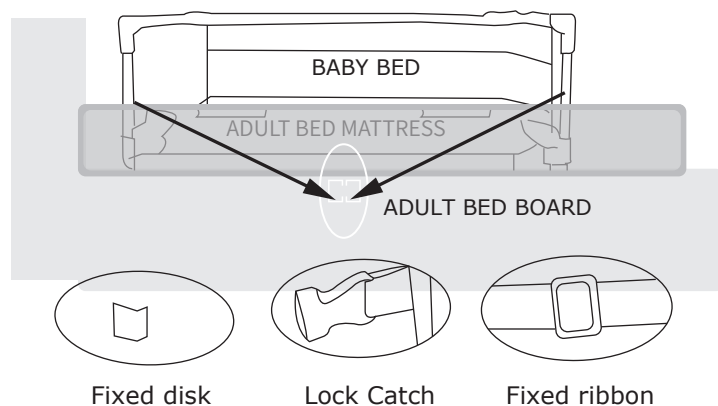

Fixed disk

Lock Catch

Fixed ribbon

HOW TO FOLD THE BABY BED

- Take off all changing table/music&toys rack/storage rack/mattress etc, only leave bed body for folding.
- Lift the ring up at the bottom of the bed.
- Hold the folding switch in the middle of the handrail.
- Press down & fold two long sides down to shape "V"; press down & fold two short sides down to shape "v". Have all 4 feet together.

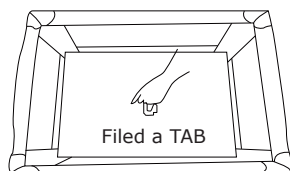

FIG.8

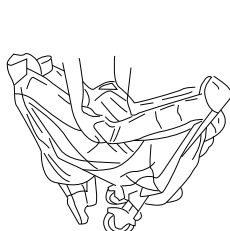

FIG.9



FIG.10

SPECIAL NOTICE:

When folding the bed, please press the bed body firmly (FIG.11). Because the long side handrail is not fully compressed, you need to fold it again to press the long side handrail button until its flank is at a right angle (FIG.12).

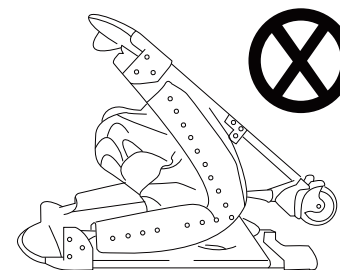

FIG.11

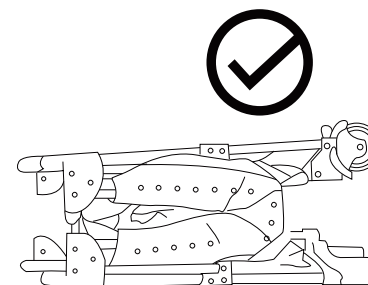

FIG.12