



TIPS:

Your suggestions and comments for Costway are really important to us!
We sincerely solicit you to go back to our shop and leave a good rating in just a simple click. It would be quite encouraging if you could kindly do so like below:

★★★★★ Great products so far

February 24, 2018

Great product so far. Fast delivery, easy setup, and working without any issues.

With your inspiring rating, Costway will be more consistent to offer you
EASY SHOPPING EXPERIENCE, GOOD PRODUCTS and EFFICIENT SERVICE!

US office:Fontana

UK office:lpswich

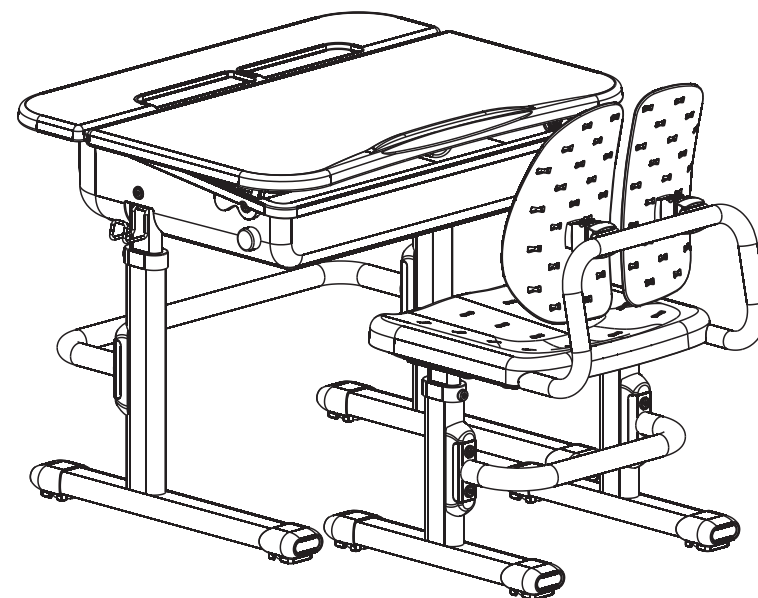

INSTRUCTION MANUAL

Kids Study Desk & Chair

HW66157/HW63293

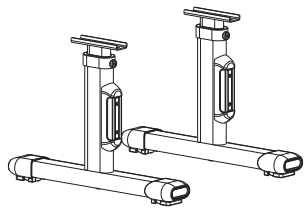

B1

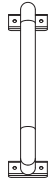

B2

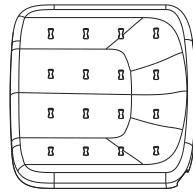

B3

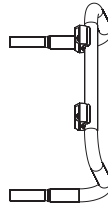

B4

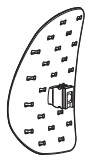

B5



B6

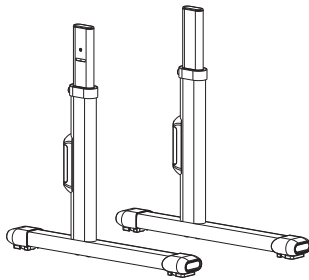

B7



B8

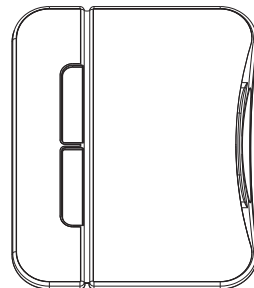

B9



D6
A1x16



M6x12
A2x16



A3x1

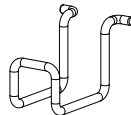

A4x1

CAUTION!

- Read the entire instruction manual before you start installation and assembly. Improper installation may result in damage or serious personal injury.
- Adult assembly required. Product contains small parts that present choking hazards for children.
- Never fully tighten the screws until all hardware has been assembled and in proper place.
- Never allow corrosives, moisture, or chemicals to make contact with the product as surface damage may occur. Should this happen, clean the surface immediately using a damp cloth.
- The product is intended for indoor use only, using the product outdoors or in an uncontrolled environment may result in product failure.

1

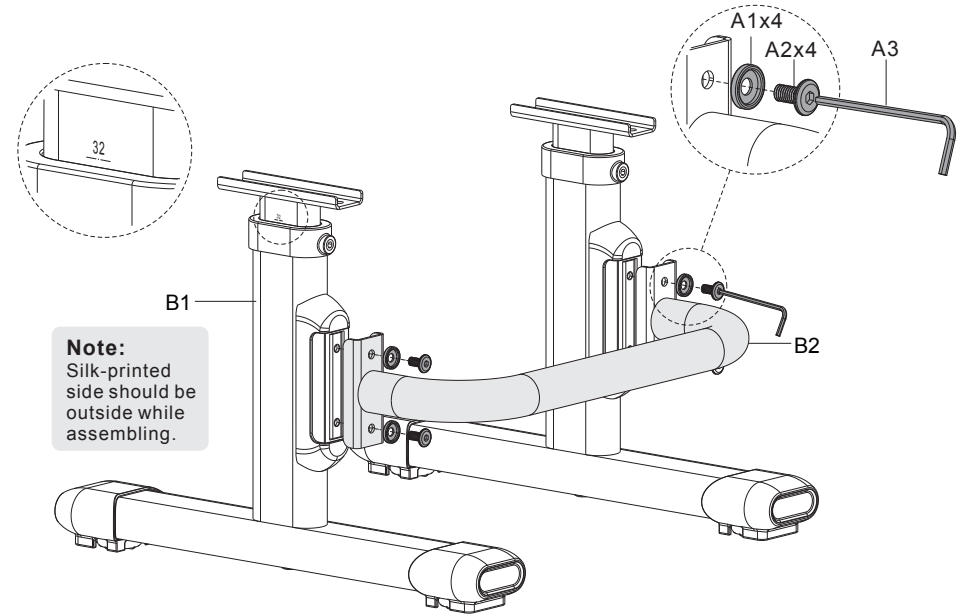

2

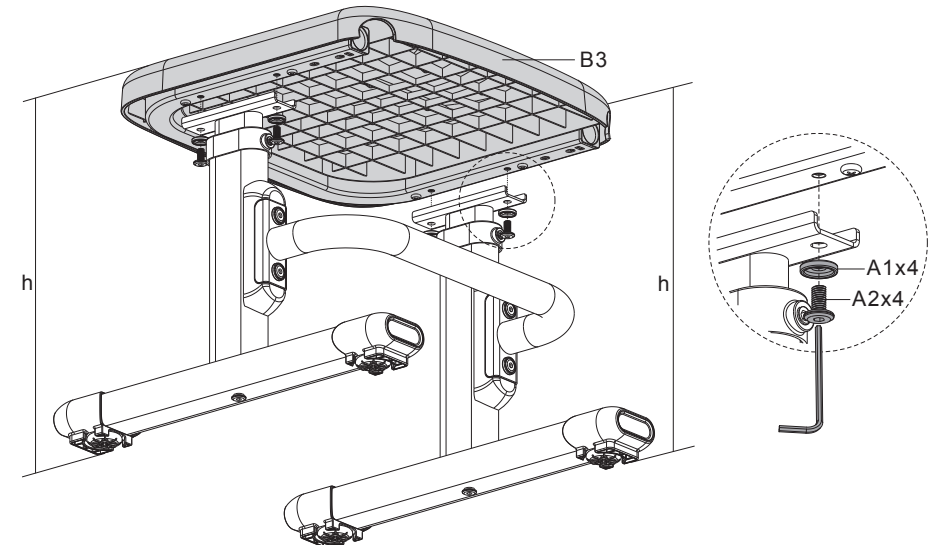

3

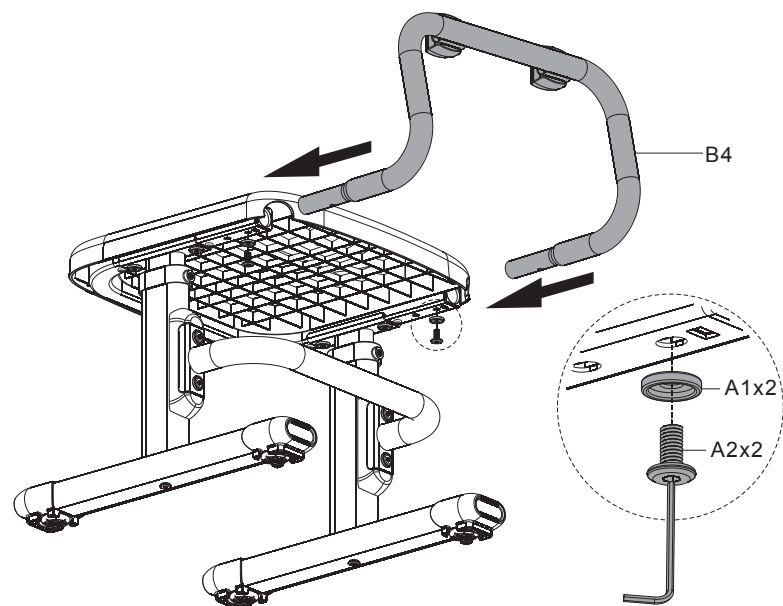

4

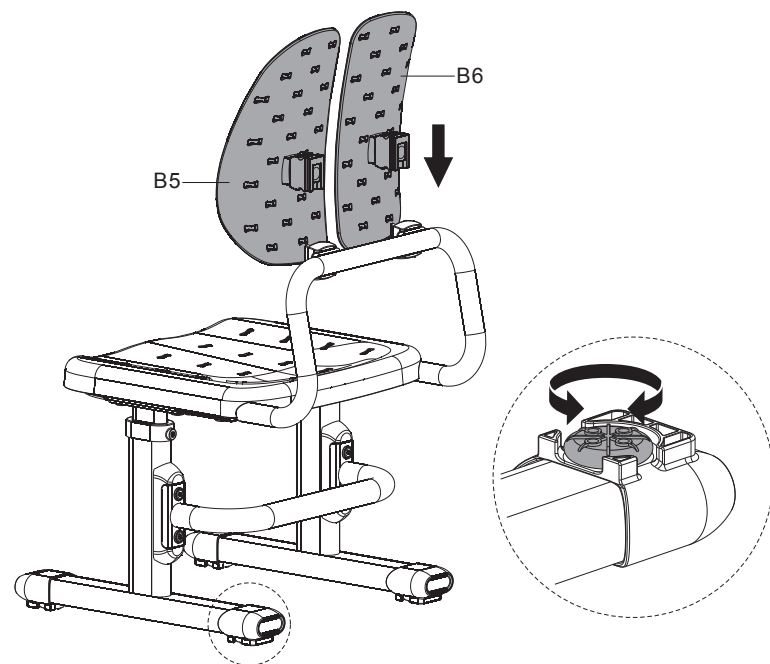

5

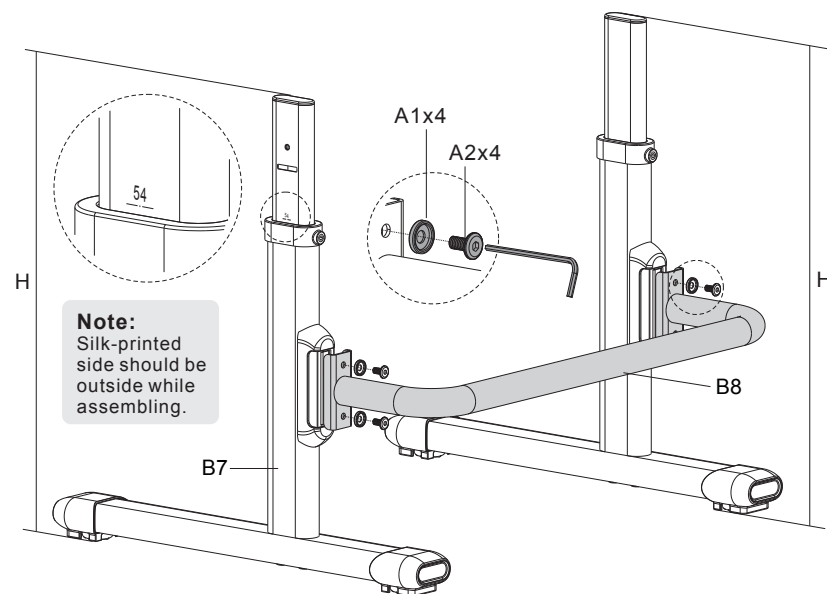

6

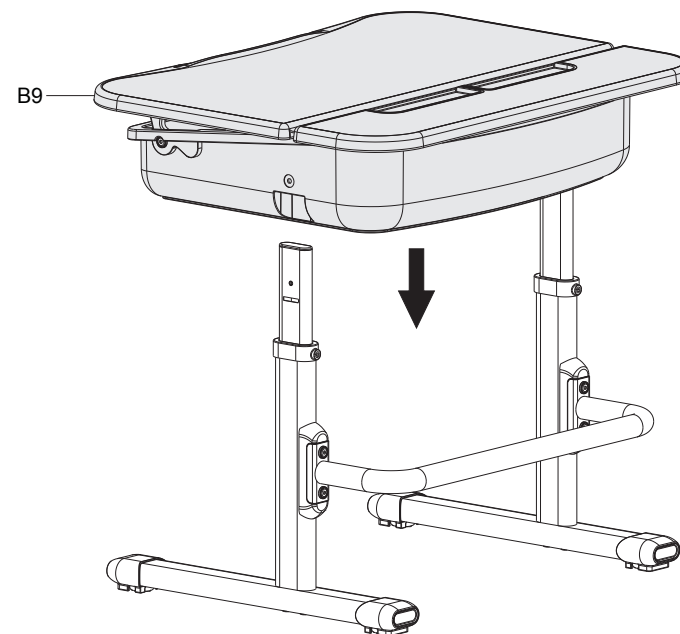

7

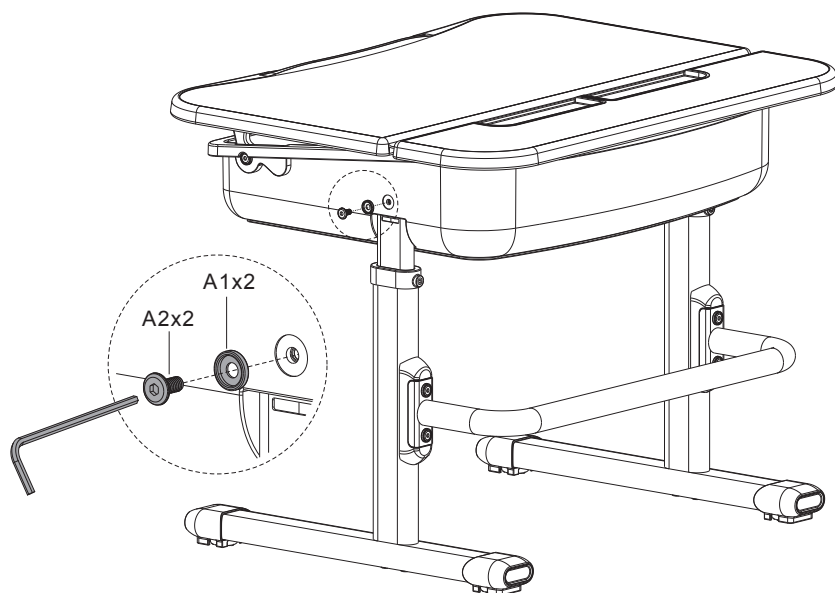

8

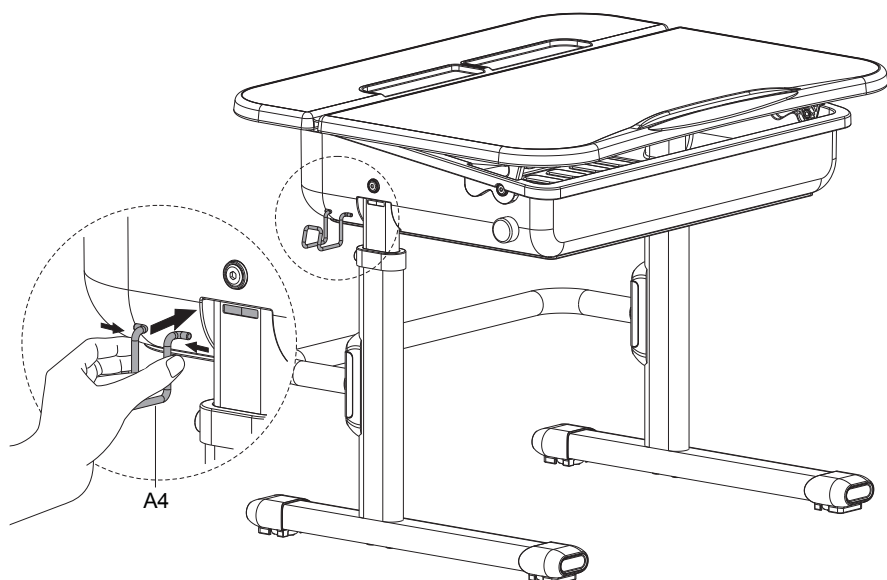

9

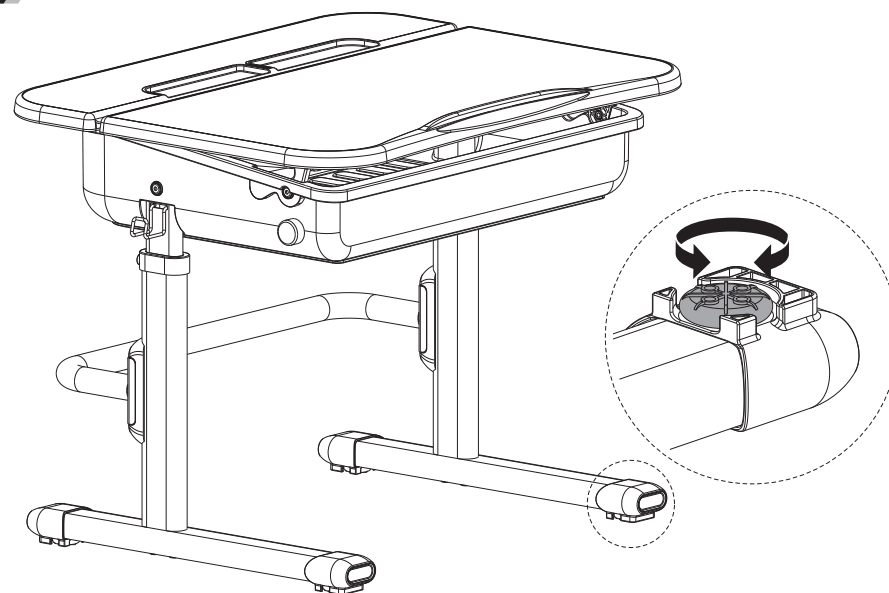

10

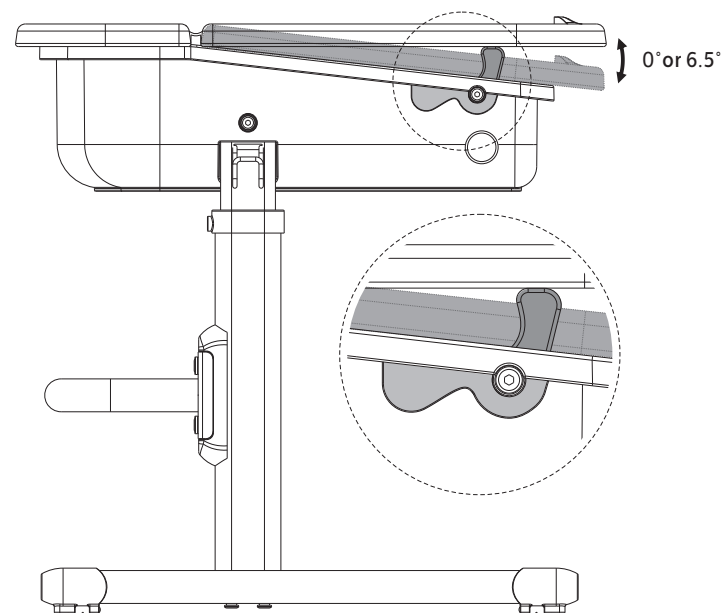

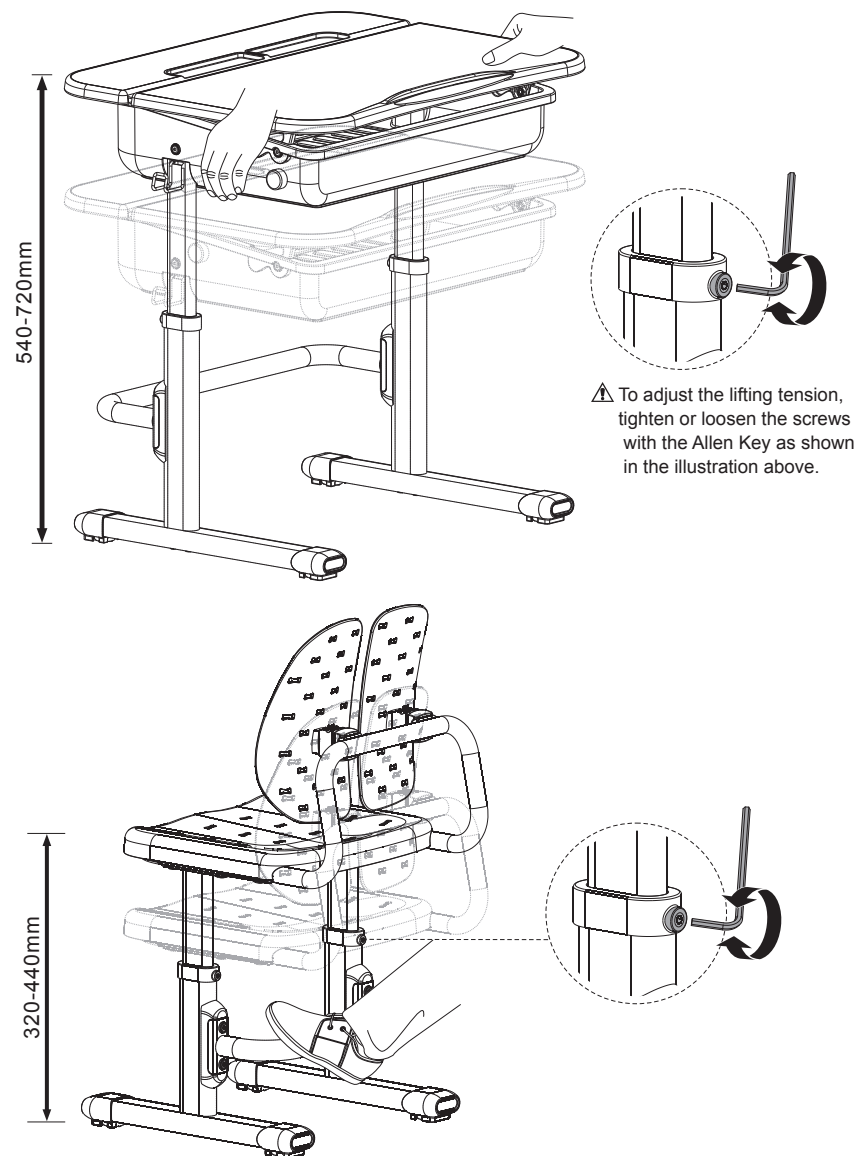

RAISING THE DESK/CHAIR

Stabilize the desk/chair by placing your foot on the crossbar as shown. Using both hands, lift up to the desired height.

LOWERING THE DESK/CHAIR

Stabilize the desk/chair by placing your foot on the crossbar as shown. Using both hands, lift up to the max. height then slowly lower to the min. height. Lift up again to the desired height.