



COSTWAY®

Please give us a chance to make it right and do better !

Contact our friendly customer service department for help first.
Replacements for missing or damaged parts will be shipped ASAP !

US office: Fontana **UK** office: Ipswich **AU** office: Truganina
DE office: Hamburg **FR** office: Saint Vigor d'Ymonville **PL** office: Gdańsk



Contact Us!

Do NOT return this item.

Contact our friendly customer service department for help first.



US:cs.us@costway.com
UK:cs.uk@costway.com
AU:cs.au@costway.com

USER'S MANUAL

360 Deg Rotating Seesaw OP3299

THIS INSTRUCTION BOOKLET CONTAINS **IMPORTANT** SAFETY INFORMATION. PLEASE READ AND KEEP FOR FUTURE REFERENCE.



Before You Start

- ⚠ Please read all instructions carefully.
- ⚠ Retain instructions for future reference.
- ⚠ Separate and count all parts and hardware.
- ⚠ Read through each step carefully and follow the proper order.
- ⚠ We recommend that, where possible, all items are assembled near to the area in which they will be placed in use, to avoid moving the product unnecessarily once assembled.
- ⚠ Always place the product on a flat, steady and stable surface.
- ⚠ Keep all small parts and packaging materials for this product away from babies and children as they potentially pose a serious choking hazard.

360 Deg Rotating Seesaw

Thank you for purchasing the 360 Deg Rotating Seesaw

The outdoor play centre you have chosen adheres to European standards

and has been certified by an independent laboratory.

Advice for assembly

- Respect exactly the assembly instructions .This product must be assembled by an adult
- Keep the instruction sheet especially for the identification of the component by the after sales service
- Before commencing, check that none of the parts are missing; You can retain excess parts as spares for future use when necessary.

Advice for safety

- This product must not used by children under 36 months (the small parts could be swallowed).It is only for children from 3 to 7 with a 35kg maximum weight, It must be used under adult supervision.
 - This product is only for private use at home and must never be used in parks and public gardens, in schools, camp sites, hotels, public leisure areas, etc.
 - The Seesaw should be set up on a flat surface and 2 metres away from all other thing
- Structures or obstacles(walls ,fences ,trees ,washing lines or electric cables etc).that could cause injury during use.
- The product must not be set up on hard surfaces (concrete, tarmac, etc) .Grass or soft surface are better .
 - The play centre must be embedded firmly into the ground, respecting the assembly ins tructions, Only use this product when the concrete is dry.
 - The anchorage must be checked regularly ,in addition to the hooks and fixtures.
- Do not throw packaging in nature and do not leave with the range of children

Maintenance

The metal parts do not need any particular care .However ,in certain regions(ie seaside areas),certain coatings could be prone to damage ,In this case ,it is advised to use a rust prevention treatment.

All parts that are under constant friction can be oiled regularly with a suitable lubricant.

The ground on which the game is placed should be controlled regularly. All elements such as stones or other objects that could cause injury in the case of a fall, should be removed.

It is advised to remove the apparatus during the winter period, when not in use .to avoid any deterioration due to bad weather conditions.

Practical advice

-Certain safety checks should be carried out regularly on the swing set. This check should include, if necessary ,removing any sharp edges, replacing missing screw covers, tightening the nuts and bolts etc, to avoid any danger through normal wear and tear or any upturning of the swing set.

Fixing into the ground see overleaf

IMPORTANT! For safety reasons .the game must be embedded into the ground :

Place the game in the desired position ,mark a square 350* 350mm around each (the feet must be in the centre of the square) and dig a hole 350mm deep Fill those holes with a minimum of 300mm of concrete .Do not exceed the ground level .Fit the embedding piece into the centre of the concrete so that fixtures for screwing the posts into place rise out of the concrete when the concrete is dry ,screw the posts to the embedding pieces.

IMPORTANT! Wait until the concrete is set before using play centre and check anchorages regularly

1

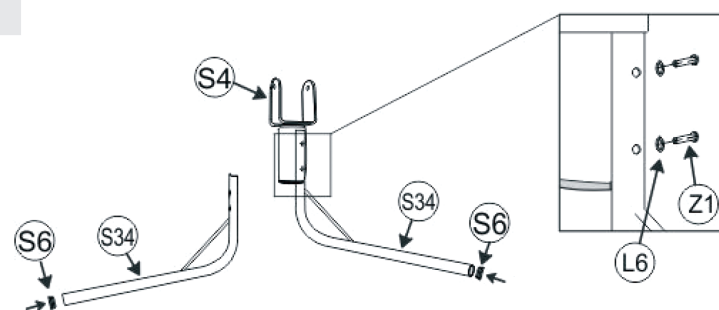

(S34) x3
(S4) x1
(L6) x6
(Z1) x6
(S6) x3

2

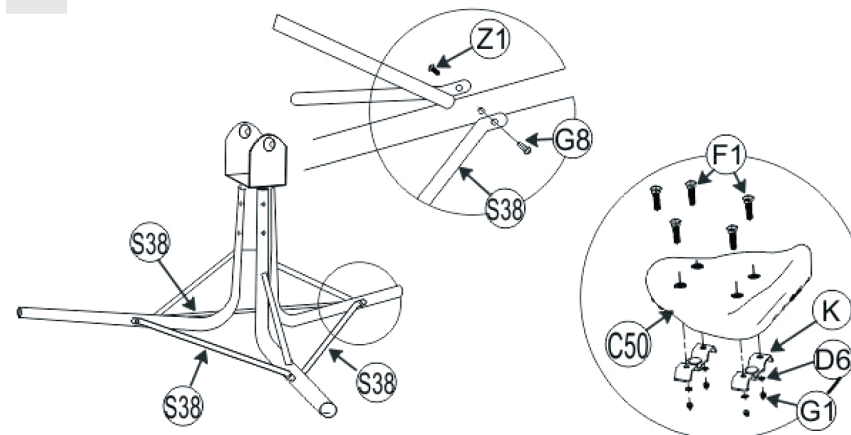

(G1) x8
(G8) x3
(K) x4
(Z1) x3
(S38) x3
(D6) x8
(C50) x2
(F1) x8

3

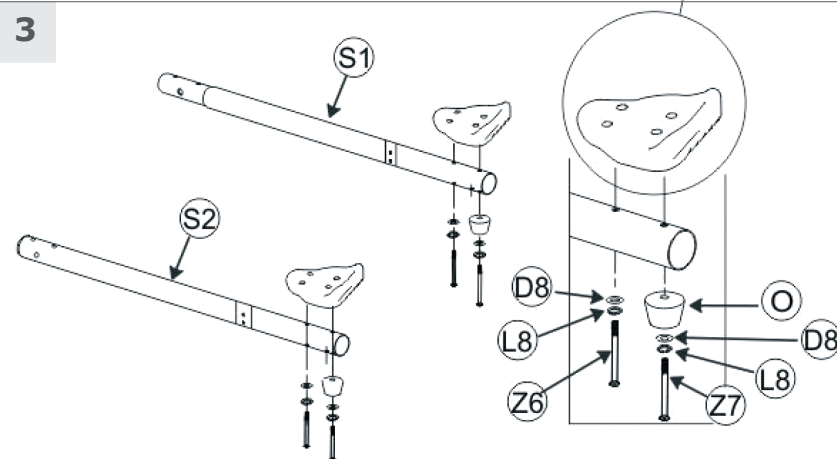

(S1) x1
(S2) x1
(Z6) x2
(Z7) x2
(O) x2
(D8) x4
(L8) x4

4

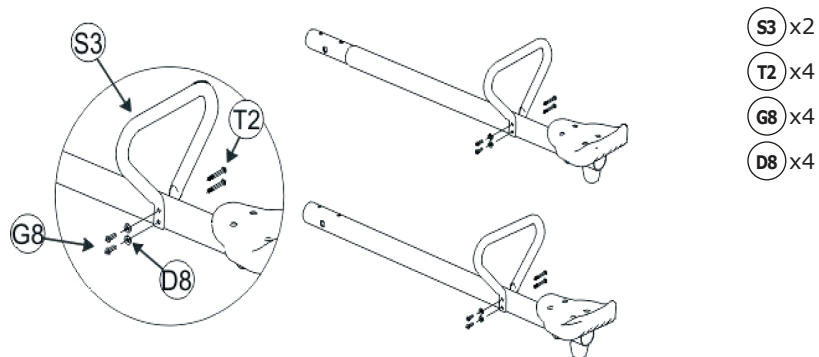

(S3) x2
(T2) x4
(G8) x4
(D8) x4

5

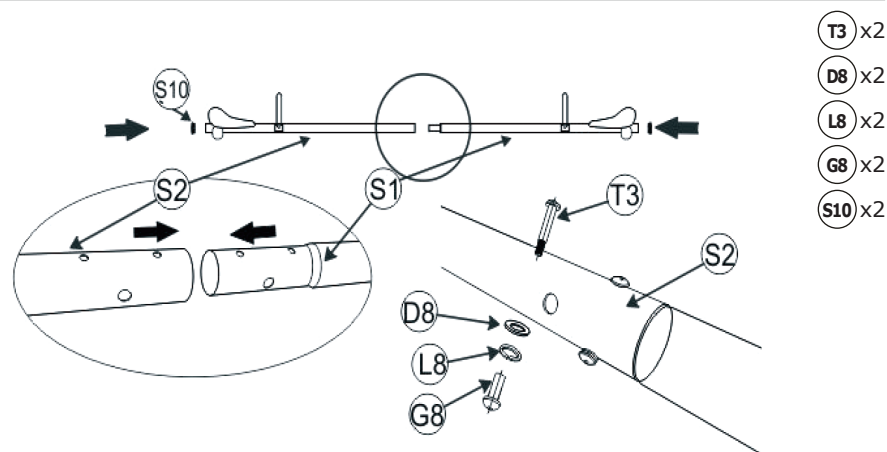

(T3) x2
(D8) x2
(L8) x2
(G8) x2
(S10) x2

6

(F) x2

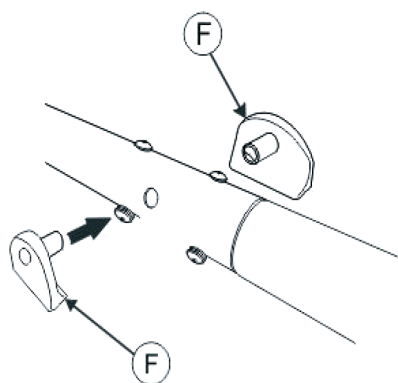

7

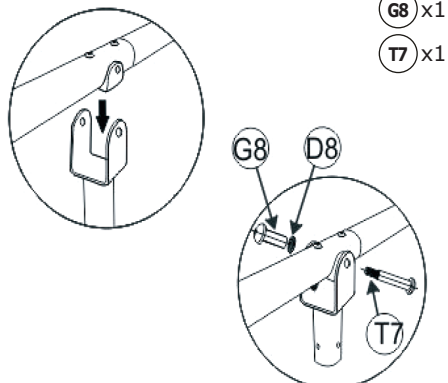

(D8) x1
(G8) x1
(T7) x1

8

(H) x3

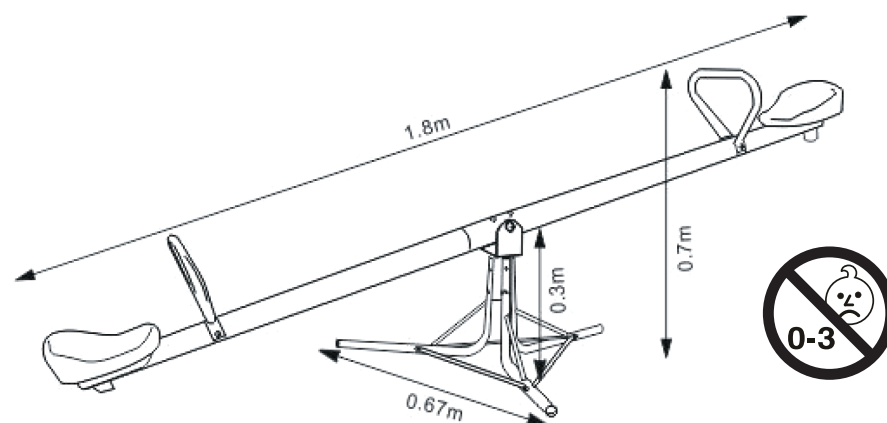
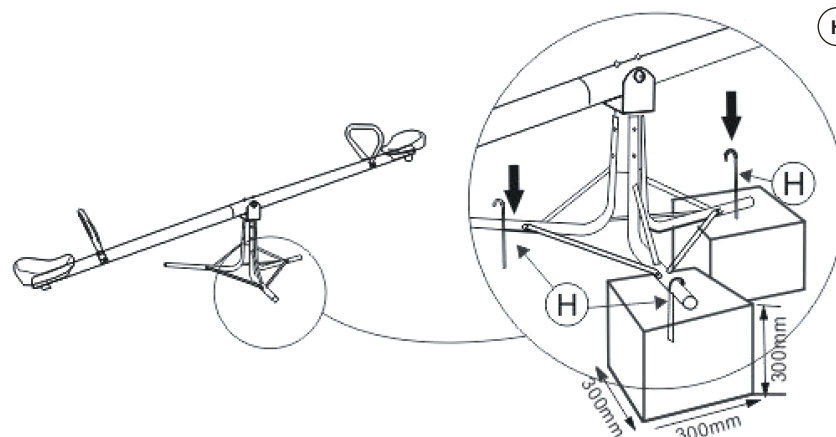

(Z1) x9 M6x13

(Z6) x2 M8x60

(Z7) x2 M8x70

(T2) x4 $\Phi 8/M6 \times 35$ (T3) x2 $\Phi 8/M6 \times 40$ (T7) x1 $\Phi 8/M6 \times 55$

(F1) x8 M6x20

(G8) x10 M6/ $\Phi 8 \times 20$ (D6) x8 $\Phi 6$ (D8) x14 $\Phi 8$

(O) x2

(L6) x6 $\Phi 6$ (L8) x7 $\Phi 8$

(G1) x8 M6

(S6) x3

(S10) x2

(A4)

K10K13

(H) x3

(C50) x2

(S1) x1

(S2) x1

(S3) x2

(S4) x1

(S34) x3

(S38) x3

(K) x4

(F) x2