

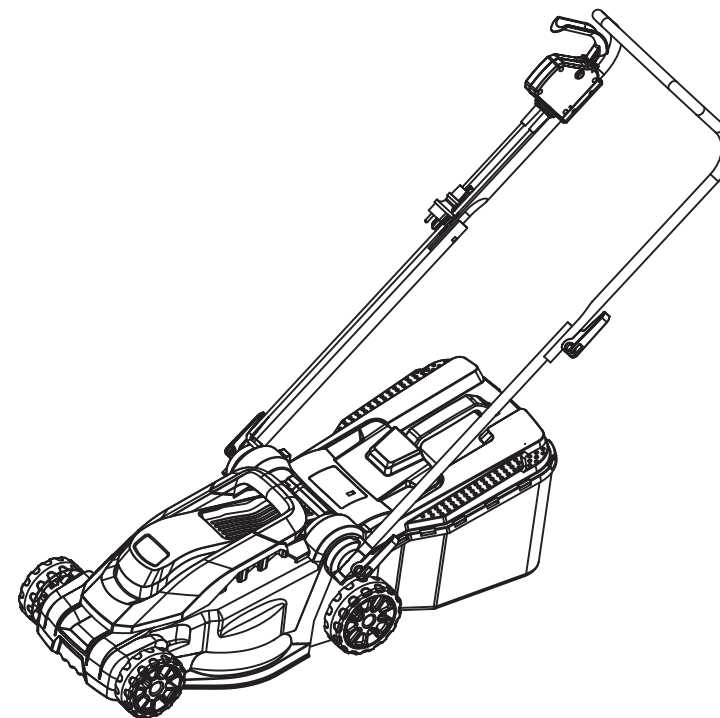

7029-302512

COSTWAY
www.costway.com

COSTWAY®



USER'S MANUAL
Electric Lawn Mower
GT3414

THIS INSTRUCTION BOOKLET CONTAINS **IMPORTANT** SAFETY INFORMATION. PLEASE READ AND KEEP FOR FUTURE REFERENCE.

Please give us a chance to make it right and do better!

Contact our friendly customer service department for help first.

Replacements for missing or damaged parts will be shipped ASAP!

Follow Costway

Visit us: www.costway.com



Contact Us!

Do NOT return this item.

Contact our friendly customer service department for help first.



Before You Start

- ⦿ Please read all instructions carefully.
- ⦿ Retain instructions for future reference.
- ⦿ Separate and count all parts and hardware.
- ⦿ Read through each step carefully and follow the proper order.
- ⦿ We recommend that, where possible, all items are assembled near to the area in which they will be placed in use, to avoid moving the product unnecessarily once assembled.
- ⦿ Always place the product on a flat, steady and stable surface.
- ⦿ Keep all small parts and packaging materials for this product away from babies and children as they potentially pose a serious choking hazard.

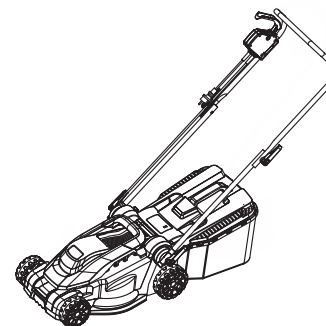

WARNING

Read and understand all instructions. Save these instructions. Failure to follow all instructions listed below may result in electric shock, fire and/or serious injury. The term 'power tool' in all of the warnings below refers to your mains-operated (corded) power tool.

KNOW YOUR LAWN MOWER

Read this manual carefully, observing the recommended safety instructions before, during and after using your lawn mower. Following these simple instructions will also maintain your lawn mower in good working order. Familiarize yourself with the controls on your mower before attempting to operate it, but above all, be sure you know how to stop your mower in an emergency. Retain this user manual and all other literature with your mower for future reference.



1. SYMBOLS MARKED ON THE PRODUCT



Read this instruction book carefully before using the lawn mower and keep it in a safe place for future reference.



Beware of sharp blades. Blades continue to rotate after the motor is switched off.



Keep bystanders away.



Keep the supply flexible cord away from the cutting blades.



CE Marking
The product meets demands and regulations set by the European Community.



SAFETY ALERT SYMBOL: Indicates caution or warning may be used in conjunction with other symbols or pictures.



Noise level marking
Your tool noise is not more than 96dB.



WEEE Marking
CAUTION! Unusable power tools do not belong with domestic waste. They must be taken to a communal collecting point for environmentally friendly disposal in accordance with local regulations.



DOUBLE INSULATED CAUTION!
Your mower is double insulated. This means that all external parts are electrically isolated from the power supply. This is achieved by placing an extra insulation barrier between the electrical and mechanical parts.

2. GENERAL SAFETY RULES

The purpose of the safety rules is to attract your attention to possible dangers. The safety symbols and the explanations with them, require your careful attention and understanding. The safety warnings do not by themselves eliminate any danger. The instruction or warnings they give are not substitutes for proper accident prevention measures.

▲ WARNING: Failure to obey a safety warning can result in serious injury to yourself or to others. Always follow the safety precautions to reduce the risk of fire, electric shock and personal injury. Save owners manual and review frequently for continuing safe operation and instructing others who may use this tool.

▲ WARNING: This machine produces an electromagnetic field during operation. This field may under some circumstances interfere with active or passive medical implants. To reduce the risk of serious or fatal injury, we recommend persons with medical implants to consult their physician and the medical implant manufacturer before operating this machine.

▲ WARNING: The operation of any tool can result in foreign objects being thrown into your eyes, which can result in eyes severely damaged. Before beginning power tool operation, always wears safety goggles or safety glasses with side shields and a full face shield when needed. We recommend Wide Vision Safety Mask for use over eyeglasses or standard safety glasses with side shield.

IMPORTANT READ CAREFULLY BEFORE USE. KEEP FOR FUTURE REFERENCE.

- 1) Read the instructions carefully. Be familiar with the controls and the proper use of the equipment;
- 2) Never allow children or people unfamiliar with these instructions to use the lawnmower. Local regulations can restrict the age of the operator
- 3) Never mow while people, especially children, or pets are nearby;
- 4) Keep in mind that the operator or user is responsible for accidents or hazards occurring to other people or their property.
- 5) While mowing, always wear substantial footwear and long trousers. Do not operate the equipment when barefoot or wearing open sandals; Avoid wearing clothing that is loose fitting or that has hanging cords or ties.
- 6) Thoroughly inspect the area where the equipment is to be used and remove all objects which can be thrown by the machine.
- 7) Before using, always visually inspect to see that the blades, blade bolts and cutter assembly are not worn or damaged. Replace worn or damaged blades and bolts in sets to preserve balance. Replace damaged or unreadable labels.
- 8) Before use check the supply and extension cord for signs of damage or worn. If the cord becomes damaged during use, disconnect the cord from the supply immediately. **DO NOT TOUCH THE CORD BEFORE DISCONNECTING THE SUPPLY.** Do not use the appliance if the cord is damaged or worn.
- 9) Mow only in daylight or in good artificial light;
- 10) Avoid operating the equipment in wet grass, where feasible;
- 11) Always be sure of your footing on slopes;
- 12) Walk, never run;
- 13) For wheeled rotary machines; mow across the face of slopes, never up and down;
- 14) Exercise extreme caution when changing direction on slopes;
- 15) Do not mow excessively steep slopes;
- 16) Use extreme caution when reversing or pulling the lawnmower towards you;
- 17) Stop the blades if the lawn mower has to be tilted for transportation when crossing surfaces other than grass, and when transporting the lawn mower to and from the area to be mowed;
- 18) Never operate the lawnmower with defective guards, or without safety devices, for example deflectors and/or grass catchers, in place;
- 19) Start or switch on the motor carefully according to instructions and with feet well away from the blades;
- 20) Do not tilt the lawnmower when starting switching on the motor, except if the lawnmower has to be tilted for starting. In this case, do not tile it more than absolutely necessary and lift only the part which is away from the operator;
- 21) Do not start the motor when standing in front of the discharge chute;
- 22) Do not put hands or feet near or under rotating parts. Keep clear of the discharge opening at all times
- 23) Never pick up or carry a lawnmower while the motor is running;
- 24) Stop the motor and disconnect the plug. Make sure that all moving parts have come to a complete stop.
 - whenever you leave the machine;
 - before clearing blockages or unclogging chute;
 - before checking, cleaning or working on the lawnmower;

- after striking a foreign object. Inspect the lawnmower for damage and make repairs before restarting and operating the lawnmower;
 - If lawnmower starts to vibrate abnormally (check immediately);
 - inspect for damage;
 - replace or repair any damage parts;
 - check for and tighten any loose parts.
- 25) Stop the mower:
- whenever you leave the lawnmower;
- 26) Keep all nuts, bolts and screws tight to be sure the equipment is in safe working condition;
- 27) Check the grass catcher frequently for wear or deterioration;
- 28) Replace worn or damaged parts for safety;
- 29) No to use the lawnmower if the cords are damaged or worn;
- 30) Not to connect a damaged cord to the supply or touch a damaged cord before it is disconnected from the supply. A damaged cord can lead to contact with live parts;
- 31) Not to touch the blade before the machine is disconnected from the supply and the blade have come to a complete stop;
- 32) To keep extension cords away from the blade. The blade can cause damage to the cords and lead to contact with live parts;
- 33) To disconnect the supply (i.e. pulling the plug from the socket);
- whenever leaving the machine unattended
 - before clearing a blockage
 - before checking, cleaning or working on the machine
 - after striking a foreign object
 - whenever the machine starts vibrating abnormally
- 34) Children are not allowed to use the machine.
- 35) This appliance is not intended for use by persons with reduced physical, sensory or mental capabilities, or lack of experience and knowledge, unless they have been given supervision or instruction concerning use of the appliance by a person responsible for their safety.
- 36) If the external flexible cable or cord is damaged, it shall be exclusively replaced by the manufacturer or his service agent or a similar qualified person in order to avoid a hazard (not lighter than H05VV-F 2x1.0mm²)
- 37) Instructions for the safe operation of the appliance, including a recommendation that the appliance should be supplied via a Residual Current Device (RCD) with a tripping current of not more than 30 mA.
- 38) Be careful during adjustment of the machine to prevent entrapment of the fingers between moving blades and fixed parts of the machine.
- 39) Always allow the machine to cool before storing.
- 40) When servicing the blades be aware that, even though the power source is switched off, the blades can still be moved.
- 41) Replace worn or damaged parts for safety; Use only genuine replacement parts and accessories.
- 42) Be careful during adjustment of the appliance to prevent entrapment of the fingers between moving blades and fixed parts of appliance.
- 43) If the supply cord is damaged, it must be replaced by the manufacturer, its service agent or similarly qualified persons in order to avoid a hazard.

3. GENERAL IDENTIFICATION

- 1.Trigger
- 2.Upper handle
- 3.Button
- 4.Switch box
- 5.Knob
- 6.Cable hook
- 7.Down handle
- 8.Grass box
- 9.Wheel
- 10.Motor cover
11. Down housing
12. Middle housing
- 13.Cable clip

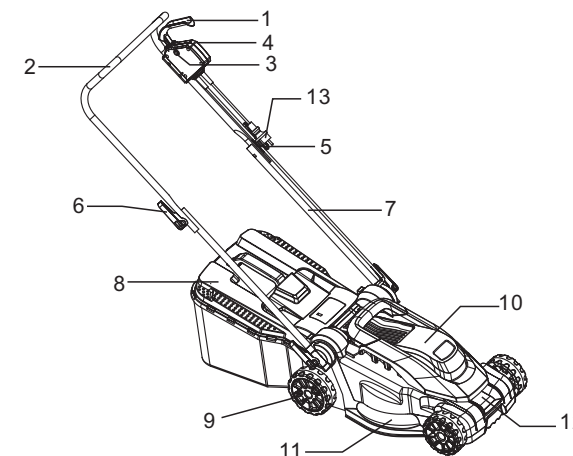

4. TECHNICAL DATA

Model:	QT3025-2
Rated voltage:	110-120V~
Rated frequency:	60Hz
Rated power:	1200W
No load speed:	3500/min
Grass catcher capacity	25L
Cutting width:	320mm
Net weight:	9.3kgs
Degree of protection against liquid:	IP24
Height adjustment :	20-35-50mm, 3 adjustment
Sound pressure level at the operator's position	83dB(A) K=3 dB(A)
Measured sound power level	93.4dB(A) K=2.13dB(A)
Guaranteed sound power level	96dB(A)
Vibration	max.2.88m/s ² K=1.5 m/s ²

5. ASSEMBLY

5-1 ASSEMBLY THE FOLDING HANDLE

- A) Fix the lower handlebars into the unit body with locking knobs as Fig. 2A./Fig.2B/Fig.2C shown.
B) Connect the upper handle and the lower handle with the locking knob. (Fig.2D/Fig.2E/Fig.2F)
C).Attach the cable clamp to the position shown and then attach the cable (Fig.2G) .



Fig.2A



Fig.2B



Fig.2C

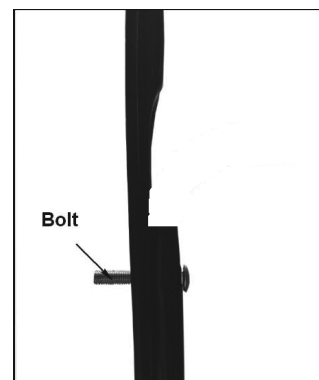

Fig.2D

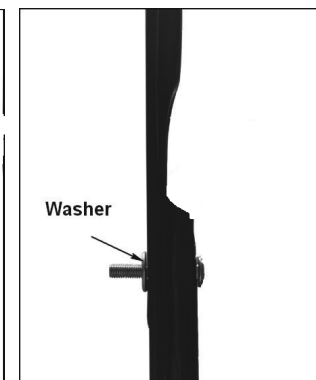

Fig.2E

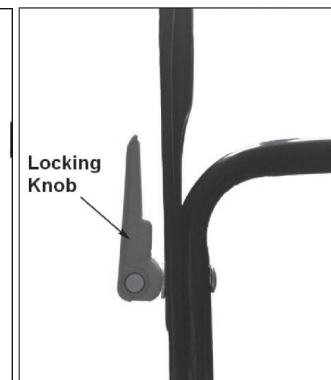

Fig.2F

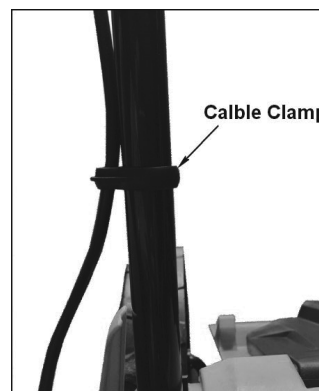

Fig.2G

5-2 ASSEMBLY THE GRASS CATCHER

1. Take out grass box bracket and collection bag , then clip the collection bag into the bracket.
2. To fit: Raise the rear cover and hitch the grass catcher on rear of mower. (Fig.3A/Fig.3B/Fig.3A1/Fig.3B1/Fig.3C1)
2. To remove: grasp and lift the rear cover, remove grass catcher.

There is a level indicator on the top of the grass catcher that shows whether the catcher is empty or full :
- The level indicator inflates if the catcher is not full during the moving. (Fig. 3E)
- If the catcher is full, the indicator collapses; once this happens, stop moving immediately and empty the catcher, make sure it is clean and ensure its meshwork is ventilated. (Fig. 3D)

▲ IMPORTANT:

If the position of indicator opening is very dirty, the indicator will not inflate-in this case, clean the position of indicator opening immediately.



Fig.3A

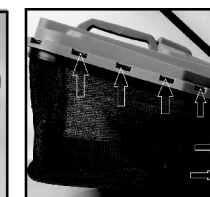

Fig.3B



Fig.3A1



Fig.3B1



Fig.3C1



Fig.3D



Fig.3E

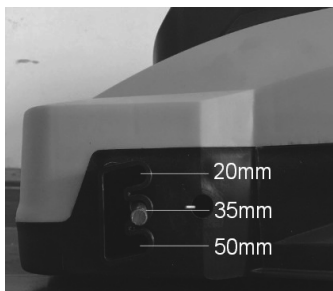

6. ADJUSTMENT OF CUTTING HEIGHT

Apply to different height of grass, lawnmower can adjust height at 3 positions(20-35-50mm). Please adjust four wheels to the same lever to make the lawn mower steady.

▲ WARNING: Make this adjustment only when the blade is stopped.

▲ WARNING: Disconnect the electric cord from the power supply.

7. SAFETY PRECAUTIONS

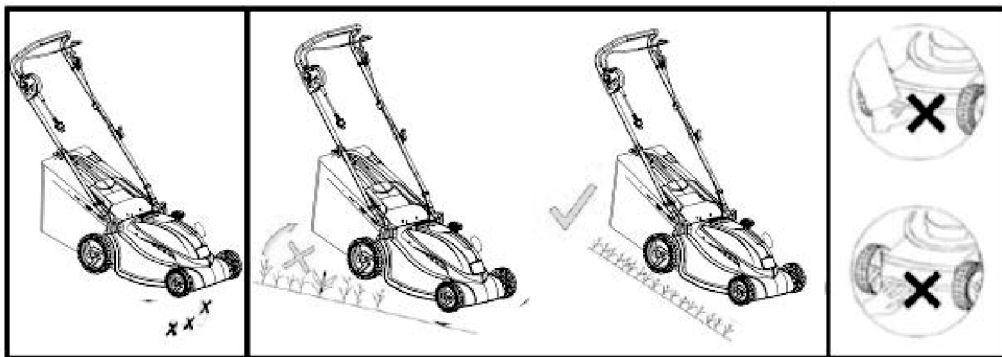

Fig.5A

Fig.5B

Fig.5C

- Always operate with the deflector or grass catcher in the correct position.
 - Always stop the motor before removing the grass catcher or adjusting the height of cutting position.
 - Before mowing, remove all foreign objects from the lawn which may be thrown by the machine.
- While mowing, stay alert for any foreign objects which may have been missed. (Fig.5A)
- Never lift the rear of the mower while starting the motor or during normal operation. (Fig.5B)
 - Never place your hands or feet underneath the underpan or into the rear discharge chute while the motor is running. (Fig.5C)

8. STARTING

8.1 STARTING

Before connecting up the lawn mower to the electric power supply, make sure that the mains supply voltage is 230-240V~ 50Hz.
Before start the lawn mower, fixed the extension cord with the machine as the Fig.6A shown.

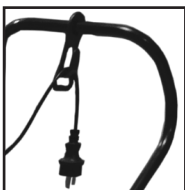

Fig.6A

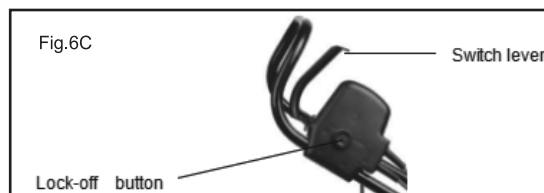

Fig.6C

- Start the motor as follows (Fig.6C)
- Press the safety push-button (1).
 - And meanwhile, pull the switch handle (2), and keep it in grasp.

If you release the switch handle, the motor will stop.

▲ CAUTION! The blade starts turning as soon as the motor is started.

▲ WARNING! Cutting elements continue to rotate after the motor is switch off.

8.2 FOR THE BEST RESULTS WHEN MOWING

Clear lawn of debris. Be sure that the lawn is clear of stones, sticks, wire or other foreign objects which could be accidentally thrown out by the mower in any direction and cause serious personal injury to the operator and others as well as damage to property and surrounding objects. Do not cut wet grass. For effective mowing do not cut wet grass because it tends to stick to the underside of the deck preventing proper mowing of the grass clippings. Cut no more than 1/3 the length of the grass. The recommended cut for mowing is 1/3 the length of the grass. Ground speed will need to be adjusted so the clippings can be dispersed evenly into the lawn. For especially heavy cutting in thick grass it may be necessary to use one of the slowest speeds in order to get a clean well mowed cut. When mowing long grass you may have to cut the lawn in two passes, lowering the blade another 1/3 of the length for the second cut and perhaps cutting in a different pattern than was used the first time. Overlapping the cut a little on each pass will also help to clean up any stray clippings left on the lawn. The mower should always be operated at full throttle to get the best cut and allow it to do the most effective job of mowing. Clean underside of deck. Be certain to clean the underside of the cutting deck after each use to avoid a build-up of grass, which would prevent proper mulching. Mowing leaves. The mowing of leaves can also be beneficial to your lawn. When mowing leaves make sure they are dry and are not laying too thick on the lawn. Do not wait for all the leaves to be off the trees before you mow.

▲ WARNING: if you strike a foreign object, stop the motor. Pull out the mains plug, thoroughly inspect the mower for any damage and repair the damage before restarting and operating the mower. Extensive vibration of the mower during operation is an indication of damage. The unit should be promptly inspected and repaired.

9. BLADE

The blade is made of pressed steel. It will be necessary to reshape it frequently (with a grind wheel). Ensure that it is always balanced (an unbalanced blade will cause dangerous vibrations). To check for balance, insert a round rod through the central hole and support the blade horizontally. A balance blade will remain horizontal. If the blade is not balanced the heavy end will rotate downwards. Reshape the heavy end until the blade is currently balanced. To remove the blade (1), unscrew the blade screw (2) and replace any parts, which are damaged.
When reassembling, make sure that the cutting edges face in the direction of the motor rotation. The blade screw (2) must be torque to 20N.m.

▲ WARNING: For service, replace the blade with QY blade: 7075-302501

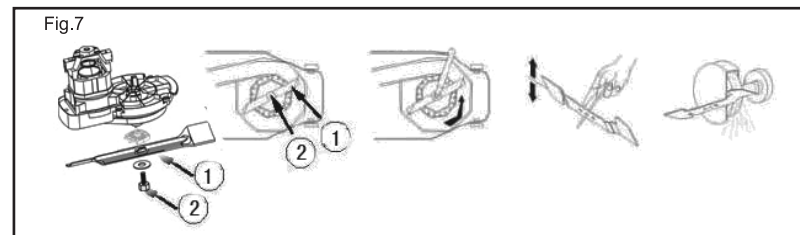

Fig.7

▲ WARNING: Disconnect the electric cord from the power supply.

▲ WARNING: Protect hands by using heavy gloves or a rag to grasp the cutting blades when replace the blade.

10. EXTENSION CORDS

You should only use extension cords for outdoor use, PVC ordinary duty with a cross sectional area not less than 1.0mm²(not lighter than H05VV-F 2x1.0mm²)
Before using, check the supply and extension cords for signs of damaged during use, disconnect the cord for signs of damage or aging. If the cord becomes damaged during use, disconnect the cord from the supply immediately. **DO NOT TOUCH THE CORD BEFORE DISCONNECTING THE SUPPLY.** Do not use the appliance if the cord is damaged or worn. Keep extension cord away from cutting elements.

▲ Warning: Always ensure that the ventilation openings are kept clear of debris.

11. MAINTENANCE AND CARE

▲ Warning: Before performing any Maintenance or cleaning work, always pull out the mains plug!

Do not spray the unit with water. Ingress of water may destroy the Switch-plug combination unit and the electric motor. Clean the unit with a cloth, hand brush, etc.
Expert inspection is required, do not make any adjustment by yourself, must contact to customer Service centre:

- if the lawn mower strikes an object.
- if the motor stops suddenly
- if the blade is bent (do not align!)
- if the motor shaft is bent (do not align!)
- if a short-circuit occurs when the cable is connected.
- if the gears are damaged.
- if the V-belt is defective.
- use only manufacturer's recommended replacement parts and accessories.

12. TROUBLESHOOTING

Fault

Remedial action

Motor does not run	Check mains connection cable Start on short grass or on an area which has already been mown. Clean discharge channel/housing –the mowing blade must rotate freely. Correct the cutting height. Check motor carbon brush, if discover finished, please replace
Motor power drops	Correct the cutting height. Clean discharge channel/housing Have mowing blade resharpened /replaced →customer service centre.
Grass catcher is not filled	Correct the cutting height Allow the lawn to dry Have mowing blade resharpened /replaced →customer service centre. Clean the grille on the grass catcher Clean the discharge channel /housing

▲ Warning: Before performing any maintenance or cleaning work, always pull out the mains plug and wait until the cutter has come to a standstill.

▲ CAUTION! Faults which can not be rectified with the aid of this table may be rectified by a specialist company only (customer service centre).

13. ENVIRONMENTAL FRIENDLY DISPOSAL



According to EU directive 2012/19/EU on electric and electronic equipment and its implementation into national law, all electric tools must be separately collected and environmentally friendly recycled. Alternative disposal: If the owner of the power tool does not return the tool to the manufacturer, he is responsible for proper disposal at a designated collection point that prepares the device for recycling according to national recycling laws and regulations.

Welcome to visit our website and purchase our quality products!

Your suggestions and comments for COSTWAY are really important to us!

We sincerely solicit you to go back to our shop and leave a good rating in just a simple click. It would be quite encouraging if you could kindly do so like below:

★★★★★ Great products so far

February 24, 2019

Great products so far. Fast delivery, easy setup, and working without any issues.

With your inspiring rating, COSTWAY will be more consistent to offer you EASY SHOPPING EXPERIENCE, GOOD PRODUCTS and EFFICIENT SERVICE!

US office: Fontana, California

UK office: Ipswich



- * Reward Points
- * Exclusive Customer Service
- * Personalized Recommendations
- * Permanent Shopping Cart
- * Order History

5 Star Rating



We would like to extend our heartfelt thanks to all of our customers for taking time to assemble this product and giving us valuable feedbacks.

THANK
you
😊