



**COSTWAY**

**COSTWAY**



## USER'S MANUAL

### Children's Electric Ride on Car TQ10022

THIS INSTRUCTION BOOKLET CONTAINS **IMPORTANT** SAFETY INFORMATION. PLEASE READ AND KEEP FOR FUTURE REFERENCE.

#### **Please give us a chance to make it right and do better!**

Contact our friendly customer service department for help first.

Replacements for missing or damaged parts will be shipped ASAP!

#### **Follow Costway**



# Contact Us!

## Do NOT return this item.

Contact our friendly customer service department for help first.



# Before You Start

Please read all instructions carefully and keep it for future reference.

### Warnings:

Attention! Use it with protective equipment.

Attention! Not use it in the traffic.

Attention! The product is not suitable for the children under 3 years.

### General Warnings:

- ⚠ The product must be installed and used under the supervision of an adult.
- ⚠ Read through each step carefully and follow the proper order.
- ⚠ Remove all packaging, separate and count all parts and hardware.
- ⚠ Please ensure that all parts are correctly installed, incorrect installation can lead to a danger.
- ⚠ We recommend that, where possible, all items are assembled near to the area in which they will be placed in use, to avoid moving the product unnecessarily once assembled.
- ⚠ Ensure a secure surface during construction, and place the product always on a flat, steady and stable surface.
- ⚠ Please use the product carefully, as the product requires great skill, avoid accidents by the user or others, by fall or collision.
- ⚠ Please wear suitable protective equipment during use, e.g. protective helmet, gloves, knee pads, elbow pads etc.



Item: DK-HL850

Toyota Hilux Ride On Car  
Age Range: 37-95 Month  
Maximum Weight: 110 LBS  
Execution Standard:  
GB6675&GB19865  
EN71&EN62115  
ASTM-F963



## Specifications

Item	DK-HL850
Battery&Motor	<b>Battery: 2 * 12V 10AH</b> <b>Motors : 4*DL550 DC12V PO20-45W RPM12000</b>
Available Ages	Children from 37-95 month
Maximum Weight	<b>110 lbs</b>
Size	<b>54" x 36.5" x 29"</b>
Speed	3-5km/h (For 12V) 6-8km/h (For 24V)
Charging Time	8-12hours
Remote Control Batteries	2PCS of AAA Batteries <b>(Not included)</b>
Charger	Input: 220V/110V Output:DC12V1000MA /DC 24v1000MA

## Charging the Drive Battery:



**IMPORTANT!** Before using the unit for the first time the battery needs to be charged for at least **8 to 12 hours** - no more than **20 hours**. Once battery is depleted, recharge for **8 to 12 hours** - no more than **20 hours**.

### IMPORTANT!

Check the drive battery and charger (supply cord, connector) for wear and damage before charging. Do not charge the battery if damage has occurred. Only replace with the same type and voltage rechargeable battery and charger supplied by the manufacturer.

- Only use the rechargeable battery (or equivalent replacement) and charger supplied with your vehicle.
- Always turn power off and charge battery after riding.
- The drive battery should be charged when depleted, or if not used regularly, once a month. Failure to charge the battery as directed will cause permanent damage to the battery and will void the warranty.

### STEPS:

1. Locate Charging Port.
2. Plug Charger plug into unit Charging Port.
3. Plug Charger into Wall outlet.
4. When battery is fully charged, unplug charger from the wall outlet and disconnect from charger port.

**NOTE:** The charger may feel warm during the charging. If excessively hot, unplug and replace.

**NOTE:** This product has charging protection: When charging, all functions are turned OFF.

## Installation procedure

### Assembly

① Car body 1PC	② Front windshield 1PC	③ Hood 1PC	④ Steering wheel 1PC
⑤ Roll bar 1PC	⑥ Seat 2PCS	⑦ Front wheels 2PCS	⑧ Back wheels 2PCS
⑨ Wheel covers 4PCS	⑩ Rear-view mirrors 1 Pair	⑪ Charger 1PC	⑫ Remote control 1PC
⑬ Manual 1PC	⑭ Air scoop 1PC	⑮ Bag of screws&nuts	⑯ Key 2PCS
⑰ Tools of M10 screw 2PCS			

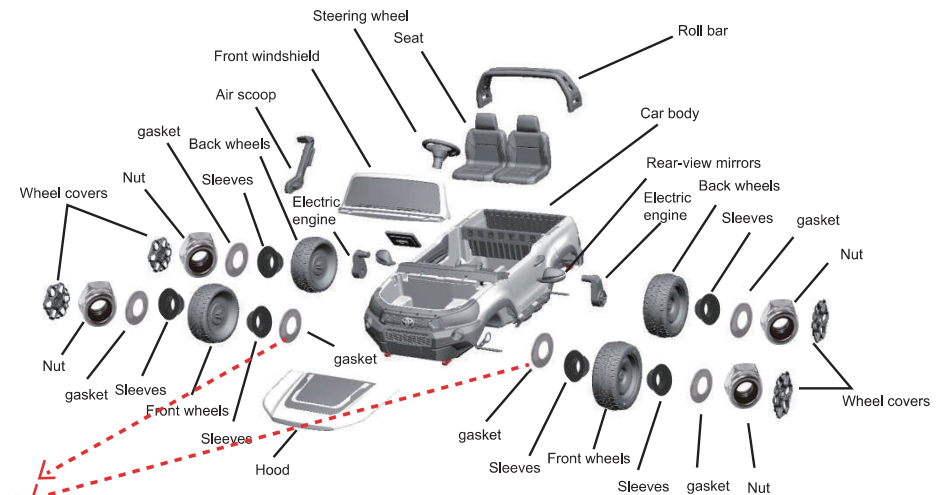

These 2 gaskets are only used under two motors version.

All of the sleeves are only used with EVA wheels.

### 1.Install Driving Motors

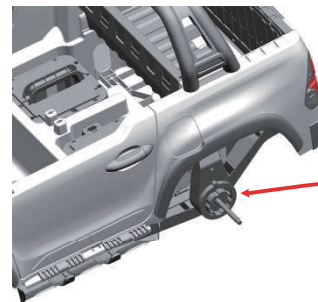

Take out the drive motors(left&right), and turn over the car body, install drive motors onto the rear axle.

## Installation procedure

### 2.Install Wheels

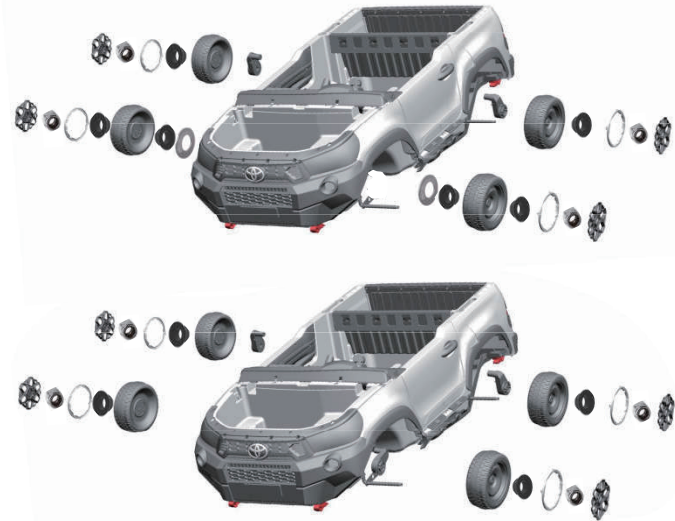

Assembly

- 1). Under two motors situation: Front wheels: gasket-(sleeves)-wheel-(sleeves)-gasket-screw-wheel cover  
Back wheels: steering motor-wheel-(sleeves)-gasket-screw-wheel cover
- 2). Under four motors situation: Front wheels: wheel-(sleeves)-gasket-screw-wheel cover  
Back wheels: steering motor-wheel-(sleeves)-gasket-screw-wheel cover

### 3.Install Back Driving Motors:

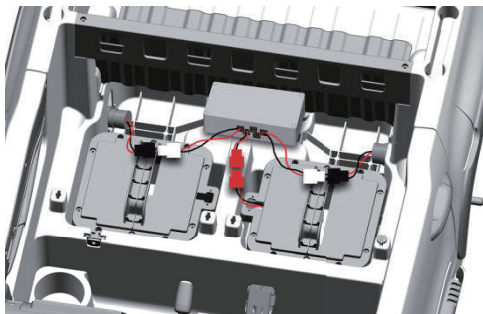

- 1) Make the car body straight
- 2) Connect back driving motors and power.

## Installation procedure

### 4.Install Roll Bar

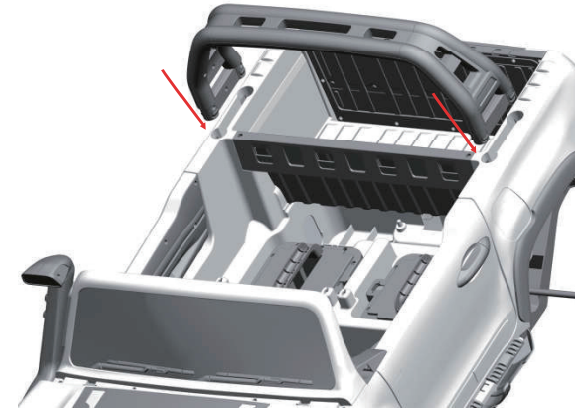

Aim the roll bar at the sockets of car body, press directly.

### 5.Install seats



Install seat and make the fastener into the sockets, and rotate 90° to lock well.



## Installation procedure

### 6. Install Steering wheel



Connect button line of steering wheel with body line and install steering wheel directly.

### 7. Install Front Windshield



Make two sides of the windshield into the sockets and lock in with screws.

Assembly

## Installation procedure

### 8. Install Air Scoop



Install air scoop directly into the socket of car body, and use the screws to lock in with **inner side** of car body and front windshield.

### 9. Install Hood



- 1) Insert two buckles at the back part of hood into the two sockets of front windshield and fix.
- 2) Insert two pillars at the front part of hood into the holes of car body.

## Installation procedure

### 10.Install Rear-view Mirrors

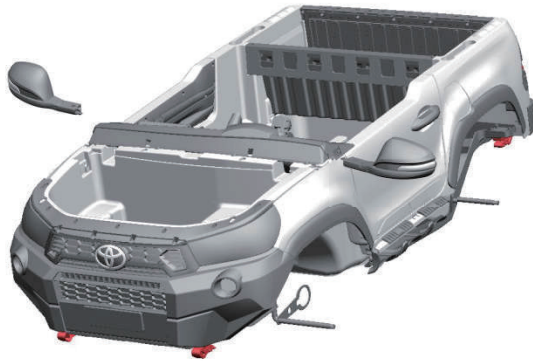

Assembly

Install rear-view mirrors of both sides into the sockets of instrument desk.

### 11.Connect with Remote Control

#### 2.4G Remote Control Instructions

For the first time need to code,this product has a memory function, **when the battery is replaced** next time, you do not need to match the code Once again.

- ①.Long press "M" button more than three seconds, until the first LED light is flashing.
- ②.Turn on the power, the LED indicator will stay on, indicating that the pairing is successful.
- ③.The remote control will automatically enter standby mode for 10 seconds without any operation, and then press any key to wake it up.
- ④.Key Description: "△" Forward, "▽" Back,"◁" Left, "▷" Right, "S" Speed, "P" Stop.  
Press the "S" key to set the speed, one light is on for low speed, two lights for medium speed, and three lights for high speed. When the car is reversing, it can only run in low speed.  
Press the "P" button to keep the brake, all indicator lights flash, press the brake button again to release the brake.

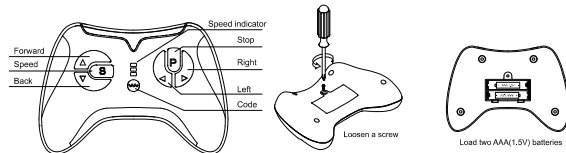

**WARNING!** Not for children under 3 years. Small parts. Choking hazard

- Load two AAA ( 1.5V ) batteries according to the diagram.
- Non-rechargeable batteries are not to be recharged.
- Different types of batteries or new and used batteries are not to be mixed.
- Batteries are to be inserted with the correct polarity.
- Exhausted batteries are to be removed from the toy.
- The supply terminals are not to be short-circuited.
- The packaging must be retained since it contains important information.

## Instructions

**Warning-When replacing a replaceable battery,first open the lid and take out the old battery.Put in the new battery,pay attention to the positive and negative poles,cover the lid.**



### WARNING!

For safety reasons,

- \*please use this vehicle under adult guidance and supervision.
  - \*do not use this product on main roads, slopes, highways or other dangerous places.
  - \*children must wear shoes and protective gears when operating the vehicle.
  - \*children should be seated with the seat belt fasten when driving.
  - \*only load a maximum of 110 lbs on the vehicle.
  - \*only children aged 37 - 95 months should be allowed on this vehicle.
  - \*use this toy strictly according to safety manual.
  - \*please check the tires, breaks, steering wheels, seats and seat belts before operating vehicle.
  - \*this toy vehicle should be used with caution and requires skill to avoid fall or collision with third parties.
  - \*Non-rechargeable batteries are not to be recharged;
  - \*The supply terminals are not to be short-circuited.
  - \*Rechargeable batteries are to be removed from the toy before being charged;
  - \*The toy should be regularly examined for damage to the cord, plug, enclosure and other parts,and in the event of such damage, they must not be used until the damage has been repaired.
  - Only use the battery specified by the manufacturer
  - Only use the charger specified by the manufacturer.
- Pictures are for reference only,please adhere to the original Products as standard

**Pictures are for reference only, please adhere to the original products as standard**

## Instructions

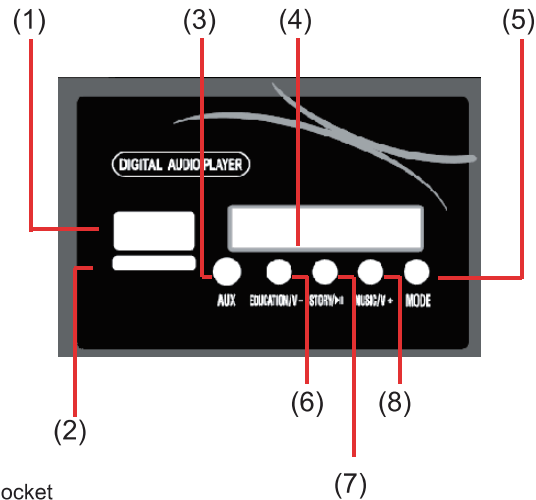

- 1.USB socket
- 2.TF socket
- 3.MP3 socket
- 4.Disply
- 5.MODE choose(Radio/Bluetooth/TF card/USB connector)
- 6.Education(Pressing for a longer time and it will decrease the volume)
- 7.Story(Play/ Pause under the Bluetooth/TF/USB functions)
- 8.Music(Pressing for a longer time and it will increase the volume)

## Function indication

**On the premise that the battery has been correctly connected,start the trolley circuit system**

The connection of steering wheel includes button connection

Forward and backward switch

Key switch



Song switching and horn button

Assembly

## Instructions

Assembly

**Be careful**

- 1.When the vehicle is running,do not switch the push handle forward and backward to avoid damaging the gearbox and motor.
- 2.In manual mode,the vehicle can run only when the foot switch is pressed.
- 3.The remote control is used by the guardian.

**Problem: The car does not move.**

Answer : The battery is low, please charge for 8-12 hours but not exceeding 20 hours.

Charge at least once a month to keep the battery cells active.

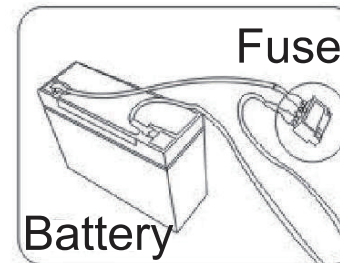

**Fuse**

**Battery**

To avoid short fuse or power cut off:

1. Do not overload the product. Max load is **110 lbs** .
2. Do not drag any item behind this product.
3. Do not allow water or any liquid into electric parts.
4. Do not change wire system without a professional.

## TROUBLESHOOTING

**Problem:The car only runs for a short time**

Answer 1: The battery is low, please charge for 8-12 hours but not exceeding 20 hours.

Charge at least once a month to keep the battery cells active.

Answer 2: The battery may need to be replaced depending on its charging history and age.

**Problem: The sound does not work.**

Please ensure the volume is turned up and the MP3 line is not connected. Sounds from steering wheel will not work when MP3 is plugged in.

**Problem: Charger overheating**

It is normal for battery and charger to be slightly warm during charging. If the charger feel excessively hot, please check for a current overload or battery short circuit.

## Instructions

## SAFETY PRECAUTIONS

Assembly

01. While driving , adult supervision is required all the time
02. Always wear a helmet when driving
03. Please don't drive near road or on the footpath.
04. It is not recommended to drive the vehicle on wet surface or on slope greater than 15-degree.
05. It is recommended to drive this vehicle on smooth surface only.
06. Please don't drive this vehicle outdoors when it is raining.
07. Make sure that the vehicle **stopped** completely before changing direction from forward to reverse
08. Please don't allow children to operate the charger or play with the battery
09. Clean the vehicle with a dry cloth only.
10. Please follow the correct weight and age limits allowed to drive this vehicle.
11. It is prohibited to change the circuit or add other electric parts.
12. Adults must teach their children about safe driving procedures.
13. Please turn the power off when not in use.
14. Check the seat to ensure it has been fitted and secured with a bolt before driving.
15. Inspect all wires and connection of the vehicle periodically.
16. Charging the battery should only be done by adults.
17. Charging plug is located underneath the seat.
18. In order to avoid accidents, please ensure the vehicle is safe before driving.
19. Please don't let children touch the wheels or be near them when the car is moving.
20. Please mind fingers when opening and closing doors.

**WARNING:**

**To reduce the risk of injury, adult supervision is required. Never use in roadways, near motor vehicles, on or near steep inclines or steps, swimming pools or other bodies of water; always wear shoes, and never allow more than 2 riders.**