

**COSTWAY®**



## **USER'S MANUAL**

**Ride On Car  
TY327424**

THIS INSTRUCTION BOOKLET CONTAINS **IMPORTANT** SAFETY INFORMATION. PLEASE READ AND KEEP FOR FUTURE REFERENCE.

**Please give us a chance to make it right and do better!**

Contact our friendly customer service department for help first.

Replacements for missing or damaged parts will be shipped ASAP!

**Follow Costway**

Visit us: [www.costway.com](http://www.costway.com)



# Contact Us!

## Do NOT return this item.

Contact our friendly customer service department for help first.



# Before You Start

Please read all instructions carefully and keep it for future reference.

### Warnings:

**Attention!** Use it with protective equipment.

**Attention!** Not use it in the traffic.

**Attention!** The product is not suitable for the children under 3 years.

### General Warnings:

- ⚠ The product must be installed and used under the supervision of an adult.
- ⚠ Read through each step carefully and follow the proper order.
- ⚠ Remove all packaging, separate and count all parts and hardware.
- ⚠ Please ensure that all parts are correctly installed, incorrect installation can lead to a danger.
- ⚠ We recommend that, where possible, all items are assembled near to the area in which they will be placed in use, to avoid moving the product unnecessarily once assembled.
- ⚠ Ensure a secure surface during construction, and place the product always on a flat, steady and stable surface.
- ⚠ Please use the product carefully, as the product requires great skill, avoid accidents by the user or others, by fall or collision.
- ⚠ Please wear suitable protective equipment during use, e.g. protective helmet, gloves, knee pads, elbow pads etc.

# About Your New Ride-On

On the purchase of your new Ride-On.

This ride-on car will provide your child with many miles of riding of enjoyment. To help assure you and your rider a safe ride we ask you to please read this manual carefully, and keep it for future reference.

Follow the recommendations in this manual, they are designed to improve the safety and operation of your ride-on car and it's rider.

Suitable age	37-96Months	Battery	12V 7AH*1 or 6v7AH*2
Load capacity	77 LBS	Size of car	115*76*75CM
Speed	3-5km/h	Power way	Charging type
Charge	Input:depend on local voltage Output:DC 12V 1000mA	Average battery life	Approximately 300 times
Charge time	8-12 hours	Fuse	10A/20A

## Part List

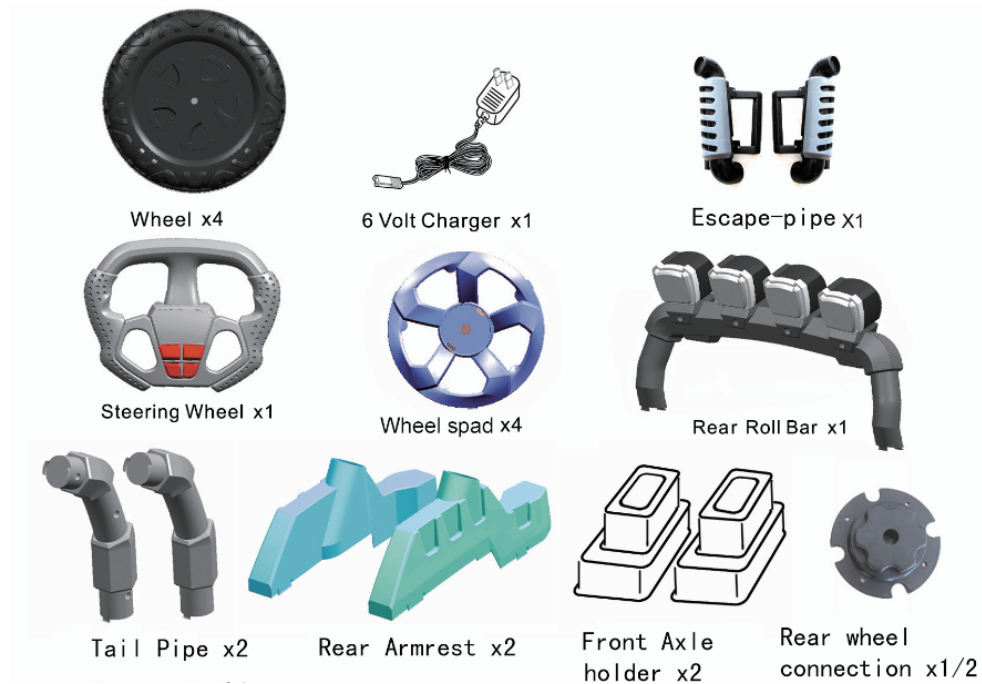

## Screw Packing

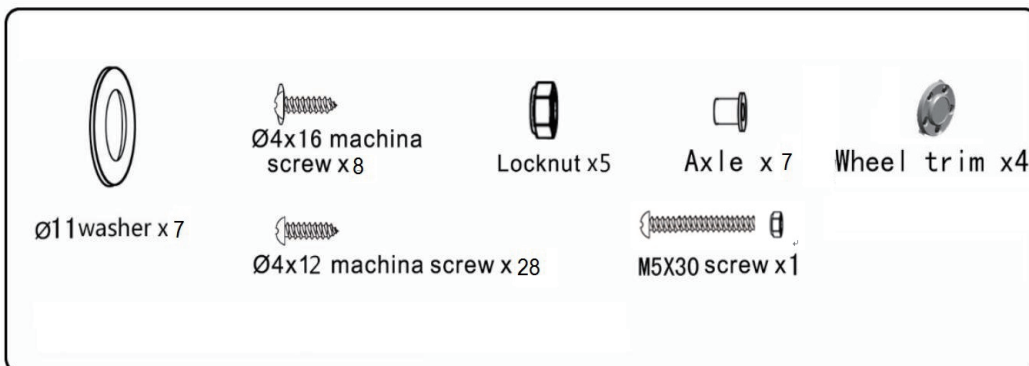

## Part Diagram

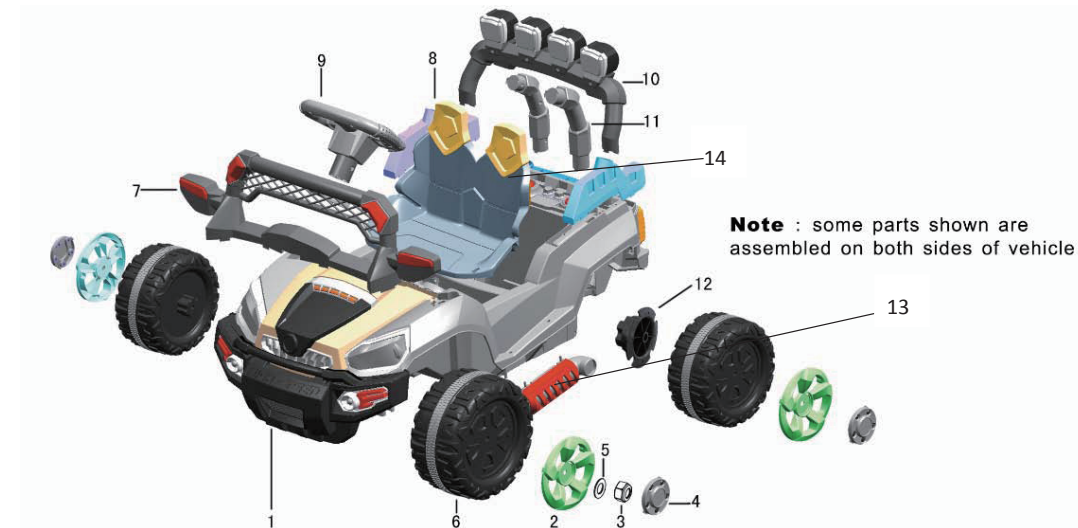

1.Vehicle Body*1	2.Wheel spad*4
3.Locknut*4	4.Wheel trim*4
5.Φ10 Washers*7	6.Wheel*4
7.Dash Board*1	8.Backrest*1
9.Steering Wheel*1	10.Rear Roll Bar*1
11.Tail Pipe*2	12.Real wheel connection*1/2
13.Vent Pipe	14.Seat

## Before You Begin Assembly

### **WARNING!**

FOR THE SAFETY OF YOUR CHILD, PLEASE READ ALL WARNINGS AND ASSEMBLY/USE INSTRUCTIONS. KEEP THIS GUIDE FOR FUTURE REFERENCE.

- **ADULT ASSEMBLY REQUIRED.** The product contains small parts, which are for adult assembly only. Keep children away when assembling.
- Always remove protective material and poly bags and dispose before assembly.

- Make sure that the power switch is **turned "OFF"** before assembling the rideon.
- Before first time use, charge the battery for at least 4 to 6 hours.
- Assembly tools required:

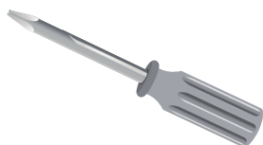

Screwdriver  
(not included)



Long nose pliers  
(not included)

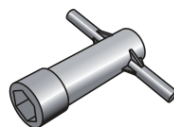

Spanner



### **BATTERY INFORMATION!**

- Non - rechargeable batteries are not to be recharged.
- If removable rechargeable batteries are used, they are only to be charged under adult supervision.
- Remove rechargeable batteries from the product before charging.
- Do not mix old and new batteries. Do not mix different types of batteries: alkaline, standard (carbon-zinc) or rechargeable (nickel-cadmium).
- Insert batteries as indicated inside the battery compartment, anode to anode, cathode to cathode.
- Remove batteries during long periods of non-use. Always remove exhausted batteries from the product. Battery leakage and corrosion can damage this product. Dispose of batteries safely.
- Never short circuit the battery terminals.

## Assembly steps

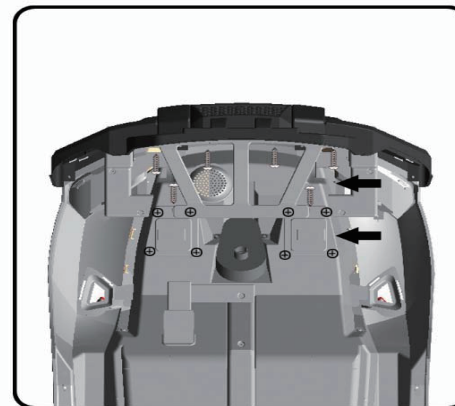

### Assemble front axle holder & front

#### insurance holder

- With 4\*16 screws fixed the front axle holder.
- With 6 only 4\*12 screws fixed the front insurance holder

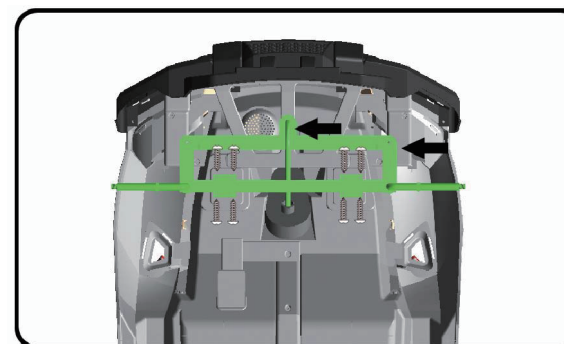

### Assemble Steering Rod & Front Axle

- Insert the steering end of steering shaft up through the hole on the front of vehicle body from bottom side to dash board.
- Insert the bent end of steering shaft through the hole in the front axle plate, use 8 pcs 4\*12 machine screw to lock it.
- Put a gasket the end of steering rod and then use M10 machine screw to lock it.

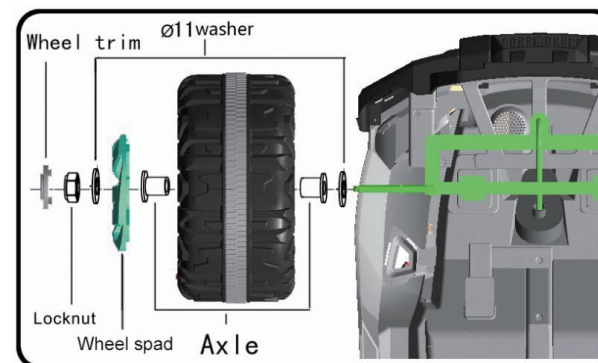

### Assemble Wheel:

- Screw off the nut from the axle, take the  $\Phi 11$  washer and round bushing out.
- Slide the round bushing (ring end first) onto the axle.
- Slide the wheel (ribbed side first) onto the axle. Slide the  $\Phi 11$  washer onto the axle.
- Fasten the locknut by a spanner, lastly insert a decoration cover into the wheel cover. Remember to follow the same steps for the other wheel.



## Assembly steps

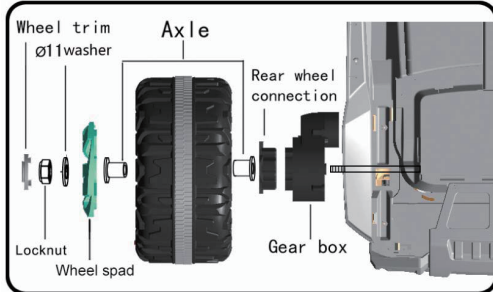

### Assemble real driving wheel

- First the gear case onto the rear axle.
- Connect the cable of the motor and the cable of the car.
- Slide the driving wheel onto the rear axle. Make sure the driving wheel inserts onto the pins in the gear case.
- Slide the  $\Phi 11$  washer onto the rear axle. Fasten locked by a spanner, lastly insert a decoration cover into the wheel cover.

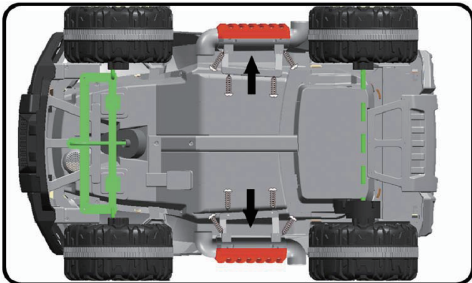

### Assemble Escape-pipe

Will escape-pipe bracket hole and car body on the corresponding feet fit well. Than with 4\*12 self-tapping fixed.

### Assemble of steering wheel

Screw off the nut from the steering wheel. Insert the steering wheel onto the end of the steering column. Pay attention to the steering wheel front and back. With 4\*12 screws 2 to around the escape-pipe which the body in turn.



### Assemble axle

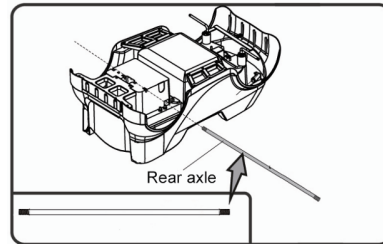

### Assemble Dash board

Insert the dash board into the holes on vehicle.

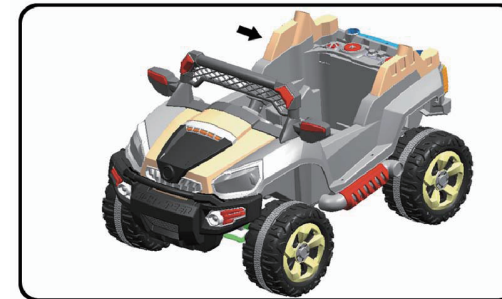

### Assemble Rear Armrest

Insert the rear armrest into the holes on vehicle.

The light of the line on the right body through the armrest.



### Assemble Rear roll bar

Insert the holder to alarm lamp, then insert the four feet to car body. Final, use 2 pcs 4\*12 machine screw to lock it.

**CAUTION!** Before assemble the holder, connect the alarm lamp wire with car body wire.



### Assembling seat

Cushion before installation. first connect the battery of car body line, at the same time, the line on the gear box and automobile body line connection. Insert the tabs at the back of the seat into the slots in the vehicle body.

Insert two M4\*12 Machine screws, and tighten with a screwdriver.

## Connect the Power Supply

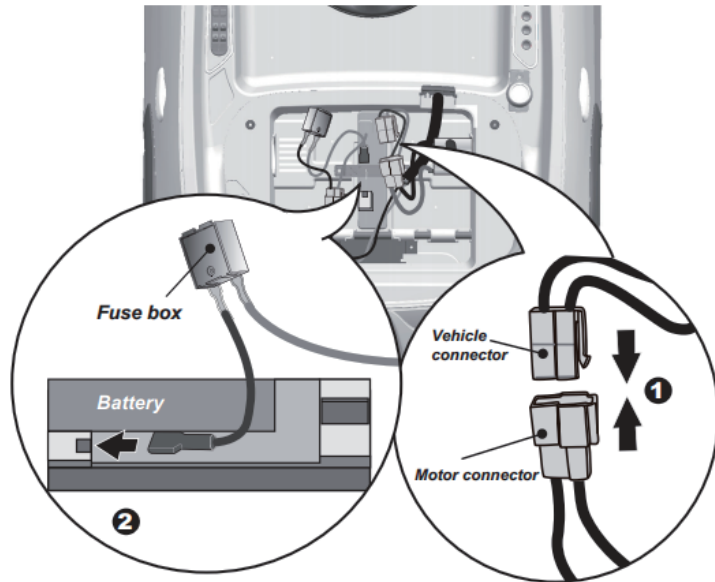

1. Plug the **Vehicle Connector** into the **Motor Connector** on body as shown above.
2. Plug the **Red fuse connector** into the **terminal on battery**.

### 1WD

1. Plug the **Vehicle Connector** into the **Motor Connector** on body as shown above.
2. Plug the **Red fuse connector** into the **terminal on battery**.

### 2WD

1. Plug the **Vehicle Connector** into the **Motor Connector** on body as shown above.  
**Repeat for the other side.**
2. Plug the **Red fuse connector** into the **terminal on battery**.

## Use Safety

### **WARNING!**

#### PREVENT INJURIES AND DEATHS:

- **NEVER LEAVE CHILD UNATTENDED. DIRECT ADULT SUPERVISION IS REQUIRED.**

Always keep child in view when child is in vehicle.

- This toy should be used with caution since skill is required to avoid falls or collisions causing injury to the user or third parties.
- Protective equipment should be worn.
- Never use in roadways, near cars, on or near steep inclines or steps, swimming pools or other bodies of water.
- Always wear shoes.
- Always sit on the seat.
- Not to be used in traffic.
- This toy is unsuitable for children under 37 months due to its maximum speed; Maximum user weight is 77 lbs.
- This toy has no brake.

- This vehicle has adjustable play seat belts. Please instruct children how to tie the safety belt before using, guarantee the security.
- Keep Children within Safe Riding Areas:
  - Never use in roadway, near motor vehicles, on lawn space, on or near steep inclines or steps, swimming pools or other bodies of water;
  - Use the toy only on flat surfaces. Such as inside your house, garden or playground.
  - Never use in the dark. A child could encounter unexpected obstacles and have an accident.
- Operate the vehicle only in the daytime or a well-lit area.
- It is prohibited to change the circuit or add other electric parts
- Inspect wires and connections of the vehicle periodically.
- Do not let any child touch the wheels or be near them when the car is moving .
- This vehicle has adjustable play seat belts. Please instruct children how to tie the safety belt before using, guarantee the security.



## Use Your Ride-on

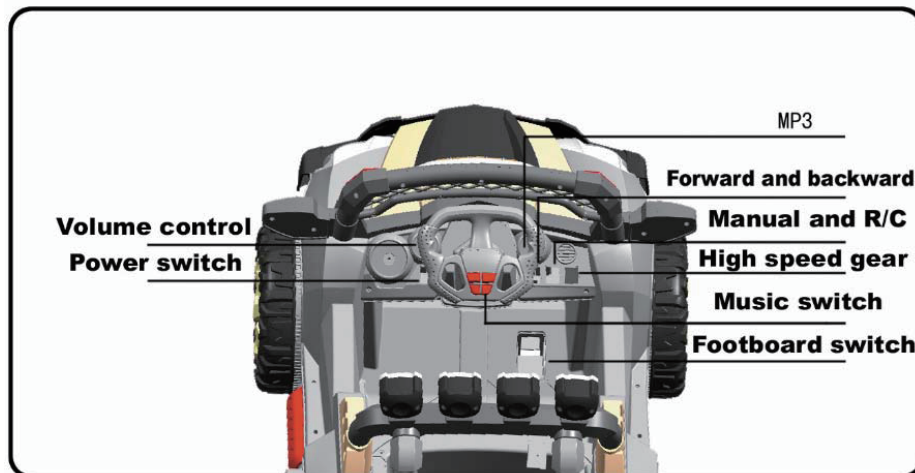

1. **Power Switch:** Turns the vehicle on and off.
2. **Forward/backward switch:** Changes the direction that vehicle moves from forward to reverse.
  - To move the car forward, rock the switch to "forward" position.
  - To move the car backward, rock the switch to "reverse" position.
3. **Music switch:** Press for sounds playing.
4. **Volume knob (OPTIONAL):** Turn the knob clockwise to increase the volume; Turn the knob counterclockwise to decrease the volume.
5. **Footboard switch:** Applies power (speed) to the vehicle.
  - To move the car, press the pedal down.
  - To brake or slow down, release pressure from the pedal.
6. **3.5 mm Audio input connector (OPTIONAL)**
7. **Digital voltmeter (OPTIONAL):** See <Charging>
8. **High speed button (OPTIONAL):** Operates the vehicle to move forward in high speed.
9. **Low speed button (OPTIONAL):** Operates the vehicle to move forward in low speed.
10. **Foot-operating button (OPTIONAL)**
11. **R/C-operating button (OPTIONAL)**

If you buy 2.4G remote control, it don't have this button



## ADVANCED USE - High speed Drive

Make sure your child knows how to steer, how to start and stop the vehicle and knows the rules for safe driving. The vehicle can be driven at a maximum of 3~5 km/h.

## Use the Normal Remote Controller



**WARNING:**

**ADULT OPERATING REQUIRED!**

If you product with a **2.4G REMOTE CONTROLLER**, See the next page please.

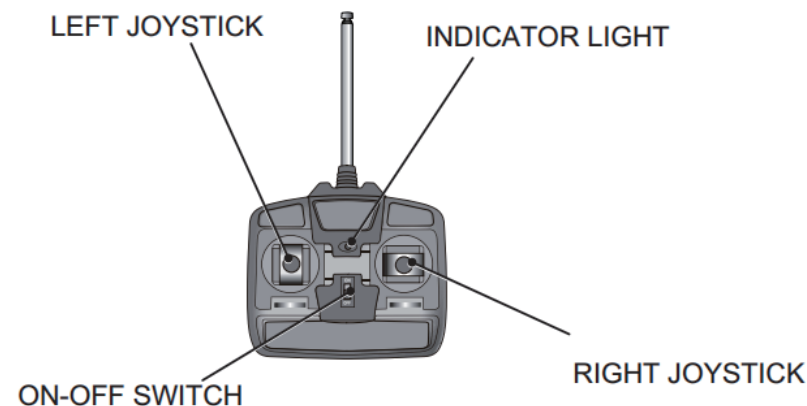

## ASSEMBLY

### OPERATION

1. Insert the antenna into the controller by tweak the antenna clockwise;
2. Lift the battery compartment door on the back of the controller and insert two AA(LR6) batteries.

**NOTE:** This product does not include the **AA(LR6) batteries**.

Follow the battery information on page 4.

## OPERATION

1. Press the FOOT - R/C SWITCH on the vehicle to the "Remote control" position.
2. Press the ON-OFF SWITCH on the remote controller to the "ON" position, the indicator light will be lighting.
3. Push the LEFT JOY STICK to the front, the vehicle goes forward, pull the LEFT JOY STICK to the back, the vehicle goes backward.
4. Push the RIGHT JOY STICK to the left, the vehicle turn left, push the RIGHT JOY STICK to the right, the vehicle turns right.

## Use the 2.4G Remote Controller

If you product with a NORMAL REMOTE CONTROLLER, See the previous page.

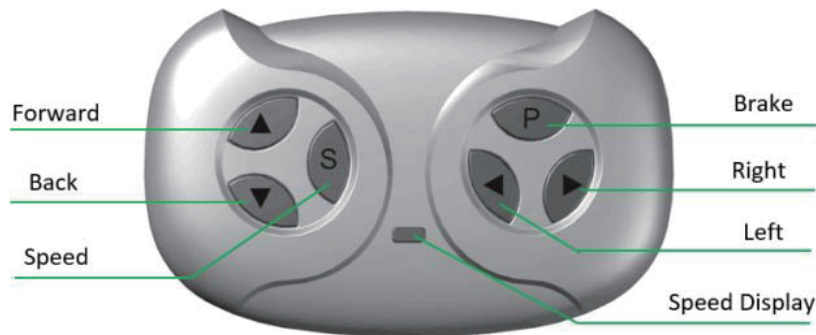

The remote control operation always prior to the foot pedal operation.  
(The foot pedal won't working while you operating the Remote Controller)

### ASSEMBLY

Lift the battery compartment door on the back of the controller and insert two AAA(LR03) batteries.

**NOTE: This product does not include the batteries. Battery information see the page 6**

- First time use need to match code, this product has memory function  
Replace battery is unnecessary match code
- Hold down “▲” & “▼” keys for 3 seconds start match code, The first LED flicker
- Turn on the car body power now, The first LED lit up, Match code Success
- Remoter 10 seconds not run will be standby, Press any key wake up
- Keys caption : “▲” Forward, “▼” Back, “◀” Left, “▶” Right, “S” Speed, “P” Brake.  
Press “S” key set up speed, 1 led lit up is low speed, 2 leds lit up is medium speed, 3 leds lit up is high speed, Back a car is only low speed  
Press “P” key hold the brake, All LED flicker

※ The remote controller only can be used with adult's guidance

### NOTE:

- Leave the remote controller idling for about 10 seconds, it will shut down automatically.
- Repeat step 1 when you replace the batteries of the remote controller.

## Charging

**ONLY AN ADULT CAN CHARGE AND RECHARGE THE BATTERY!**

### **WARNING!**

#### • PREVENT FIRE AND ELECTRIC SHOCK:

- Use the only rechargeable battery and charger supplied with your vehicle. NEVER substitute the battery or the charger with another brand. Using another battery or charger may cause a fire or explosion.
- Do not use the battery or charger for any other product. Overheating, fire or explosion could occur.
- NEVER modify the electric circuit system. Tampering with the electric system may cause a shock, fire or explosion or may permanently damage the system.
- Do not allow direct contact between battery terminals. Fire or explosion can occur.
- Do not allow any type of liquid on the battery or its components.
- Explosive gasses are created during charging. Do not charge near heat or flammable materials. Charge the battery in a well-ventilated area ONLY.
- NEVER pick up the battery by the wires or charger. Damage can occur to the battery and may cause a fire. Pick up the battery by the case ONLY.
- Charge the battery in a dry area ONLY.
- Battery posts, terminals and related accessories contain lead and lead compounds, chemicals known to the State of California to cause cancer and reproductive harm. Wash hands after handling.
- Do not open the battery. Battery contains lead acid and other materials that are toxic and corrosive.
- Do not open the charger. Exposed wiring and circuitry inside case may cause electric shock. Only adults may handle or charge the battery. NEVER allow child to handle or charge the battery. Battery is heavy and contains lead acid (electrolyte).
- Do not drop the battery. Permanent damage to the battery could occur or cause serious injury.
- Before charging the battery, check for wear or damage to the battery, charger, its supply cord and the connectors. DO NOT charge the battery if any damage to parts has occurred.
- Do not allow the battery to drain completely. Recharge the battery after each use or once a month if not used regularly.
- Do not charge battery upside down.
- Always secure the battery with the bracket. Battery can fall out and injure a child if vehicle tips over.

- The POWER SWITCH must be turned in **OFF** position when charging.
- Before the first use, you should charge the battery for 4-6 hours. Do not recharge the battery for more than 10 hours to avoid overheating the charger.
- When the vehicle begins to run slowly, recharge the battery.
- After each use or once a month minimum recharge time as 8 to 12 hours, less than 20 hours at most.



## Charging

- If your ride-on with a **Digital voltmeter(OPTIONAL)**, the magnitude of voltage will tell you how much power is remaining in the battery when you must recharge the battery. Make sure the vehicle is stop!

BATTERY	MAGNITUDE OF VOLTAGE	BATTERY STATE
6V4Ahx1, 6V7Ahx1 6V10Ahx1	$\geq 6.6$	The battery is full.
	6.5~6.3	The vehicle can work normally.
	$\leq 6.2$	The battery needs to be charge.
6V4Ahx2, 12V7Ahx1,	$\geq 13.2$	The battery is full.
	13.1~12.6	The vehicle can work normally
	$\leq 12.5$	STOP operating the vehicle, the battery needs to be charge.



Find the socket as shown 1.

1. Plug the charger port into the input socket. (the socket is below the seat)
2. Plug the charger plug into a wall outlet. The battery will begin charging

## **WARNING!**

Always stop vehicle when changing the speed or direction to avoid damage the gears and motor.

Make sure your child knows how to steer, how to start and stop the vehicle and knows the rules for safe driving. The vehicle can be driven at a maximum of 3~5 km/h.

## Battery Replacement & Fuse

The battery features a thermal fuse with a reset fuse that will automatically trip and cut all power to the vehicle if the motor, electric system or battery is overloaded. The fuse will reset and power will be restored after the unit is turned OFF for 20 seconds and then turned ON again. If the thermal fuse trips repeatedly during normal use, the vehicle may need repair.

**Contact your distributor please.**

To avoid losing power, follow these guidelines:

- Do not over load the vehicle.
- Do not tow anything behind the vehicle.
- Do not drive up steep slopes.
- Do not drive into fixed objects, which may cause the wheels to spin, causing the motor to overheat.
- Do not drive in very hot weather, components may overheat.
- Do not allow water or other liquids to come in contact with the battery or other electric components.
- Do not tamper with the electric system. Doing so may create a short, causing the fuse to trip.

### Battery Replacement and Disposal



The battery will eventually lose the ability to hold a charge. Depending on the amount of use, and varying conditions, the battery should operate for one to three years. Follow these steps to replace and dispose the battery:

1. Remove the car seat.
2. Disconnect the battery connectors.
3. Remove the battery bracket.
4. Remove the battery cover.
5. Carefully lift the battery.
- Depending on the condition of the battery (i.e.: leakage) you may want to wear protective gloves before removal.
- Do not lift the battery by its connectors or cables.
6. Place the dead battery in a plastic bag.
- Important!** Recycle the dead battery responsibly. The battery contains lead acid (electrolyte) and must be disposed of properly and legally. It is illegal in most areas to incinerate lead acid batteries or dispose of them in landfills. Take it to a federal or state-approved lead acid battery recycler, such as local automotive battery retailer. Do not throw the battery away with your regular household waste!
7. Replace the battery and reconnect the connectors.
8. Replace the metal battery bracket.
9. Replace the seat



## Troubleshooting Guide

Problem	Possible Cause	Solution
Vehicle does not run	Battery low on power	Recharge battery.
	Thermal fuse has tripped	Reset fuse, see <Fuse>
	Battery connector or wires are loose	Check that the battery connectors are firmly plugged into each other. If wires are loose around the motor contact your distributor please.
	Battery is dead	Replace battery, contact your distributor please.
	Electrical system is damaged	Contact your distributor please.
	Motor is damaged	Contact your distributor please.
Vehicle does not run very long	Battery is under charged	Check that the battery connectors are firmly plugged into each other when recharging
	Battery is old	Replace battery, contact your distributor please.
Vehicle runs sluggishly	Battery low on power	Replace battery, contact your distributor please.
	Battery is old	Replace battery, contact your distributor please.
	Vehicle is overload	Reduce weight on vehicle. Maximum user weight is 77 lbs.
	Vehicle is being used in harsh conditions	Avoid using vehicle in harsh conditions ,see <Safety> conditions
Vehicle needs a push to go forward	Poor contact of wires or connectors	Check that the battery connectors are firmly plugged into each other. If wires are loose around the motor, contact your distributor please.
	"Dead Spot" on motor	A dead spot means the electric power is not being delivered to the terminal connection and the vehicle needs repair. Contact your distributor please
Difficult shifting from forward to reverse or vice-versa	Attempting to shift while the vehicle is in motion	Completely stop the vehicle and shift, see <Use Your Ride-On>
Loud grinding or clicking noises coming from motor or gear box	Motor or gears are damaged	Contact your distributor please.
Battery will not recharge	Battery connector or adapter connector is loose	Check that the battery connectors are firmly plugged into each other.
	Charger not plugged in	Check that the battery charger is plugged into a working wall outlet.
	Charger is not working	Contact your distributor please.
Charger feels warm when recharging	This is normal and not a cause for concern	

Completely read through this manual and the troubleshooting guide table before calling. If you still need help resolving the problem **Contact your distributor please.**

## Maintaining

- It is parents' responsibility to check main parts of the toy before using, Must regularly examine for potential hazard, such as the battery, charge, cable or cord, plug, screws are fastening enclosure of other parts and that in the event of such damage, the toy must not be used until that damage had been properly removed.
- Make sure the plastic parts of the vehicle are not cracked or broken.
- Occasionally use a lightweight oil to lubricate moving parts such as wheels.
- Park the vehicle indoors or cover it with a tarp to protect it from wet weather.
- Keep the vehicle away from sources of heat, such as stoves and heaters. Plastic parts may melt.
- Recharge the battery after each use. Only an adult can handle the battery. Recharge the battery at least once a month when the vehicle Raider is not being used.
- Do not wash the vehicle with a hose. Do not wash the vehicle with soap and water. Do not drive the vehicle in rainy or snowy weather. Water will damage the motor, electric system and battery.
- Clean the vehicle with a soft, dry cloth. To restore shine to plastic parts, use a non-wax furniture polish. Do not use car wax. Do not use abrasive cleaners.
- Do not drive the vehicle in loose dirt, sand or fine gravel which could damage the moving parts, motors or the electric system.
- When not using, all the electrical source should be turned off. Turn off the power switch and disconnect the battery connection.

Our products are suitable for

**ASTM F963; GB6675; EN71 and EN62115 standard.**

**Welcome to visit our website and purchase our quality products!**

With your inspiring rating, COSTWAY will be more consistent to offer you  
**EASY SHOPPING EXPERIENCE, GOOD PRODUCTS and EFFICIENT SERVICE!**

US office: Fontana, California

UK office: Ipswich



- \* Reward Points
- \* Exclusive Customer Service
- \* Personalized Recommendations
- \* Permanent Shopping Cart
- \* Order History

*5 Star Rating*



We would like to extend our heartfelt thanks to  
all of our customers for taking time to assemble  
this product and giving us valuable feedbacks.

