

PARTS LIST

- A PVC grip
- B Scorecard holder
- C Handle tube
- D Adjustable handle mechanism
- E Upper bag holder bracket
- F Main upper frame tube
- G Leg bracket
- H 2 holes leg frame
- I 4 holes leg frame
- J Right weight stabilizer
- J1 Left weight stabilizer
- K Slippery connecting rods
- L Right wheel locking mechanism
- L1 Left wheel locking mechanism
- M Anti-splay wire
- N Lower frame mechanism
- O Rear wheel
- P Lower frame
- Q Front fork
- R Front wheel locking mechanism
- S Lower bag holder bracket
- T Front wheel
- U Umbrella holder storage rack
- V Umbrella holder base
- W Umbrella holder

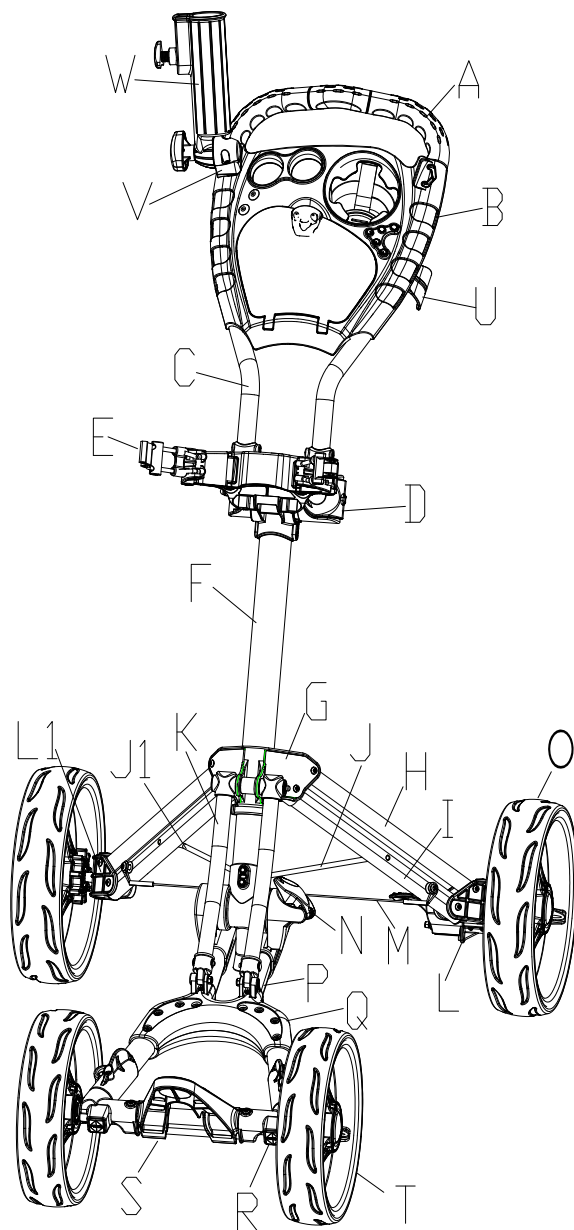

GC332616

MAINTENANCE

To clean to the cart, wipe with a soft, dry cloth. Car polish may be used to maintain finish. Lubricate moving parts every 6 months.

Warning:

For your own safety, please read and understand these warnings and keep this user guide for future reference.

Always make sure the cart is fully extended and locked before use.

Always make sure the cart is folded and locked properly before lifting or transporting.

Do not run while using this product.

Do not use accessories other than those designed for use with this cart.

Keep all packing materials away from children and recycle where possible or where required by law.

Handle Joint Mechanism

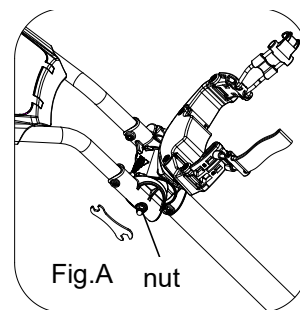

The customer can adjust the nut on the handle joint mechanism by wrench tool when they found the handle joint is so loose as Fig.A

Front wheel

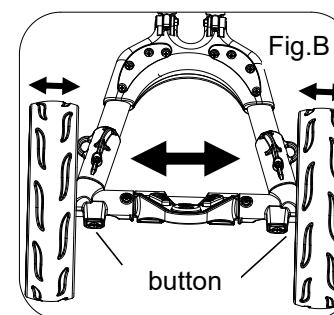

Press the button to pull out the wheel forward two sides, so it can suit for different bag size as Fig.B.

UNFOLDING

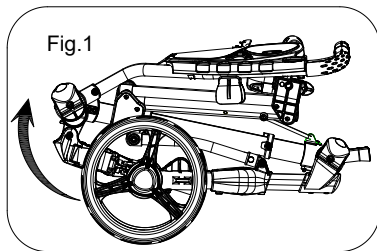

Open the top bracket as Fig.1

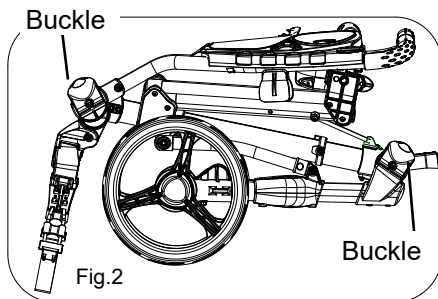

Release the buckle for the low frame and handle joint mechanism as Fig.2

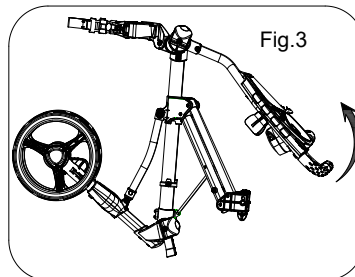

Unfolding the handle and low frame, and click to sticking point, fixed the buckle on the handle and

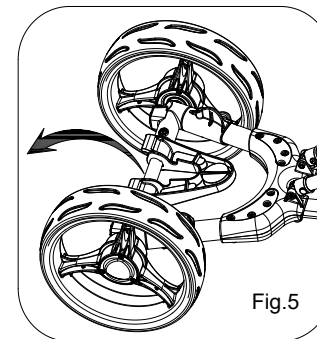
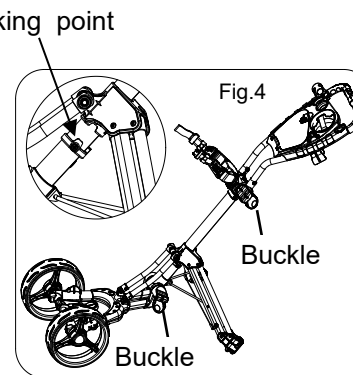

Unfolding the bottom bracket as Fig.5

FOLDING STEP

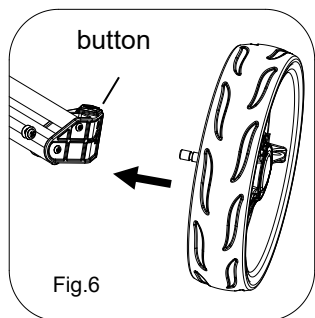

Assemble the rear

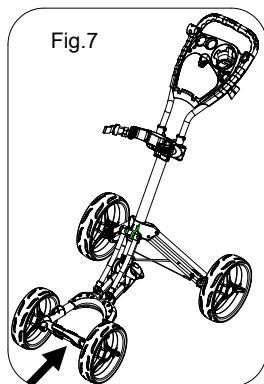

Folding the low bracket as Fig.7

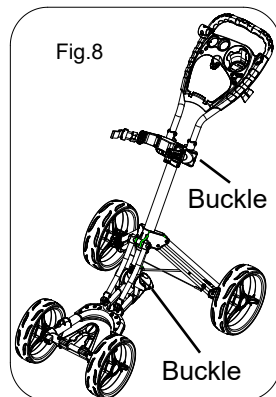

Release the buckle for the handle joint and low bracket as Fig.8

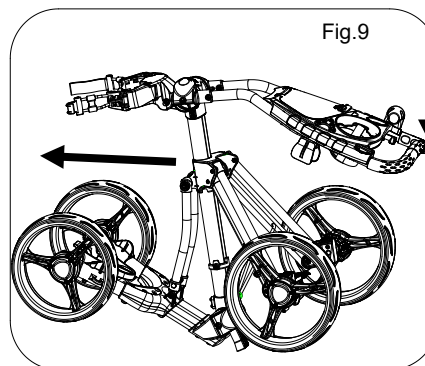

Folding the handle and push forward the frame as Fig.9, so the handle can fold in the

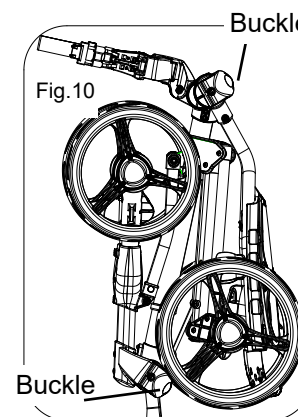

Fixed the buckle as Fig.10.

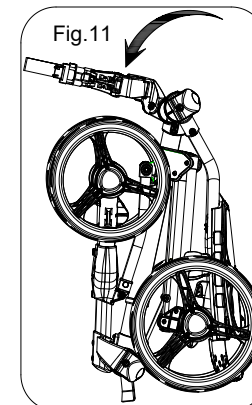

Folding the top bracket as Fig.11 and finish the

UMBRELLA HOLDER

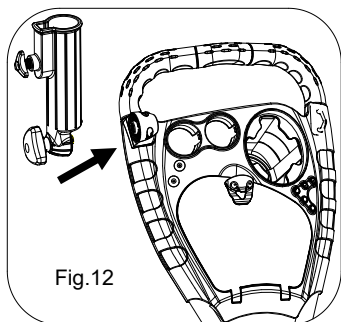

To put in use: Simply attach the umbrella holder onto the cart as in Fig. 12

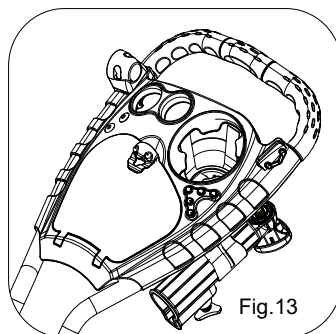

To store: Attach the umbrella holder to the storage rack on the handle as in Fig. 13

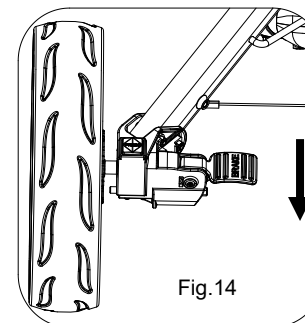

FOOT BRAKE MECHANISM

Push on the brake pedal to stop the rear wheel and pull off to release as Fig.14

If the cart veers to the left, please use the hex wrench to turn the screw A counterclockwise and Screw B clockwise to adjust the alignment.

If the cart veers to the right, please use the hex wrench to turn Screw A clockwise and screw B counterclockwise to adjust the alignment.

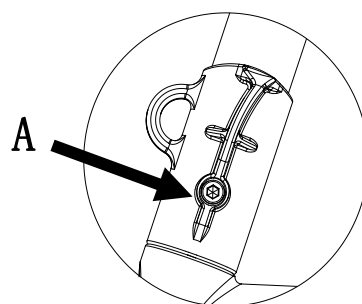
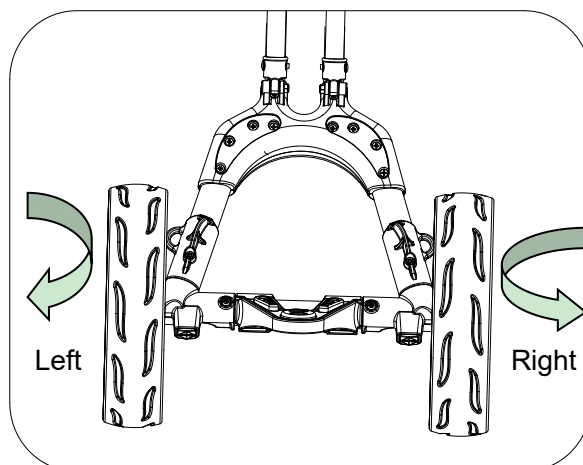

Left

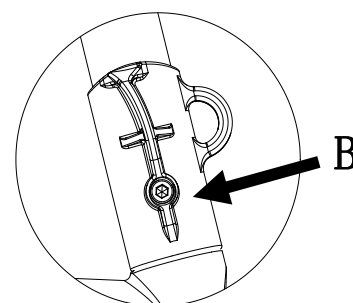

Right

Alignment adjusting screws A/B

