

PATIOJOY®

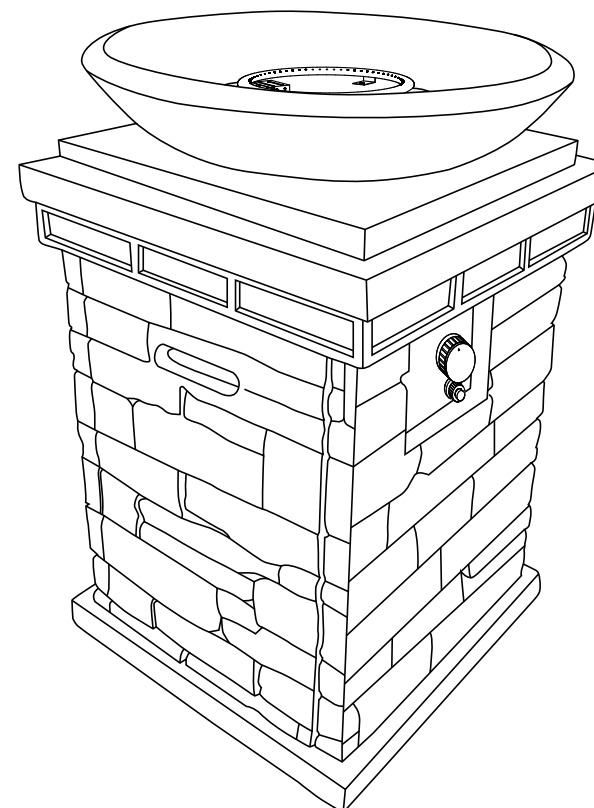

USER'S MANUAL

**Fire Pit
OP70366**

THIS INSTRUCTION BOOKLET CONTAINS **IMPORTANT** SAFETY INFORMATION. PLEASE READ AND KEEP FOR FUTURE REFERENCE.

Please give us a chance to make it right and do better!

Contact our friendly customer service department for help first.

Replacements for missing or damaged parts will be shipped ASAP!

Follow Costway

Visit us: www.costway.com



Contact Us!

Do NOT return this item.

Contact our friendly customer service department for help first.



Before You Start

- ⚠ Please read all instructions carefully.
- ⚠ Retain instructions for future reference.
- ⚠ Separate and count all parts and hardware.
- ⚠ Read through each step carefully and follow the proper order.
- ⚠ We recommend that, where possible, all items are assembled near to the area in which they will be placed in use, to avoid moving the product unnecessarily once assembled.
- ⚠ Always place the product on a flat, steady and stable surface.
- ⚠ Keep all small parts and packaging materials for this product away from babies and children as they potentially pose a serious choking hazard.

! NOTICE

Please retain these instructions for future reference.

- Children are not allowed to operate this fire pit.
- Fire pit must be attended by adults at all times. Do not leave children and pets around a fire pit when in use.
- For outdoor use only; do not use in a building, garage, or any other enclosed area.
- For use with propane gas tanks only (not included).
- Improper adjustment, installation, usage, and maintenance could result in an explosion and cause serious injury or property damage.
- Read and follow all warnings and instructions thoroughly before appliance assembly, service, and use.
- Failure to follow warnings and instructions may cause death, serious injury, or property damage.
- If any parts are missing, broken, damaged, or worn, stop using this product until repairs are made and/or factory replacement parts are installed.
- Do not use this item in a way inconsistent with the manufacturer's instructions as this could void the product warranty.

CALIFORNIA PROPOSITION 65

⚠ **WARNING:** This product can expose you to Carbon monoxide, which is known to the State of California to cause birth defects or other reproductive harm. For more information go to www.P65Warnings.ca.gov

WARNING

- This fire pit produces carbon monoxide which has no odor. Do not use in enclosed area.
- If you smell gas during operation, immediately shut off gas and extinguish flames.
- Do not use a flame to check for gas leaks.
- Only use this appliance on a hard and level surface such as concrete or rock.
- Do not use this fire pit under trees or near any other unprotected combustible area.
- Fire pit must have a minimum clearance of 72 inches above and 48 inches from the sides. Make sure area is clear and free from combustible objects/constructions.
- Do not connect to a remote gas supply.
- Do not use with natural gas.
- Do not use solid fuel or charcoal on this fire pit.
- Do not burn anything other than what is provided.
- Do not place clothing or flammable materials near the fire pit.
- Fire pit is not intended for cooking.
- Do not place food or eat on the surface of fire pit.
- Be careful when igniting fire pit as flame may flare and cause injury.
- Do not use if lava rocks are wet. Ensure that rocks are completely dry before use.
- Keep a safe distance from the fire pit when in use. Do not sit or rest hands/feet on fire pit or tank table.
- To avoid burns, do not touch or move any part of this fire pit when in use; wait until it has completely cooled.
- Do not breathe smoke from the fire pit and avoid getting smoke in your eyes.
- Do not alter this appliance. Any alteration can cause a safety hazard.
- Do not use any accessory or fitting other than original accessories and fittings.
- Keep all electrical cords and hoses away from heated surfaces.
- Routinely check hoses for wear or abrasions. Do not use if hoses are damaged.

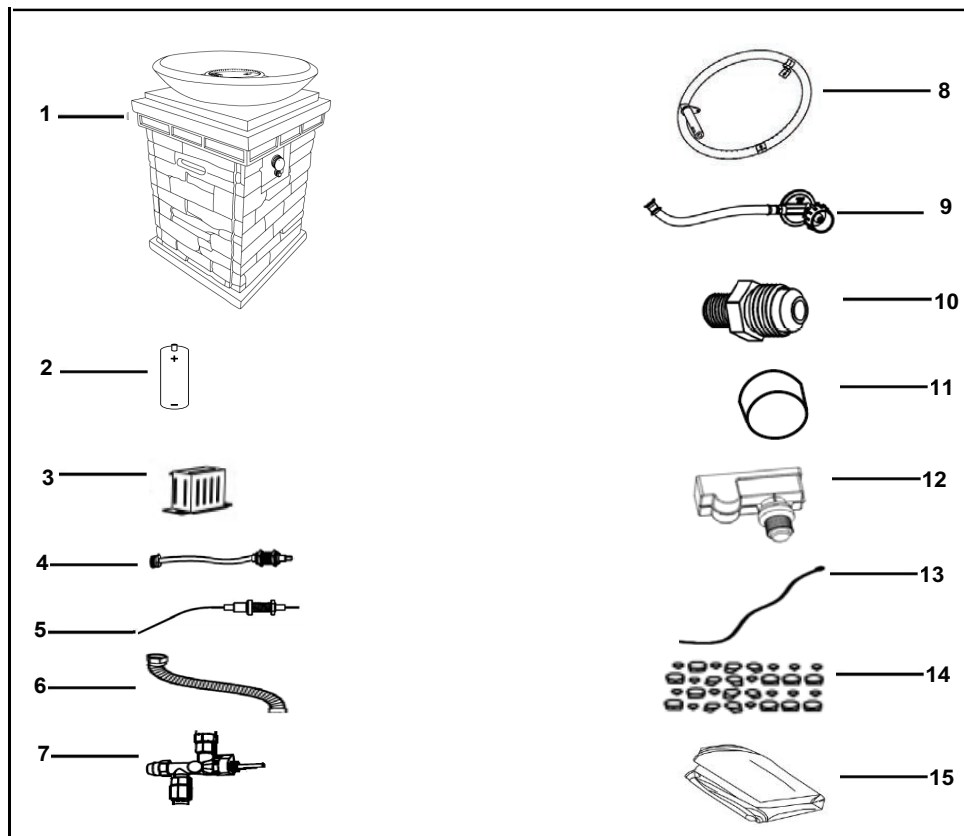

ITEM	SPECIFICATION	QTY
1	Body	1 PC
2	Battery (AAA)	1 PC
3	Guard	1 PC
4	Thermocouple	1 PC
5	Ignition Pin	1 PC
6	Corrugated Pipe	1 PC
7	Gas valve	1 PC
8	Burner	1 PC
9	Regulator	1 PC

ITEM	SPECIFICATION	QTY
10	Reducing Nipple	1 PC
11	Control Knob	1 PC
12	Ignitor	1 PC
13	Groundwire	1 PC
14	Lava rocks	1 Box(3KG)
15	PVC Cover	1 PC

Check that the control knob (11) for the gas supply system is turned to the "OFF" position before starting any assembly.

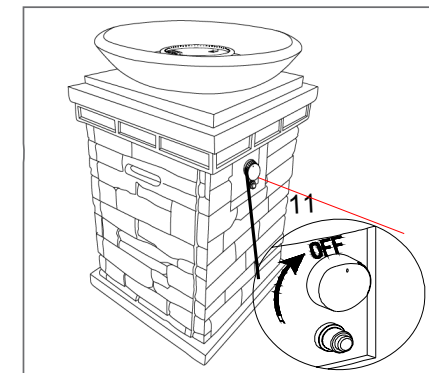

Turn the cylinder valve on the tank clockwise to close the propane tank. Attach the preassembled regulator from the Body (1) to the cylinder valve by turning the regulator coupling nut clockwise. Make sure it is fastened securely and tighten connections by hand only.

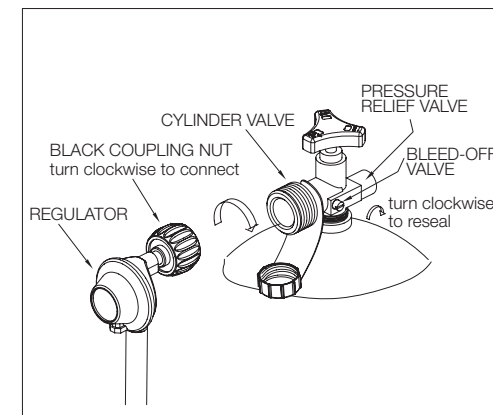

Remove the rubber cap on the electronic igniter (12) by unscrewing and slide battery (2) into the battery slot. Make sure the positive side of the battery faces outwards. Screw the electronic igniter cap (12) over the battery tightly.

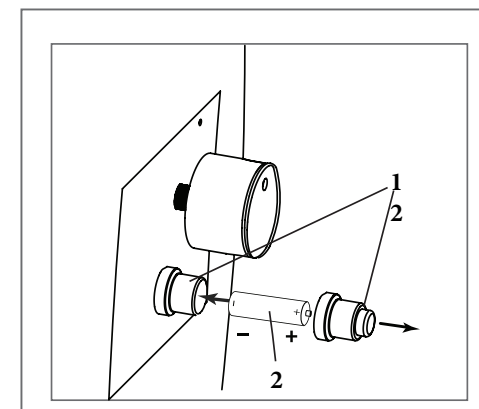

PLACING LAVA ROCKS

- Lava rocks are located in a box underneath the fire pit.
- Place rocks in fire pit and spread them according to your preference.
 - You may place rocks around burner but do NOT cover the guard.
- Rocks should not be more than ¼ inch above the burner holes.
- Excessive rocks will suffocate the flame.

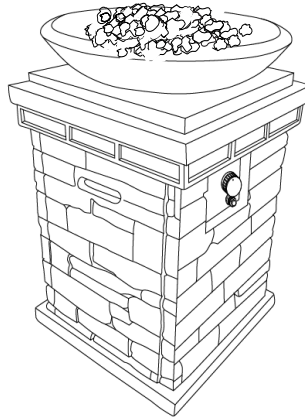

Place propane gas tank (not included) into the metal stand . Make sure the gas tank sits on the metal stand completely. Turn the preassembled wing screw on the outer part of metal stand clockwise to secure the propane gas tank tightly.

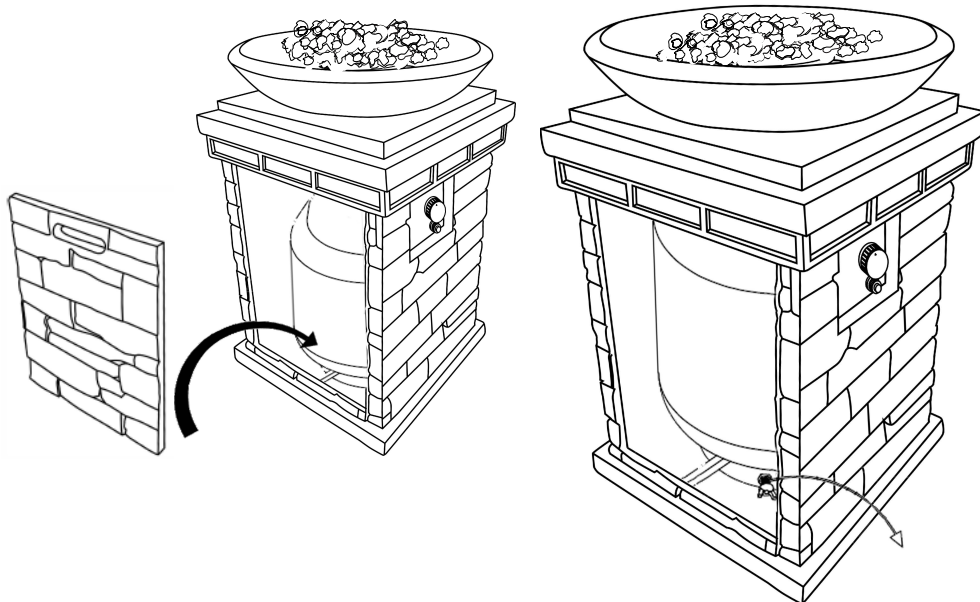

ATTACHING PROPANE

- 1** Make sure release valve on tank is firmly screwed shut.

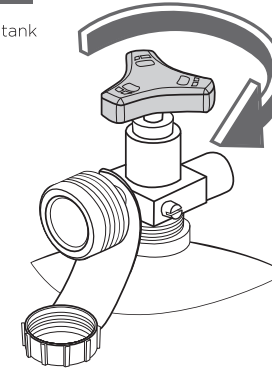

- 2** Attach fuel hose regulator to the output of the tank by turning the coupling nut clockwise.

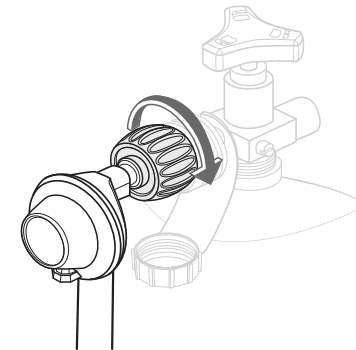

- 3** Turn release valve on tank counterclockwise to release gas.

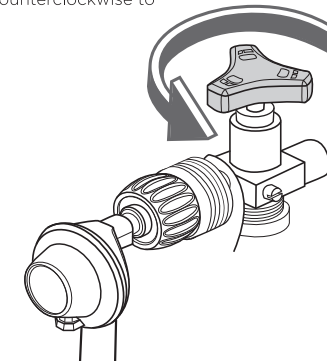

CONTROL PANEL

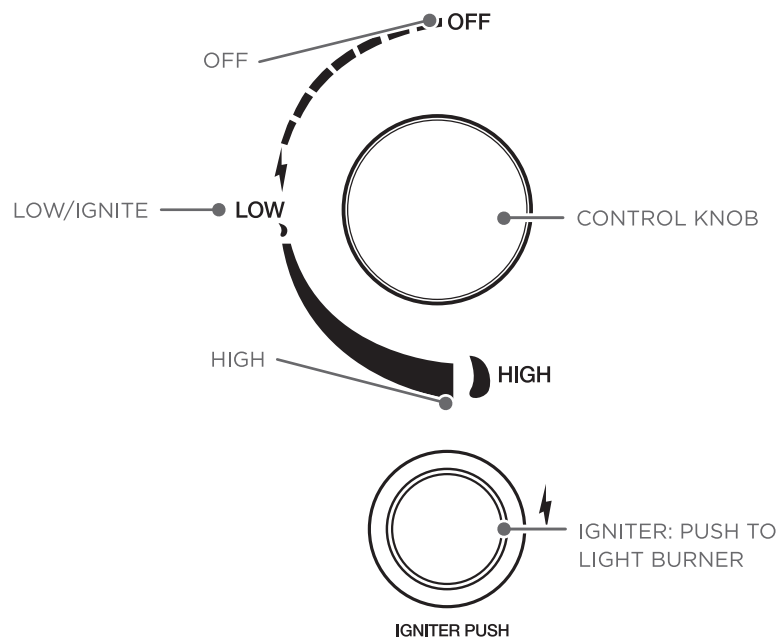

OPERATING INSTRUCTIONS

WARNING: Before using this outdoor fire pit, please thoroughly read and follow all warnings and instructions written in this manual. Failure to follow warnings and instructions may cause death, serious injury, or property damage.

NOTE: During first use, leave fire pit ignited for 20 minutes as lava rocks may pop and cause injury.

1. Push and turn control knob counterclockwise to low/ignite.
2. Press the igniter button repeatedly to light burner.
 - If flames do not ignite after 45 seconds, turn off, wait 5 minutes, and try again.
 - If necessary, light burner with a match or lighter.
3. Adjust flames with the control knob.
4. When finished, push and turn control knob clockwise to off position.
5. Turn valve on propane tank clockwise to turn off gas flow.

REPLACING BATTERY

If the burner is not lighting, you may need to replace the battery in the igniter.

1. Unscrew igniter button.
2. Insert AAA battery with the positive side facing outwards.
3. Replace igniter button.

EXCESS FLOW SAFETY DEVICE

If too much gas is flowing into fire pit, the excess flow safety device will activate to drastically reduce gas flow. To reset the safety device, turn fire pit off, wait 30 seconds, then turn on again.

If flames are still low, do the following:

1. Turn off fire pit and turn off gas flow from propane tank.
2. Disconnect the fuel hose from the tank.
3. Turn control knob to high and wait 5 minutes. Turn control knob to off position.
4. Reconnect fuel hose and turn on gas flow. After 30 seconds, light fire pit.

CLEANING

- Immediately wipe spills before they absorb into surface.
- Make sure fire pit is completely cool before cleaning.
- Use a soft brush or cloth to wipe stains and dirt.
- If necessary, clean with mild detergent and a soft cloth/sponge.
- Thoroughly dry fire pit after cleaning.
- Do not use petroleum-based or abrasive cleaners as it may damage the finish.
- Do not use rough or harsh sponges/brushes.

STORAGE

- Allow fire pit to cool 10 minutes before storage.
- Place cover on fire pit to protect from harsh weather.
- Do not store in direct sunlight.
- Do not store or use gasoline, or any other flammable vapors or liquids, in the vicinity of the fire pit.
- If propane tank is disconnected, do not store it in the vicinity of the fire pit.
- It is recommended that the fire pit is stored indoors during winter.
- If fire pit is stored indoors, disconnect and leave propane tank outdoors.

TROUBLESHOOTING

PROBLEM	REASON	SOLUTION
Burner not lighting with igniter	Igniter pin is bent	Bend igniter pin back towards thermocouple
	Guard obstructed	Clear guard of obstructions
	Electrode/burner wet	Dry electrode/burner
	Igniter battery dead	Replace AAA battery in igniter
Burner does not light	Propane tank is empty	Replace/refill tank
	Coupling nut loose	Fully tighten coupling nut
	Bent hose	Straighten hose
	Burner holes obstructed	Remove obstructions or clean holes
Emits a lot of black smoke	Bent hose	Straighten hose
	Burner holes obstructed	Remove obstructions or clean holes
Drop in gas flow, reduced flame height	Propane tank is empty	Replace/refill tank
	Excess flow safety device activated	Follow steps to reset safety device
Irregular flame pattern, or does not run length of burner	Burner holes obstructed	Remove obstructions or clean holes
Flames blow out	Propane tank is empty	Replace/refill tank
	High winds	Turn control knob to high
	Excess flow safety device activated	Follow steps to reset safety device
Flames lose heat in cold weather	Ice buildup on propane tank	Replace tank

Welcome to visit our website and purchase our quality products!

Your suggestions and comments for COSTWAY are really important to us!

We sincerely solicit you to go back to our shop and leave a good rating in just a simple click. It would be quite encouraging if you could kindly do so like below:

★★★★★ Great products so far

February 24, 2019

Great products so far. Fast delivery, easy setup, and working without any issues.

With your inspiring rating, COSTWAY will be more consistent to offer you EASY SHOPPING EXPERIENCE, GOOD PRODUCTS and EFFICIENT SERVICE!

US office: Fontana, California

UK office: Ipswich



- * Reward Points
- * Exclusive Customer Service
- * Personalized Recommendations
- * Permanent Shopping Cart
- * Order History

5 Star Rating



We would like to extend our heartfelt thanks to all of our customers for taking time to assemble this product and giving us valuable feedbacks.

THANK
you
😊