

USER'S MANUAL
Kids Ride On Container Cargo Truck Vehicle
TQ10005

THIS INSTRUCTION BOOKLET CONTAINS **IMPORTANT** SAFETY INFORMATION. PLEASE READ AND KEEP FOR FUTURE REFERENCE.

Please give us a chance to make it right and do better!

Contact our friendly customer service department for help first.

Replacements for missing or damaged parts will be shipped ASAP!

Follow Costway



Contact Us!

Do NOT return this item.

Contact our friendly customer service department for help first.



Before You Start

Please read all instructions carefully and keep it for future reference.

Warnings:

Attention! Use it with protective equipment.

Attention! Not use it in the traffic.

Attention! The product is not suitable for the children under 3 years.

General Warnings:

- ⚠ The product must be installed and used under the supervision of an adult.
- ⚠ Read through each step carefully and follow the proper order.
- ⚠ Remove all packaging, separate and count all parts and hardware.
- ⚠ Please ensure that all parts are correctly installed, incorrect installation can lead to a danger.
- ⚠ We recommend that, where possible, all items are assembled near to the area in which they will be placed in use, to avoid moving the product unnecessarily once assembled.
- ⚠ Ensure a secure surface during construction, and place the product always on a flat, steady and stable surface.
- ⚠ Please use the product carefully, as the product requires great skill, avoid accidents by the user or others, by fall or collision.
- ⚠ Please wear suitable protective equipment during use, e.g. protective helmet, gloves, knee pads, elbow pads etc.

Truck

BATTERY POWERED RIDE-ON

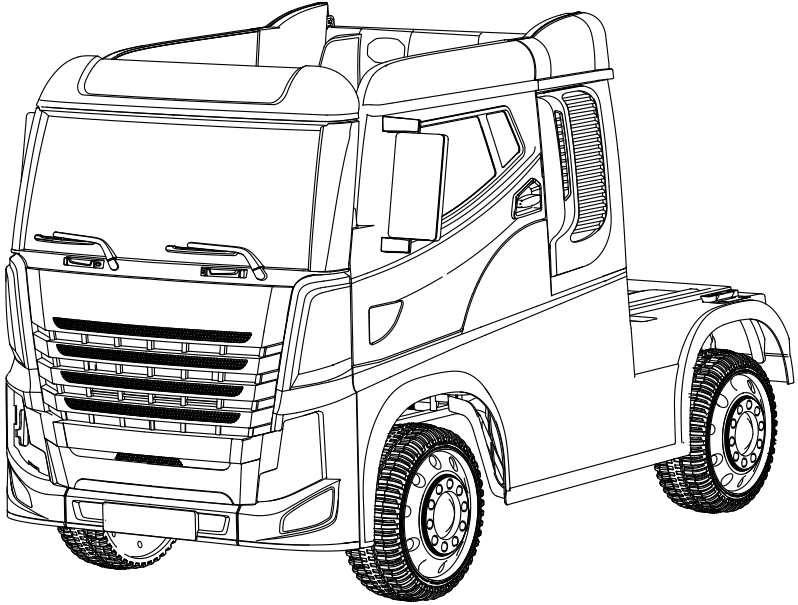

Owner's Manual with Assembly Instructions

Styles and colo(u)rs may vary.
Made in China.

The owner's manual contains important safety information as well as assembly, use and maintenance instructions.

The Ride-on Car must be assembled by an adult who has read and understands the instructions in this manual.

Keep the package away from children and dispose of properly before use.

Keep this manual for future reference.

About Your New Ride-On

On the purchase of your new Ride-On.

This ride-on will provide your child with many miles of riding of enjoyment. To help assure you and your rider a safe ride we ask you to please read this manual carefully, and keep it for future reference.

Follow the recommendations in this manual, they are designed to improve the safety and operation of your ride-on car and it's rider.

SPECIFICATIONS:

Battery	12V7AH *1	
Charger	12V1000mA	

Suitable age:	37-96 months
Load Capacity:	Under 66lbs
Speed:	3-5km/h
Size of product:	71.3" x 26" x 30"
Size of Container:	41" x 18.7" x 18.9"
Power way:	Charging type
Charge time:	8-12 hours

User Notice



WARNING!

- **CHOKING HAZARD** - Small parts. Not suitable for children under 36 months. The product contains small parts, keep children away when assembling.
- **ADULT ASSEMBLY REQUIRED.**
- Always remove protective material and poly bags and dispose before assembly.
- Protective equipment should be worn. Always wear shoes and sit in the seat when operating the vehicle.
- Only drive on level ground. Never use on the lawn.
- Never leave a child unattended.
- Keep your hands, hair, and clothes away from moving parts.



SAFETY

The following safety hazards may result in serious injury or death:

- Never leave child unattended. Direct adult supervision is required. Always keep child in view when child is in vehicle.
- To reduce the risk of injury, adult supervision is required. Never use in roadways, near motor vehicles, on or near steep inclines or steps, swimming pools or other bodies of water, always wear shoes, and never allow more than 1 rider.
- Never use in unsafe conditions such as snow, rain, loose dirt, mud, sand, or gravel, otherwise may result in an unexpected accident such as tipping over, and could damage the electrical system or battery
- Not to be used in traffic.
- This toy should be used with caution since skill is required to avoid falls or collisions causing injury to the user or third parties.
- This toy is unsuitable for children under 36 months due to its maximum speed; Maximum user weight is 66 lbs.
- This toy has no brake.



BATTERY INFORMATION

- Non-rechargeable batteries are not to be recharged.
- Rechargeable batteries are to be removed from the toy before being charged.
- Rechargeable batteries are only to be charged under adult supervision.
- Different types of batteries or new and used batteries are not to be mixed.
- Batteries are to be inserted with the correct polarity.
- Exhausted batteries are to be removed from the toy.
- The supply terminals are not to be short-circuited.

Parts Diagram

HINT: Some parts shown are assembled on both sides of vehicle

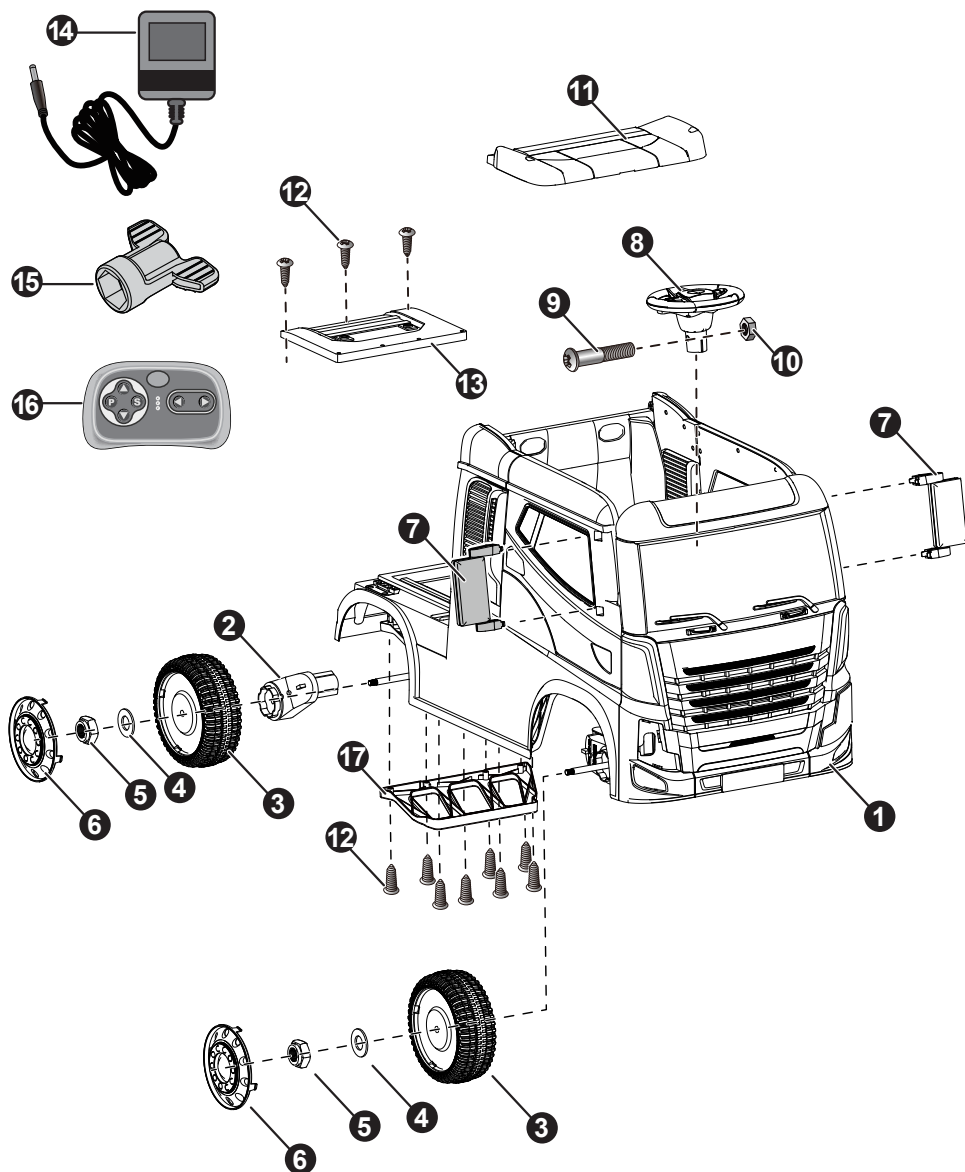

Parts List

PART NO.	PART NAME	Q'ty (pcs)			REMARKS
1	Vehicle body	1			
2	Rear gear box	2			one labeled "R", the other one labeled "L"
3	Wheel	4			
4	Ø12 washer	4			
5	Lock nut	4			
6	Wheel cover	4			
7	Side mirror	2			Left and right
8	Steering wheel	1			
9	M5x35 machine screw	1			Placed on the steering wheel
10	Ø5 nut	1			Placed on the steering wheel
11	Seat	1			
12	Ø4x12 screw	11			
13	Rear cover	1			
14	Charger	1			
15	Spanner	1			
16	Remote controller	1			For R/C type only
17	Rear support	1			

Assembly tools required:

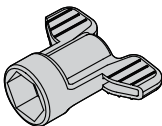

Spanner



**Screwdriver
(not included)**

Attach the Front Wheels

Turn the vehicle body upside down.

Remove all the parts from the front axle.

1. Adjust the gear box on the front axle so that the gear box in the correct position as shown.
2. Slide a wheel (EVA wheel)onto the front axle.
3. Slide a $\varnothing 12$ washer onto the rear axle.
4. Tighten a lock nut to the end of the rear axle with a spanner.
5. "Snap" the wheel cover to the wheel.

Repeat the above procedure to assemble the other front wheel.

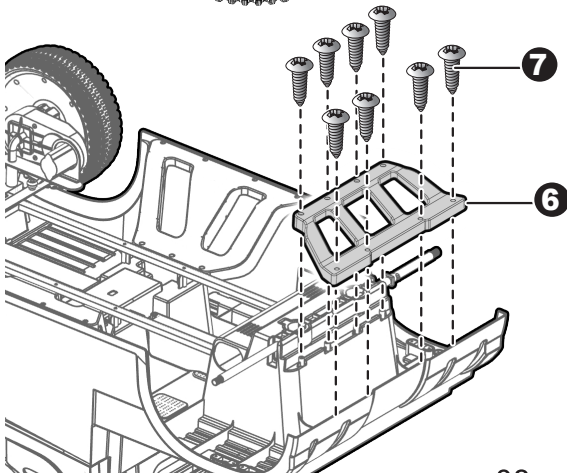
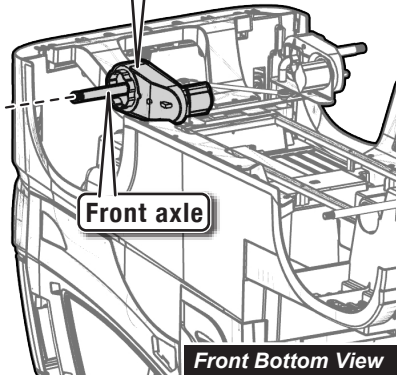
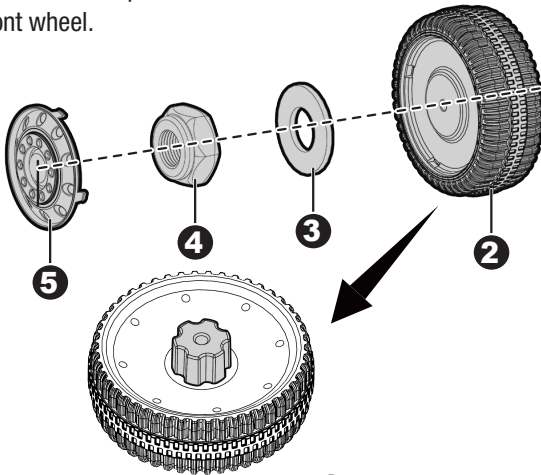
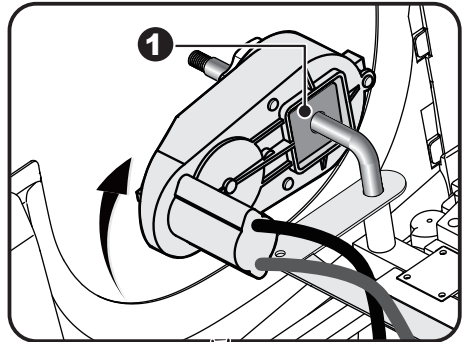

6. Fit the rear support to the vehicle body.
7. Insert the eight $\varnothing 4 \times 12$ screws and tighten with a screwdriver.

Attach the Rear Wheel & Plug the Motor Connectors

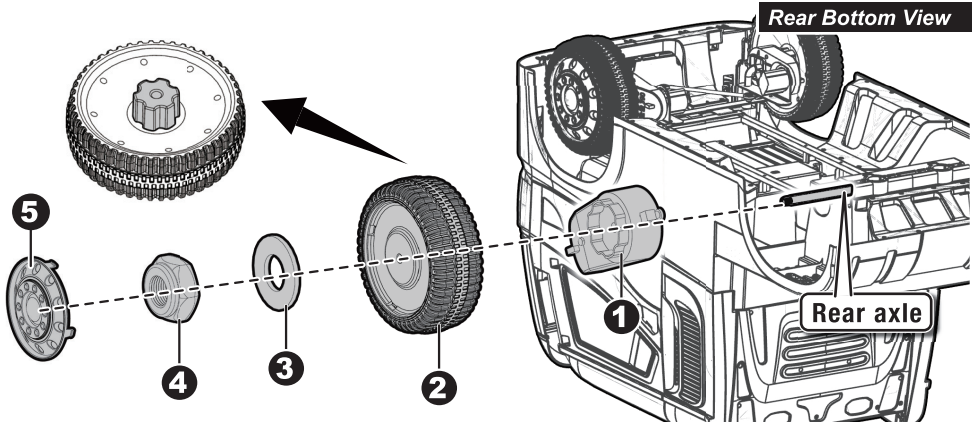

1. Slide the rear gear box onto the rear axle. ("R" labeled gear box should be fit to the "Right" side, "L" labeled gear box should be fit to the "Left" side), keep the connector and the motor on the gear box pass through the larger hole and out where the battery sits.

2. Slide the wheel onto the rear axle.

3. Slide the $\varnothing 12$ washer onto the rear axle.

4. Tighten a lock nut to the end of the rear axle with a spanner.

5. "Snap" the wheel cover to the wheel.

Repeat the above procedure to assemble the other rear wheel.

6. Turn the vehicle body upright. Plug the white vehicle connectors into the white motor connectors.

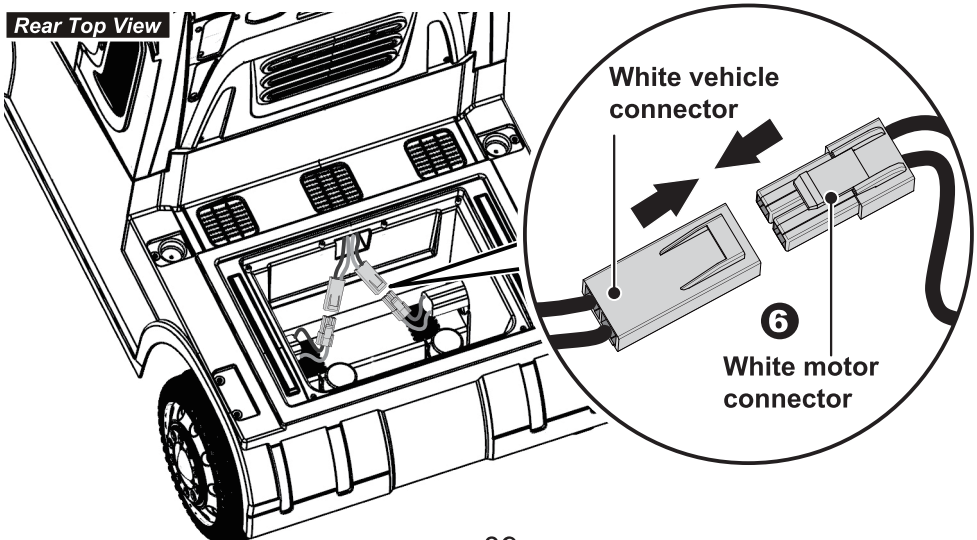

Attach the Steering Wheel

HINT: If the steering wheel of your vehicle equipped with the sound function, please follow the steps 1-4 to add the batteries (Not Included), and refer to the battery information section.

1. Use a screwdriver to loosen the screw on the battery cover located in the center of the steering wheel.
2. Remove the battery cover from the top of the battery compartment.
3. Insert 2x1.5 AA batteries in their correct polarities.
4. Place the battery cover over the battery compartment and fasten with the screw you removed in step one.

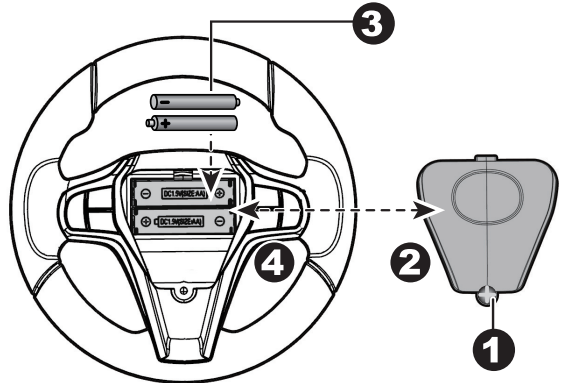

Attach the Steering Wheel

Remove the M5x35 machine screw and Ø5 nut from the steering wheel.

5. Place the steering wheel over the steering column, protruding from the middle of the steering wheel base.
6. Align the holes on each side of steering wheel with the holes at the end of the steering column.
7. Fasten a nut on the opposite end of the screw to secure the steering wheel to the steering column.

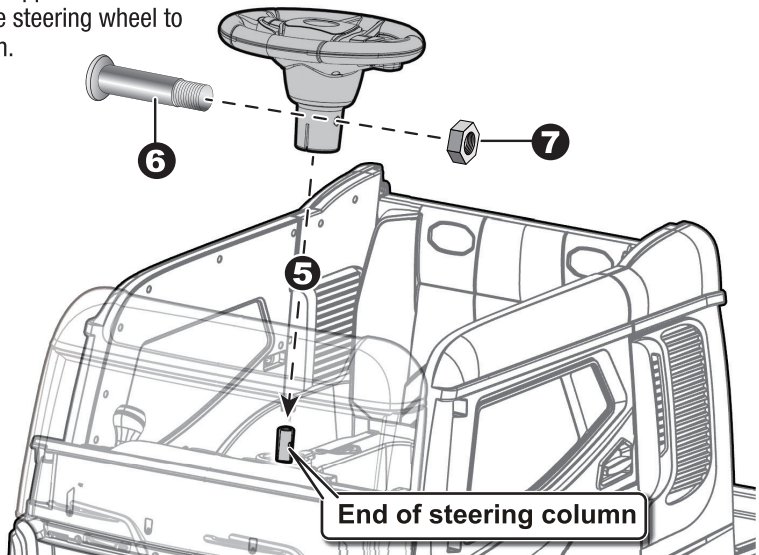

Connect the Power Supply

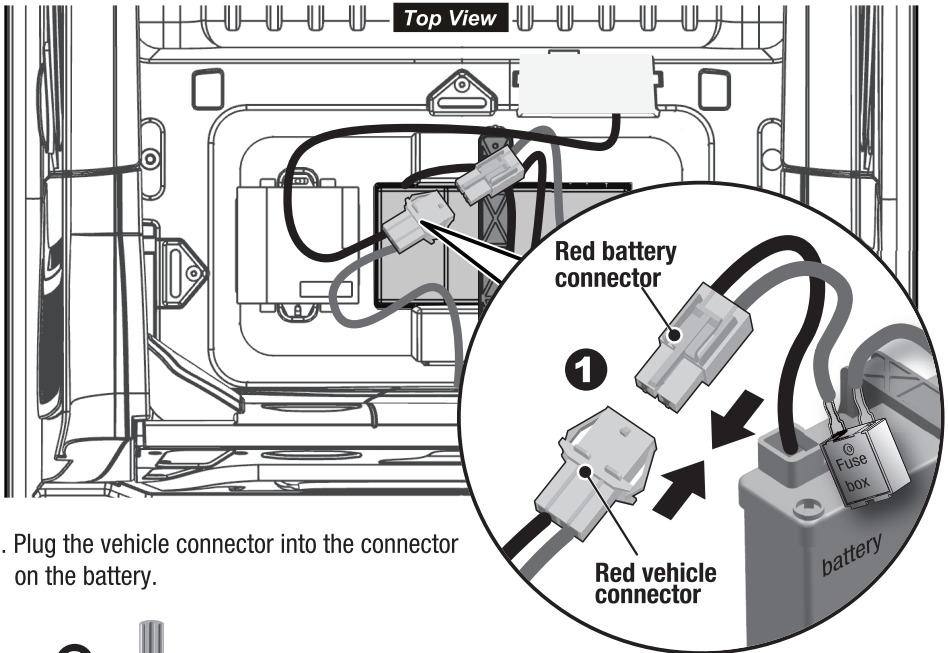

1. Plug the vehicle connector into the connector on the battery.

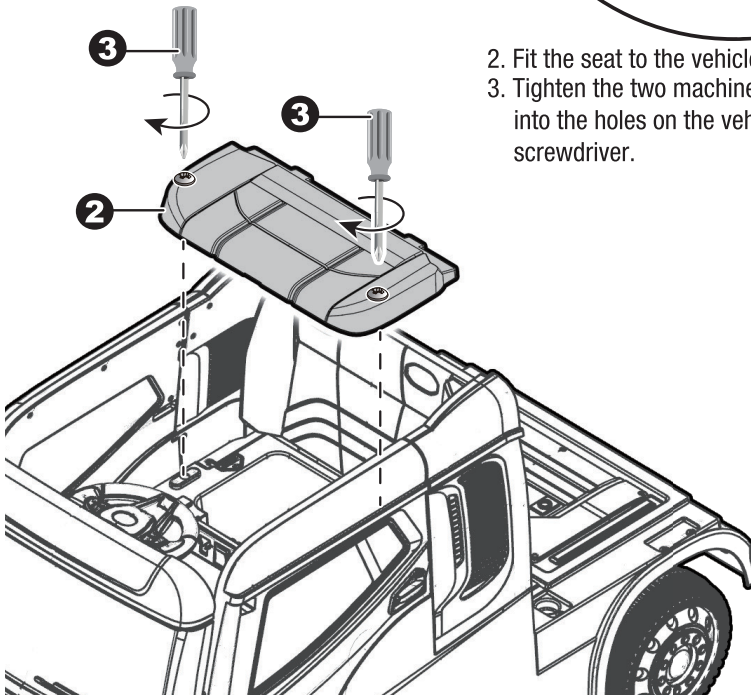

2. Fit the seat to the vehicle body.
3. Tighten the two machine screws on the seat into the holes on the vehicle body with a screwdriver.

Attach the Side Mirrors

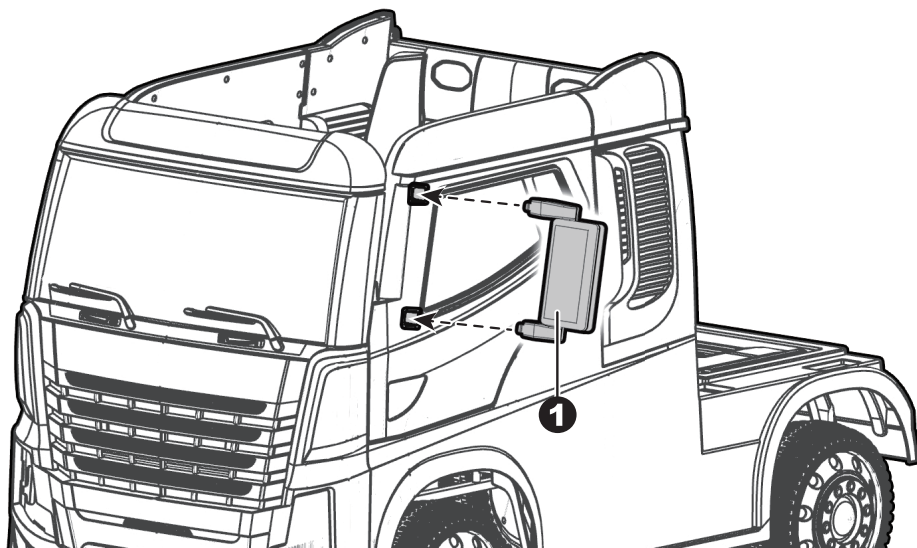

1. “Snap” the side mirror to each door.

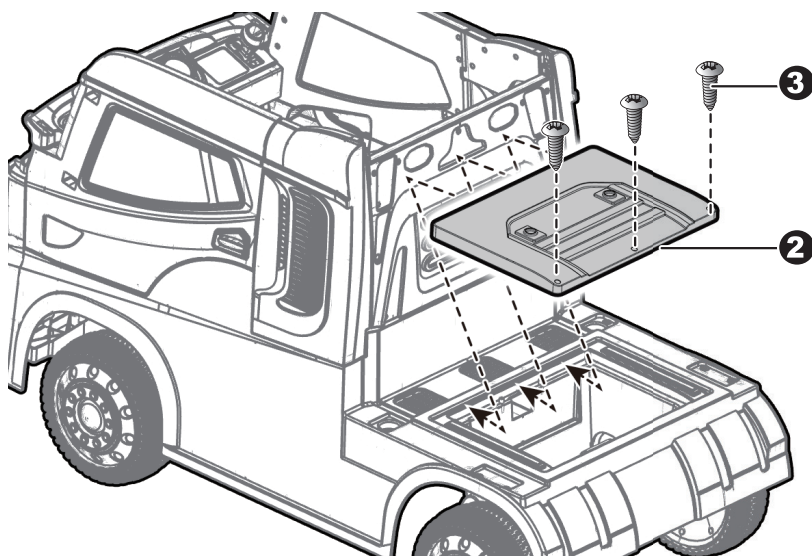

2. Fit the rear cover to the vehicle body.

3. Insert three Ø4x12 screws, and tighten them with a screwdriver.

Container's Assembly Instructions

Product size with container: 71.3" x 26" x 30"

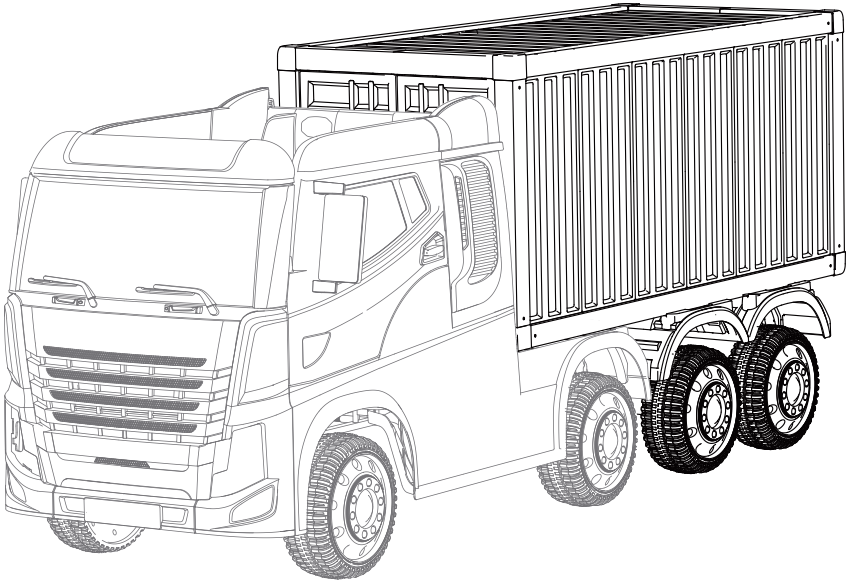

⚠ WARNING! ADULT ASSEMBLY REQUIRED.

⚠ WARNING! The container is not allowed to be used alone, it must be used with the truck.



**NO STEPPING
NO CLIMBING**

Parts Diagram

HINT: Some parts shown are assembled on both sides of container.

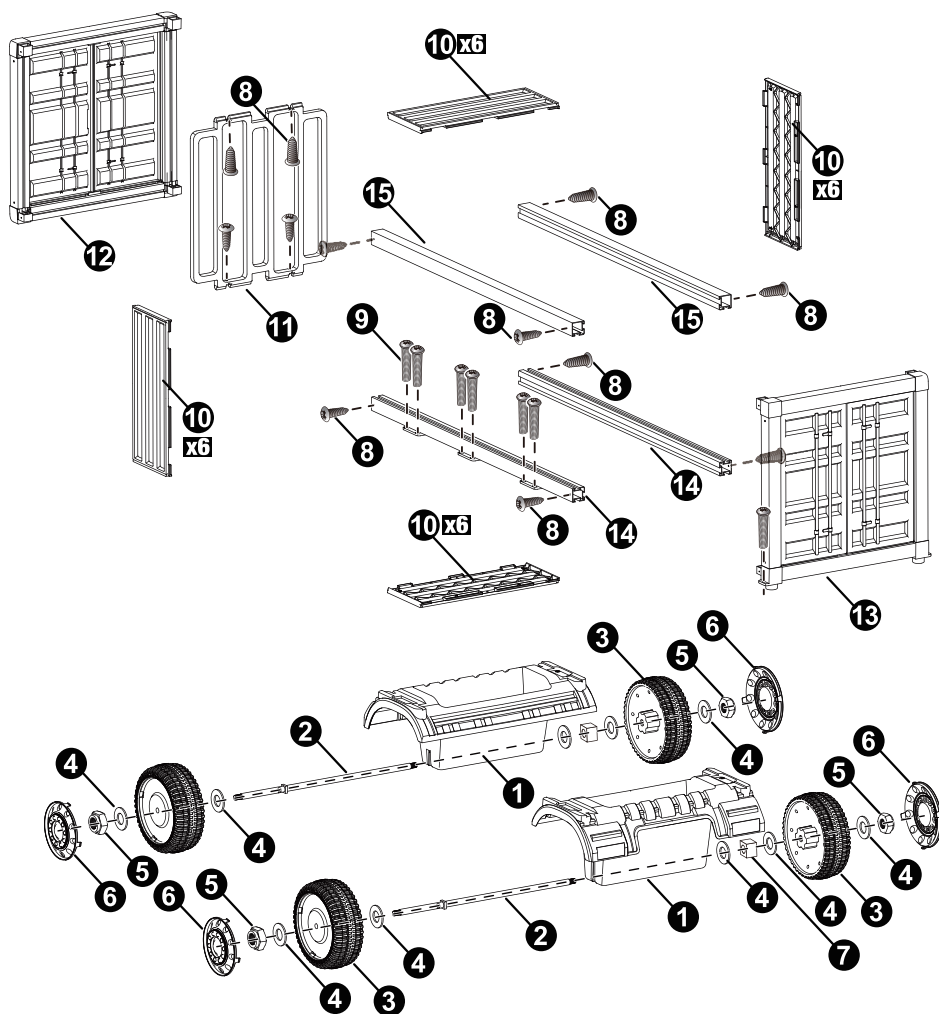

Parts List

PART NO.	PART NAME	Q'ty (pcs)	REMARKS
1	Wheel house	2	
2	Axle	2	
3	Wheel	4	
4	Ø12 washer	10	
5	Lock nut	4	
6	Wheel cover	4	
7	Square bushing	2	
8	Ø4x12 screws	12	
9	M5x12 machine screw	14	
10	Wall plate	24	
11	Clapboard	1	
12	Rear frame	1	
13	Front frame	1	
14	Square pipe (up)	2	Left and right
15	Square pipe (down)	2	Left and right

Assembly tools required:

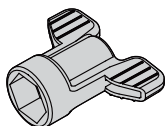

Spanner



Screwdriver
(not included)

Assembly

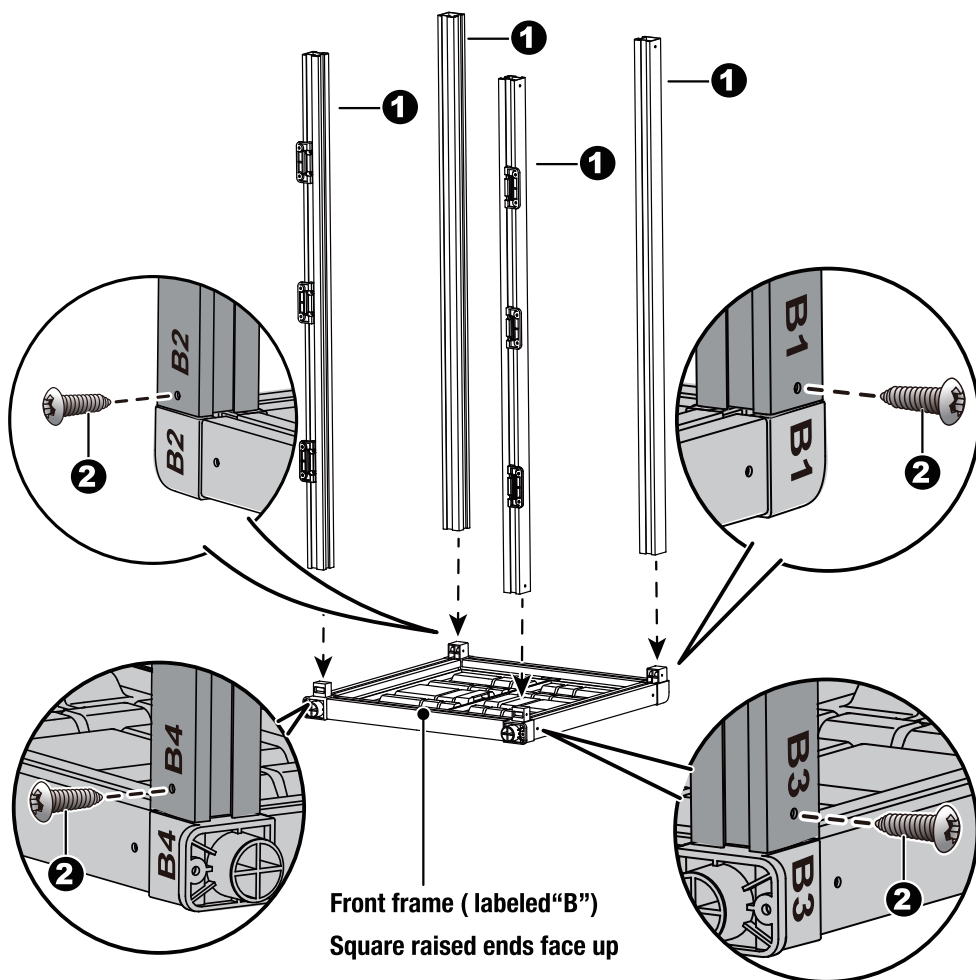

1. Place the front frame (labeled "B") on a flat ground, the side with four square connecting blocks facing up. Fit two square pipes (up) and two square pipes (down) to the rear frame.
HINT: Ensure B1 to B1, B2 to B2, B3 to B3, B4 to B4. And align the screw hole in each square pipe with the screw hole in the rear frame.
2. Insert and tighten a Ø4x12 screw with a screwdriver on each square pipe.

Assembly

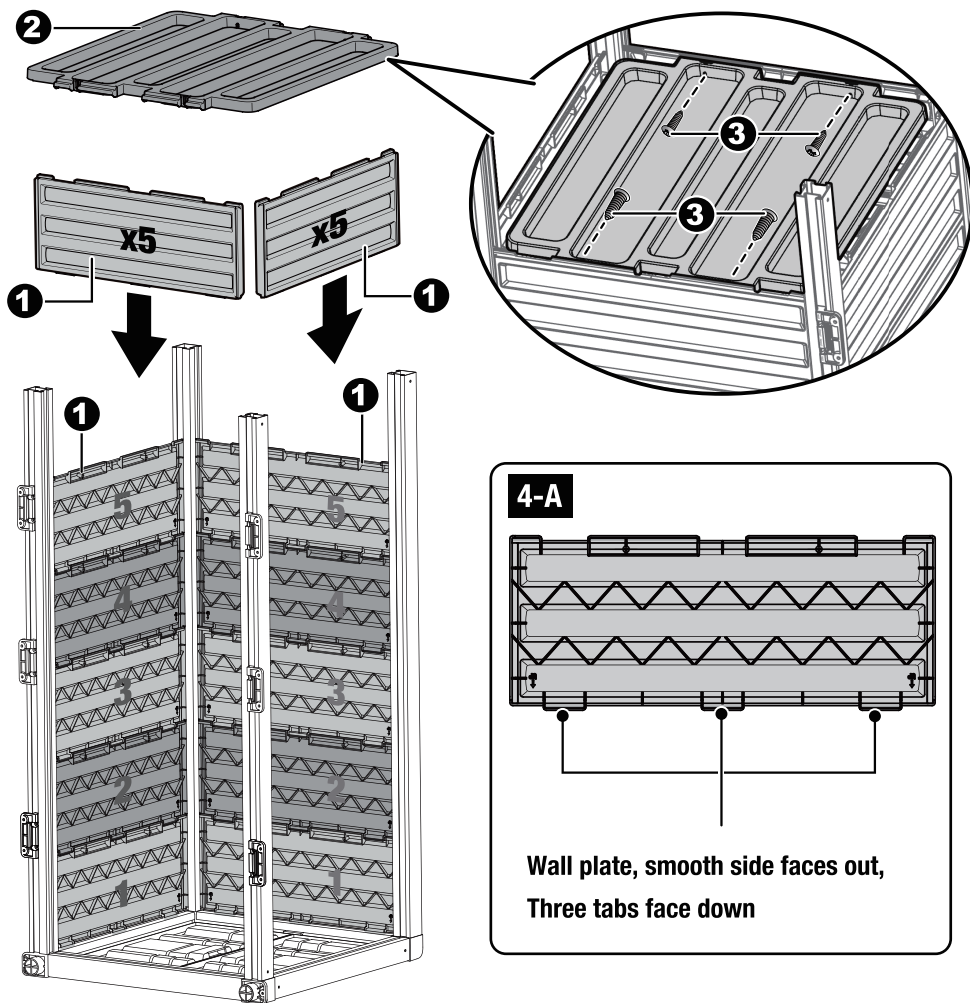

1. Fit five wall plates between every two adjacent square pipe, 20 pcs in total.
2. Fit the clapboard to the container frame, **it can be fitted horizontally or vertically, but keep smooth side up.**
3. And align the screw holes in clapboard with the screw holes in the wall plates. Insert and tighten four $\varnothing 4 \times 12$ screws with a screwdriver.

Assembly

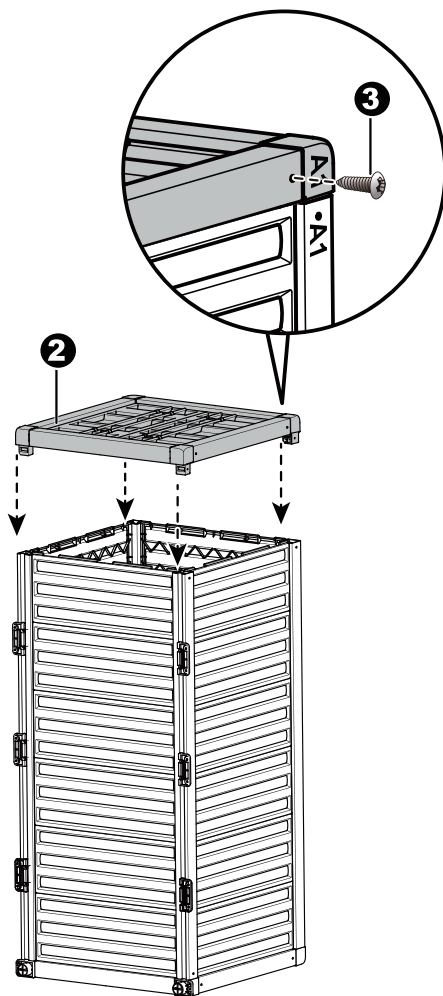
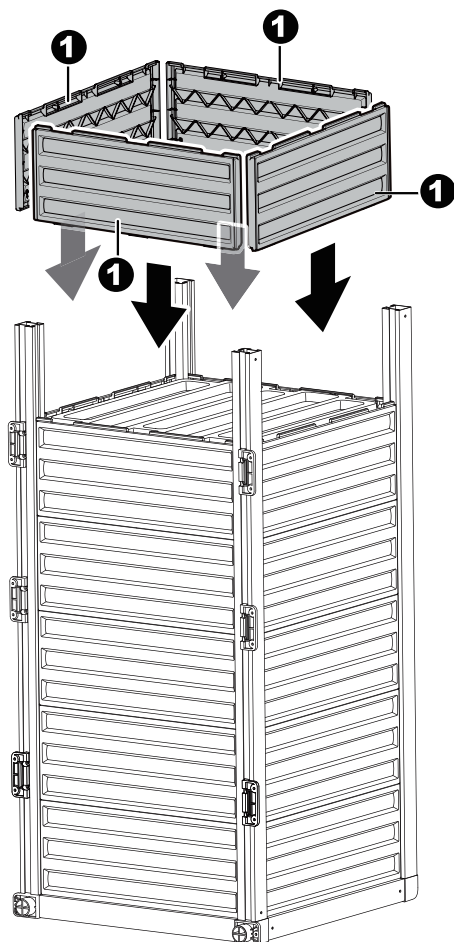

1. Continue to fit the remaining wall plates (**smooth side faces out, three tabs face down, as  4-A**) into the container frame. 4 pcs in total.
2. Fit the rear frame (**labeled A**) into the container frame. **Ensure A1 to A1, A2 to A2, A3 to A3, A4 to A4.**
3. Insert and tighten a $\varnothing 4 \times 12$ screw on each square pipe with a screwdriver.

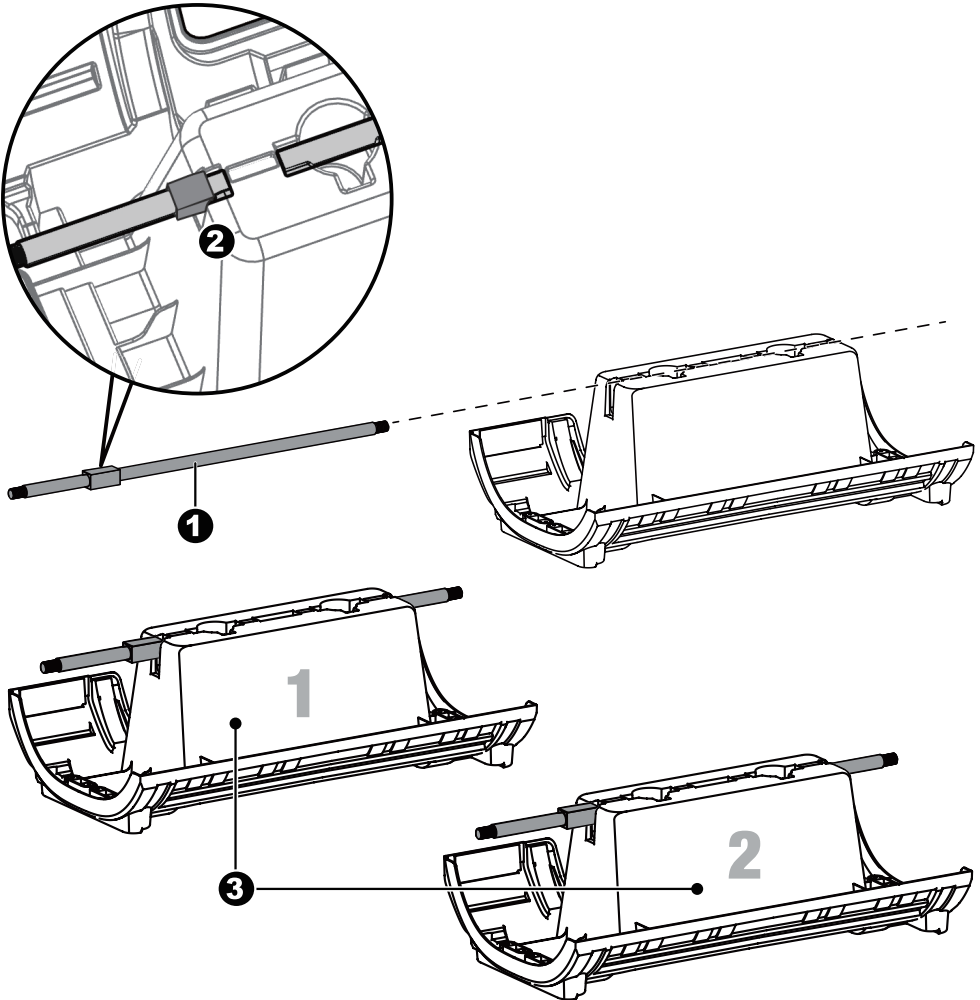
Assembly

1. Turn the wheel house upside down.
2. Insert the wheel axle through the hole in the wheel house. Ensure the square part on the wheel axle match up with the square opening on the wheel house.
3. Repeat for the other wheel house.

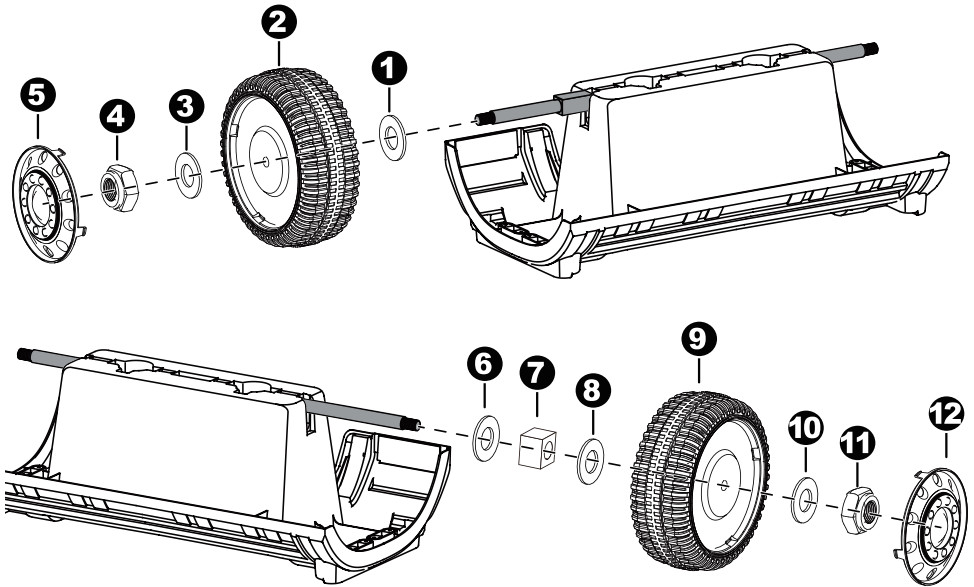
Assembly

1. Slide a $\varnothing 12$ washer onto the wheel axle from the side with the square part.
2. Slide a wheel onto the wheel axle.
3. Slide a $\varnothing 12$ washer onto the wheel axle
4. Tighten a lock nut to the end of the wheel axle with a spanner.
5. "Snap" the wheel cover to the wheel.
6. Slide a $\varnothing 12$ washer onto the wheel axle from the other end.
7. Slide a square bushing onto the wheel axle.
8. Slide a $\varnothing 12$ washer onto the wheel axle.
9. Slide a wheel onto the wheel axle.
10. Slide a $\varnothing 12$ washer onto the wheel axle
11. Tighten a lock nut to the end of the wheel axle with a spanner.
12. "Snap" the wheel cover to the wheel.

Repeat the above procedure to assemble the remaining two wheels.

Assembly

8-A

bottom view

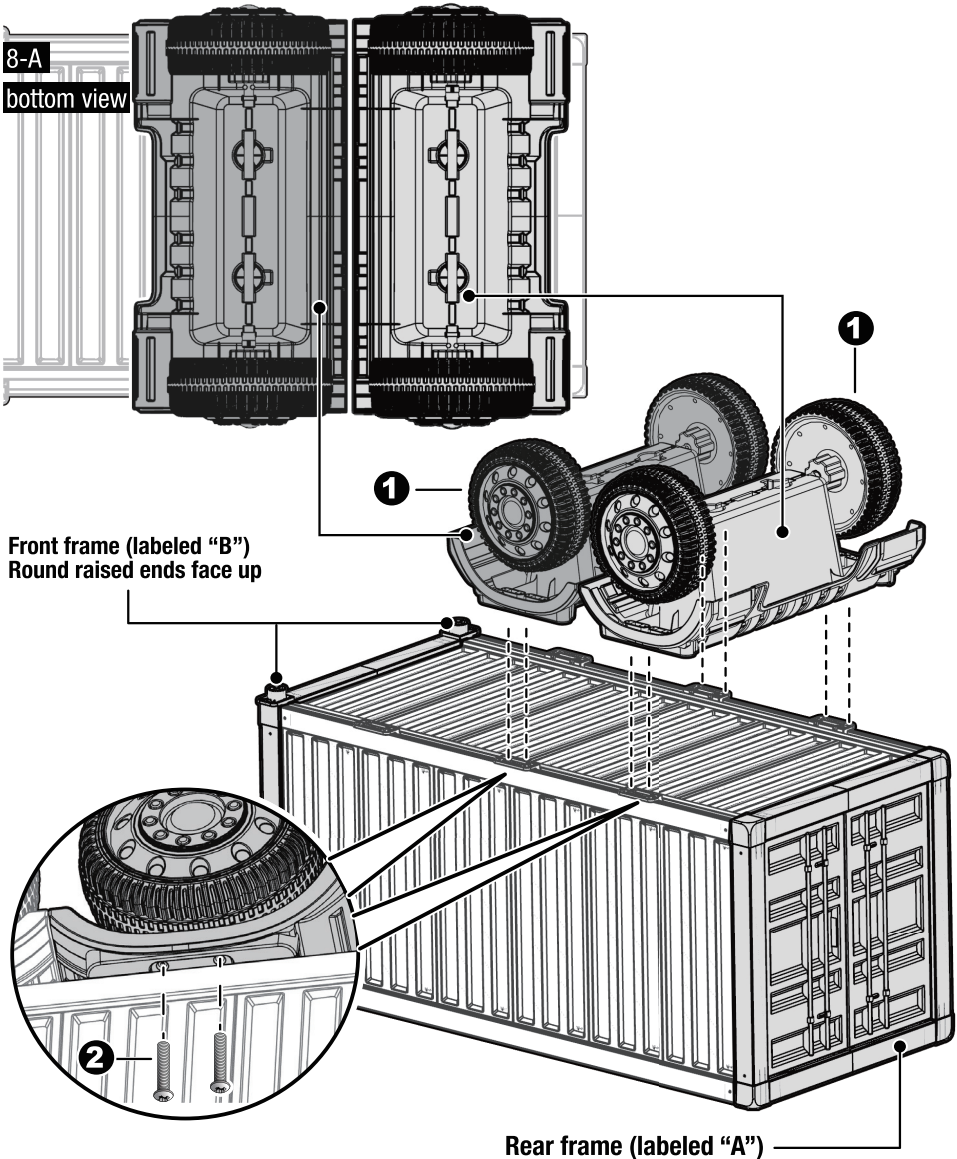

Front frame (labeled "B")
Round raised ends face up

Rear frame (labeled "A")

Turn the container assembly until the two round raised ends on the front frame (labeled "B") face up.

1. Fit the two wheel house assembly to container frame.

2. Insert and tighten four M5x12 machine screws on each side.

Assembly

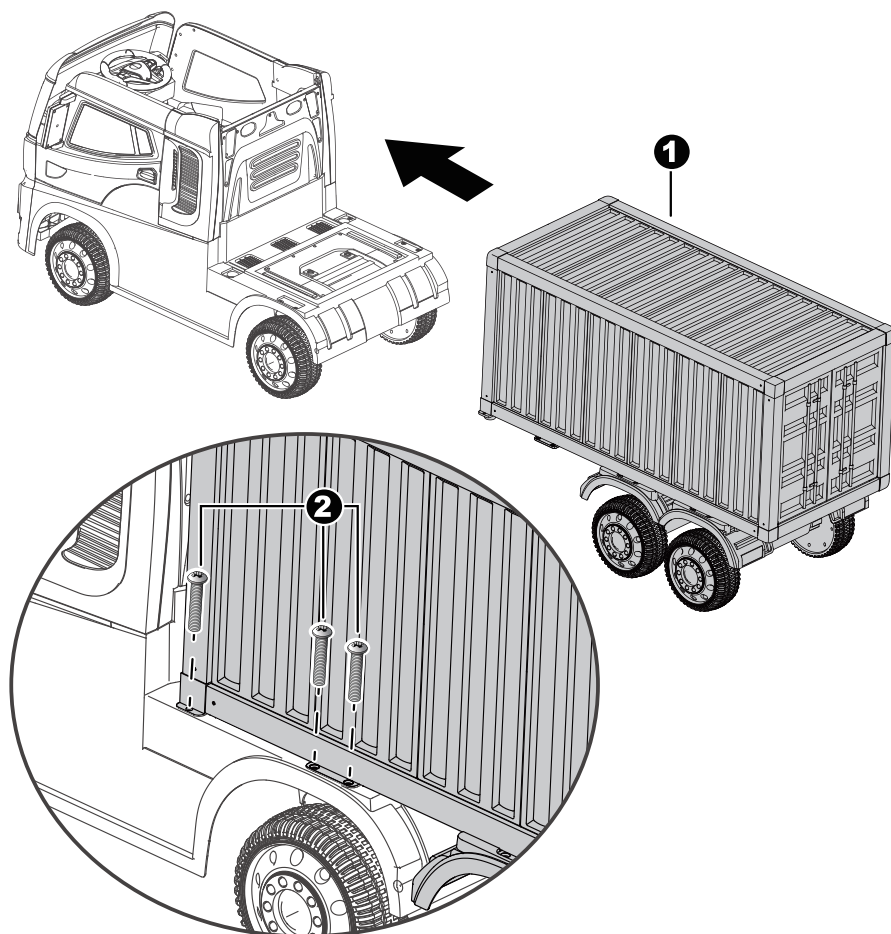

1. Fit the container assembly to the truck.
2. Insert and tighten three M5x12 machine screws on each side.



Use Your Ride-on

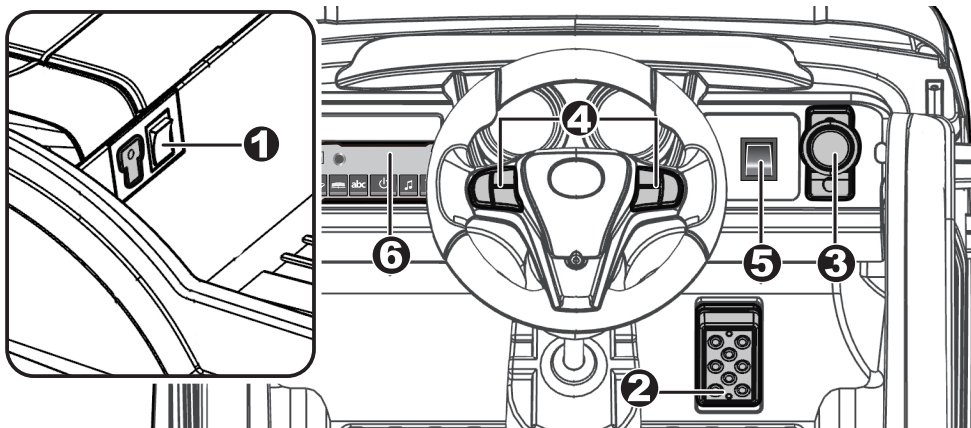

- 1. Power switch (below the seat):** Turns the vehicle on and off.
- 2. Foot pedal:** Applies power (speed) to the vehicle.
 - To move the car, press the pedal down.
 - To brake or slow down, release pressure from the pedal.
- 3. Forward/reverse switch:** Changes the direction that vehicle moves from forward to reverse.
 - To move the vehicle forward, shift the lever to top position.
 - To move the vehicle backward, shift the lever to down position.
- 4. Sound buttons (if equipped):** Press for sound playing.
- 5. High/Low speed switch:**

Operates the vehicle to move in high speed or low speed.
 HINT: The vehicle is designed to operate in low speed only in reverse.
- 6. Music player (if equipped).**

IMPORTANT

- Always stop vehicle when changing the speed (if equipped) or direction to avoid damage the gears and motor.
- **HIGH SPEED (if equipped):** Make sure your child knows how to steer, how to start and stop the product and knows the rules for safe driving.



Use the vehicle on generally level ground ONLY!

DO NOT Use the vehicle on Lawn space!

Charging

WARNING!

- **ONLY an adult is allowed to charge and recharge the battery!**
- **This product with Charging Protection: when charging, all functions will be cut off.**
- The POWER SWITCH must be turned in OFF position when charging.
- Before the first use, you should charge the battery for 4-6 hours. Do not recharge the battery for more than 10 hours to avoid overheating the charger.
- When the vehicle begins to run slowly, recharge the battery.
- After each use or once a month minimum recharge time as 8 to 12 hours, less than 20 hours at most.
- Use the only rechargeable battery and charger supplied with your vehicle. NEVER substitute the battery or the charger with another brand. Using another battery or charger may cause a fire or explosion.
- Do not use the battery or charger for any other product.
- If your ride-on with a Digital voltmeter(IF EQUIPPED), the magnitude of voltage will tell you how much power is remaining in the battery when you must recharge the battery. Make sure the vehicle is stop!

12V product	less than 12.5	The battery needs to be charge.

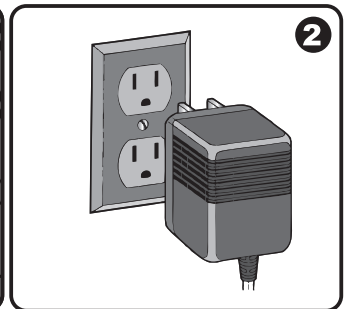
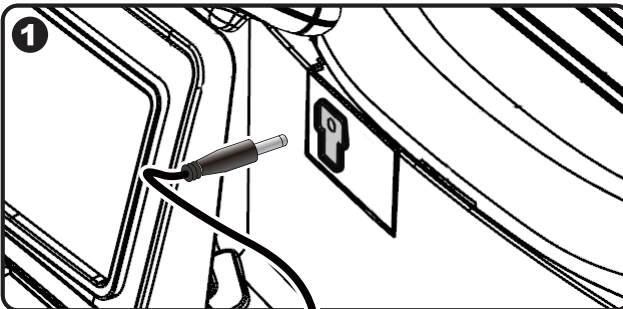

1. Plug the charger port into the input socket (the socket is below the seat).
2. Plug the charger plug into a wall outlet. The battery will begin charging.

Battery Disposal



The battery will eventually lose the ability to hold a charge. Depending on the amount of use, and varying conditions, the battery should operate for one to three years.

Important! Recycle the dead battery responsibly. The battery contains lead acid (electrolyte) and must be disposed of properly and legally. It is illegal in most areas to incinerate lead acid batteries or dispose of them in landfills. Take it to a federal or state-approved lead acid battery recycler, such as local automotive battery retailer.

Do not throw the battery away with your regular household waste!

Troubleshooting Guide

Problem	Possible Cause	Solution
Vehicle does not run	Battery low on power	Recharge battery.
	Thermal fuse has tripped	Reset fuse, see <Fuse>
	Battery connector or wires are loose	Check that the battery connectors are firmly plugged into each other. If wires are loose around the motor . contact our customer service please.
	Battery is dead	Replace battery, contact our customer service please.
	Electrical system is damaged	contact our customer service please.
	Motor is damaged	contact our customer service please.
Vehicle does not run very long	Battery is under charged	Check that the battery connectors are firmly plugged into each other when recharging
	Battery is old	Replace battery, contact our customer service please.
Vehicle runs sluggishly	Battery low on power	Recharge battery, contact our customer service please.
	Battery is old	Replace battery, contact our customer service please.
	Vehicle is overload	Reduce weight on vehicle.
	Vehicle is being used in harsh conditions	Avoid using vehicle in harsh conditions, see <Safety>.
Vehicle needs a push to go forward	Poor contact of wires or connectors	Check that the battery connectors are firmly plugged into each other. If wires are loose around the motor, contact our customer service please.
	"Dead Spot" on motor	A dead spot means the electric power is not being delivered to the terminal connection and the vehicle needs repair. contact our customer service please.
Difficult shifting from forward to reverse or vice-versa	Attempting to shift while the vehicle is in motion	Completely stop the vehicle and shift, see <Use Your Ride-On>
Loud grinding or clicking noises coming from motor or gear box	Motor or gears are damaged	Contact our customer service please.
Battery will not recharge	Battery connector or adapter connector is loose	Check that the battery connectors are firmly plugged into each other.
	Charger not plugged in	Check that the battery charger is plugged into a working wall outlet.
	Charger is not working	Contact our customer service please.
Charger feels warm when recharging	This is normal and not a cause for concern	

Completely read through this manual and the troubleshooting guide table before calling. If you still need help resolving the problem **contact our customer service please.**

Maintaining

- It is parents' responsibility to check main parts of the toy before using, Must regularly examine for potential hazard, such as the battery, charge, cable or cord, plug, screws are fastening enclosure of other parts and that in the event of such damage, the toy must not be used until that damage had been properly removed.
- Park the vehicle indoors or cover it with a tarp to protect it from wet weather.
- Recharge the battery after each use. Only an adult can handle the battery. Recharge the battery at least once a month when the vehicle is not being used.
- Do not wash the vehicle with a hose. Do not wash the vehicle with soap and water. Do not drive the vehicle in rainy or snowy weather. Water will damage the motor, electric system and battery.
- Clean the vehicle with a soft, dry cloth. To restore shine to plastic parts, use a non-wax furniture polish. Do not use car wax. Do not use abrasive cleaners.
- When not using, all the electrical source should be turned off. Turn off the power switch and disconnect the battery connection.

Fuse

The battery features a thermal fuse with a reset fuse that will automatically trip and cut all power to the vehicle if the motor, electric system or battery is overloaded. The fuse will reset and power will be restored after the unit is turned OFF for 20 seconds and then turned ON again. If the thermal fuse trips repeatedly during normal use, the vehicle may need repair. Contact your distributor please.

To avoid losing power, follow these guidelines:

- Do not overload the vehicle.
- Do not tow anything behind the vehicle.
- Do not drive up steep slopes.
- Do not drive into fixed objects, which may cause the wheels to spin, causing the motor to overheat.
- Do not drive in very hot weather, components may overheat.
- Do not allow water or other liquids to come in contact with the battery or other electric components.
- Do not tamper with the electric system. Doing so may create a short, causing the fuse to trip.

**Our products are suitable for
ASTM F963; GB6675; EN71 and EN62115 standard.**

Welcome to visit our website and purchase our quality products!

With your inspiring rating, COSTWAY will be more consistent to offer you
EASY SHOPPING EXPERIENCE, GOOD PRODUCTS and EFFICIENT SERVICE!

US office: Fontana, California

UK office: Ipswich

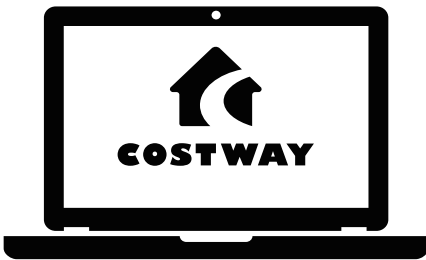

- * Reward Points
- * Exclusive Customer Service
- * Personalized Recommendations
- * Permanent Shopping Cart
- * Order History

5 Star Rating



We would like to extend our heartfelt thanks to
all of our customers for taking time to assemble
this product and giving us valuable feedbacks.

THANK
YOU
😊

