

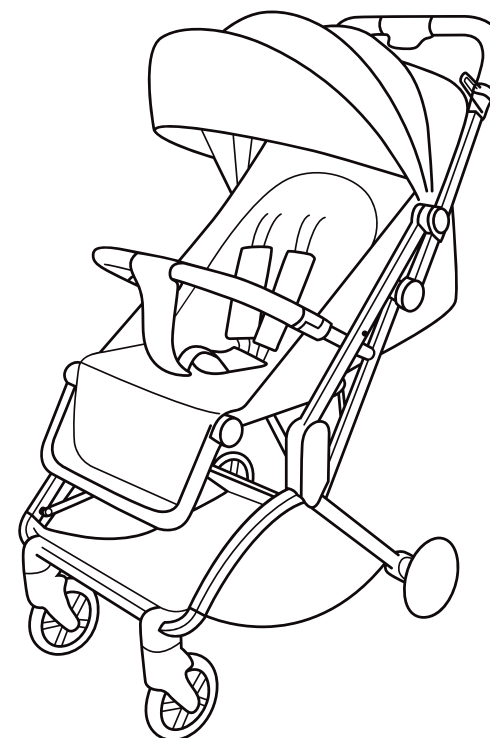

COSTWAY®



USER'S MANUAL
BABY STROLLER
BC10002

THIS INSTRUCTION BOOKLET CONTAINS **IMPORTANT** SAFETY INFORMATION. PLEASE READ AND KEEP FOR FUTURE REFERENCE.

Please give us a chance to make it right and do better!

Contact our friendly customer service department for help first.

Replacements for missing or damaged parts will be shipped ASAP!

Follow Costway

Visit us: www.costway.com



Contact Us!

Do NOT return this item.

Contact our friendly customer service department for help first.



Before You Start

Please read all instructions carefully and keep it for future reference.

General Warnings:

- ⚠ **Danger! Keep all small parts and packaging materials for this product away from babies and children, otherwise they may pose a choking hazard.**
- ⚠ **The product must be installed and used under the supervision of an adult.**
- ⚠ **Read through each step carefully and follow the proper order.**
- ⚠ **Remove all Packaging, separate and count all parts and hardware before Installation.**
- ⚠ **Please ensure that all parts are correctly installed, incorrect Installation can lead to a Danger.**
- ⚠ **We recommend that, where possible, all items are assembled near to the area in which they will be placed in use, to avoid moving the product unnecessarily once assembled.**
- ⚠ **Ensure a secure surface during construction, and place the product always on a flat, steady and stable surface.**

01 WARNINGS

- 1) Read all instructions before assembly and using of this product. Keep the instruction for future reference.
- 2) Before assembly or using, inspect this product for damaged hardware, loose joints, missing parts or sharp edges.
- 3) Do not use if any parts are missing or broken. Contact customer service for replacement parts and instructions if needed. Never substitute the parts.
- 4) Please remove all parts from the package and identify them before assembly.
- 5) Adult assembly required because of small parts. Keep assembly parts out of reach of children under 3 years. Make sure the locking is under working before using

02 PRECAUTIONS

- 1) WARNING: Never leave children unattended
- 2) CAUTION: Purses, shopping bags, parcels, diaper bags or accessory items may change the balance of the stroller and cause hazardous unstable conditions
- 3) This product is not suitable for running or skating
- 4) WARNING: Avoid serious injury from falling or sliding out. Always use seat belt
- 5) Do not exceed the maximum loading weight limit of 33LBS in seat. Excessive weight may cause a hazardous unstable condition to occur
- 6) Do not adjust seat position when child is in the seat
- 7) Do not let your child play with this product
- 8) WARNING: Child may slip into leg openings and strangle. Never use in reclined carriage position(s) unless footrest is folded up and snapped
- 9) Do not exceed the maximum loading weight limit of 3 LBS in shopping basket
- 10) Make ensure your child is kept away when unfolding and folding this stroller
- 11) Be careful for your finger when folding or unfolding
- 12) Be careful for your finger or any part of your body when adjust the backrest, safety belt and front armrest.
- 13) Always set the wheel brakes when stroller is not moving.
- 14) Never use this stroller on stairways or escalators.
- 15) Do not place this stroller near dangerous places like stove or pool
- 16) Only one child is allowed to occupy the stroller one time
- 17) To avoid danger of suffocation, keep the plastic bag away from child

03/ PRODUCT PARTS

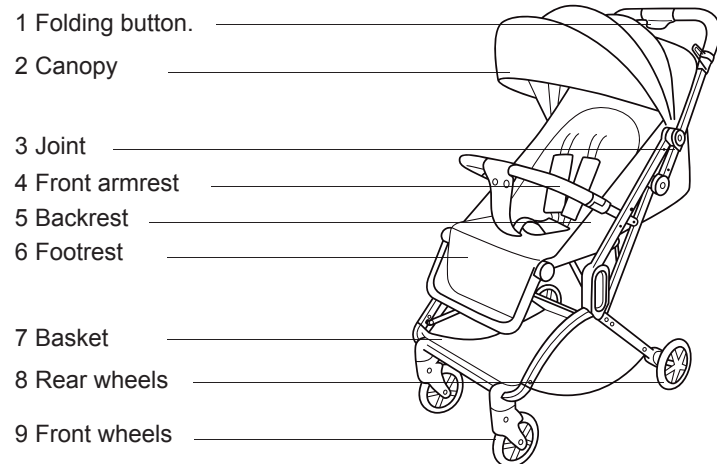

04/INSTALLATION STEPS

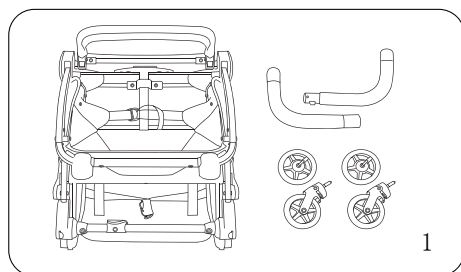

1. Take out the stroller from carton, including 1 set of frame, 2 rear wheels, 2 front wheels, 2 parts of front armrest (pic.1)

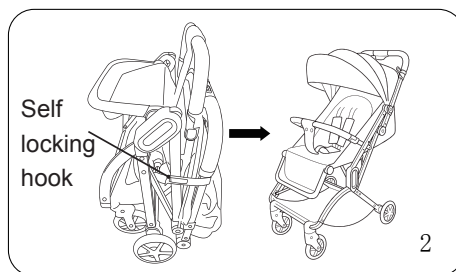

2. Unfolding: Pull the self locking hook outward to release and lift the stroller until you hear a "click" (pic.2)

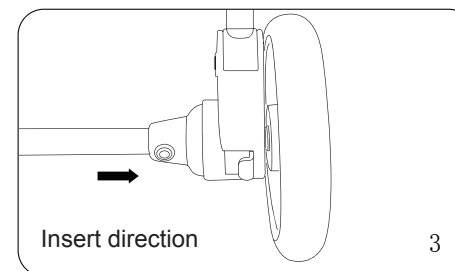

3. Install rear wheels: Insert wheel shaft into the center hole of rear wheels until you hear a "click" . (pic.3)

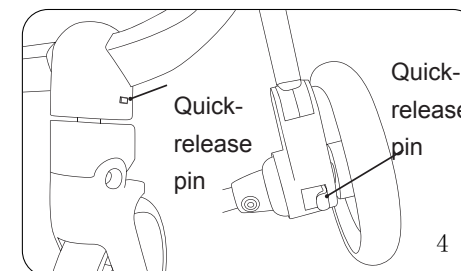

4. Detach wheels: Use a hard tool to press the "quick-release" pin on front wheels. Pull the "quick-release" pin on rear wheels. (pic.4)

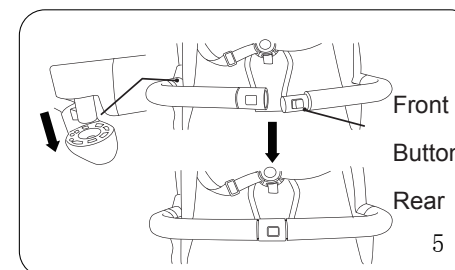

5. Install front armrest: Insert the left and right part of armrest into the socket on frame, then insert the left plug to the right socket until the button pops up. Conversely, Press the button to open the armrest. (pic.5)

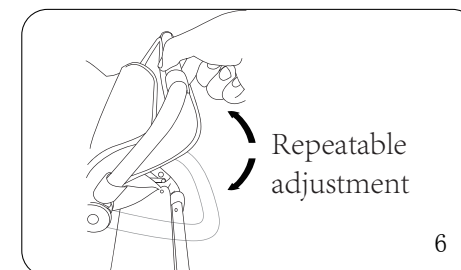

6. Footrest adjustment: Pull the footrest upward to adjust position. Pull it up to the maximum position when you hear a "click", then it can be pressed down to the lowest position.

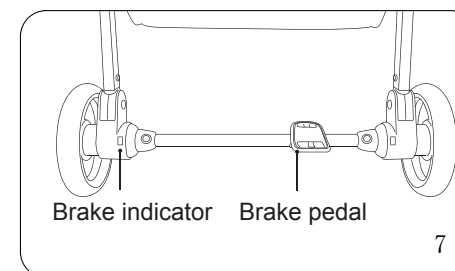

7. Brake: Step the brake pedal down until it "clicks" into the locked position. Lift the pedal to release the brake. (pic.7)

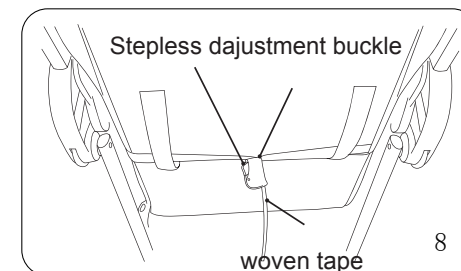

8. Backrest adjustment: Hold the buckle while push the backrest upward to any position, then insert plug to socket of buckle. (pic.8)

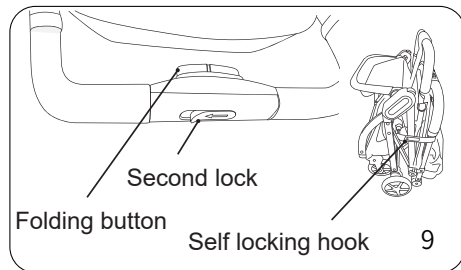

9. Fold stroller. push the second lock to another side with your thumb, while press the button to the bottom, then release your hand, the stroller can fold by itself under its gravity auto folding system. In the meantime, the self locking hook will be locked. The stroller can stand upright after folding (pic.9)

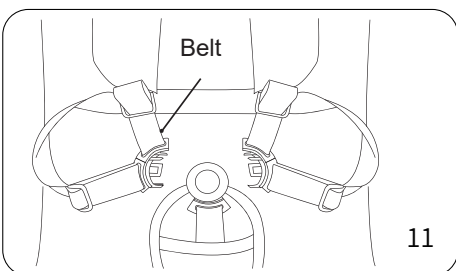

11. Adjust safety belt: Pull or release the end of belt to adjust the length (pic.11)

05/PRODUCT PERFORMANCE

1. One- hand folding. gravity auto folding system, the stroller can be standing and towing with telescoping handle after folding
2. Compact & travel friendly
3. Peekaboo windows, integrated ventilation net
4. Quick mid detachable front armrest
5. Stepless adjustment of backrest
6. 3- position adjustable footrest

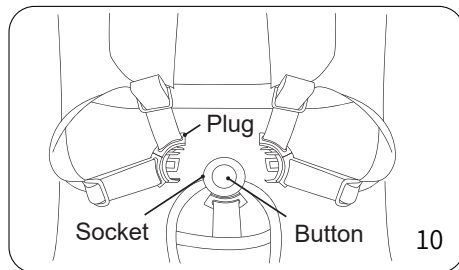

10. Release and fasten safety belt: Make sure the crotch belt is placed between your child's legs. Insert both plugs to the socket of buckle until you hear a "click". Press the center button on the buckle to release belt (pic.10)

7. Seat height 500MM (19.7 INCH), Valid inside width of seat 360MM (14 INCH)
8. A comfortable "stop and go" brake
9. Four wheels shock absorption, quick release
10. Washable fabrics, the entire fabric can be quickly removed without tools

06/CART MAINTENANCE

1. Please check and maintain this stroller frequently
2. Use the stroller in a dry environment at room temperature
3. Don't do intense exercise while pushing the stroller
4. To clean the plastic parts on stroller use warm water on a sponge or damp cloth. Hand wash fabric with damp cloth and air dry. Do not use bleach
5. Regularly check for loose screws, damaged parts or broken stitches.
6. When disassembling and assembling. please carefully check the instructions to avoid damaging the stroller



WARNING: Never leave child unattended.

WARNING: Avoid serious injury from falling or sliding out. Always use seat belt.

WARNING: Parcels or accessory items, or both, placed on the unit may cause the unit to become unstable.

Welcome to visit our website and purchase our quality products!

With your inspiring rating, COSTWAY will be more consistent to offer you
EASY SHOPPING EXPERIENCE, GOOD PRODUCTS and EFFICIENT SERVICE!

US office: Fontana, California

UK office: Ipswich



- * Reward Points
- * Exclusive Customer Service
- * Personalized Recommendations
- * Permanent Shopping Cart
- * Order History

5 Star Rating



We would like to extend our heartfelt thanks to
all of our customers for taking time to assemble
this product and giving us valuable feedbacks.

