

## USER'S MANUAL

### Baby Swing BC10089

THIS INSTRUCTION BOOKLET CONTAINS **IMPORTANT** SAFETY INFORMATION. PLEASE READ AND KEEP FOR FUTURE REFERENCE.



# Before You Start

Please read all instructions carefully and keep it for future reference.

## General Warnings:

- ⚠ Attention: To prevent possible injury by entanglement, remove this toy when the child starts trying to get up on its hands and knees in a crawling position.
- ⚠ Danger! Keep all small parts and packaging materials for this product away from babies and children, otherwise they may pose a choking hazard.
- ⚠ The product must be installed and used under the supervision of an adult.
- ⚠ Read through each step carefully and follow the proper order.
- ⚠ Remove all Packaging, separate and count all parts and hardware before installation.
- ⚠ Please ensure that all parts are correctly installed, incorrect installation can lead to a danger.
- ⚠ We recommend that, where possible, all items are assembled near the area in which they will be placed in use, to avoid moving the product unnecessarily once assembled.
- ⚠ Ensure a secure surface during installation, and place the product always on a flat, steady and stable surface.

# Standard Configuration Parts

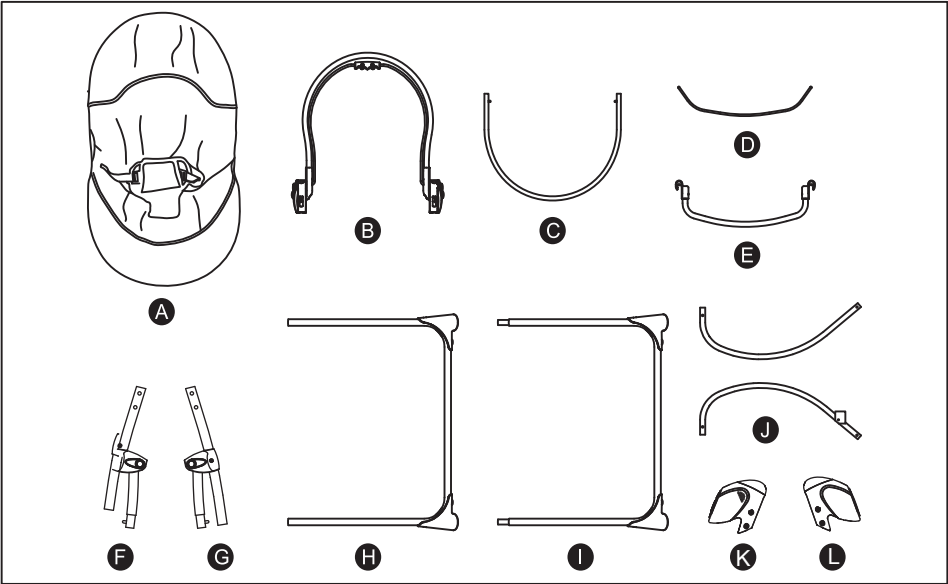

- A. seat cover      B. backrest tube      C. seat support tube  
D. fabric fixed steel wire      E. cross tube  
F. left support tube group      G. right support tube group  
H. front leg      I. rear leg      J. hanging tubes  
K. left driving part      L. right driving part

# Selective Parts

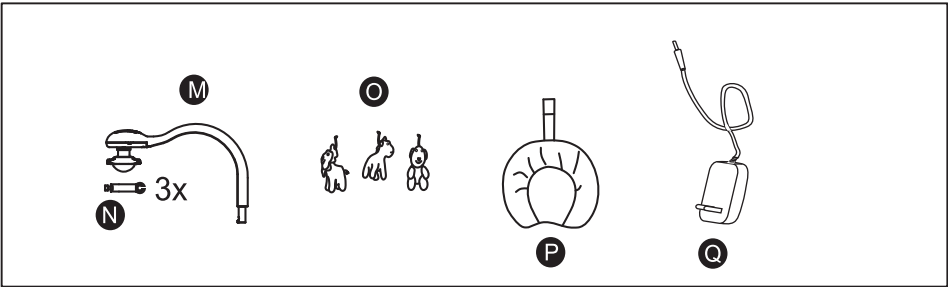

- M. main toy bar      N. toy bar arm      O. toys      P. head support  
Q. AC/DC power adapter

# ASSEMBLY

1. Insert the seat support tube into the backrest tube and “click” into place.

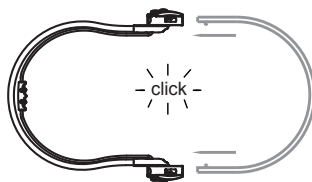

2. Put on the seat cover to the seat frame.

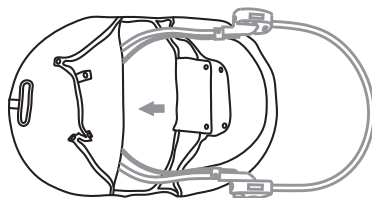

3. Insert the steel wire through fabric sewing housing, put the two ends of the steel wire into the plastic holes and “click” into place.

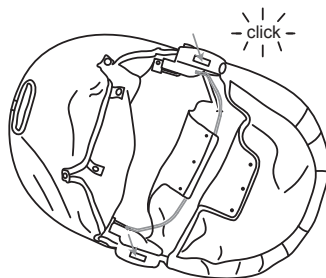

4. Fix the seat cover onto the steel wire with the buttons.

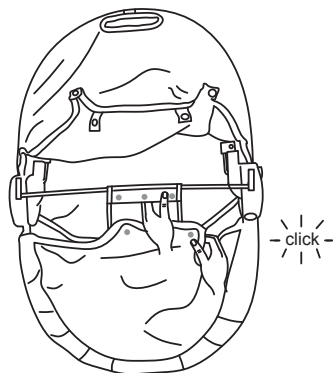

5. Fix the backrest fabric onto the steel wire with the buttons.

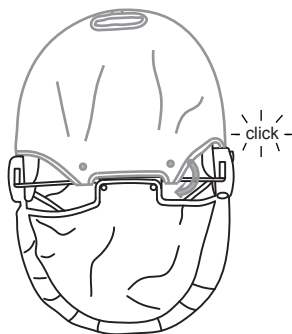

6. Unfasten the screw. (Attention: do not take off the screw caps). Insert the leg into music device and fasten the screws. Same as the other side. Attention: the folding buttons on legs should be outward always.

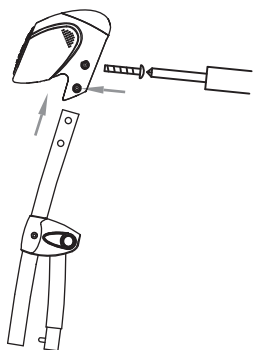

7. Unfold the 2 driving system parts until you hear “click” sound.

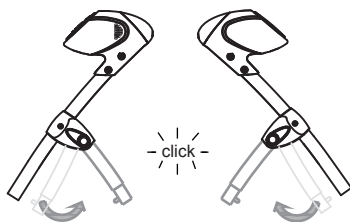

8. Install the front legs and rear legs by inserting the two legs into the upper part tube until you hear “click” sound.

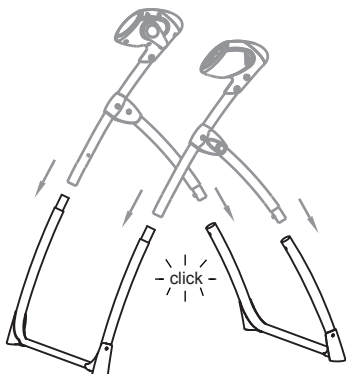

9. Install the hanging tubes: Insert the 2 hanging tubes into the plastic part holes until you hear “click” sound.

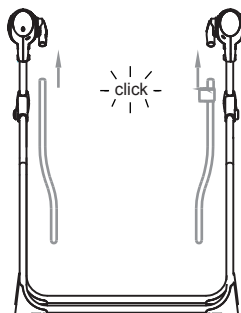

10. Install the cross tube:  
Install the cross tubes onto the 2 hanging tubes and “click” into place.

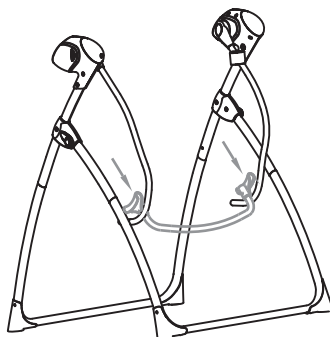

11. Install the seat unit: Install the seat unit by inserting the 2 hanging tubes into the seat socket.

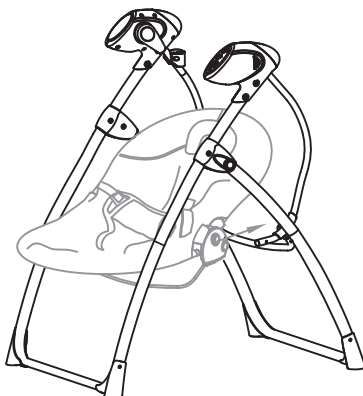

12. Assemble the toy bar: put on the 3 toy bar arms onto the toy bar, and then put on the 3 plush toys into the holes of the arms.

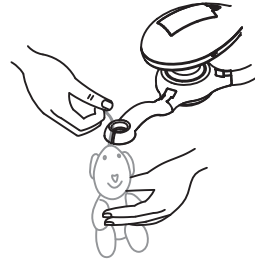
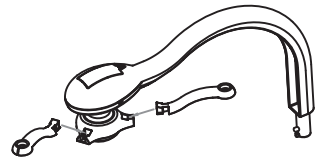

13. Insert the toy bar frame into the toy bar hole according to the guide line, and then you can turn around the toy bar by 360 degree, you can stop in different position.

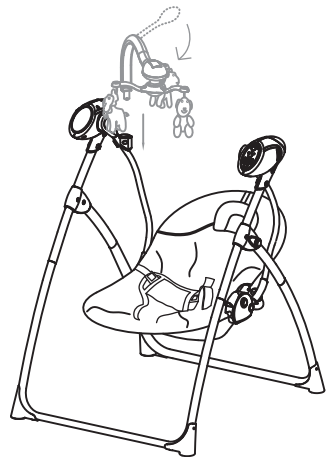

## FUNCTIONS

1. Adjust the backrest positions: there are 3 positions of backrest position, adjust it by pulling handle of the backrest.

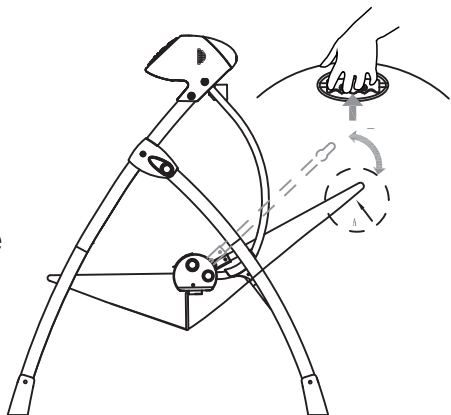

2. Adjust the positions of toy bar: The toy bar can be hand moved to different positions as you like, easy for parents to amuse baby.

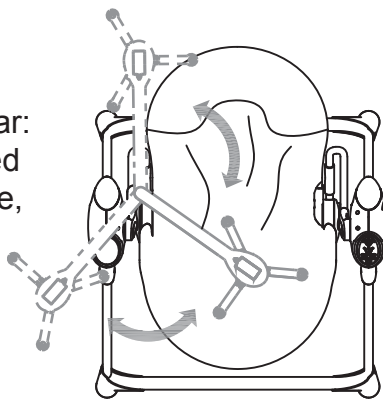

3. Install the battery of toy bar: Install 2pcs 1.5V AAA LR03 size batteries, and turn on the toy bar button, then the toy bar can be turned around automatically, turn on the light button to open the lamp light.

SCREW  
BATTERY BOX COVER  
1.5V SIZE AAA LR03 +  
2 X  
(BATTERIES NOT INCLUDED)

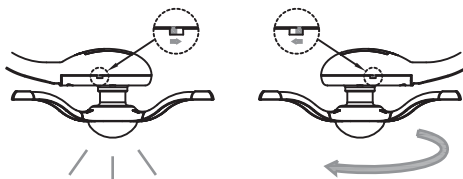
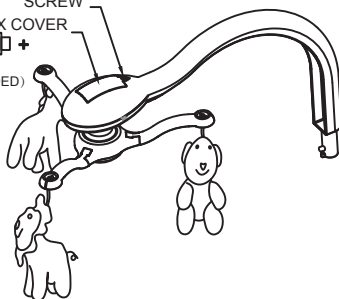



4. Folding: Folding the swing by pressing the 2 buttons on the 2 sides of the swing frame.

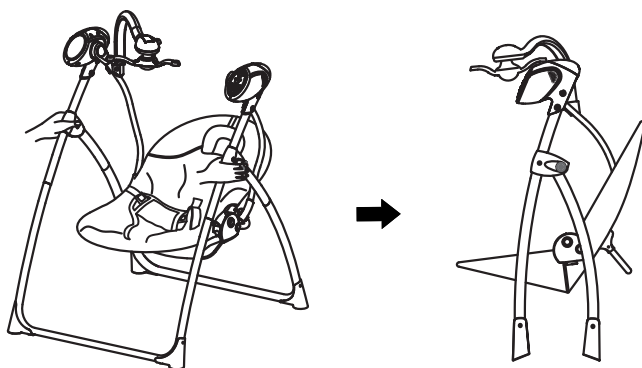

# SWING CONTROL PLATE INSTRUCTIONS

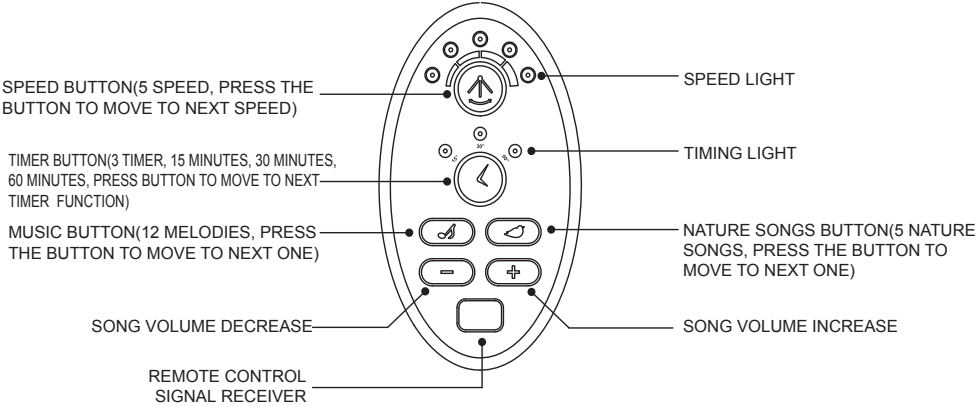

(BATTERIES NOT INCLUDED)

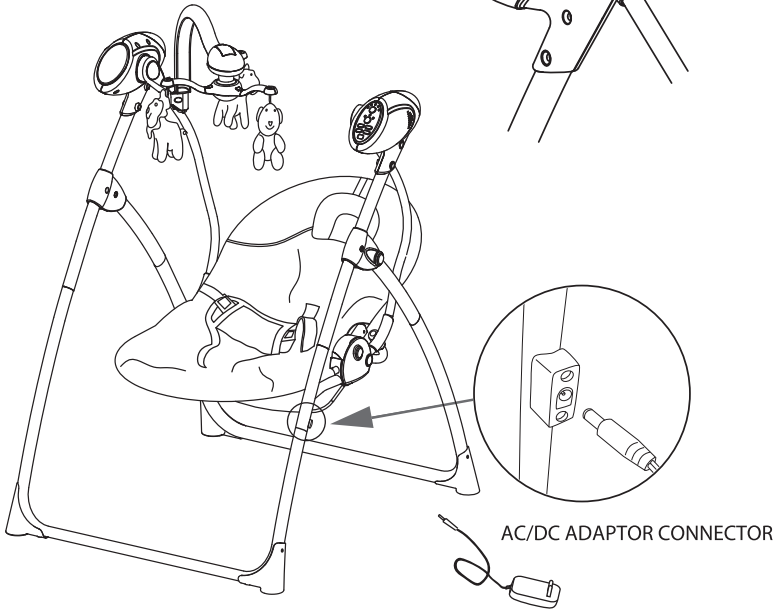
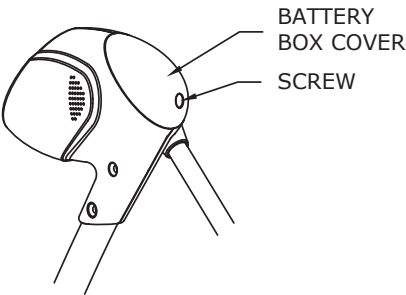
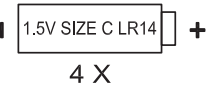

# **WARNING**

Read this instruction carefully before using and keep it for future reference. Failure to follow these warnings and the assembly instruction could result in serious injury or death.

Products need to be installed by adult and used under adult's supervision.

1. Do not use the product if any parts are broken, torn or missing and use only spare parts approved by the manufacturer.
2. Always use harness. Do not move or lift this product with the baby inside it.
3. Never leave child unattended. Do not let children play with this product.
4. Stop using product when child attempts to climb out or reaches 20 lbs.
5. It is dangerous to place this product on an elevated surface. Always use on a flat, level floor.
6. To avoid injury ensure that children are kept away when unfolding and folding this product.
7. Be aware of the risk of open fire and other sources of strong heat, such as electric bar fires, gas fires, etc. In the vicinity of the product.
8. This product does not intend for prolonged period of sleep. Should your child need to sleep, then place the child in a suitable cot or bed.
9. Do not use the product without the seat cushion.
10. Discontinue using your product should it become damaged or broken.
11. Transformers used with the infant swing are to be regularly examined for damage to the cord, plug, enclosure and other parts, and in the event of such damage they shall not be used.
12. The infant swing shall only be used with the recommended transformer.

**FALL HAZARD:** Children have suffered head injuries falling from rockers.

- **ALWAYS** use restraints. Adjust to fit snugly.
- **NEVER** lift or carry baby in rocker.
- **STOP** using product when baby starts trying to sit up or has reached 20 lbs, whichever comes first.
- **ALWAYS** place rocker on floor. Never use on any elevated surface.

**SUFFOCATION HAZARD:** Babies have suffocated when seats tipped over on soft surfaces.

- **NEVER** use on a bed, sofa, cushion, or other soft surface.
- Stay near and watch child during use. This product is not safe for unsupervised use or unattended sleep.

## **CAUTION**

To prevent battery leaks, which can burn skin and eyes:

- Always replace the entire set of batteries at one time.
- Never mix old and new batteries, or batteries of different brands or types.
- Remove batteries when storing product for a long time.
- Dispose of used batteries immediately.

### **For safe battery use**

1. Keep the batteries out of children's reach.
  2. Only the recommended batteries or equivalent are to be used, volts and size.
  3. Batteries are inserted with the correct polarity.
  4. Remove exhausted batteries from the product.
  5. Do not short-circuit supply terminals.
  6. Rechargeable batteries are to be removed before being charged.
  7. Rechargeable batteries are only to be charged under adult supervision.
- Non-rechargeable batteries are not to be recharged.

8. Any battery may leak battery acid if mixed with a different battery type, if inserted incorrectly(put in back-wards) or if all batteries are not replaced or recharged at the same time. Do not mix old and new batteries. Do not mix alkaline, standard(carbon-zinc) or rechargeable(nickel-cadmium) batteries.
9. Any battery may leak battery acid or explode if disposed of in fire or an attempt is made to charge a battery not intended to be recharged.
10. Never use a charger made from one type of battery to charge another type.
11. Discard leaky batteries immediately. Leaky batteries can cause skin burns or other personal injury. When discarding batteries, be sure to dispose of them in the proper manner, according to your state and local regulations.
12. Always remove batteries if the product is not going to be used for a month or more. Batteries left in the unit may leak and cause damage.
13. Recommended type batteries-alkaline disposables, size C(LR14-1.5v). Never mix battery types. Change batteries when product ceases to operate satisfactorily.

## **MAINTENANCE**

This product requires regular maintenance to keep it in good working order. Regularly check all parts of the product to ensure that they are operating correctly and for signs of wear or damage. Only replacement parts supplied or recommended by the manufacturer should be used.

## **CLEANING**

Refer to care label on the product for cleaning instructions for fabrics. Clean metal or plastic components with mild detergent and warm water. Never use abrasive, ammonia based, bleach based or spirit type cleaners. Ensure the product is fully dry before use or storage.



**Please give us a chance to make it right and do better !**

Contact our friendly customer service department for help first.  
Replacements for missing or damaged parts will be shipped ASAP !

US office: Fontana      UK office: Ipswich      AU office: Truganina



## Contact Us !

**Do NOT return this item.**

Contact our friendly customer service department for help first.



US:cs.us@costway.com

UK:cs.uk@costway.com

AU:cs.au@costway.com