

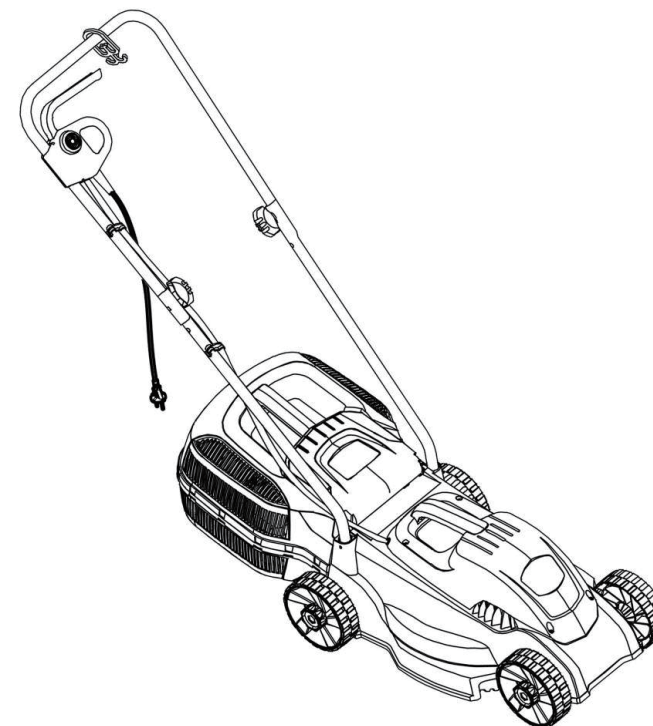

**COSTWAY®**



**USER'S MANUAL**  
**Electric Lawn Mower**  
**ET1279**

THIS INSTRUCTION BOOKLET CONTAINS **IMPORTANT** SAFETY INFORMATION. PLEASE READ AND KEEP FOR FUTURE REFERENCE.

**Please give us a chance to make it right and do better!**

Contact our friendly customer service department for help first.

Replacements for missing or damaged parts will be shipped ASAP!

**Follow Costway**

Visit us: [www.costway.com](http://www.costway.com)



# Contact Us!

## Do NOT return this item.

Contact our friendly customer service department for help first.



# Before You Start

- ⚠ Please read all instructions carefully.
- ⚠ Retain instructions for future reference.
- ⚠ Separate and count all parts and hardware.
- ⚠ Read through each step carefully and follow the proper order.
- ⚠ We recommend that, where possible, all items are assembled near to the area in which they will be placed in use, to avoid moving the product unnecessarily once assembled.
- ⚠ Always place the product on a flat, steady and stable surface.
- ⚠ Keep all small parts and packaging materials for this product away from babies and children as they potentially pose a serious choking hazard.

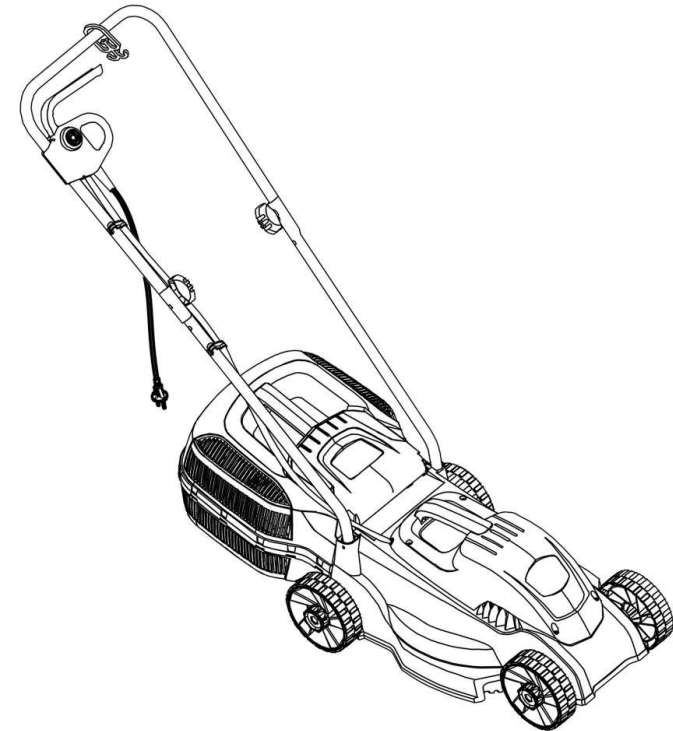

## WARNING!

When using electric tools, basic safety precautions, including the following, should always be followed to reduce the risk of fire, electric shock and personal injury. Read all these instructions before operating this product and save these instructions.

It's recommended to stop the machine working once it works for more than half an hour to prevent the motor from overheating overload.

Run the machine at first before you are going into to use it to cut the grass.

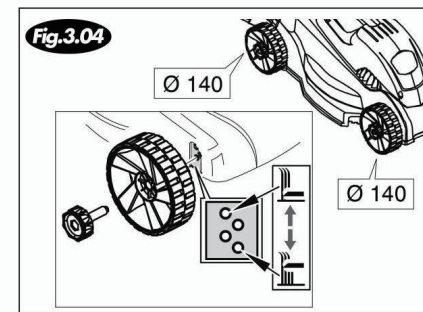
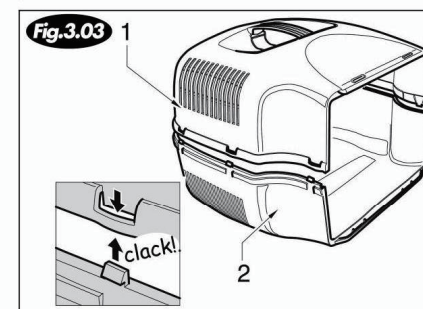
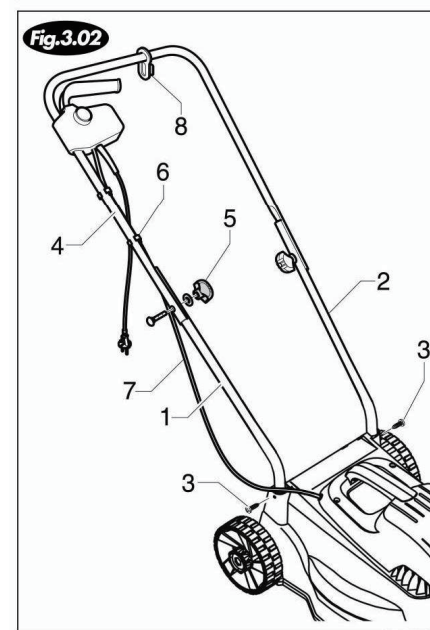
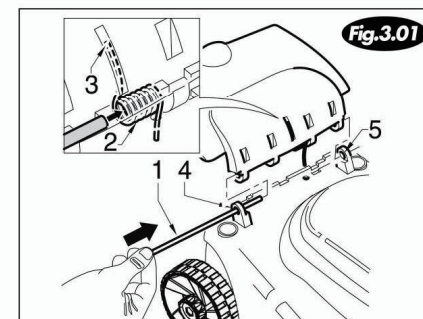
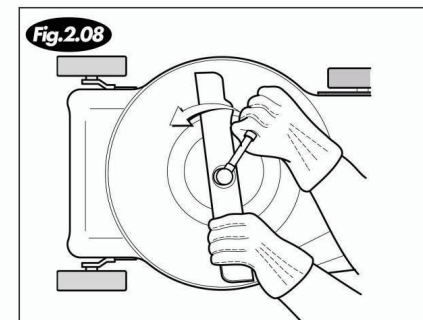
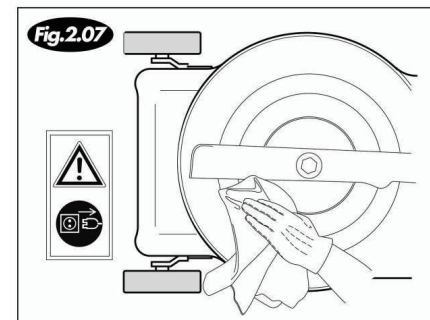
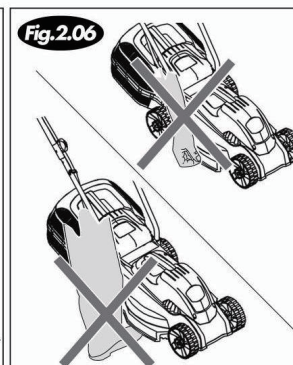
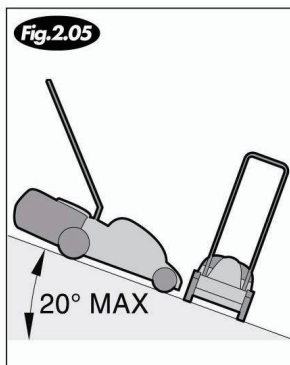
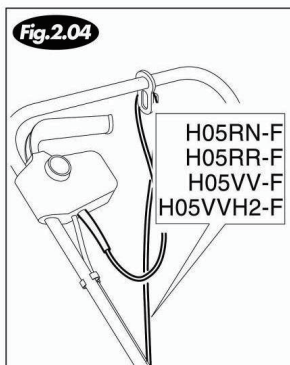
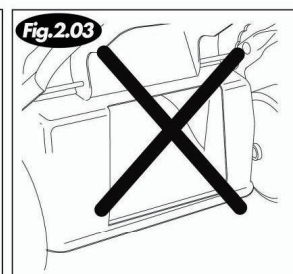
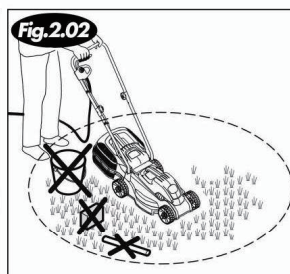
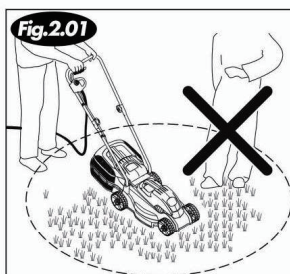
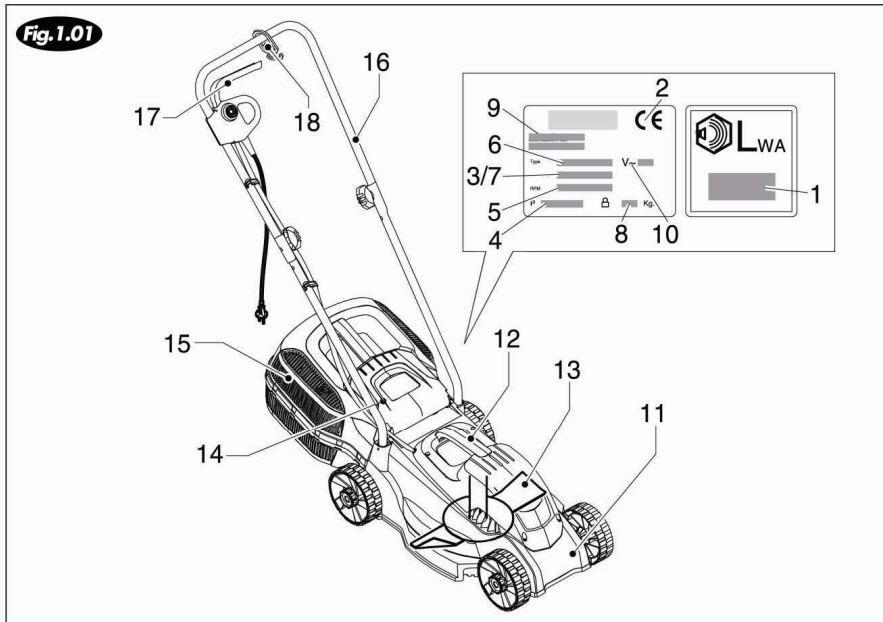

## TECHNICAL DATA

Lawn Mower	M1G-ZP4-320	
Voltage, Frequency	V / Hz	120 / 60
Power Input	W	1,200
No Load Speed	RPM	3,100
Cutting Width	mm	320
No. of Cutting Height		3
Height Settings	mm	26/41/56
Blade Type	Steel	
Blade Brake	Yes	
Grass box capacity	L	30
Weight	LBS	19
Cable Length	m	0.35

## POSITIONING OF SAFETY LABELS

Your lawnmower should be used with due care and attention. Therefore, figured labels have been placed on various parts of the machine to remind you of the main precautions to be taken. Their full meaning is explained later on.

These labels are an integral part of the lawnmower and so, if any of them should become detached or illegible, contact your Supplier for their replacement. You are also asked to carefully read the safety regulations in the applicable chapter of this handbook.



Before using the machine, read the instruction manual.



ATTENTION!



Keep persons, who do not know the Safety rules away from the mower.



Wear safety glasses to protect your eyes.



Remove the power supply cable and read instructions before carrying out and repair or maintenance.



Keep the power supply cable away from the blade.



**IMPORTANT:** Before connecting the lawnmower to the power supply, ensure that the socket has a differential switch (circuit breaker) and that the supply voltage is the same as that shown on the machine's identification label.

## 1. DESCRIPTION OF THE PARTS (Fig.1.01)

1. Acoustic power level according to EEC directive 2000/14/CE

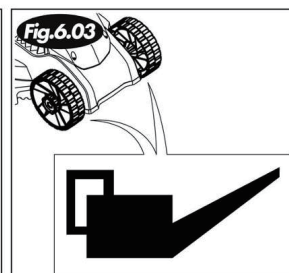
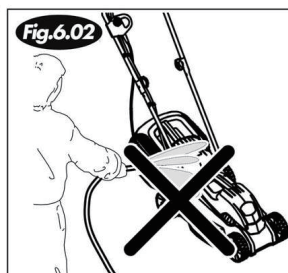
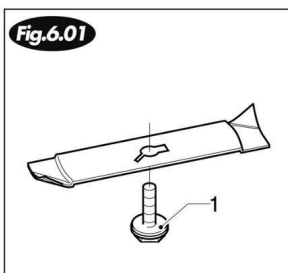
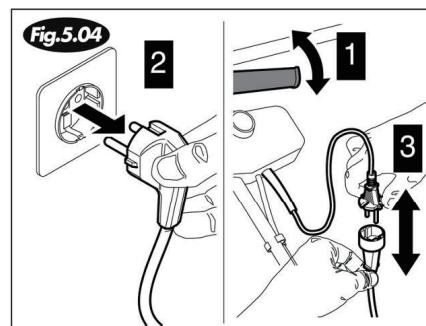
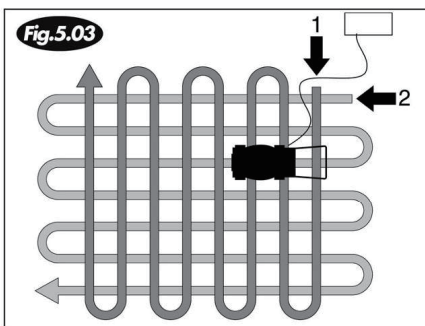
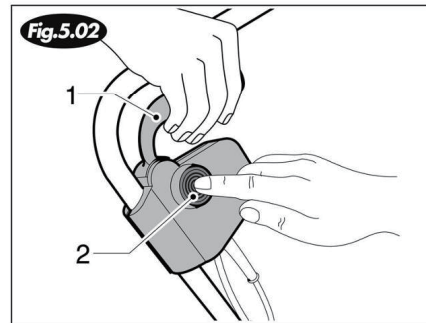
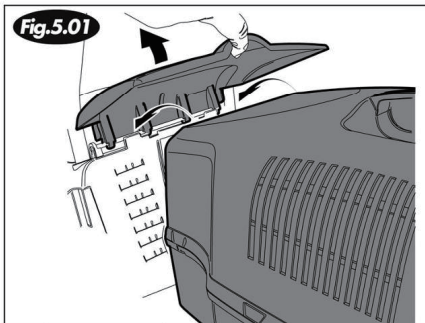
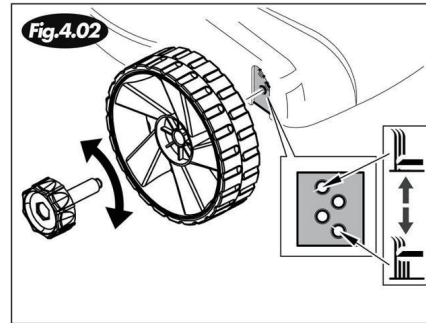
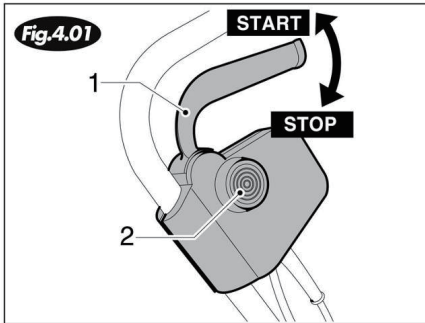



2. Mark of conformity according to EEC directive 98/37
3. Year of manufacture
4. Rating
5. Operational blade speed in r.p.m
6. Lawnmower type
7. Serial number
8. Weight in Kg. (if over 25 kg.)
9. Name and address of Manufacturer
10. Supply voltage and frequency
11. Chassis
12. Transporting handle
13. Blade
14. Stone-deflector
15. Grass-catcher
16. Handle
17. Motor switch
18. Electric cable hood

## 2. SAFETY REGULATIONS



ATTENTION!

### A) TRAINING

- 1) Read the instructions carefully. Be familiar with the controls and the proper use of the equipment. Learn how to stop the motor quickly.
- 2) Only use the lawn mower for the purpose for which it was made, that is, the cutting and collection of grass. Any other use can be dangerous and result in damage to the machine.
- 3) Never allow children or people unfamiliar with these instructions to use the lawn mower. Local regulations may restrict the age of the operator.
- 4) Never use the lawnmower,
  - When people, especially children, or pets are nearby;
  - If the operator has taken medicine or substances that can affect his ability to react and concentrate.
- 5) Keep in mind that the operator or user is responsible for accidents or hazards occurring to other people or their property.

### B) PREPARATION

- 1) While mowing, always wear substantial footwear and long trousers. Do not operate the equipment, when barefoot or wearing open sandals.

- 2) Thoroughly inspect the area where the equipment is to be used and remove all objects which may be thrown by the machine (stones, sticks, metal wire, Bones, etc.).
- 3) Before using, always carry out a visual inspection, particularly of the blade, seeing that the screws and cutter assembly are not worn or damaged. Replace worn or damaged blades and screws in sets to preserve balance.
- 4) Before mowing, attach the discharge opening guards (grass catcher or deflector).



5) WARNING: DANGER! Damp and electricity do not go together

- the handling and connection of cables must be done in the dry
- use a 30 mA residual current device (RCD)
- never allow contact between an electric socket or cable with a wet area (puddles or damp grass);
- Connections between cables and sockets must be of the waterproof type. Only use extension cables with moulded-on waterproof or approved sockets available commercially.

- 6) The power supply cables must not be of lower quality than the H05RN-F, H05RR-F, H05WF, H05VH2-F type for outdoor use and with minimum cross-section size of 1.5 sq. mm.
- 7) Clamp the cable onto the cable-hook before starting the equipment.
- 8) The permanent connection of any electrical device to a building is circuit must be performed by a qualified electrician, in accordance with electrical regulations in force. An incorrect connection may cause severe injury or death.

### C) OPERATION

- 1) Mow only in daylight or good artificial light.
- 2) Avoid operating the equipment in wet grass or when raining
- 3) Never go over the electric cable with the lawnmower. While cutting, the cable should always be pulled behind the lawnmower and always from the area of grass already cut. Use the cable hook in the way already described. In this manual to avoid the cable's unexpected disconnection. Ensure that it is properly inserted

and avoid forcing into the power socket.

- 4) Never pull the lawnmower by its power cable or pull the cable to remove the plug. Do not expose the cable to sources of heat or let it come in contact with oil, solvents or sharp objects.
- 5) Always be sure of your footing on slopes.
- 6) Walk, never run and do not allow yourself to be pulled along by the lawnmower.
- 7) Mow across the face of slopes, never up and down.
- 8) Exercise extreme caution when changing direction on slopes
- 9) Do not mow on slopes of more than 20°.
- 10) Exercise extreme caution when pulling the lawnmower towards you.
- 11) Stop the blade if the lawnmower has to be tilted for transportation when crossing surfaces other than grass, and when transporting the lawnmower to and from the area to be mowed
- 12) Never operate the lawnmower with defective guards, or without safety devices, for example deflectors and/or grass catchers, in place.
- 13) On those models with drive traction, disengage the drive clutch before starting the motor.
- 14) Start the motor or switch on the motor carefully according to instructions and with feet well away from the blade.
- 15) Do not tilt the lawnmower when starting the motor or switching on the motor. Start the motor or motor on a flat surface that is free of obstacles and tall grass.
- 16) Do not put hands or feet near or under rotating parts. Keep clear of the discharge opening at all times
- 17) Never pick up or carry a lawnmower while the motor is running.
- 18) Stop the motor and disconnect the power supply cable
  - before carrying out any work beneath the cutting deck or unclogging the chute!
  - before checking " cleaning or working on Lawnmower!
  - After striking a foreign object, inspect the lawnmower for damage and make repairs before restarting and operating the lawnmower!
  - if the lawnmower starts to vibrate abnormally immediately check and remove the cause of the

vibration!

- Whenever you leave the lawnmower unattended.
  - When transporting the equipment.
- 19) Stop the motor
    - Every time the grass catcher is removed or replaced.
    - Before regulating the grass cutting height.
  - 20) When mowing" always keep to a safe distance from the rotating blade. This distance is the length of the handle.

### D) MAINTENANCE AND STORAGE

- 1) Keep all nuts" bolts and screws tight to be sure the equipment is in safe working condition. Regular maintenance is essential for safety and for maintaining performance levels.
- 2) To reduce the fire hazard" keep the lawnmower, and particularly the motor, free of grass, leaves, or excessive grease. Do not leave garden rubbish contained within a room.
- 3) Check the deflector and grass catcher frequently for wear and deterioration
- 4) Periodically check the electric cables and replace them if they are damaged or the insulation has been damaged. Never touch a badly insulated cable if it still connected to the power supply. Remove the cable from the socket before taking any action
- 5) Wear strong work gloves when removing and reassembling the blade.
- 6) Check the blade's balance after sharpening.
- 7) For reasons of safety, do not use the equipment with worn cables or damaged parts. Parts are to be replaced and not repaired. Use genuine spare parts (blades should always bear the symbol). Parts which are not of an equivalent quality can damage the equipment and be dangerous for your safety.

## 3. ASSEMBLY

- Attach the stone-deflector by inserting the pin (Fig3.01-pos.1) and the spring (2) as shown. First, insert the pin into the right hand housing (Fig3.01-pos.4). Next insert the eyelet end (3) of the spring into the central slot, and lastly insert the other end into the position (5).
- Insert the lower part right (Fig 3.02-pos.1) and left

(Fig3.02-pos.2) of the handle into the respective holes and lock into position with the supplied screws (Fig3.02-pos3).

Attach the upper part of the handle (Fig 3.02-Pos.4) to the lower part using the knobs (5) and the supplied nuts and bolts as shown.

Attach the cable-clamp (6) to the position shown and then attach the cable (7).

The correct position of the electric cable hook (8) is as shown.

- When using a rigid grass catcher" assemble the two parts (Fig 3.03-pos.1) and (2)" making sure that the hooks are fully clicked into position.
- Attach the wheels" selecting the hole for the preferred cutting height(Fig 3.04)

#### 4. DESCRIPTION OF CONTROLS

The motor is controlled by a dual action switch to prevent starting it accidentally.

To start, press the button (Fig.4.01-pos.2) and pull the lever (1). The motor automatically stops on releasing the lever (Fig.4.01 -pos. 1).

**WARNING:** Blade continues to rotate after machine is switched off.

The cutting height is adjusted by attaching the wheels to the required hole(Fig.4.02). All the wheels must be at the same height. **MAKE THIS ADJUSTMENT ONLY WHEN THE BLADE IS STOPPED.**

#### 5. GRASS CUTTING

Lift the stone-deflector and correctly attach the rigid grass catcher (Fig.5.01 -pos. 1 ).

Start the motor by pressing the safety push-button (Fig.5.02-pos.2) and pulling the lever (1) of the switchgear. If it is necessary to tilt the machine to encourage the motor to start on grass, it should only be tilted from the front.

While cutting, ensure that the electric cable is always behind you and on the area of grass already cut (Fig.5.03).

The lawn's appearance will be improved if it is always cut to the same height and is cut in alternate directions. Once cutting is finished, release the lever (Fig.5.04- pos. 1). **FIRST** disconnect the cable extension from the supply socket (2) and **THEN** from the side of the lawnmower's switchgear (3).

Wait for the blade to stop before carrying out any type of work on the lawnmower.



#### IMPORTANT NOTE

Should the motor stop during use through overheating, wait about 5 minutes before re-starting.

#### 6. ROUTINE MAINTENANCE

After work has been carried out on the blade, reassemble as shown in the drawing, tightening the central screw (Fig.6.01 -pos. 1) to 16-18 Nm (1.6-1.8 kgm).

Do not use forced water and avoid wetting the motor or the electrical components (Fig.6.02).

Do not use harsh products for cleaning the chassis.

Oil the wheel pins (Fig.6.03).

Store the lawnmower in a dry place.

Should you have any doubts or problems, do not hesitate to contact the nearest Service Centre or your Sales outlet.

## Installation and Use Instructions

### 1. Machine Accessories Display

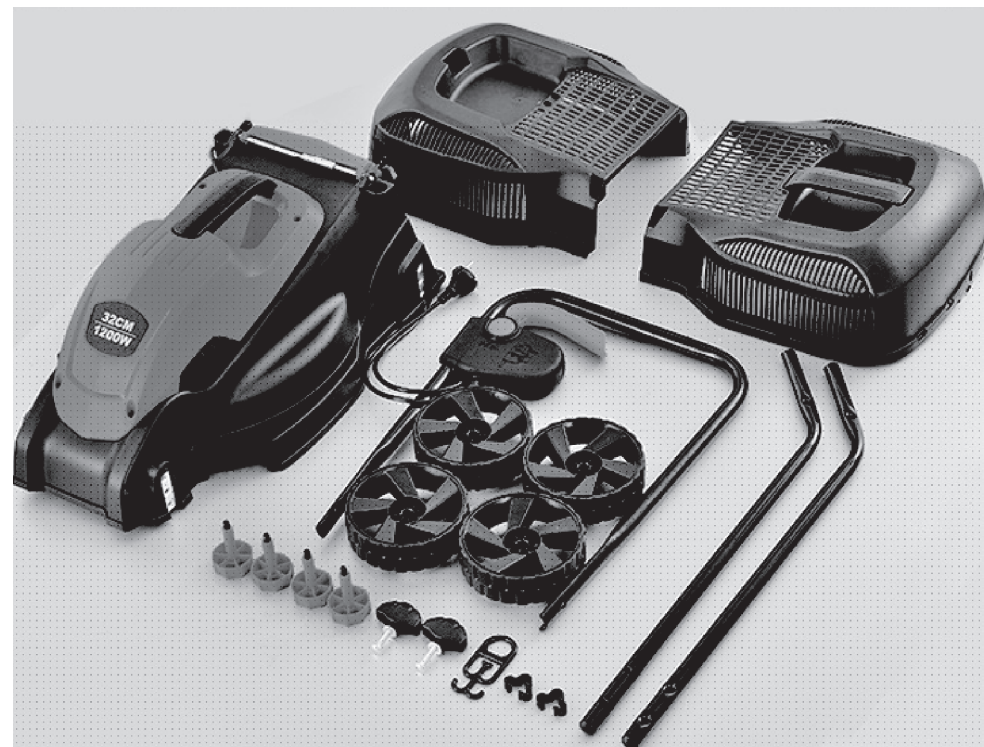

## 2. Machine Installation



(1) Unscrew the lower handrail screw.



(2) Insert the lower handrail into the fixing hole of the mower and tighten the screw.

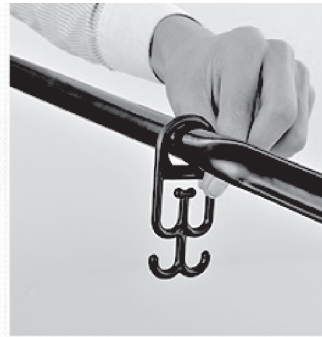

(3) Put the hook into the upper handrail.



(4) Fix the upper and lower handrail bars with fan screws.



(5) Fix the power cord of machine body with the triangle clamp.



(6) Fix the tire with the wheel shaft screw (only 1200W lawn mower needs to be installed).

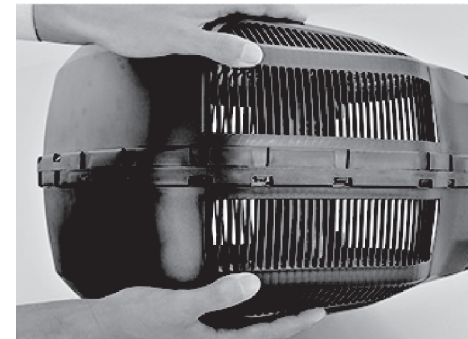

(7) Cover the upper and lower lids of the grass basket.



(8) Turn over the grass basket cover board and install the grass basket.

## 3. Startup Steps



(1) Press and hold the round power button.



(2) Hold the start switch at the same time.



(3) Release the power button after startup.



#### 4. Mowing Height Adjustment



1200W lawn mower adjusts the three-level height of mowing by wheel mounting.



1600W lawn mower adjusts the three-level height of mowing by moving the wheel axle.

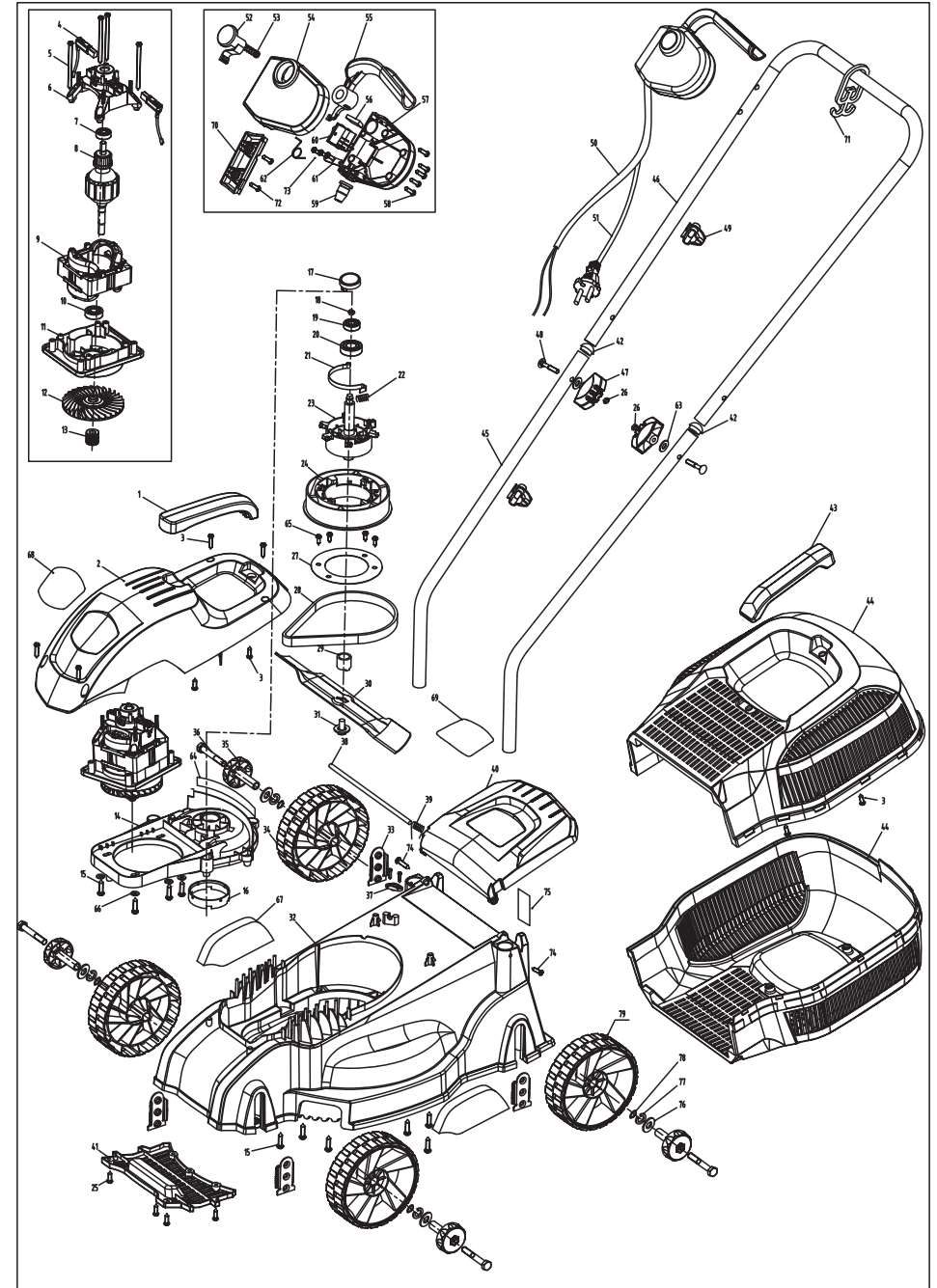



## SPARE PART SET

1	Carrying handle	1	40	Grass box cover	1
2	Top Cover	1	41	Weight adding box cover	1
3	Cross head Tapping screw	8	42	Pipe plug	2
4	Brush set	2	43	Grass box handle	1
5	Cross head Tapping screw	4	44	Grass box	2
6	Motor end cap	1	45	Lower push handle	2
7	Deep groove ball bearing	1	46	Upper push handle	1
8	Armature	1	47	Handle knob	2
9	Stator	1	48	Square nick screw	2
10	Deep groove ball bearing	1	49	Cable clip	2
11	Motor front cap	1	50	Cable	1
12	Fan	1	51	Plug	1
13	Belt roller	1	52	switch safety button	1
14	Motor holder	1	53	switch box spring	1
15	Cross head Tapping screw	10	54	switch front cover	1
16	brake hoop	1	55	switch trigger	1
17	bearing cover	1	56	capacitor	1
18	nut	1	57	switch rear cover	1
19	Deep groove ball bearing	1	58	Cross head Tapping screw	5
20	Deep groove ball bearing	1	59	Cord guard	1
21	Brake steel belt	1	60	switch	1
22	Brake spring	1	61	Cable clamp	1
23	Brake core	1	62	spring	1
24	big belt wheel	1	63	Washer	2
25	Cross head Tapping screw	6	64		1
26		2	65	Cross head Tapping screw	4
27	Belt wheel cover	1	66	Washer	4
28	Belt	1	67	sponge	2
29	Blade washer	1	68	logo label	1
30	Blade	1	69	warning label	1
31	Blade bolt with flange	1	70		1
32	Base	1	71	cable hook	1
33	Wheel height adjust plate	4	72	Cross head Tapping screw	2
34	Wheel	4	73	Cross head Tapping screw	3
35	Wheel Bolt	4	74	Tapping screw	2
36	Hexagon screw	4	75	nameplate	1
37	Strain relief	1	76	Washer	4
38	Grass box rotation shaft	1	77	Spring Washer	4
39	Grass box spring	1	78	Circlip	4

## Welcome to visit our website and purchase our quality products!

Your suggestions and comments for COSTWAY are really important to us!

We sincerely solicit you to go back to our shop and leave a good rating in just a simple click. It would be quite encouraging if you could kindly do so like below:

★★★★★ Great products so far

February 24, 2019

Great products so far. Fast delivery, easy setup, and working without any issues.

With your inspiring rating, COSTWAY will be more consistent to offer you EASY SHOPPING EXPERIENCE, GOOD PRODUCTS and EFFICIENT SERVICE!

US office: Fontana, California

UK office: Ipswich



- \* Reward Points
- \* Exclusive Customer Service
- \* Personalized Recommendations
- \* Permanent Shopping Cart
- \* Order History

## 5 Star Rating



We would like to extend our heartfelt thanks to all of our customers for taking time to assemble this product and giving us valuable feedbacks.

THANK  
you  
😊