

## **USER'S MANUAL**

### **Kids Ride On Car TQ10038**

THIS INSTRUCTION BOOKLET CONTAINS **IMPORTANT** SAFETY INFORMATION. PLEASE READ AND KEEP FOR FUTURE REFERENCE.

**Please give us a chance to make it right and do better!**

Contact our friendly customer service department for help first.

Replacements for missing or damaged parts will be shipped ASAP!

**Follow Costway**



# Contact Us!

## Do NOT return this item.

Contact our friendly customer service department for help first.



# Before You Start

Please read all instructions carefully and keep it for future reference.

### Warnings:

Attention! Use it with protective equipment.

Attention! Not use it in the traffic.

Attention! The product is not suitable for the children under 3 years.

### General Warnings:

- ⚠ The product must be installed and used under the supervision of an adult.
- ⚠ Read through each step carefully and follow the proper order.
- ⚠ Remove all packaging, separate and count all parts and hardware.
- ⚠ Please ensure that all parts are correctly installed, incorrect installation can lead to a danger.
- ⚠ We recommend that, where possible, all items are assembled near to the area in which they will be placed in use, to avoid moving the product unnecessarily once assembled.
- ⚠ Ensure a secure surface during construction, and place the product always on a flat, steady and stable surface.
- ⚠ Please use the product carefully, as the product requires great skill, avoid accidents by the user or others, by fall or collision.
- ⚠ Please wear suitable protective equipment during use, e.g. protective helmet, gloves, knee pads, elbow pads etc.

# PLEASE READ THE INSTRUCTIONS

**Styles and colors may vary**

◎ Suitable age for 37-96 months

◎ Maximum user weight: 66 lbs

◎ Adult assembly required



Charge for 4-6 hrs  
before initial use.

After initial charge,  
follow the normal  
recommended  
Charging time.



**SAFETY**

Please retain these instructions for future reference.

**NOTE:**For best performance,only use this vehicle on flat and hard surfaces.

**AGE RANGE:** 37-96 months

**WEIGHT CAPACITY:**66lbs is the maximum weight for 1 rider(combined)

The following safety hazards may result in serious injury or death:

- This product contains small parts.Keep children away during assembly.Make sure to remove all packaging material and parts from underneath the vehicle body.
- Never open the battery.Batteries contain lead and lead compounds(acids).
- Limbs,hair,and clothing can get caught in moving parts.Always wear shoes,keep limbs away from moving parts,and do not wear loose clothing while operating this vehicle.
- This vehicle does not have brakes or braking capability.Do not leave a child unattended during operation.DO not use this car in a location that may require braking capability as this could result in loss of control,which may cause serious injury or death.
- Use of this vehicle near streets,motor vehicles,steps,bodies of water,sloped surfaces,hills,wet areas,flammable vapors,in alleys,at night,or in the dark could result in an unexpected accident.
- Use of this vehicle in unsafe conditions such as snow,rain,loose dirt,mud,sand,or gravel may result in an unexpected accident such as tipping over,and could damage the electrical system or battery.
- Do not operate this vehicle in an unsafe manner.Examples include but are not limited to:
  - Pulling the vehicle with another vehicle or similar device
  - Allowing more than one child to ride
  - Pushing the user
  - Traveling at an unsafe speed

**BATTERY WARNINGS**

The following safety hazards may result in serious injury or death:

- Use of a battery or charger other than the supplied rechargeable battery and charger may cause a fire or explosion. Only use the supplied battery and charger.
- Use of the rechargeable battery and charger for any other product may result in overheating, fire, or explosion. Never use the supplied rechargeable battery and charger with another product.
- Explosive gases are created during charging. Charge the battery in a well-ventilated area. Do not charge the battery near heat or flammable materials.
- Contact between the positive and negative terminals may result in fire or explosion. Avoid direct contact between the terminals. Picking up the battery by the wires or charger can cause damage to the battery and may result in a fire. Always pick up the battery by its case or handles.
- Liquids on the battery may cause fire or electric shock. Always keep all liquids away from the battery and keep the battery dry. Contact or exposure to battery leakage (lead acid) may cause serious injury. If contact or exposure occurs immediately call your physician. If the chemical is on the skin or in the eyes, flush with cool water for 15 minutes. If the chemical was swallowed, immediately give the person water or milk. Do not give water or milk if the patient is vomiting or has a decreased level of alertness. Do not induce vomiting.
- Battery posts, terminals, and related accessories contain lead and lead compounds (acid).
- Tampering or modifying the electric circuit system may cause a shock, fire or explosion and permanently damage the system. Exposed wiring and circuitry in the charger may cause electric shock. Always keep the charger housing closed.

**USER WARNINGS**

The following safety hazards may result in serious injury or death:

- Never leave a child unattended.
- Always sit in the seat when using this vehicle.
- Keep your hands, hair, and clothes away from moving part.
- Always wear shoes when operating this vehicle.
- Maximum of two children are allowed in the vehicle at a time.
- Children under 3 years of age cannot use the vehicle.
- Only drive on level ground.
- Do not go near swimming pools or other bodies of water, drop-offs, or up and down steep inclines.
- Do not drive the vehicle into loose dirt, mud, sand, fine gravel, or on wet surfaces.
- Do not drive the vehicle on streets or near cars.

**SPECIFICATIONS**

Item	Specification
Batteries	12V
Motor	12V
Age	37-96 months
Max Weight	66 lbs
Dimension	40.5" x 24.5" x 17.5"
Speed	2-3Mph(12V)
Play Time	1-2 hours /charging time 8-12hours
Charger	Output DC 12V (Dual drive)

**TOOLS REQUIRED**

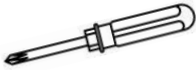

SCREWDRIVER  
(BRING YOUR OWN)



NEEDLE NOSE PLIERS  
(NOT INCLUDED)



2 PERSON  
ASSEMBLY



APPROXIMATELY  
45 MIN.  
ASSEMBLY

**HARDWARE**

1

M4\*10mm  
SCREW



2 PCS

2

φ 10 WASHER



6 PCS

3

COTTER PIN



4 PCS

**PARTS**

A

WHEELS

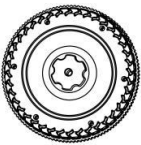

4 PCS

B

WINDSHIELD



1 PC

C

WHEEL COVER

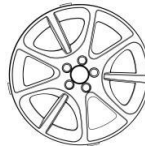

4 PCS

D

MIRROR (L/R)



1 PAIR

E

SEAT



1 PC

F

STEERING WHEEL



1 PC

G

REMOTE CONTROL



1 PC

H

CHARGERS



1 PC

## PRODUCT ASSEMBLY (DUAL DRIVE)

Put the gasket, wheels, gasket and cotter pin into the front axle in turn.  
Insert the cotter pin into the hole of iron piece and bend it to fix it and then attach the wheel cover to the wheel.

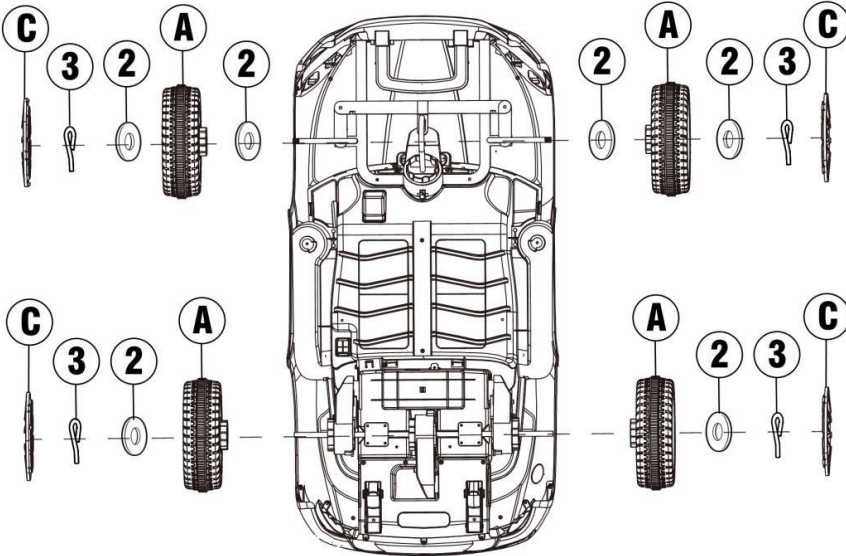

Place the wheels, washer, and cotter pin on the rear axle in turn.  
Insert the cotter pin into the hole of iron piece and bend it to fix it and then attach the wheel cover to the wheel.

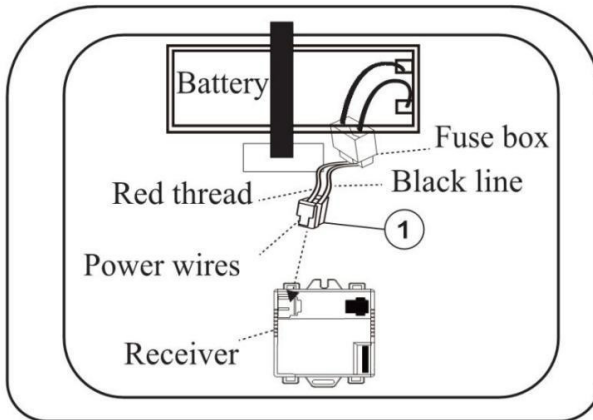

Put the vehicle upside down

1. Find the main power cord under the seat and insert the plug of the power cord into the corresponding jack of the receiver

**PRODUCT ASSEMBLY**

Follow the assembly steps in the order listed below.

**F** Attach the steering wheel.

- Remove the nut and bolt from the steering wheel.
- Connect the wires coming from the steering column to the wires on the steering wheel.
- Insert the steering wheel over the steering column and secure with nut and bolt.

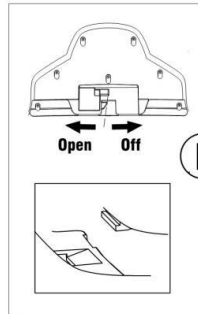

**E** Fix the seat

- Stuck the seat buckle into the vehicle slot
- Press the seat switch to fix the seat.

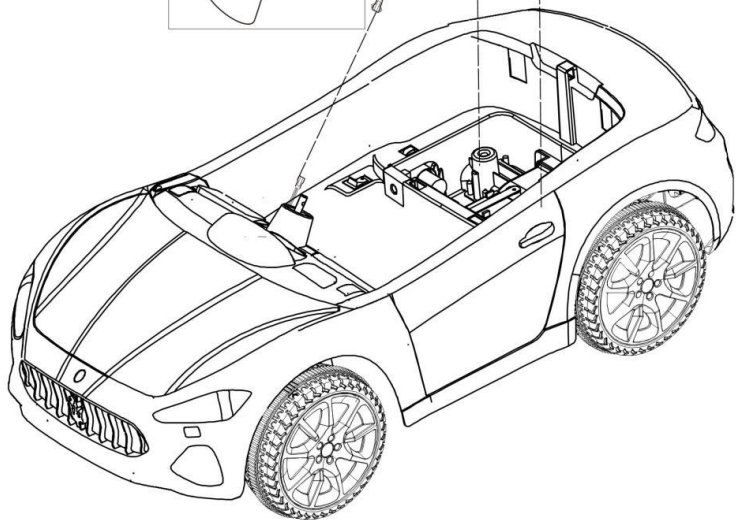
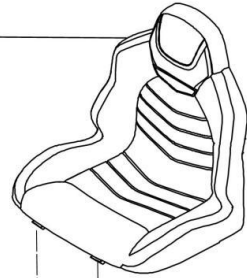
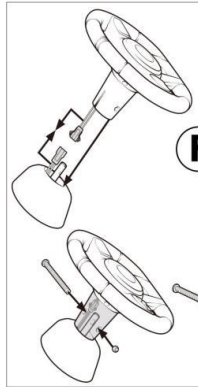

**PRODUCT ASSEMBLY**

- D** Stuck the mirror into the windshield and fix it with M4\*10 screws;
- B** Stuck the windshield into the corresponding slot on the body

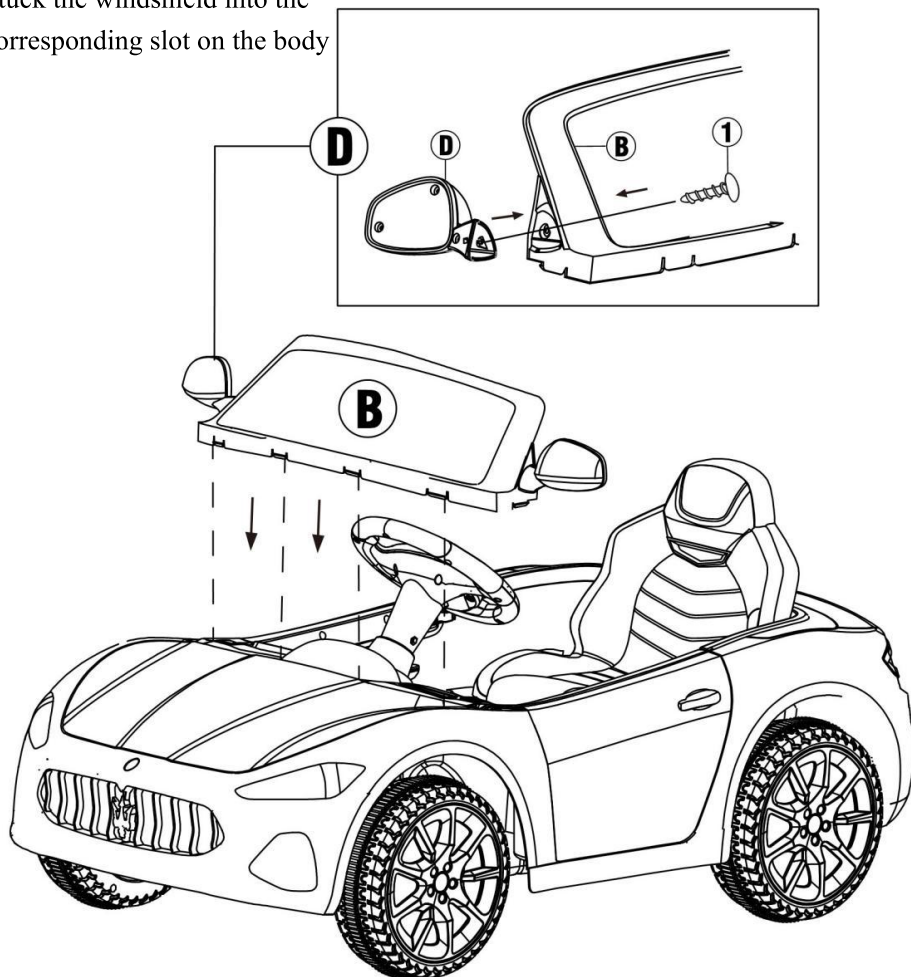

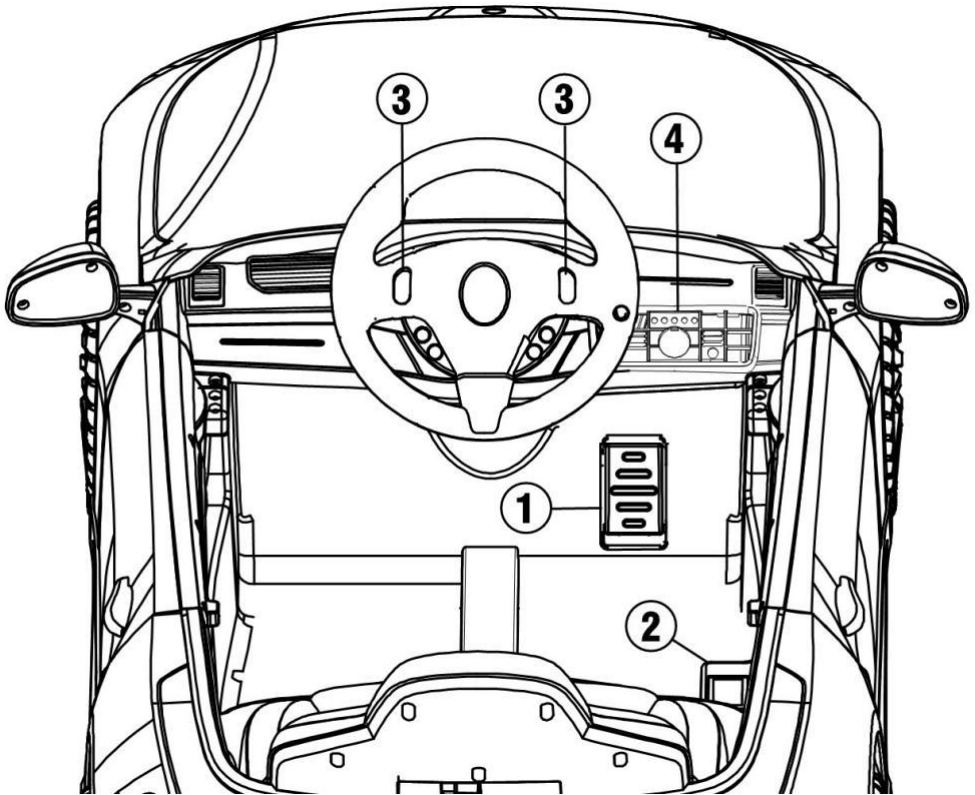
**DASHBOARD DIAGRAM**

1. Pedal button: Step on the button , the car will move and when release, the car will slowly stop
2. Shift switch: Change the direction of the car , Forward-Backward
3. Horn button: Press to play the horn
4. Control board:

## DASHBOARD DIAGRAM

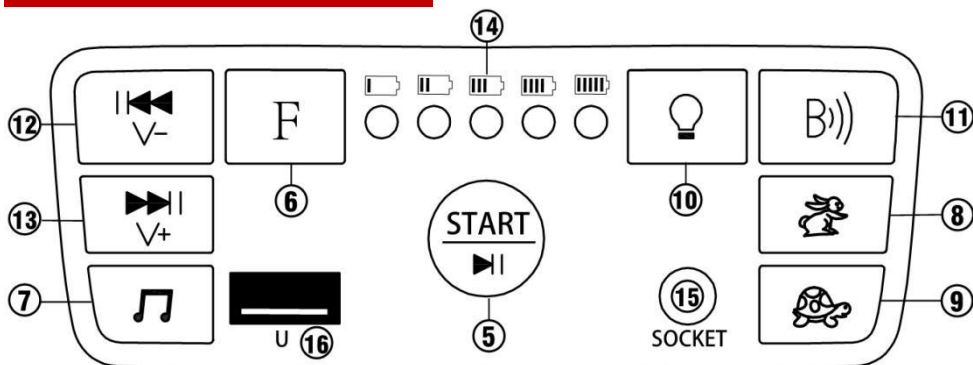

5. Power Button: Long press it for 3 seconds, turn the vehicle on and off;
6. F: Radio, long press it for 2-3 seconds, start search automaticall ;
7. Music Button: Play music;
8. High speed Button: change the speed the car more quickly;
9. Slow speed Button: change the speed of the car more slowly;
10. Light button: press it to switch the light;
11. Wireless Technology: After connecting your mobile phone and the wireless device ,the car can play music from your mobile phone;
12. Last song: Switch songs, and long press will decrease volume;
13. Next song: Switch songs, and long press will increase volume;
14. Power Display: Clearly see the battery power, in order to charge in time.
15. Socket : Charge;
16. USB port;

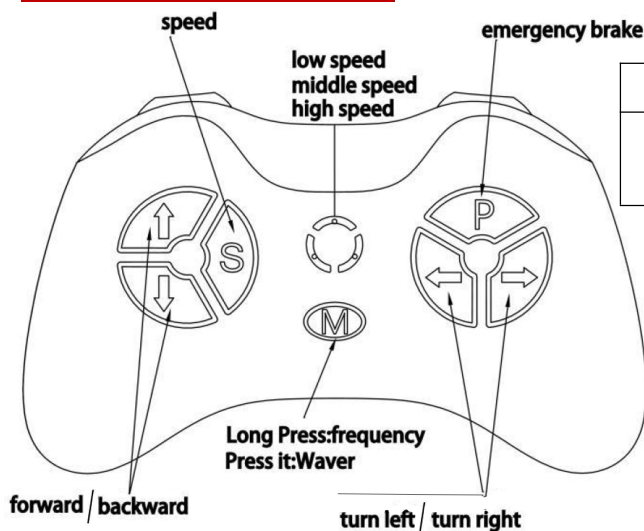
**REMOTE CONTROL DIAGRAM**

**Warning**

Only used by adults

**Remote control first. When the remote control is on, foot pedal will not work.**

**Operation Manual:**

Take out the remote control, open the battery compartment on the back of the remote control and add two AAA LRO3 alkaline batteries. Pay attention to the polarity of the batteries. When the alignment light and speed indicator light up, it indicates that the battery is installed correctly. This product does not provide dry batteries.

**<Button Description >**

(1) Long press on the frequency key(M) 2-4 seconds, Low speed LED light flashing. Turn on the power of the car, **if the low-speed LED light keeps flashing until it stays on, then the frequency binding is successful.** If the frequency binding failed (Low speed LED light flashing), remove the battery and repeat steps above.

P: Press to brake

S: Speed: press to change speed(low,middle and high speed).

△Forward ▽backward

◁ Turn left ▷ turn right

- 2) Brake button: Press it to stop moving; press it again to move.
- 3) Speed selection key and speed indication: used to select speed of the car. Press the key once to switch the speed once. 3 speeds are cyclically switched, and the switching sequence is: low-medium-high. The speed indicator is arranged from top to bottom on the remote control: high-speed lamp, medium-speed lamp, low-speed lamp; when switching to one speed, the corresponding indicator lamp will light up. Note: The speed grade changes only when moving forward
- 4) Forward/backward keys: used for forward and backward movement control. When one of the keys is pressed, the moving speed will slowly increase to reach the set speed level. Therefore, children will not have a sudden impact.
- 5) Left turn/right turn key: used for left and right direction control.

**Note: If there is no operation after 10 seconds, the indicator light will go out and enter the power saving mode.**

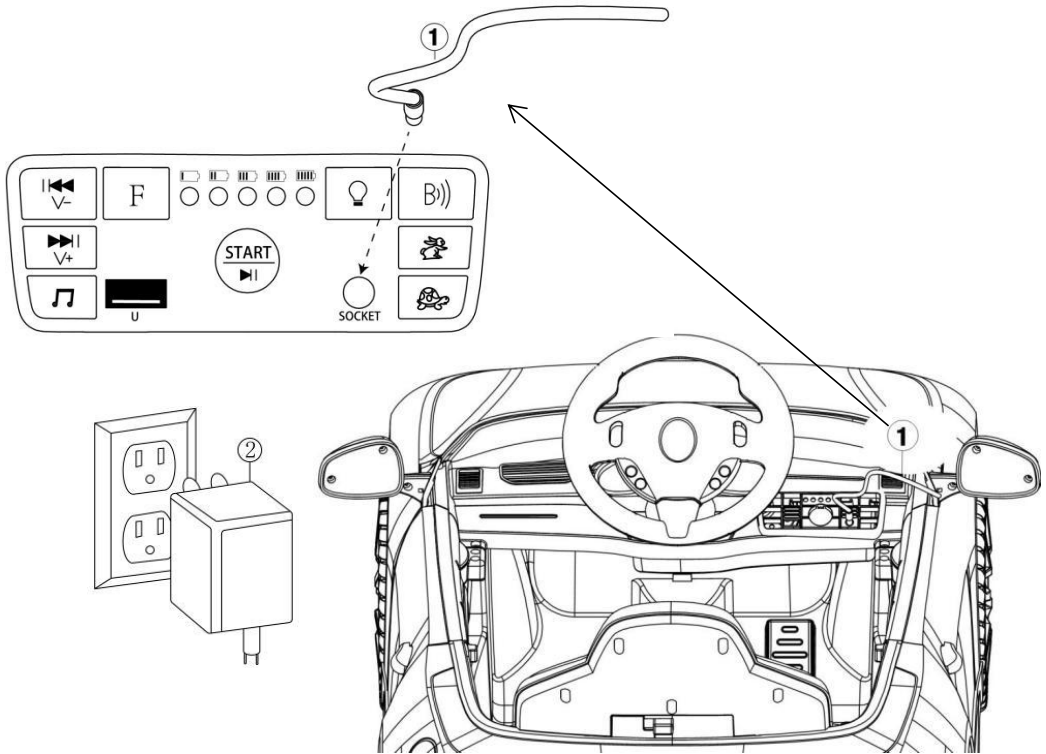
**CHARGING INSTRUCTIONS**

1.Insert the charger jack into the charging hole of the car.

2.Plug the charger plug into the stable matching AC power supply as shown in the picture.

- Charge the battery 15 to 18 hours before initial use.
- On average,you will need to charge the battery between 8 and 12 hours.Do not charge the battery for more than 20 hours.Failure to charge the battery as directed could cause permanent damage to the battery and void the warranty
- Damage to the battery may occur if it is allowed to drain completely.Do not allow the battery to drain completely.
- Check the battery and charger (supply cord,connector) for wear and damage before charging.DO not charge the battery if damage has occurred.
- Only an adult who has read and understood the safety warnings should handle,charge and recharge the battery.

**CARING FOR YOUR RIDE-ON**

- Park the vehicle indoors or cover it with a tarp to protect it from wet weather.
- Do not leave the vehicle in the sun for long periods of time or fading may occur.  
Store in shade or cover with tarp.
- Do not wash the vehicle with a hose.
- Do not wash the vehicle with soap.
- Charge battery at least once a month to prolong the life of the battery.

**TROUBLESHOOTING**

PROBLEM	REASON	SOLUTION
Vehicle does not move	Low battery	Fully charge the battery
	Electrical protection	Stop use for several minutes and restart
	Switch not in the correct position	Completely press in switches
	Battery connectors disconnected	Plug in battery connectors
Battery does not recharge	Battery connectors disconnected	Plug in battery connectors
	Charger not connected to socket or outlet	Completely plug in the charger
Battery does not last	Battery does not have a full charge	Fully charge the battery
Battery is warm and makes a slight noise while charging	Normal	Normal
Slow speed	Low battery	Fully charge the battery
	Overloaded vehicle	Reduce the weight on the vehicle
	Uneven or sloped road	Drive on flat pavement
Vehicles shakes while driving	Loose connection to motor	Ensure the motor is properly connected to the battery
Difficulty shifting between forward/reverse	Attempting to shift while vehicle in motion	Only shift when the vehicle is at a stop
Forward and reverse switch is flipped	Gear boxes are installed incorrectly	Make sure the L gear box is on the left and R gear box is on the right

**WARNINGS REGARDING BATTERIES**

The battery on the vehicle is not replaceable.

- DO not mix old and new batteries.  
DO not mix alkaline, standard (carbon-zinc), or rechargeable batteries.
- Non-rechargeable batteries should not be charged.
- Rechargeable batteries should be charged under adult supervision only.
- Exhausted batteries should be removed.
- The supply terminals should not be short-circuited.
- Do not put batteries next to or in a heat source (fire, electronic heating device, etc.)
- Do not hit batteries against hard objects.
- Do not submerge batteries in water.
- Batteries should be inserted with the correct polarity.

**WARNING:**

- Protective equipment should be worn. Not to be used in traffic.
- The toy should be used with caution since skill is required to avoid falls or collisions causing injury to the user or third parties.
- To reduce the risk of injury, adult supervision is required. Never use in roadways, near motor vehicles, on or near steep inclines or steps, swimming pools or other bodies of water; always wear shoes, and never allow more than one rider.

**IMPORTANT**

- Always charge battery for a FULL 18hrs the first time you use it.
- Always charge battery for a FULL 10hrs after each use.
- Charge the battery once a month even if you are not using your vehicle.



**WARNING:** CHOKING HAZARD-Small parts.  
Not for children under 3yrs.

To reduce the risk of injury, adult supervision is required. Never use in roadways, near motor vehicles, on or near steep inclines or steps, swimming pools or other bodies of water; always wear shoes, and never allow more than one rider



**WARNING:** ADULT ASSEMBLY REQUIRED



**WARNING:** Not to be used in traffic

**FCC Statement****Caution:**

This device complies with Part 15 of the FCC Rules. Operation is subject to the following two conditions: (1) this device may not cause harmful interference. (2) this device must accept any interference received, including interference that may cause undesired operation.

Changes or modifications not expressly approved by the party responsible for compliance could void the user's authority to operate the equipment.

This equipment has been tested and found to comply with the limits for a Class B digital device, pursuant to part 15 of the FCC Rules. These limits are designed to provide reasonable protection against harmful interference in a residential installation. This equipment generates uses and can radiate radio frequency energy and, if not installed and used in accordance with the instructions, may cause harmful interference to radio communications. However, there is no guarantee that interference will not occur in a particular installation. If this equipment does cause harmful interference to radio or television reception, which can be determined by turning the equipment off and on, the user is encouraged to try to correct the interference by one or more of the following measures:

- Reorient or relocate the receiving antenna.
- Increase the separation between the equipment and receiver.
- Connect the equipment into an outlet on a circuit different from that to which the receiver is connected.
- Consult the dealer or an experienced radio/TV technician for help.

**Welcome to visit our website and purchase our quality products!**

With your inspiring rating, COSTWAY will be more consistent to offer you  
**EASY SHOPPING EXPERIENCE, GOOD PRODUCTS and EFFICIENT SERVICE!**

US office: Fontana, California

UK office: Ipswich



- \* Reward Points
- \* Exclusive Customer Service
- \* Personalized Recommendations
- \* Permanent Shopping Cart
- \* Order History

*5 Star Rating*



We would like to extend our heartfelt thanks to  
all of our customers for taking time to assemble  
this product and giving us valuable feedbacks.

THANK  
YOU  
😊

