



COSTWAY®

Please give us a chance to make it right and do better !

Contact our friendly customer service department for help first.
Replacements for missing or damaged parts will be shipped ASAP !

US office: Fontana **UK** office: Ipswich **AU** office: Truganina
DE office: Hamburg **FR** office: Saint Vigor d'Ymonville **PL** office: Gdańsk



Contact Us!

Do NOT return this item.

Contact our friendly customer service department for help first.



US:cs.us@costway.com
UK:cs.uk@costway.com
AU:cs.au@costway.com

USER'S MANUAL

Home Dehumidifier ES10104US

THIS INSTRUCTION BOOKLET CONTAINS **IMPORTANT** SAFETY INFORMATION. PLEASE READ AND KEEP FOR FUTURE REFERENCE.



Before You Start

- ⚠ Please read all instructions carefully.
- ⚠ Retain instructions for future reference.
- ⚠ Separate and count all parts and hardware.
- ⚠ Read through each step carefully and follow the proper order.
- ⚠ We recommend that, where possible, all items are assembled near to the area in which they will be placed in use, to avoid moving the product unnecessarily once assembled.
- ⚠ Always place the product on a flat, steady and stable surface.
- ⚠ Keep all small parts and packaging materials for this product away from babies and children as they potentially pose a serious choking hazard.

1. BEFORE YOU BEGIN

1.1 PRODUCT DESCRIPTION

The dehumidifier is used to remove excessive moisture from the air. The resulting reduction in relative humidity protects buildings and their contents from the adverse effects of excess humidity.

2. FOR YOUR SAFETY

2.1 GENERAL PRECAUTION

Your safety is the most important thing we are concerned about!

Turn off the dehumidifier when cleaning.



Turn off the dehumidifier when cleaning.

Do not operate with wet hands.

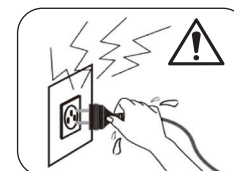

Do not operate with wet hands.

Do not unplug while the unit is operating.



Do not unplug while the unit is operating.

Always use a power outlet that is grounded.

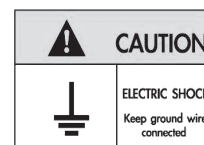

Do not use an extension cord or an adapter plug.

Keep the air inlet and outlet free of obstacles.



Do not tilt or turn over the unit.

Do not put objects on the unit



Do not climb or sit on the product.

Take care to ensure that children do not play with the unit.



Do not insert fingers or other objects into the air outlet.

Ensure the unit is far away from fire, inflammable, or explosive objects.

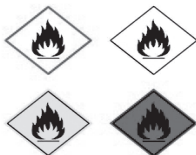

Do not store in dusty place, or expose under corrosive environment.

Service or repair should be performed by a qualified technician.



Replace the assembly with the manufacturer approved replacement parts.

3. WHERE TO USE

3.1 Installation



1. Place the unit on a firm, level surface in an area with at least 7.8"(20cm) of free space around it allowing for proper air circulation.

2. Operate this unit at an ambient temperature from 41°F to 95°F (5°C to 35°C).



3. Keep doors and windows close for better energy saving.

4. Do not operate in close proximity to walls, curtains, or other objects that may block inlet and outlet.



5. Do not operate the unit beneath furniture or where the air flow is restricted.

6. Do not operate or store the unit in direct sunlight or rain.

4. QUICK START GUIDE

Making dry and comfortable

Smartly senses room humidity and maintains your ideal levels.



To dry clothes quickly

Continuous dehumidifying to speed the drying process.

Sleep well into the night

Silence dehumidifying and dims the lights when you sleep.

1. Unpacking the appliance and checking for any damage or scratches on the machine.
2. If tipped more than 45°, allow the unit to set upright for at least 2 hours before starting up.
3. Check if the bucket is empty and re-install correctly before plugging in the dehumidifier. Be sure the bucket full indicator does not light up.
4. Press POWER to turn on the dehumidifier.
5. Press MODE repeatedly to choose Auto Sunny (60%RH), Auto Rainy (40%RH), or Continuous Drying.

6.  Press SLEEP for silent operating with dim light before going to bed.
7.  Press TIMER repeatedly to set a 1-hour to 24-hour delay OFF before you go out.
8.  Press POWER again to turn the unit off.

For more operational instructions, please read the following pages.

5. PRODUCT OVERVIEW

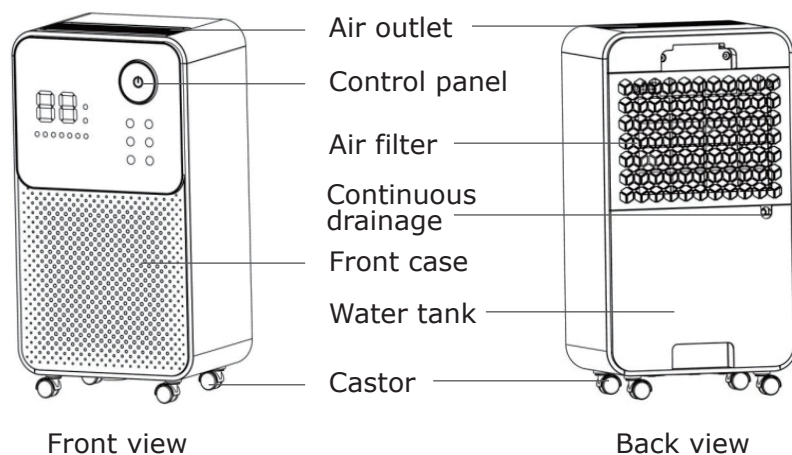

FEATURES

- ✓ Powerful moisture removal (Up to 12L/day dehumidification)
- ✓ Antibacterial Filter
- ✓ Continuous Drainage or 2L Water Tank
- ✓ Laundry Drying Function/ Child Lock / Auto-Defrost
- ✓ Touch Screen / Touch control buttons

- ✓ Humidity Monitor shows current air humidity.
- ✓ Auto mode automatically adjusts humidity levels.
- ✓ Effectively removes moisture, dust, and dust mites from the air.
- ✓ Low power consumption-energy efficiency.
- ✓ A-24 hour timer to set the time of operation.
- ✓ Quiet fan has two speed settings. (Noise: ≤36dB (A))
- ✓ Sleep mode dims the control panel light when you sleep.

6. HOW TO USE

6.1 CONTROL PANEL

Display:

A. The screen will display current relative humidity (%) when the machine is turned on. And display "—" when the machine is off.

B. The screen will display following function:



1. Timer set; 2. Error code;

3. Long press HUM key to display Room temperature (°F/°C);

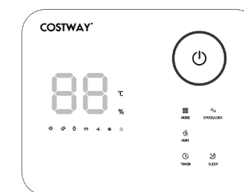









C. The indicators will light up when the corresponding function is turned on.



POWER BREATHING LIGHT

INDICATOR	DESCRIPTION	
 Blue	Steady On:	Humidity levels below 40% relative humidity.
	Flashing Blue:	Defrosting is in progress.
 Green	Steady On:	Above 40% and below 60% relative humidity.
	Flashing Green:	The air purifying function is individually turned on.
 Red	Steady On:	High humidity above 60% relative humidity.
	Flashing Red:	Indicates the water tank is almost full.

6.2 FUNCTION KEYS AND INDICATORS

Power Button		Press to switch the machine on or off.
Mode Button		Press to choose Sunny, Rainy and Continuous Drying mode.
Fan Speed Button/ Safe Lock Button		Press to choose fan speed High and Low. Long press to turn child lock function on or off.
Humidity Button		Adjusts the humidity set-point within the range of 20%-95%.
Timer Button		Sets a time for the unit to automatically start or stop.
Sleep Button		Press to turn sleep mode on or off.
Child Lock Light		Lights up when child lock function is turned on.
Fan Speed Light		Lights up when switch to High or Low speed.
Bucket Full Light		Lights up when water tank is almost full.
Mode Light		Operation functions of Sunny, Rainy, and Continuous drying.
Digital Display		Displays humidity value, Timer setting or Temperature.

6.3 SETTINGS

a. Dehumidification Mode Setting

- ➡ Press POWER key to turn on the unit after plug in.
The dehumidifier starts with sunny mode and air purifying function.
- ➡ Press MODE key repeatedly to switch the mode:
 - Sunny mode: auto dehumidifying with 60%RH, High fan speed.
 - Rainy mode: auto dehumidifying with 40%RH, high fan speed.
 - Continuous mode: continuous dehumidifying

b. Set Sleep Mode:

- ➡ Press SLEEP key to turn on sleep function.
It will operate in silent mode with low fan speed and dims all the lights.
- ➡ Press any button to wake up the indicators.
- ➡ Press SLEEP key again to exit the sleep mode.

c. Set Humidity (setting range: 20%-95%):

- ➡ Press the HUM key to check the humidity set-point under current mode.
- ➡ Press the HUM key repeatedly to adjust humidity set-point.
Set appropriate humidity levels to create a comfortable environment.
Note: The HUM key cannot be set in the continuous mode.

d. Set Fan Speed:

- ➡ Press SPEED key to switch the speed between High speed and Low speed.
Note: The fan speed cannot be set when the indicator is off in sleep mode and defrosting progress.

e. Child Lock Function:

- ➡ The child lock function is designed to prevent children from playing unit.
To active: Long press the SPEED/LOCK key for 5 seconds to disable all the buttons.
To unlock: Press and hold again to cancel the child lock.

f. Overload Protection

➡ In the event of a power loss, to protect the compressor, there is a 3-minute delay until the compressor restarting.

g. Timer Setting (setting range: 1hour-24hours) :

To turn off
(When power on) ➡ Press Timer key to turn on the timer function ➡ Press Timer repeatedly to set the delay OFF time.

To turn on
(When power off) ➡ Press Timer key to turn on the timer function ➡ Press Timer repeatedly to set the delay ON time.

Cancel the timer ➡ Press Timer repeatedly until the screen shows '00'
Note: when press POWER will also exit the timer setting.

h. Water Full Indicator:

The machine automatically shuts off once the water tank is full, alerting the user through an indicator light and buzzing for 15 times. It reminds you to check:

- If the water tank is full, empty and re-install the water tank.
- If the water tank is not in position, the full indicator always on and the unit is inoperative.
- Re-install the tank correctly, and the unit will auto operate as your last setting.

i. Room Temperature Inspection

In addition to the humidity level, the digital display can also indicate the current room temperature. Please check as follows:

➡ Press and hold the TIMER button for 5 seconds.

j. Auto Defrost Function

At low room temperatures, frost may buildup at the evaporator, reducing the airflow across it during dehumidifying.

The unit will automatically start defrosting and the POWER indicator flashing.

When the room temperature is below 64.4°F/18°C or the humidity sensor failures, the compressor stops for 10 minutes during the automatic defrost function and the fan keeps running.

6.4 DRAINAGE

There are two ways of removing collected water produced by the unit.

A. Manual draining: Empty water tank by manual.

B. Continuous draining: Use gravity to drain condensate water by attaching a drain hose.

6.4.1 Emptying the water tank

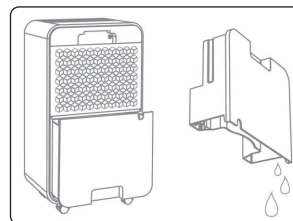

- Unplug the dehumidifier from its power source.
- Pull on the water tank and simply slide out of the body of the dehumidifier.

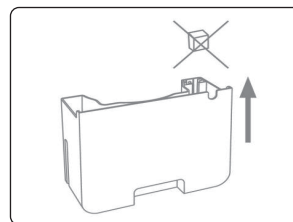

- Do not remove the float out of the tank. Make sure that the float can move freely and that it will actuate the level switch when the tank is full.
- Clean the inside of the tank as well as the outside.

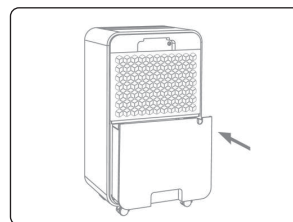

- Allow the tank to air-dry completely and slide it back into place within the dehumidifier.
- After you have replaced the tank, plug the unit back into its power source.

Warning!!!

Use only mild soap, water and soft cloth. Do not use any commercial cleaning solvents.

6.4.2. CONTINUOUS DRAINAGE

Condensate water can automatically flow into a bucket or drain by gravity with a water hose.

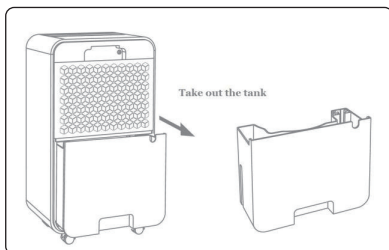

- Set the unit in a horizontal surface and stable position.
- Switch off the unit before operating.
- Gently take out the water tank from the dehumidifier.

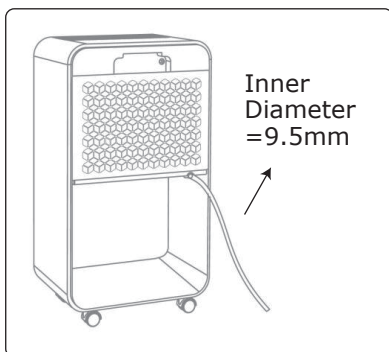

- Securely and properly connect the drain hose and make sure it is not kinked and clear of obstruction.
- Put back the water tank.
- Place the outlet of hose over a drain or bucket and ensure that water could freely flow out of the unit.
- Do not submerge the end of hose into water; otherwise it can cause "Air Lock" in the hose.



To avoid water spillage:

- As the negative pressure of condensate drain pan is large, tilt the drain hose downward toward the floor. It is appropriate that the degree of inclination should exceed 20 degrees.
- Straighten the hose to avoid a trap existing in the hose.

7. CLEANING AND CARE

• CLEANING THE AIR FILTER (every two weeks)

The air filter is removable for easy cleaning. Do not operate the unit without an air filter, or the evaporator may be contaminated. Do not clean the appliance with any chemicals.

Pic1. Switch off the unit and remove air filter.

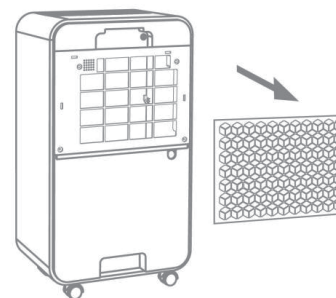

Pic2. Rinse the air filter under running water.

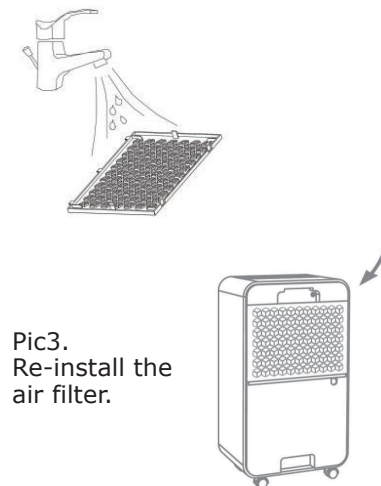

Warning!!!

Do not touch the evaporator surface with bare-hand, or it could cause injury of your fingers.

Pic3. Re-install the air filter.

8. TROUBLESHOOTING

When	Please confirm	Solution
The unit is not operating.	Check the power connection in securely.	Insert the power cord securely into the wall outlet.
	Check if the water level indicator lights up?	Empty the water tank and re-install it correctly.
	Check the room temperature.	The range of operating temperature is 41-95 °F / 5-35 °C.

There is little formation of condensate.	Check the air filter for dirt.		Clean the air filter as necessary.
	Check if the air duct is blocked.		To clear the obstacle.
	Check if the room temperature is below 68°F/20°C.		This is normal. Low humidity in low temperature environment.
	Set humidity level is higher than current humidity value.		Set the humidity level below current humidity value.
Water Leakage	Overflow while moving the unit.		Empty the water tank before transport.
	Check if the drain hose is kinked or bent.		Straighten the hose to avoid a trap existing.
Excessive Noise	Check if the unit is securely positioned.		Place the unit on horizontal and firm ground.
	Check if any loose, vibrating parts.		Secure and tight the parts.
	Noise sounds like water flowing.		Noise comes from flowing refrigerant. This is normal.
Emitting hot	The air outlet is hotter than room temperature a bit.		This is normal. The compressor produces heat that has been removed by the air exhausted.
Error Code	E2	Humidity sensor dampened or failure.	To clean or replace the humidity sensor.
	CL	Display when Room temperature is below 41°F (5°C).	Normal. The compressor stops, and the fan keeps running.
	CH	Display when Room temperature is above 95°F(35°C).	Normal. The compressor stops, and the fan keeps running.
	LO	Display when Room relative humidity is below 20%RH.	Normal. The compressor stops, and the fan keeps running.
	HI	Display when Room relative humidity is above 95%RH.	Normal. The compressor and the fan keep running.

9. STORAGE AND DISPOSAL

9.1 STORAGE

Long-term storage - If you will not be using the unit for an extended period of time (more than a few weeks), it is best to clean the unit and dry it out completely.

Please store the unit per the following steps.

- 1.Unplug the unit.
- 2.Empty the water tank and dry it with a cloth.
- 3.Clean the filter and let the filter dry completely in a shaded area.
- 4.Collect the power cord at the tank and re-install it.
- 5.Re-install the filter at its position.
- 6.Preserving the machine in ventilating, dry, non- corrosive gas and safe place indoor.
- 7.The unit must be kept in an upright position when in storage.

ATTENTION: The evaporator inside the machine has to be dried out before the unit is packed to avoid component damage and molds. Unplug the unit and place it in a dry open area for days to dry it out. Another way to dry the unit is to set the humidity point more than 5% higher than the ambient humidity to force the fan to dry the evaporator for a couple of hours.

9.2 DISPOSAL

WARNING!!!

Releasing refrigerant into atmosphere is strictly forbidden!

Used electrical appliances must be collected separately and recycled in an environmentally sound manner.

