

MERCEDES-BENZ
G65 CHILDREN BATTERY CAR SPECIFICATIONS

TY570699BK
TY570699RE
TY570699WH



Original License Counterfeit Investigated

Exectue standard: GB6675 GB19865
EN71\EN62115 ASTM-F963

Mercedes-Benz G65 (Manual)

Welcome to use our children ride-on cars. To ensure you can use our products correctly, please read through this manual before use. The toy must be assembled by adult

Parts List

			
1.Car body *1	2. Front bracket*1 Rear bracket *1	3.Bonnet *1	4. Car Seat*1
			
5.Rear windshield*1	6.Front windshield*1	7.Steering hook*1	8.Spare wheel*1
			
9.Front Wheels*2	10.Rear wheels*2	11.Wheel covers*4	12.Steering Wheel *1
			
13. Screws*1	14.Self-tapping screw*13	15. Cotter*4 Gasket*6	16. Wearing ring*6

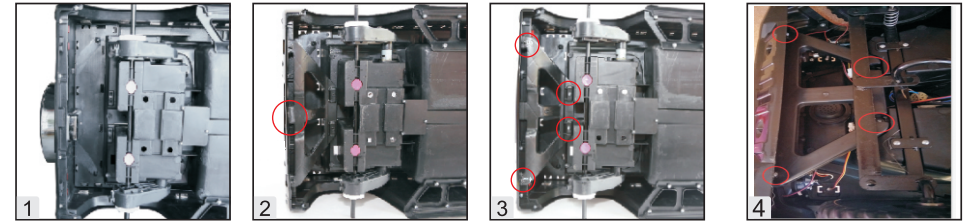

I . Rear bracket Installation:

Side lay the vehicle as picture 1, fix the bracket in car body with 4 screws (as picture 2 &3)

Front bracket Installation:

Side lay the car , fix the front bracket in car body with 4 screws (as picture 4)

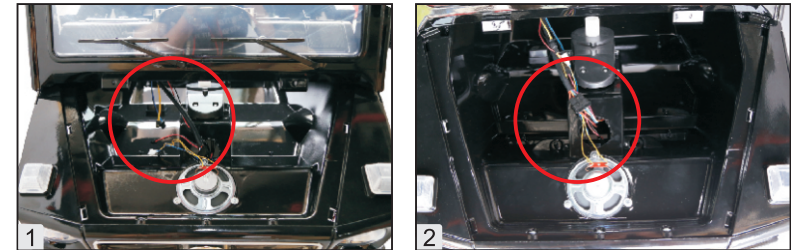

II. Dashboard wiring connection

Lay flat car body, connect the wire socket accordingly (refer to picture 2) .

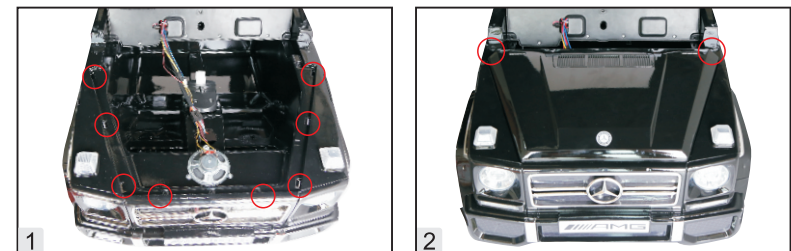

III. Car hood Installation

First put the hood into the relative gaps on the vehicle, then lock it with 2 self-tapping screws.

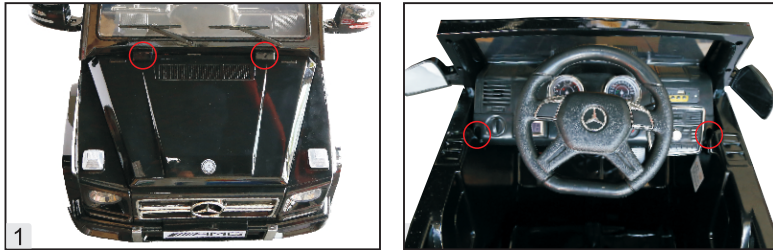

IV. Front windshield Installation

First put the windshield into the relative gaps on the hood, then lock it with 2 self-tapping screws.

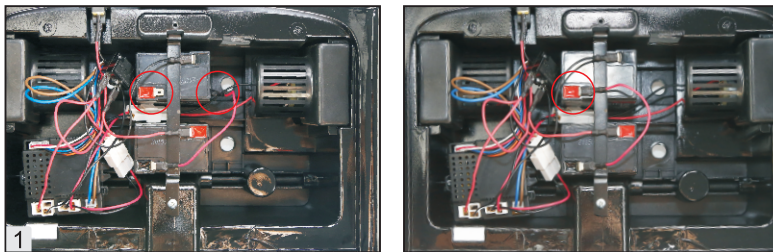

V. Connecting battery terminal

Please note polarity when connecting the battery terminals, black wire to black terminal, red wire to red terminal.

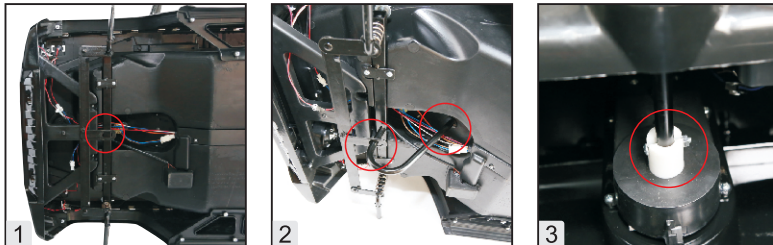

VI. Steering hook Installation

Side lay the vehicle, fix the hook to vehicle as picture 2, then lay flat the vehicle, lock the connecting rod with 1 short screw as picture 3.

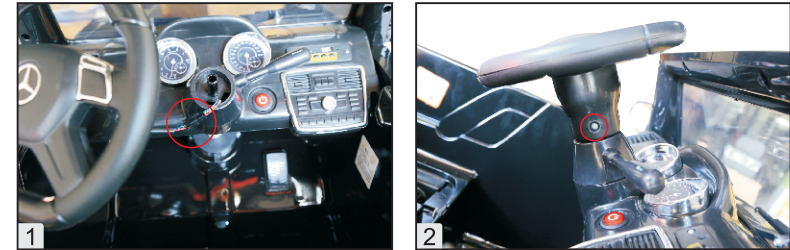

VII. Steering Wheel Installation

First remove the screws and nuts, then connect the wires, insert the steering wheel in the steering rod. Align the side screw holes, lock it with the screws and nuts.

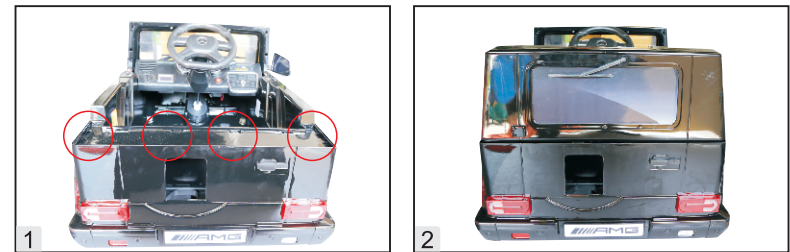

VIII. Rear windshield Installation

Press down the windshield into the corresponding gaps on the car.

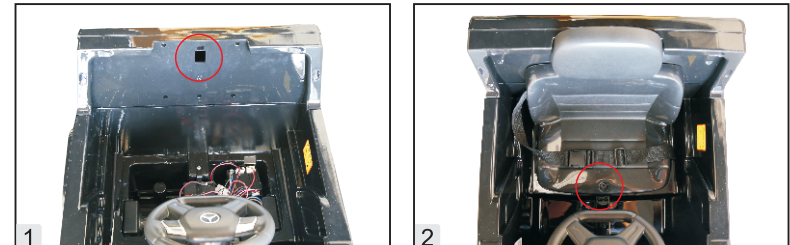

IX. Car Seat Installation

Fix the seat into the vehicle with 1 self-tapping screw.



1 PU tires installation

1. Front wheels install: First put one gasket on the front axle, second put one wearing ring on the inside of the wheel, then the wheel through the axle, third, put one wearing ring on the outside of the wheel, then another gasket, fourth, fasten the wheel with one lock nut and button the small benz logo wheel cover.



2. Driving wheel:

First the rear wheel through the axle, then one wearing ring and one gasket, finally, fasten the wheel with one lock nut and button the small benz logo wheel cover.

PP Plastic wheels install

XI. Front wheels Installation

Install left and right front wheels: first put one gasket on front axle, then install the wheel, put another gasket outside the wheel and use cotter pin to lock it. (as picture shown)

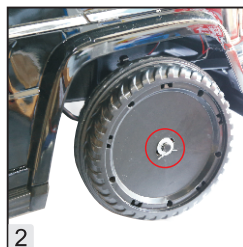
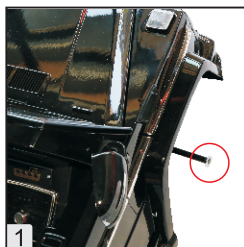

XII. Install driving wheel:

first the wheel through the axle, then one gasket and a cotter pin to lock it.



Warning!

- * For the remote control function, please take reference to the instruction in the remote control box.
- * To avoid gearbox and motor damage, ensure the vehicle has completely stopped when shift gears.
- * Running function: Set in the switch in forward, the vehicle will move forward when you stepping on "foot switch". Set it in backward state, the vehicle will run backward. Set the switch in the middle, the vehicle can not move. (If the car has remote control function, you can also control the car with the controller)

Charging Warning!

⚠ Warning!

To avoid fires and electric shock:

- Only allowed to use the battery and charger prescribed by the manufacturer. Prohibite to use the other brand.
- Do not put the battery and charger in other products.
- It is not allowed to change the line structure privately.
- Do not link positive terminal and negative terminal by any conductor
- Please keep the battery dry, far away from any liquid
- When charging, do not smoking nearby, any flames may cause explosion.
- Please charge the vehicle in well ventilated, dry area.

Charging precautions

- *Battery can not be reversed.
- *battery type: colsed dry battery.
- *Please check the charger,battery and plug before charging, if any damage found, stop using unless repair intact.
- * It's normal for battery heating in charging process,if the temperature is too high, please check either the current flow is too strong or battery internal short-circuit
- * To avoid likely damage caused by battery to child,must fix the battery with platen
- *if the vehicle unused for long time, it must be fully charged, and charge once each month to ensure the battery life.
- *Batteries are only to be charged by adults or children at least 8 years old.
- ** the batteries of the remote controller are non-rechargeable, do not charge them. Batteries should be installed with the correct polarity. Do not mixed different types of batteries or new and used batteries. Exhausted batteries must be removed from the vehicle.

When charging,turn off the power switch.

Before first use,recommend to charge 4 to 6 hours but not more than 10 hours

When the vehicle speed slows down obviously, indicating the battery is low,please charge.

After use,please charge 4 to 8 hours,not exceeding 20 hours.charger

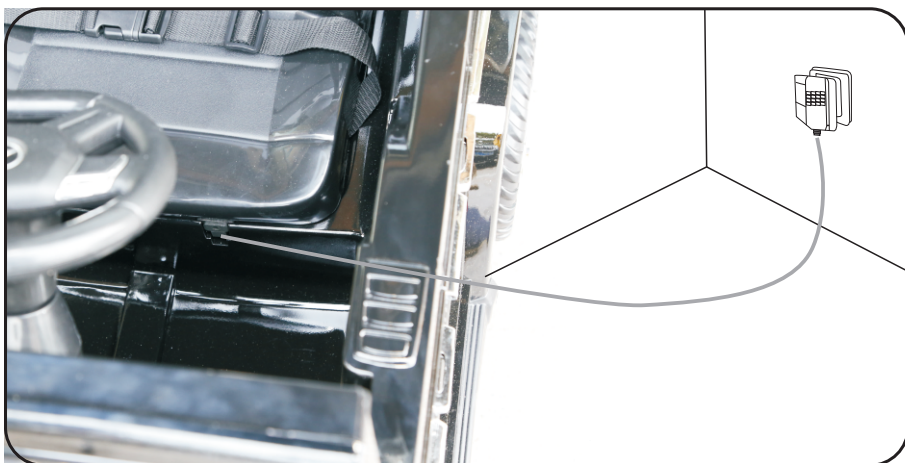

Troubleshooting

■ Problem: the vehicle can not move

Answer 1: it is low battery

please charge in time after each use,charge at least once each month.recommend to charge 4 to 6 hours but not more than 10 hours

Answer 2: overloading

An automatic reset fuse is equipped under the seat,when overloading,it will cut off the power for 15 to 20 seconds,then restart.

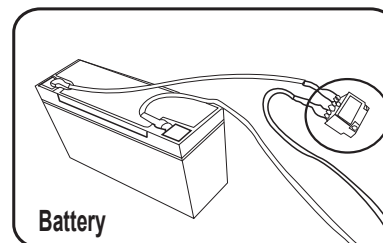

To avoid fuse cut off the power:

1. Max:30kgs,overload is forbidden
2. Do not drag any items behind this product.
3. Do not allow water or other liquids dip the electrical parts.
4. Do not change the line system by yourself.

Answer 3: driving wheel nuts loose

If the nut is not locked tightly,the motor can not work.. Please lock the nut tightly with wrench.

Answer 4:the battery plug-ins or wires loose

Make sure the battery plug-ins have connected correctly,wire without loosing

Answer 5:battery is broken

Please contact the agent or manufacturer

Answer 6:car body wiring has been damaged

Please contact the agent or manufacturer

Answer 7:the motor is damaged

Please contact the agent or manufacturer

■ Problem: unable to charge

Answer 1:the battery plug-ins loose

Make sure the battery terminals have connected with the wires tightly

Answer 2:the charger is not inserted in place

Make sure the charger is plugged into the power outlet properly(ensure the power outlet switch turn on)

Answer 3:the charger can not work normally

If the charger no warmed,please contact the agent or manufacturer

■ Problem: vehicle run for a short time

Answer 1:the battery is not fully charged.

The charging time is not enough,please charge in time after each use.

Recommend to charge 8 to 12 hours but not exceeding 20 hours.

Answer 2:battery aging

Battery service life:1-3 years,otherwise,change a new one.

■ Problem: charger makes a buzzing sound while charging

This is normal.

■ Problem: charger heating phenomenon

This is normal.if the battery temperature is too high,please check either the current flow is too strong or battery internal short-circuit

Note on Safety

- 1.This vehicle is not suitable for children under 36 months. Please use this vehicle under the supervision of adults.
2. Please keep this vehicle far from pool, highway, slopes or other dangerous places.
3. To avoid gearbox and motor damage, ensure the vehicle has completely stopped when shift gears.
4. Before using, parents should check the main parts:battery,charger,wires,plugs, shell and other parts for not damaging;screw loose whether;if there is potential security risks.Any damage found,stop using until well repaired.
5. To avoid rust , lubricate the iron parts with lubricating oil after using for some time.
6. The vehicle should be kept away from fire and long-term light side-up for shortage,upside down
7. Do not use the fuse not matching the product.
- 8.Do not change the wire system by yourself,the repair work must be carried out under the guidance of professionals and technical staff.

Remote control priority function

Please refer to the use of the remote comtrpller description
the remote control must be used under the adult's supervision.



Suitable age: For children between 37 months to 96 months old only.
(Please use this vehicle under the supervision of adults)

Warning!

For safety sake:

- *Please use this vehicle under the adult guidance and supervision.
- *Prohibited to use this product on the the road ,slopes, highway or other dangerous places !
- *When driving, children must wear shoes and helmet.
- *When driving, children should be seating in the seat and fasten the seat belt.
- *The maximum loading capacity of the vehicle is 30KGS, and can take only one child, the users must be aged 37 months to 96 months !