

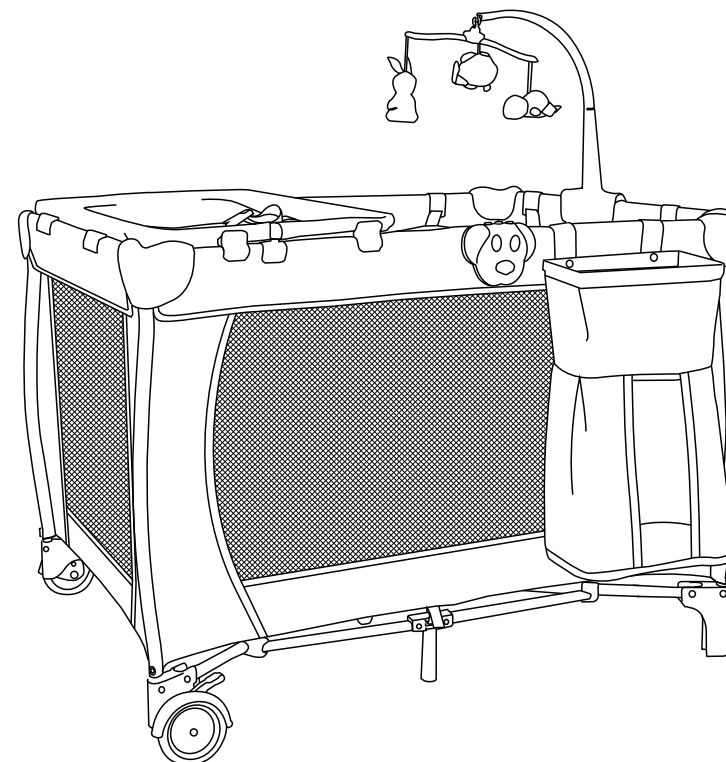

COSTWAY®



USER'S MANUAL

Baby Crib BB0493

THIS INSTRUCTION BOOKLET CONTAINS **IMPORTANT** SAFETY INFORMATION. PLEASE READ AND KEEP FOR FUTURE REFERENCE.

Please give us a chance to make it right and do better!

Contact our friendly customer service department for help first.

Replacements for missing or damaged parts will be shipped ASAP!

Follow Costway

Visit us: www.costway.com



Contact Us!

Do NOT return this item.

Contact our friendly customer service department for help first.



Before You Start

Please read all instructions carefully and keep it for future reference.

General Warnings:

- ⚠ **Attention:** To prevent possible injury by entanglement, remove this toy when the child starts trying to get up on its hands and knees in a crawling position.
- ⚠ **Danger!** Keep all small parts and packaging materials for this product away from babies and children, otherwise they may pose a choking hazard.
- ⚠ **The product must be installed and used under the supervision of an adult.**
- ⚠ **Read through each step carefully and follow the proper order.**
- ⚠ **Remove all Packaging, separate and count all parts and hardware before Installation.**
- ⚠ **Please ensure that all parts are correctly installed, incorrect Installation can lead to a Danger.**
- ⚠ **We recommend that, where possible, all items are assembled near to the area in which they will be placed in use, to avoid moving the product unnecessarily once assembled.**
- ⚠ **Ensure a secure surface during construction, and place the product always on a flat, steady and stable surface.**

Manual Instruction

IMPORTANT: Read all instructions BEFORE assembly and USE of product, and KEEP THEM FOR FUTURE USE.



1 WARNING

WARNING: Never leave the child unattended.

WARNING: Do not put the playpen near a fireplace or any other source of heat.

WARNING: Upper age /weight limit for children using the playpen: 3 years or 15kgs.

WARNING: Do not use the playpen without the bottom being in place.

WARNING: Make sure the playpen is completely unfolded and all the locking system are fully secured before putting your child into it.

2. RECOMMENDATIONS

RECOMMENDATION: Check that all assembly mechanisms are properly secured and regularly monitored.

RECOMMENDATION: To avoid injury, keep children well away when folding or unfolding the playpen..
RECOMMENDATION: Do not leave anything inside the playpen and do not place it alongside anything that the child could climb onto or which could pose a risk of suffocation or strangulation, e.g. strings, curtains ties, etc .

RECOMMENDATION: Do not move the playpen when the child is in it.

RECOMMENDATION: Do not use if one or more items are broken or missing.

RECOMMENDATION: Use only accessories or spare parts that have been approved by the manufacturer.

RECOMMENDATION: Make sure that your child cannot climb out of the playpen. To avoid the risk of falls, stop using the playpen as soon as the child is able to climb out of it.

LIST OF PARTS

Check that no parts are missing before setting up the playpen.

- | | |
|------------------------|--------------------|
| A. 1 playpen | E. diaper changer. |
| B. 1 carrying bag | F. Storage |
| C. 1 foldable mattress | G.Turning toy bar |
| D. bassinet | H. Music box |

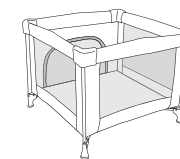

A. playpen

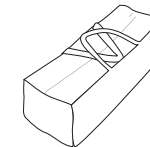

B. carrying bag

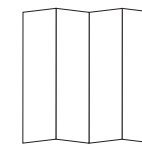

C. foldable mattress

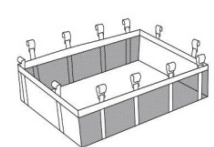

D. bassinet



E. diaper changer



F. Storage



G. Turning toy bar



H. Music box

3. ASSEMBLY INSTRUCTIONS

STEP 1: OPENING OF THE PACK

Open the carrying bag (Fig.1) and take the playpen out. Detach the foldable mattress from the playpen by unfastening the self-fastening straps (Fig. 2) to release the playpen.

STEP 2: SECURING THE PLAYPEN

a. Unfold the structure slightly to push the sides of the playpen apart (Fig. 3).

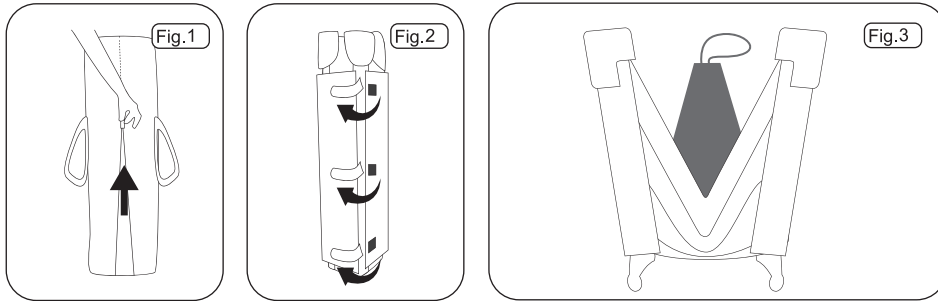

IMPORTANT

Start by unfolding the playpen by pushing the sides apart. The bottom of the playpen(in the centre) should be lowered last.

b. Follow the instructions illustrated Fig.4a and Fig.4b on both sides at the same time.

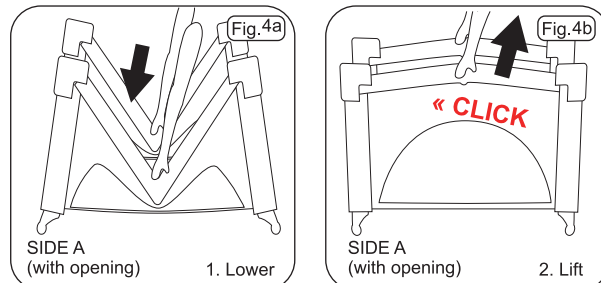

c. Follow the instructions illustrated in Fig. 4c and Fig. 4d on both sides at the same time.

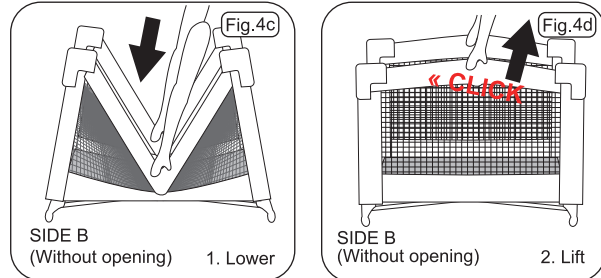

d. Finish by banging down on the bottom of the playpen(Fig. 5) to secure the blacking mechanism.

STEP 3: FITTING THE MATTRESS

Finally, slip the foldable mattress into the bottom of the playpen (Fig. 6).

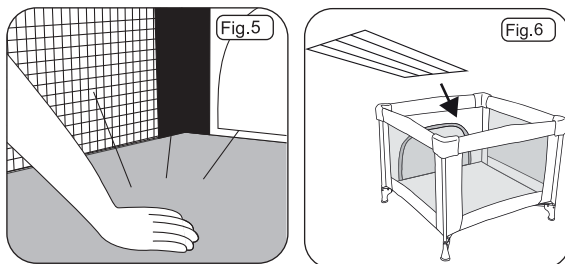

4. FOLDING AND STORING THE PRODUCT

STEP 1: FOLDING THE PLAYPEN

a. Remove the mattress from the playpen (Fig. 7) and lift up the bottom with the help of the fabric pulling strap (Fig. 8).

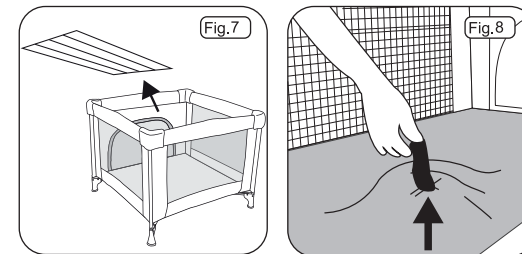

b. Lift up rims A simultaneously while pressing the unlocking button underneath the rim(Fig.9).

c. Lift up rims B simultaneously while pressing the unlocking button underneath the rim(Fig.10)

Each rim should buckle on both sides, as shown here(Fig. 11 and Fig.12).

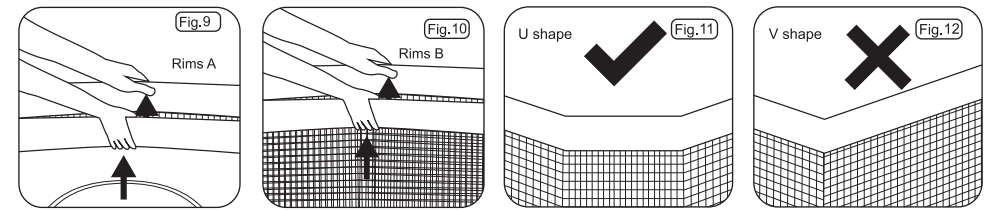

IMPORTANT

If the rims of the playpen do not fold down completely, repeat the procedure shown in Fig.9 and Fig.10

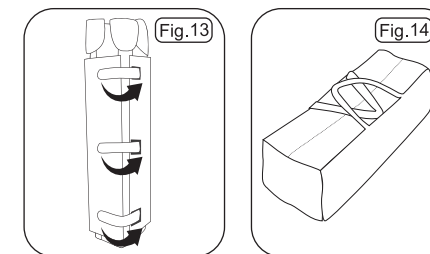

STEP 2: STORING THE PLAYPEN

Once the playpen locking mechanisms have been released, fold it up completely and fit the mattress around the structure, securing it with the self-fastening straps(Fig.13), Slip the whole thing into the carrying bag (Fig. 14).

If the product is including a bassinnet, pls refer to the following drawings to install it.

5. Install the bassinnet

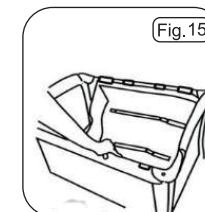

a. Before installing, remove the foldable mattress from the bottom of playard, place bassinnet in side the palyard and attach the 12 clips to the top rails. Fig.15

Make sure all 12 clips are securely attached to the top rails

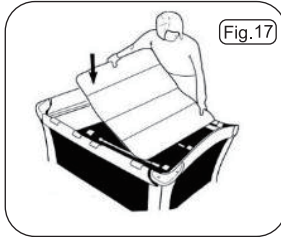
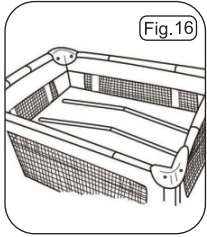

b. Insert the metal tube together in the bottom of the playpen as shown, MAKE SURE tubes are connected before installing the foldable mattress.
Fig.16 Slip the foldable mattress into the bottom of the playpen. Fig.17

Diaper changer assembly

- Unfold the diaper changer.
- Insert the two tubes inside the diaper changer as shown.
- Attach the 4 clips on the top short hand rails. **Make sure all 4 clips are securely attached to the top short rails**

When you put you baby on the diaper changer, Always use the harness to keep your baby in safe.

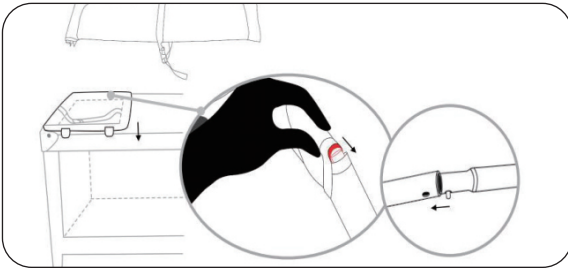

Storage1 or 2 assembly

Attach the clips of the storage to the top rail.

Turning toy bar with music box assembly

Hanging the music box on the bracket hook, then put the bracket onto the short handrail

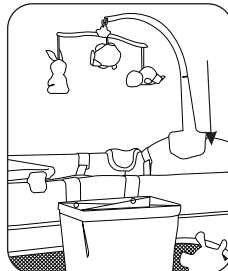
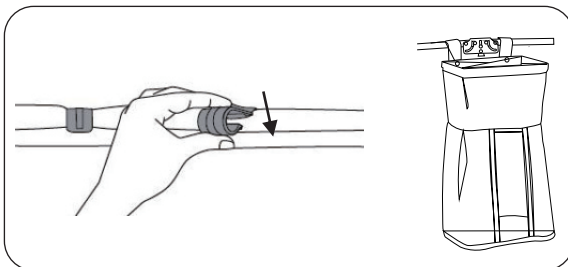

MAINTENANCE INSTRUCTIONS

You can extend the life of your playpen by taking good care of it, here is some advice.

- Never immerse the playpen, just wipe down the different surfaces.
- Clean with a sponge and soap or a gentle detergent. Air-dry, preferably away from sunlight.
- Always store this product in a well-aired place.
- Do not expose to sunlight for long periods of time.

Welcome to visit our website and purchase our quality products!

Your suggestions and comments for COSTWAY are really important to us!
We sincerely solicit you to go back to our shop and leave a good rating in just a simple click. It would be quite encouraging if you could kindly do so like below:

★★★★★ Great products so far

February 24, 2019

Great products so far. Fast delivery, easy setup, and working without any issues.

With your inspiring rating, COSTWAY will be more consistent to offer you EASY SHOPPING EXPERIENCE, GOOD PRODUCTS and EFFICIENT SERVICE!

US office: Fontana, California

UK office: Ipswich



- * Reward Points
- * Exclusive Customer Service
- * Personalized Recommendations
- * Permanent Shopping Cart
- * Order History

5 Star Rating



We would like to extend our heartfelt thanks to all of our customers for taking time to assemble this product and giving us valuable feedbacks.

THANK
you
😊