



**TIPS:**

Your suggestions and comments for Costway are really important to us!  
We sincerely solicit you to go back to our shop and leave a good rating in just a simple click. It would be quite encouraging if you could kindly do so like below:

★★★★★ Great products so far

February 24, 2018

Great product so far. Fast delivery, easy setup, and working without any issues.

With your inspiring rating, Costway will be more consistent to offer you  
**EASY SHOPPING EXPERIENCE, GOOD PRODUCTS and EFFICIENT SERVICE!**



**USER'S MANUAL**  
**Electric Scooter**  
**SP0562**

Contents

1. Introduction

1.1 About this manual

1.2 Related documents and materials

1.3 Relevant agreements

2. Product overview

2.1. Serial number

2.2. Dimension

2.3. Product parameters

2.4. Product composition

2.5. Packaging box check

2.6. SP0562 scooter unfolding

2.7 Optional seat installation Note

2.8. Optional seat height adjustment

2.9. Display screen

2.10. Turning on/off the light

2.11. Horn and sound function

2.12. Operating mode of the scooter

3. Battery and charger

3.1. Batter specification

3.2. Charging method

3.3. Safety tips for charging

3.4. Over-discharge protection

4. Using SP0562 scooter

4.1. Riding SP0562 scooter

4.2. Precautions before riding

4.3. Operation steps for beginners

4.4. Folding steps of the scooter

5. Maintenance

51. Storage

5.2. Cleaning

5.3. Disposal

5.4. Inflation and change of tube and tire

5.5. Inflating method

6. Precautions for safe riding

7. legal information

7.1. Compliance with local laws and regulations

7.2. Version number

8. Maintenance service and disposal

Maintenance Record

1. Introduction

1.1 About this manual

For your safety, please read this manual (hereinafter referred to as User Manual) carefully prior to use of my company SP0562 scooter so as to ensure that you will use SP0562 scooter according to correct instructions.

- Please carefully read and fully understand all safety warnings and notices listed in this manual. They will help you to useSP0562 scooter better.
- This manual applies to SP0562 scooter produced by my company (hereinafter referred to as my company).
- If you have any doubts or can't obtain the information you need from this manual, please contact the authorized agent or the after-sales service department of my company.

1.2 Related documents and materials

The PDF format document and its help document of W-008 User Manual can be downloaded from the official website of my company.

1.3 Relevant agreements

The following instructions apply to the whole User Manual. Please pay special attention to relevant "warning", "prompt" and "attention".

Warning: Your actions or behaviors may cause product damage, personal injury and/or other property loss.

Prompt: The user should pay attention to points or function prompts that should be noted.

Attention: Given continuous product upgrading and updating, illustrations in this user manual are provided for reference only. Please refer to the real object; sorry for any inconvenience caused.

2. Product overview

SP0562 is a cool, compact, efficient and economic personal means of transportation. Its modeling shows both fashionable sense and feel of the science and technology. Excellent shock absorber design and powerful lithium battery bring you pleasant riding experience. .

2.1. Serial number

As the only unique identifier of the product, serial number is used for product quality tracking, after-sales service, insurance claim and loss confirmation. Be sure to record and keep the serial number well. You can obtain the serial number of the product from the following positions: Outer package of the product, warranty card of the product, body of SP0562 scooter.

2.2. Dimension

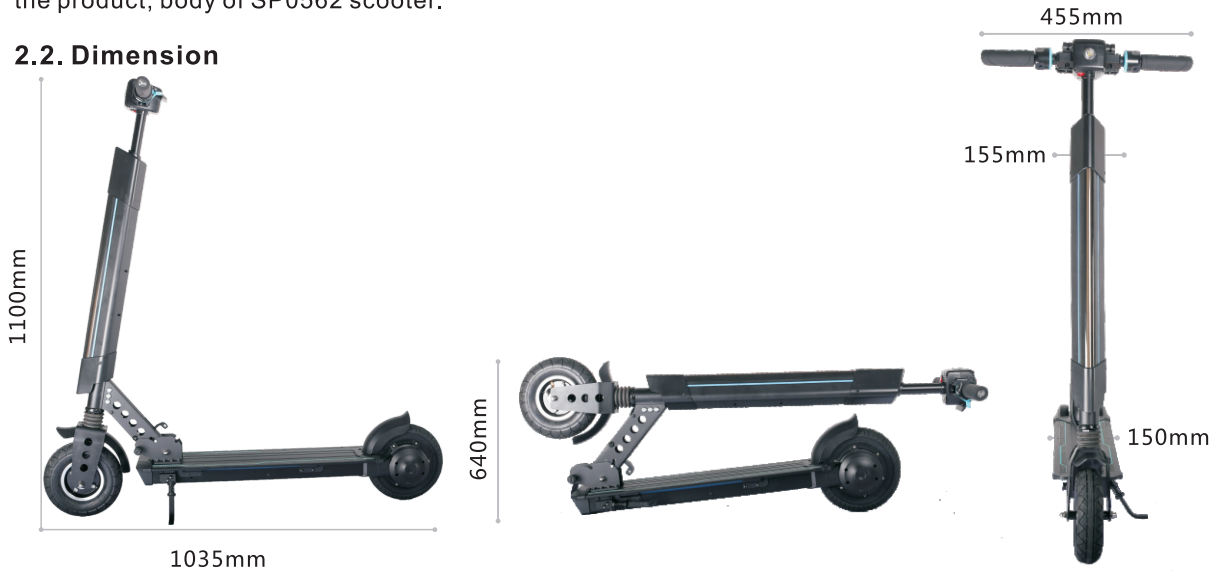

2.3. Product parameters

Product model	Sp0562	<b>Remarks:</b> The average riding mileage is measured at the temperature of 25°C, with a load of 70kg, and on a flat road. Riding habits, ambient temperature, road environment and load will affect the riding mileage. Furthermore, the riding mileage may differ with scooter model and battery model.
Speed default	25km/h	
Maximum cruise speed	25km/h	
Average riding mileage	17~20km	
Maximum gradeability	15°	
Net weight	14.2kg	
Carrying capacity	100kg	
Overall dimensions	103.5CMX45.5CMX110CM	
Battery specification	36V 5.2Ah lithium battery	
Requirements for charging	100~240V 50~60Hz	
Charging time	About 4 hours	
Tire type	Front wheel pneumatic tire, rear wheel solid tire	
Brake type	Electronic brake	
Optimum temperature for riding	25°C	
Waterproof level	Ip65	

5

2.4. Product composio

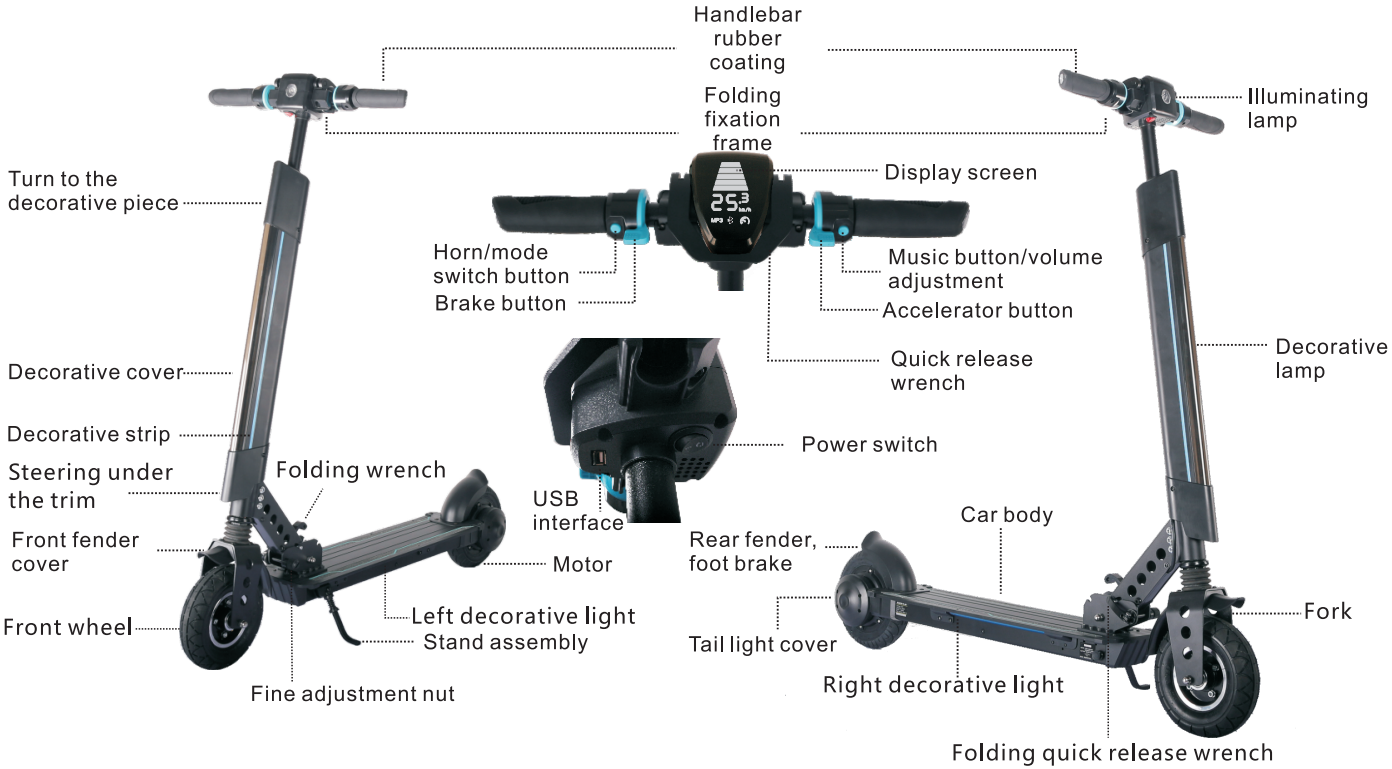

6

2.5. Packaging box check

SP0562 scooter comprises the following components when it is delivered. Please open and check the box. If any item is missing, please consult the distributor or the after-sales service department of my company.

- 1 body • 1 charger • 1 hexagon wrench • 1 user manual

Warning

Adopting non my company approved parts or inappropriately installing the parts may cause damage to SP0562 scooter and even cause personal injury or property loss. To ensure quality and safety, all parts and accessories of SP0562 scooter shall be approved by my ompany and installed on SP0562 scooter properly. Don't disassemble or tune SP0562 scooter without permission so as to avoid unrecoverable damage to SP0562 scooter or personal injury and/or property loss.

2.6. SP0562 scooter unfolding

Tstep1 : pull up the folding wrench and hold the front of the car Before leaving the car body, expand until you hear "嗒" One sound.

Step 2: Press the folding quick release wrench.

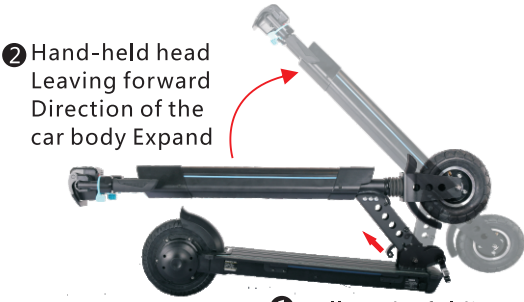

1 Pull up the folding wrench



3 Press the folding quick release wrench

7

Step 3: Open the quick release wrench, unfold the handlebar stem towards both sides, insert the handlebar toward the center, and compress the quick release wrench.

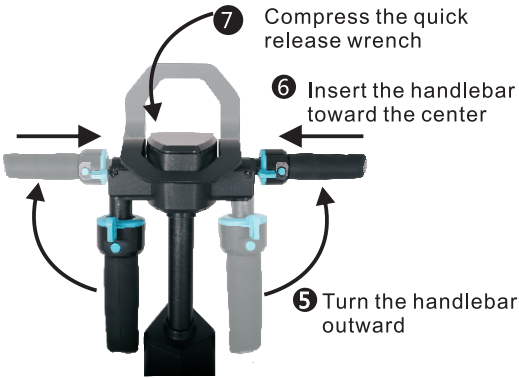

Step 4: Turn on the power switch under the instrument to start and use the scooter normally.

8



**2.7.Optional seat installation Note:** This seat is an optional accessory that can be selected before the user purchases the product. If it is not selected, this accessory is not available.

- 1.Place the assembled seat on the body mounting hole.
- 2.Insert 4 M6 socket head cap screws.
- 3.Twist the four M6 self-locking nuts underneath.



**2.8.Optional seat height adjustment**

- 1.Pull the quick release wrench to the right.
- 2.Adjust the seat height up and down.
- 3.Press the quick release wrench to the left.



**2.9. Display screen**

The display screen is a LED display interface that is used to describe the working state of the scooter:

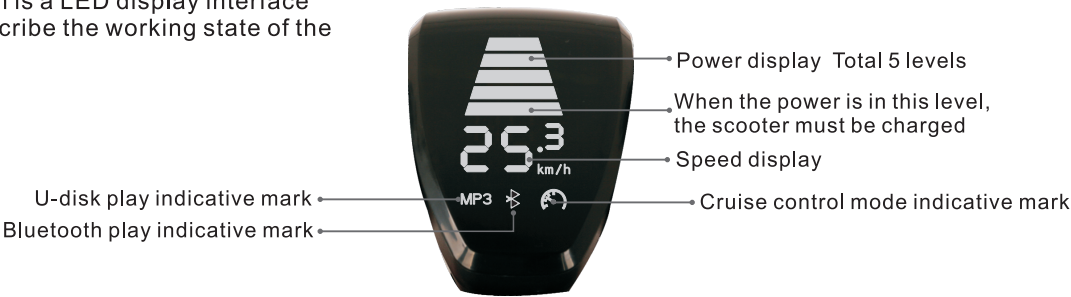

**2.10. Turning on/off the light**

When the scooter is started and braked, keep pressing the brake button for 5s to turn on/off the illuminating lamp



When the scooter is started and braked, keep pressing the brake button and the accelerator button at the same time to turn off the breathing light

**2.11. Horn and sound function**

- 1. Horn function: Trigger the button on the left handle, the horn will make a sound.
- 2. Next song/volume adjustment function: Trigger the button on the left handle, the scooter will play the built-in music automatically and stop automatically after the current song is played. Trigger the button again during playing/after playing to switch to the next song. 5 songs are built in.
- 3. U-disk play function: Insert the U-disk with downloaded MP3 music into the U-disk interface, the MP3 icon on the display screen is on, and now the music in the U-disk can be played. "Trigger next song/volume adjustment" key to switch to the next song or select continuous play without switch.
- 4. Mode switch function: Keep pressing the horn key on the left handle for 3 seconds to switch to Bluetooth mode. Now the horn makes a prompt tone and the Bluetooth icon on the display screen is on.
- 5. Bluetooth play function: After switching to Bluetooth mode, the Bluetooth icon on the display screen flashes. Now by enabling the Bluetooth function of the mobile phone, you can search and find the Bluetooth name of the scooter "W-007", click connection and wait for several seconds, now the Bluetooth icon on the display screen is on constantly to represent that it has been connected; play the music on the mobile phone, now the scooter will play the music; adjust the volume and select songs on the mobile phone, now the sound made by the horn of the scooter changes synchronously; note: If there are connection records of two or more other devices, it is suggested to unpair the historical connection records, which can improve the connection speed of the scooter and the Bluetooth on the mobile phone.
- 6. Volume adjustment function: When a song is being played, keep pressing the music button on the right handle to increase the default starting volume to the maximum level gradually. When the volume is increased to the maximum level, the horn will beep. After releasing the music button, keep pressing it again to reduce the volume gradually.

**2.12. Operating mode of the scooter**

SP0562 scooter has three operating mode. Here make a brief introduction of some important operating modes:

Operating mode	Description
Enter cruise control mode	Keep pressing the accelerator to a certain position for 5s to enter the cruise control mode. Now the cruise icon on the display screen is on. Release the accelerator to ride the scooter at current rate; Press the brake or accelerator to deactivate current cruise control mode.
Power save mode	Keep pressing both the brake and accelerator all the way down for 5 seconds to turn off the light on the scooter; keep pressing both the brake and accelerator all the way down for 5 seconds again to exit power save mode.
Sleep mode	When the scooter is in static state without any operation for 3 minutes, the scooter will go off automatically and enter sleep mode; move the scooter or press the brake or accelerator to exit the sleep mode.

**3. Battery and charger**

**3.1. Batter specification**

The following table describes various parameters of the battery:

Model	SP0562	<b>Remarks:</b> 1. The charging time may vary with the battery model, ambient temperature and battery capacity. 2. Voltage here means the voltage of the lithium battery with a moderate capacity. 3. Charging is unavailable when the temperature is below 0°C.
Type	Lithium battery	
Charging time	About 4 hours	
Voltage	36V	
Capacity	5.2Ah	
Weight	1Kg	
Dimension	L*W*H: 200*71*40mm	
Operating temperature	-10°C~40°C	
Charging temperature	5°C~45°C	
Storage temperature	-20°C~45°C	

**3.2. Charging method**

First step: The charging port is located on the right side of SP0562 scooter. Make sure the charging port is dry.  
Second step: Insert the charging end of the charger into the charging port of SP0562 scooter.  
Third step: The indicator lighting up in red represents that the battery is being charged. The indicator turning green from red represents that the battery has been fully charged; now stop charging as charging for a long time may affect the service life of the battery and even cause safety accidents.



3.3. Safety tips for charging

- To maximize the service life of the battery, please charge the battery once every three months or when the battery runs down; delayed charging may cause damage to the battery.
- Even when the scooter is not in use for a long time, the battery is always in standby state, namely, static microcurrent will be generated and consume power, so that battery over-discharge may be caused at last after a long time, in this case, be sure to charge the battery once every three months.
- Please use the battery, charger and cable provided by the original manufacturer to avoid risks.
- Be sure that the charger is provided with specified cable and connected correctly.
- Be sure to use the battery in a well-ventilated environment with appropriate temperature.
- Be sure to use the battery in a dry environment. Contact of the charger and water or touching the charger with wet hand is forbidden, because this may lead to electric shock.
- Pull out the power plug immediately if any failure occurs during charging.
- Be sure to draw the plug rather than the cable.
- Keep the charger and its cable from sharp or hot items.
- Conduct visual inspection for the charger and its cable.
- Stop using the charger or the cable in case of any wear.
- Don't repair the battery, charger or cable by yourself.



3.4. Over-discharge protection

The built-in intelligent over-discharge protection system of SP0562 scooter will cut off the power supply in order to protect the battery when the battery level is too low no matter the scooter is in operating state or shutdown state. The scooter under over-discharge protection state should be awakened by charging. If the scooter can't be awakened after it is charged for half an hour, please contact the authorized agent or after-sales service department of the company.

4. Using SP0562 scooter

4.1. Riding SP0562 scooter

SP0562 scooter is a high-tech means of transportation. If you don't understand the operating specification, riding SP0562 scooter may result in unpredictable harm, especially for users who use SP0562 scooter for the first time. Here we will explain in detail how to ride SP0562 scooter correctly and list various matters needing attention which the user shall read carefully. The user shall ride SP0562 scooter according to the requirements completely.

4.2. Precautions before riding

Be sure to check the following items before riding SP0562 scooter since certain losses may be generated during riding or parking and affect the performance of the product:

- Check whether all components of SP0562 scooter are mounted securely without any damage. If any component is loose, fasten corresponding accessories; if any component is damaged, stop using it.
- Check whether the handle is tightened securely; if the handle is loose, adjust and tighten the bolt with the tools provided with this scooter until the handle isn't loose.
- Check that the rotating mechanism and folding mechanism have been locked.
- Check that there is enough power.
- Check that the tire is in good condition.
- Take a test riding in a relatively open and flat place (road with a minimum area of 4m\*20m) prior to use.
- You should fully understand the riding environment around; make sure that you will not be disturbed by vehicles, pedestrians, pets, bikes and other barriers.
- You should have a skilled assistant by your side. The assistant shall be able to operate W-008 scooter skillfully and know all precautions and riding methods in this manual very well.
- Don't take the test riding on smooth or wet field.
- Be sure to wear the safety helmet and protective equipment to avoid possible injury.

Warning

- Moisture will slow the reaction rate of the brake. Clean the brake pad on the rear wheel of the scooter and dry it in a safe place.
- Don't use this product in bad weather (such as: rainy, snowy or icy environment).
- Before use of this product in any environment, please check whether the brake can function normally in advance.

4.3. Operation steps for beginners

- Press the power switch under the display screen to start SP0562 scooter.
- After the operation in the previous step, the front decorative lamp and tail light of SP0562 scooter go on, representing that the scooter has been started.
- Put one foot on the pedal and look ahead; pedal forward with the other foot to generate an initial speed, and then press accelerator button to accelerate the scooter.
- Now, put the other foot on the pedal too and stand in a staggered way, straighten up the upper body, look straight ahead, feel like standing on a flat ground, and keep your body balanced.
- Press the handle of the accelerator lightly to accelerate the scooter. The degree of acceleration depends on the degree of pressing on the handle of the accelerator. It is suggested that beginners shall accelerate gradually and slowly.
- When you are riding the scooter, keep pressing the accelerator at the same position for 5s to enter cruise control mode. Now the cruise icon on the display screen is on. Now release the accelerator to ride at current speed. Press the brake or press the accelerator again to deactivate the cruise control mode.
- Rotate the headstock to control the riding direction. Since W-008 scooter has a certain length, don't turn it in a narrow space.
- If there is a need to decelerate or stop the scooter, press hard the brake button with fingers on the left hand until SP0562 scooter decelerates or stops.
- Furthermore, you can stomp on the fender behind to decelerate or stop SP0562 scooter.
- After the brake is activated, the accelerator button on right handle shall be powered off automatically and disabled.
- When W-008 scooter isn't in use, after it is parked and put aside for 3 minutes, the decorative lamp shall enter sleep state, but the nixie tube shall go on continuously.
- If SP0562 scooter shall not be used for a long time, remember to turn off the power switch and charge the battery in a timely manner when the power level is low.

4.4. Folding steps of the scooter

- 1: Pull the folding quick release wrench outwards.
- 2: Push the handlebar forward, Pull up the folding handle at the same time
- 3: Hold the handlebar down and fold it down until it clicks.
- 4: Finish folding.



5. Maintenance

5.1. Storage

- Improper storage will reduce the service life of the lithium battery or cause other hazards. Please store SP0562 scooter in a dry indoor place with appropriate temperature and humidity.
- Don't store the scooter in a place exposed to direct sunlight (even the trunk), otherwise, high temperature may cause damage to the battery and even cause safety accidents.
- When the battery is not in use, self-discharge will occur. Please monitor the battery level once every three months at least and charge the battery in time so as to ensure a full charge state of the battery and avoid irreparable losses caused by storing the battery without power for a long time (such as deep discharge of battery or other accidents).
- The battery may run down faster in winter due to low temperature.
- Fully charge the battery before storing SP0562 scooter for a long time.

5.2. Cleaning

- Be sure to stop the scooter, disconnect the charging cable and cover the charging port before cleaning. Make sure that water doesn't get into the charging port in the process of cleaning.
- Clean the shell of SP0562 scooter with soap-suds or clear water and soft cloth. Don't clean it with water cannon.
- The waterproof and dustproof level of W-008 scooter is IP65, i.e., it is spill-resistant and anti-dust. Therefore, don't immerse SP0562 scooter into water, otherwise, permanent damage may be caused.

5.3. Disposal

- You have made great contributions to environmental protection by the use of SP0562 scooter. In order to further avoid unnecessary pollution of battery and electrical equipment, it shall not be disposed as common household waste.
- Please dispose your SP0562 scooter and all relevant assemblies (battery) with authorized disposing facilities.
- Please abide by the latest applicable guideline. Please consult the distributor or the after-sales service department of my company for inquiries.

5.4. Inflation and change of tube and tire

- When the tire shows under-inflation, inflate the tire in time and keep the tire inflated to the correct pressure. Default tire pressure is 1.5Bar.
- When the tire of SP0562 has to be changed due to reasons such as flat tire, please contact the authorized agent or the after-sales service department of the company.

5.5. Inflating method:



Twist the valve cover and connect the pump to hit Gas, after the end of the game, twist back in the opposite way.

6. Precautions for safe riding

- Please read carefully and fully understand the "SP0562 scooter user manual" before using the SP0562 scooter.
- DPlease don't let anyone who fails to read and fully understand the user manual of the w-007 scooter use your w-007 scooter.
  - The W-007 is designed to carry one person with a maximum weight of 100KG. driving age is 13 to 60 years old, under 16 years old, driving should have adults in Next supervision to avoid accidents.
  - The maximum speed of this product is 25KM/H, please control the driving speed according to the local road conditions.
  - It is forbidden to use this product for racing and stunt performance to avoid unresponsiveness and out of control.
  - When the motor is running, do not allow your body parts such as hands, feet, hair, clothing, etc. to come in contact with the motor.
  - Ensure all bolts are fastened securely and braking system is functioning properly (including axle guards, chain guards or other covers .)
  - Ensure that all guards and/or pads provided with the W-007are in proper place and good condition prior to riding.
  - Ensure area is safe and suitable for safe riding.
  - Ensure all safety labels are in place and understood by the operator and any passenger.
  - After the product is powered on, the electronic brake system operates normally and brake operation is possible.
  - Ensure tires are in good condition, inflated properly, and have sufficient tread remaining.
  - Please watch the operation demonstration provided by our company before driving, and understand that all operation parts can be used after the operation.
  - Observe road conditions and follow traffic regulations at all times.
  - It is prohibited to use W-007 scooter for people with heart disease, pregnant women, people with head, back, or neck problems or who have not previously recovered from surgery.
  - Do not drive the W-007 Scooter when you are sick or taking physical or mental conditions such as taking drugs or drinking.
  - When using this product, you should wear your shoes and wear appropriate protective clothing, knee pads,and helmets.
  - Insufficient light at night, do not ride at night to avoid danger.
  - The parts of this product should be maintained and repaired according to the company's specifications, and only the replacement parts authorized by the company should be used only by the dealer or other technical personnel.nstall it.
  - When driving, avoid sharp bumps on the road, pay attention to drains, and sudden changes in the road surface.
  - Do not incline above or below 15°, and do not make rapid acceleration or deceleration on the slope.
  - The wading depth should not exceed 20m. Do not immerse the vehicle in water, prohibit cycling up and down the stairs, and prohibit driving on the motorway.
  - Pay attention to obstacles and slippery roads. Avoid running on the road with water, sand, gravel, dirt, leaves, and other debris. Wet roads can affect Gravity, braking and visibility.

- W-008 scooter is means of transportation for single person. Two or more persons are prohibited from riding the same scooter at the same time. Carrying a baby or bearing loads are prohibited too.
- Please confirm you have the physical and mental conditions that you can freely get on/off and control SP0562 scooter without the help of others before riding SP0562 scooter.
- Please install the product in strict accordance with the installation instructions on the User Manual of SP0562 Scooter . Improper installation may cause risks such as losing control, collision or falling down. Pay attention to proper force application during installation. Both excessively loose and tight installation may cause damage to or failure of the scooter. Special prompt: Don't implement installation and maintenance when the power is on.
- Don't tune or maintain SP0562 scooter without permission or allow non- authorized persons to tune or maintain SP0562 scooter. If the product has any problem, please contact the after-sales service department of the company, which is the most secure choice for you.
- Please ensure that SP0562 scooter is free of abnormities such as loose installation, damage or failure before use.
- The tire of rear wheel of SP0562 scooter is pneumatic tire. Incorrect pneumatic pressure and tire pressure may lead to unstable riding or easy damage and even cause traffic accidents in severe case. Please check the tire pressure of wheels twice a month at least and recheck the tire pressure before long riding.
- Stop using this product and check and repair this product immediately after loose or other damage, abnormality or failure phenomenon of the components of the product are identified during the use of W-008 scooter so as to avoid danger.
- Ensure that the jack is dry and free of failure and foreign matter before charging. Be sure to connect the correct jack (100V-240V/50HZ-60HZ), and keep out of reach of children & pets, and keep away from flammable materials.
- Battery used on the scooter must be placed in -20℃~45℃ environment. Don't place the scooter in an environment where the temperature is higher than 45℃. Besides, when the temperature is lower than -20℃, the battery will enter into self-locking status and can't be charged and used. In this case, please move the scooter to a warmer environment where the battery can be charged and used.
- If the battery shows abnormities such as leakage (including damage, giving off a peculiar smell, smoke or overheating), please stop using it immediately and avoid contact with other items.
- Don't try to open or disassemble the battery or conduct any abnormal operation and use of the battery.

- The standby time of the scooter that is fully charged (The display screen shows Power Level 5) is about 180 days in different battery statuses and environments; the standby time of the scooter that isn't fully charged (The display screen shows Power Level 1) is about 90 days. Pay attention to the standby time to avoid unrecoverable damage to the battery caused by delayed charging.
- Don't wear unsuitable shoes such as high heels and unsuitable clothes such as excessively loose clothes when riding the scooter. Besides, wear professional protective equipment must be worn.
- It is high suggested that you wear protective glasses when you ride the scooter to prevent dirt, dust or insects in the air from causing damage to your eyes and adversely affecting the riding.
- Don't ride the scooter in rainy days or on wet roads. This is because the resistance of tires decreases and the braking deceleration distance increases and the scooter may go out of control due to slipping when the road is wet and slippery.
- Please use dry and soft cloth to wipe and clean the scooter. Don't use strong water flow or high-pressure hose to clean the scooter and don't immerse the scooter into water to avoid risks such as uncontrollable severe failures, abnormities or accidents.
- Don't use the scooter in bad weather or bad environment with very low visibility and poor light and don't use the scooter when you are extremely tired.
- At night or in an environment with poor light, drivers, car drivers and pedestrians can hardly see each other in time, so we highly suggest that you don't ride the scooter at night or in an environment with poor light to avoid possible serious risks.
- When you ride W-008 scooter, please pay attention to the change of road and ambient environment and ride carefully to avoid hurting yourself and others.
- Don't ride the scooter on stairs, in elevator, through the revolving door or under other inappropriate road conditions and in other inappropriate environments.
- When you ride W-008 scooter, pay attention to the distance between your head and barriers.
- In case of slope, uneven road or other terrains you haven't met before, be sure not to pass them venturesomely.
- Don't make turns at high speed or brake suddenly on smooth road. These behaviors may cause the scooter out of control, including spin.

- Please ride the scooter on non-motorized vehicle lane. Riding at inappropriate places, such as on motorized vehicle lane, is prohibited. Please strictly observe traffic rules and other laws and regulations. When approaching or passing through crossroads, bends of motorized vehicle lane or doors, slow down and give way to pedestrians; meanwhile, enhance defensive awareness and pay attention to hazardous acts of passing vehicles and pedestrians that may hurt you.
- Please always pay attention to and watch out for vehicles, pedestrians, holes, sewer board, railway track, expansion joint, road or sidewalk construction, chips, other barriers and other hazardous conditions that may affect your and others' personal and property safety.
- Don't make and receive phone calls or have any activities or actions that may distract you when you are riding SP052 scooter so that you can monitor external environments with full attention.
- Please ride the scooter along the edge of bicycle lanes or roads permitted and designated by local government and laws forward. Riding backward is prohibited. Don't cut in with vehicles or pedestrians when you are riding SP052 scooter.
- Don't put your hand on another means of transportation and have you dragged when you are riding SP052 scooter; don't do stunts or any other extreme sports, or have other improper conducts.
- Don't ride SP052 scooter to remote areas alone. Even if you ride SP052 scooter to remote areas together with others, make sure to prevent possible risks.
- SP052 scooter is a short-trip means of transportation. Don't use it for cargo transport or other improper purposes.
- The data and parameters of SP052 scooter may vary with the model of the product and are subject to change without further notice.



7. legal information

7.1. Compliance with local laws and regulations

SP0562 scooter can be used as an intelligent and convenient means of transportation. However, it can't replace existing means of transportation. Don't ride SP0562 scooter on public transport road. In certain countries and regions, SP0562 scooter is prohibited from being used on public transport road. Please consult related local department or authorized agent of my company or after-sales service department of my company for details.

7.2. Version number

v1.0

8 MAINTENANCE SERVICE AND DISPOSAL

8.1 MAINTENANCE

components shall be maintained and repaired in accordance with the manufacturer's specifications and using only the manufacturer's authorized replacement parts with installation performed by dealers or other skilled persons.

Cleaning

- Always disconnect your SP0562 from the charger before cleaning with liquid .
- Do not use thinners or other solvents for cleaning as they may damage the surfaces.
- Use a damp cloth when cleaning plastic parts.
- Do not wash the SP0562 with a high pressure hose or immerse in water.

Maintenance and repair

- Make sure all parts are installed and functioning properly. Never attempt to access the electronics,Motors, or the components unless specified in the user manual or by an authorized service center.There are not user-serviceable parts.
- Clean the rear brake mudguard regularly . test the brake at low speed to check it's working correctly before riding.
- To do the maintenance of a small amount of ubricant in the clutch sleeve folding handle inside every six month.
- To increase the lifespan of your E-scooter ,avoid storing your W-008 outdoors or in humid or wet conditions.

General Trouble shooting

When the product is unable to operate normally, please check whether completed as follow actions.

If the following is complete but the product still does not work, contact your dealer.

problem	Potential Cause	Solution
The car did not show	Power switch is not turned on	Turn on the power switch
	Battery is dead	Charge with charger
The car can't run	Not enough power	Charge with charger
short run time (less than 15 minutes)	Battery is not fully charged	full charge
	Battery aging	Replacement battery

Maintenance Record

S/N	Maintenance record	Service site	Maintenance time
1			
2			
3			
4			
5			
6			

Note: Please return the warranty card, invoice and the body, charger and lithium battery pack etc. of the product.