



TIPS:

Your suggestions and comments for Costway are really important to us!
We sincerely solicit you to go back to our shop and leave a good rating in just a simple click. It would be quite encouraging if you could kindly do so like below:

★★★★★ Great products so far

February 24, 2018

Great product so far. Fast delivery, easy setup, and working without any issues.

With your inspiring rating, Costway will be more consistent to offer you
EASY SHOPPING EXPERIENCE, GOOD PRODUCTS and EFFICIENT SERVICE!

US office:Fontana

UK office:lpswich

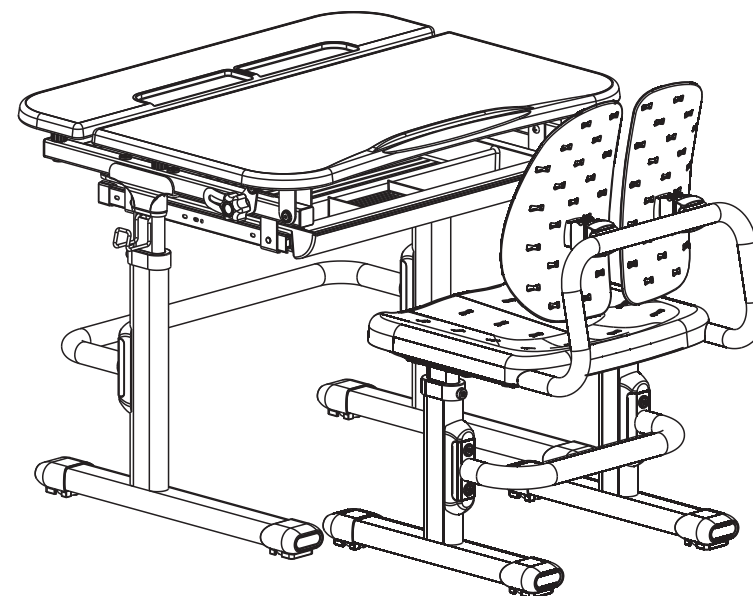

ASSEMBLY INSTRUCTIONS

Healthy Ergo Study Desk & Chair

HW63294

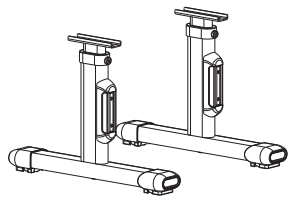

B1



B2

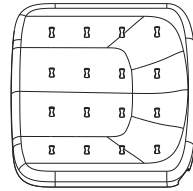

B3

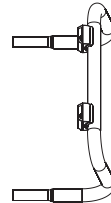

B4

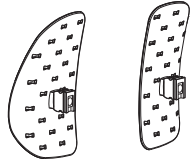

B5

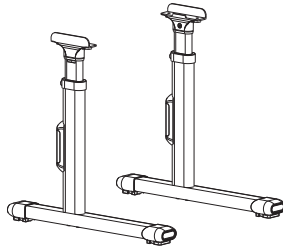

B6



B7

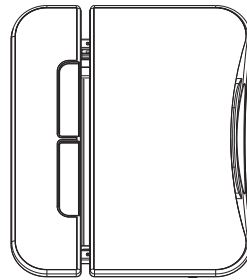

B8

B9



D6
A1x18



M6x12
A2x14



M6
A3x4



M6x35
A4x4



A5x1

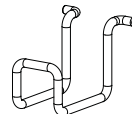

A6x1

CAUTION!

1. For indoor use only.
2. This product should be placed on a flat surface.
3. Please immediately wipe clean the desktop surface if any liquid is splashed on it.
4. Please check screws regularly to ensure there are no loose parts during daily use.
5. Only tightly fasten all the screws once the desk and chair have been assembled properly.
6. Use a damp cloth to clean the desktop surface.
7. Don't put product in the place where there is corrosive gas and moisture in case of damage.

CHAIR ASSEMBLY INSTRUCTIONS

1

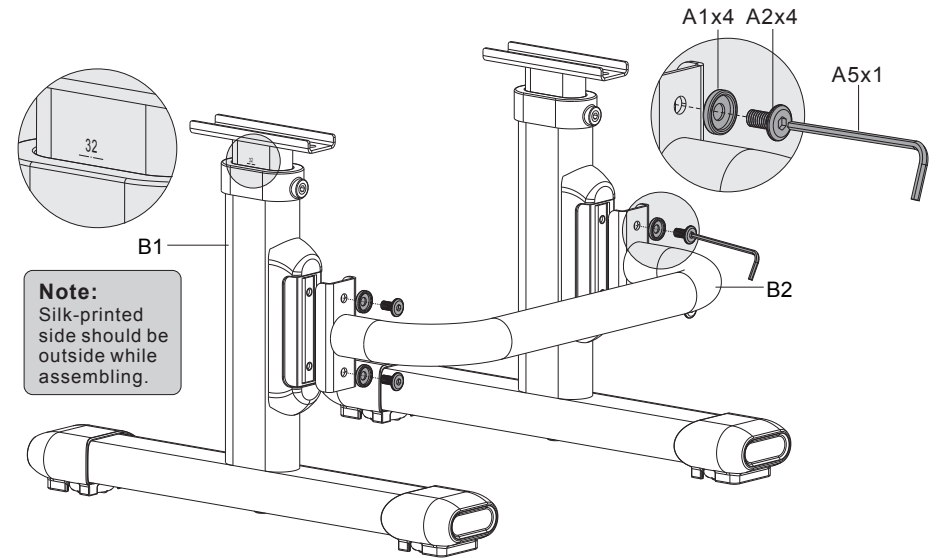

2

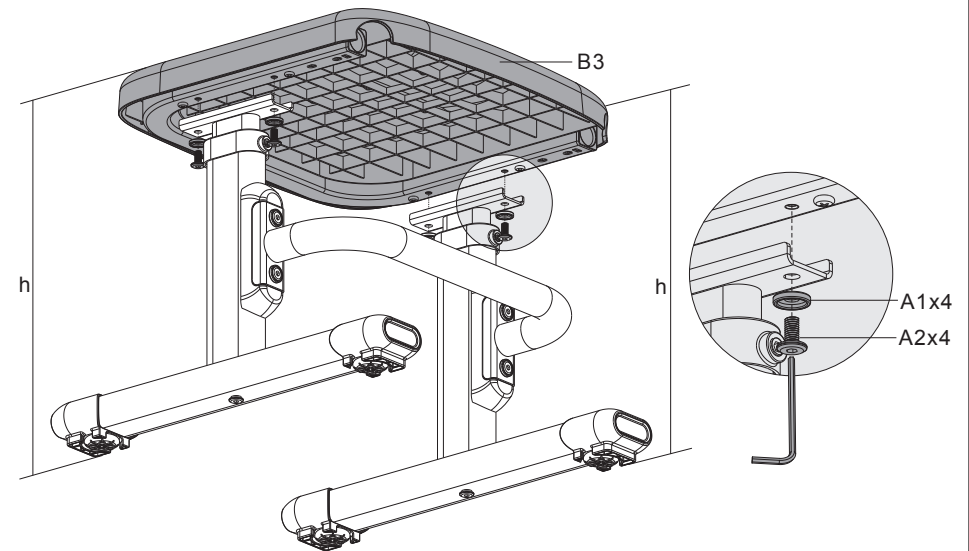

3

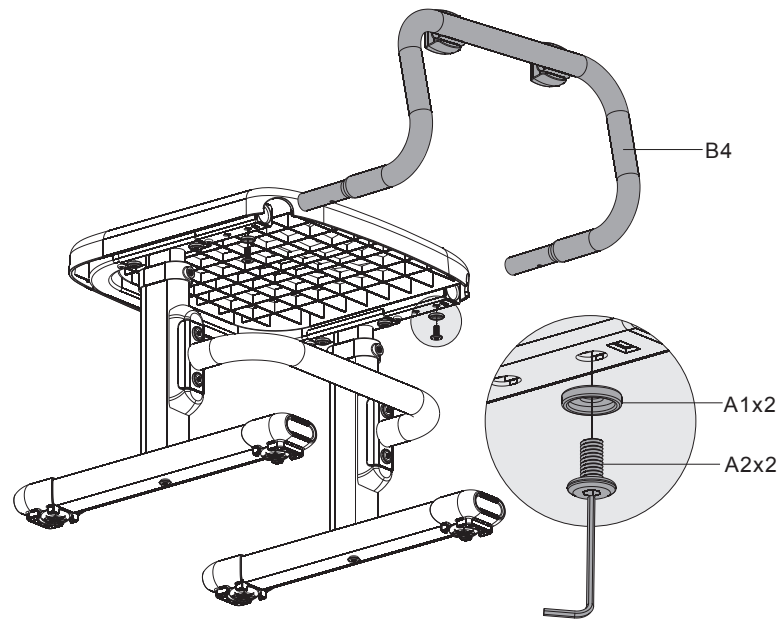

4

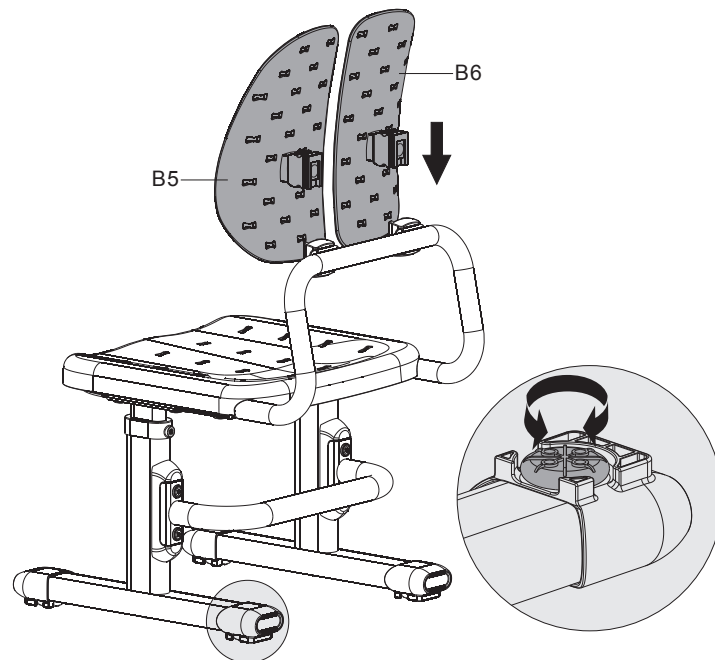

DESK ASSEMBLY INSTRUCTIONS

5

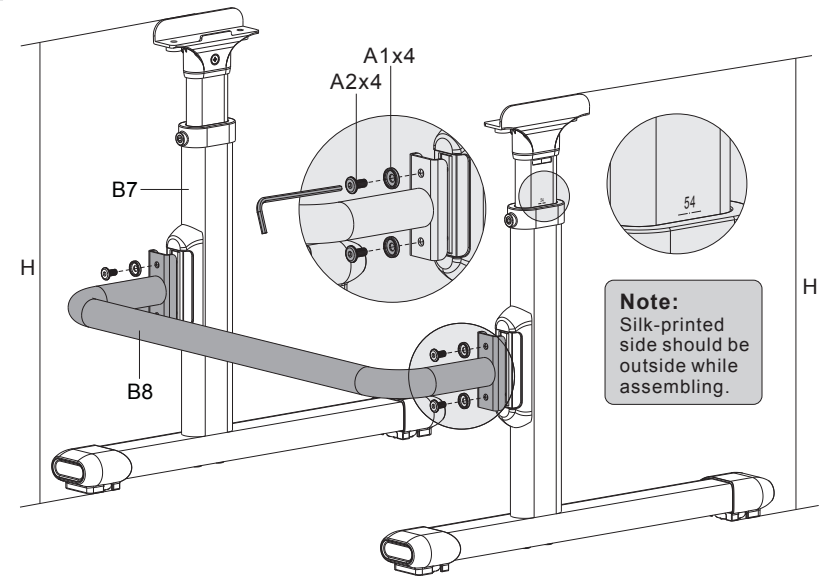

6

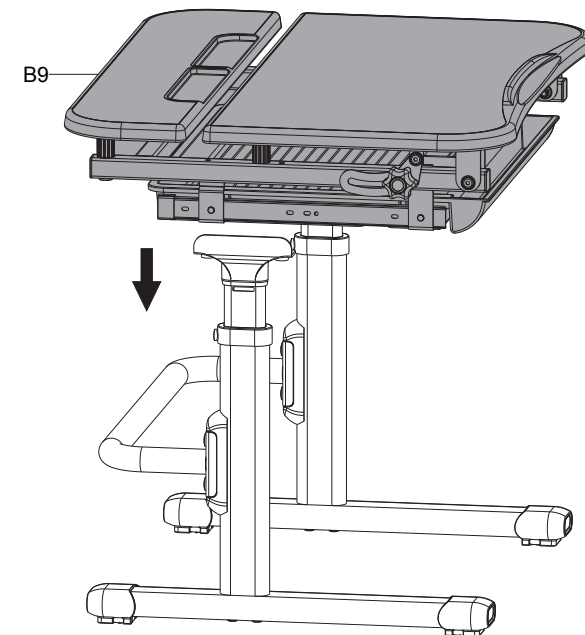

7

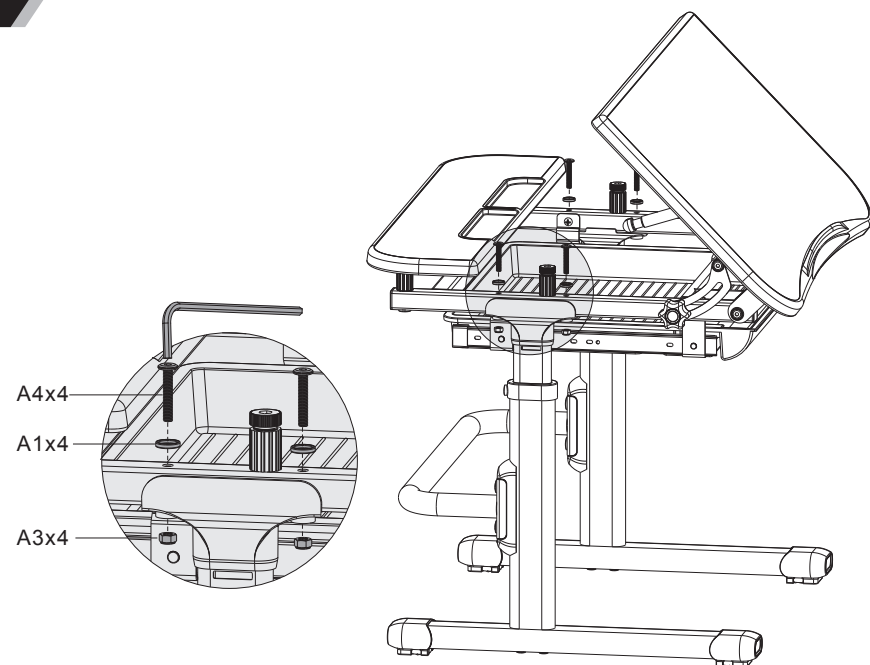

8

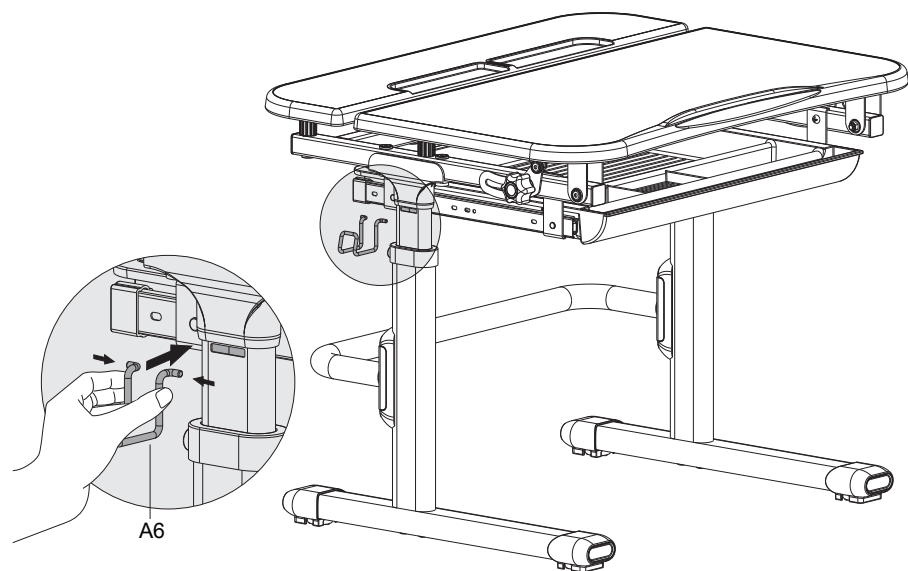

9

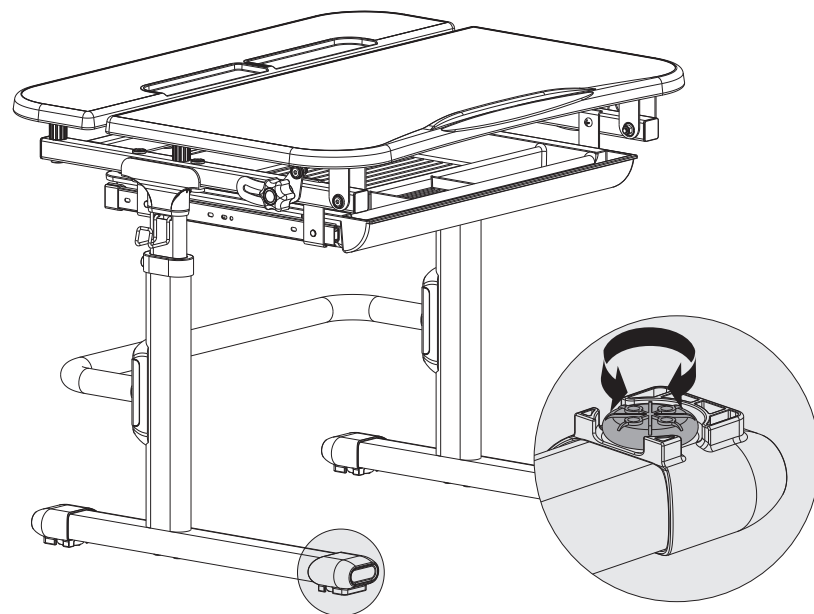

10

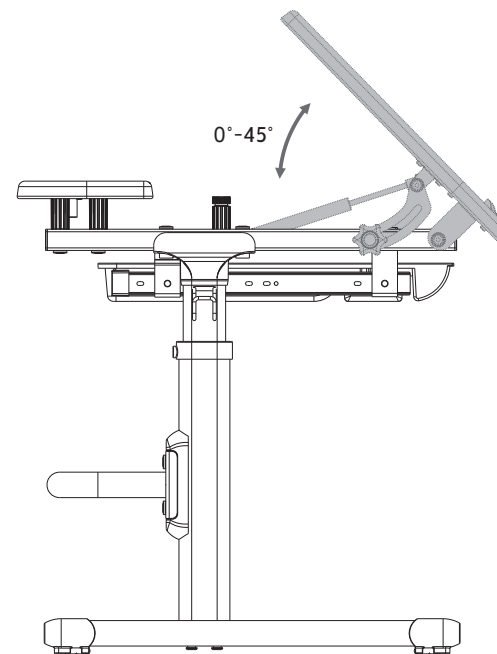

HEIGHT ADJUSTMENT

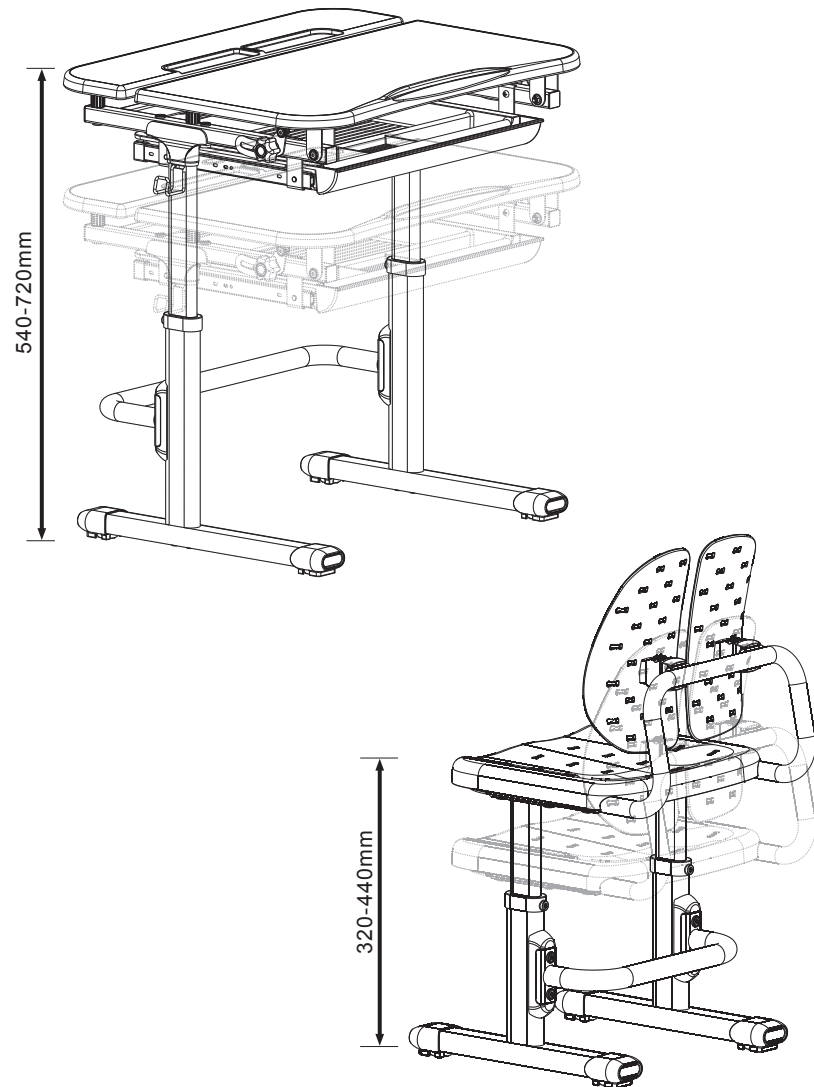

How to Lift Up

The desk and chair can be adjusted higher by placing one foot on the support bar and pulling the desk or chair up to the required height.

How to Lower Down

Gently pull up the desk or chair to the maximum height and then slowly lower down to the minimum height. Lift up again to the required height as above.