

# SuperFit

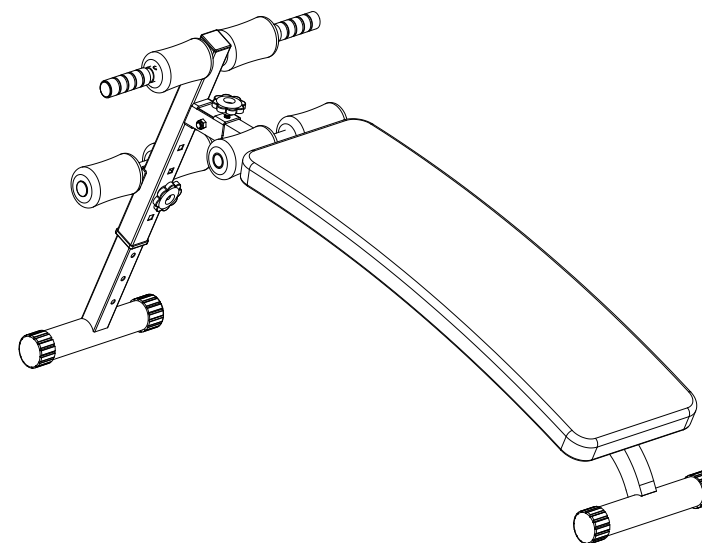

## USER'S MANUAL

THIS INSTRUCTION BOOKLET CONTAINS **IMPORTANT** SAFETY INFORMATION. PLEASE READ AND KEEP FOR FUTURE REFERENCE.

**Please give us a chance to make it right and do better!**

Contact our friendly customer service department for help first.

Replacements for missing or damaged parts will be shipped ASAP!

**Follow Costway**

Visit us: [www.costway.com](http://www.costway.com)



## Parts List

No.	Item Name	Quantity	NO.	Item Name	Quantity
1	Front Bracket	1	10	Square Tube Plug	1
2	Forefoot Tube	1	11	Round Tube Plug	6
3	Intermediate Bracket	1	12	Carriage Bolts	1
4	Hook Stand	1	13	M10*50 Bolts	1
5	Handle	2	14	M10 Nuts	1
6	Plum Knob	2	15	Padded Board	1
7	Foam	6	16	M6*10 Bolts	6
8	Reducing Sleeve	1			
9	Round Footpad	4			

## Explosion Drawing

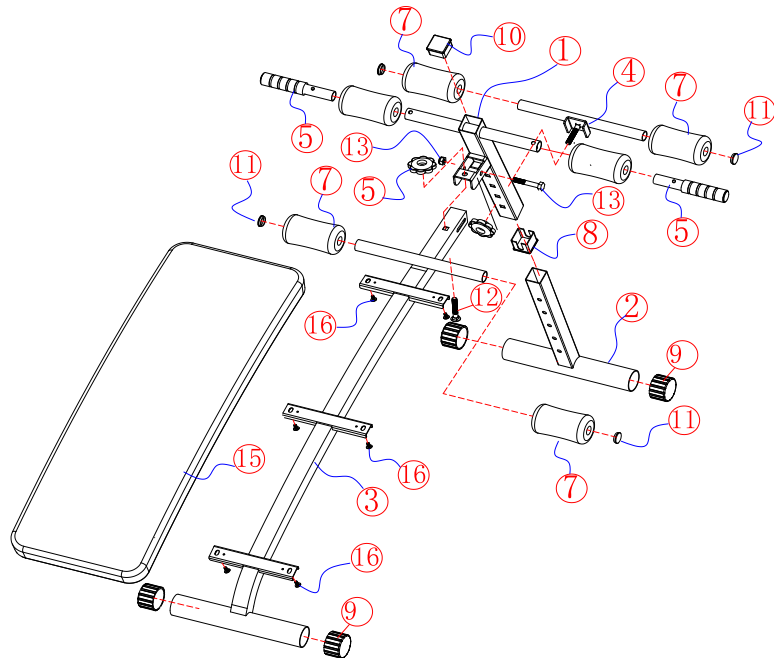

## Assembly Instruction

Take the full machine out of box, then rotate the front bracket forward as shown in the figure.

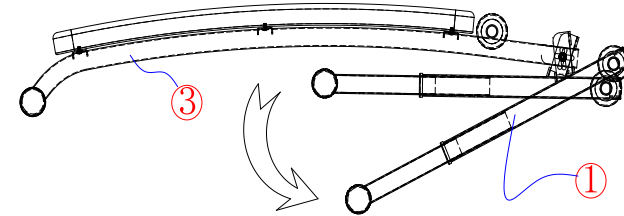

Use carriage screw (12) to pass through the front bracket and the intermediate bracket, and tighten with Plum Knob (6). Put the hook stand (4) pass through the front bracket tube (1) and the front foot tube (2) according to the height requirement, and tighten with plum knob (6). Then insert the two handles (5) into the tube (1) hole.

