



COSTWAY®



USER'S MANUAL
Heavy duty kayak rack
TL35157

THIS INSTRUCTION BOOKLET CONTAINS **IMPORTANT** SAFETY INFORMATION. PLEASE READ AND KEEP FOR FUTURE REFERENCE.

Please give us a chance to make it right and do better!

Contact our friendly customer service department for help first.

Replacements for missing or damaged parts will be shipped ASAP!

Follow Costway

Visit us: www.costway.com



Contact Us!

Do NOT return this item.

Contact our friendly customer service department for help first.



Before You Start

- ⚠ Please read all instructions carefully.
- ⚠ Retain instructions for future reference.
- ⚠ Separate and count all parts and hardware.
- ⚠ Read through each step carefully and follow the proper order.
- ⚠ We recommend that, where possible, all items are assembled near to the area in which they will be placed in use, to avoid moving the product unnecessarily once assembled.
- ⚠ Always place the product on a flat, steady and stable surface.
- ⚠ Keep all small parts and packaging materials for this product away from babies and children as they potentially pose a serious choking hazard.

DIAGRAM & PART LIST

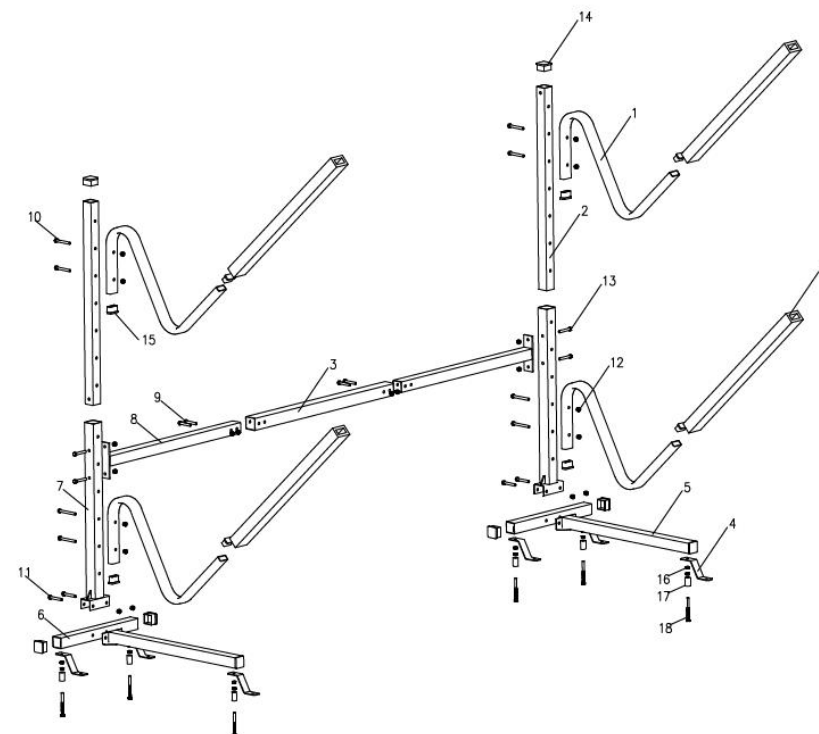

NO.	DECP.	QTY.	NO.	DECP.	QTY.
1	S tube	4	11	Bolt M8x60	4
2	Top Post	2	12	Lock Nut M8	20
3	Middle Bar	1	13	Bolt M8X75	4
4	Foot Plate	6	14	Plastic Cap 40x40	8
5	Long Foot Tube	2	15	Plastic Cap 40x20	8
6	Short Foot Tube	2	16	Nut M8	12
7	Bottom Post	2	17	Rubber Bolck	6
8	Horizontal Bar	2	18	Bolt M8x80	6
9	Bolt M8x55	4	19	Rubber Wrap	4
10	Bolt M8x70	8			

How to install?

- 1) Use Bolt (11) and Lock Nut (12) to lock Part (5)(6)(7) together as picture shown, install for both 2 sides and tighten the bolts.
- 2) Lock 3 of the Foot Plates (4) onto each side of the Foot Tube (5)(6) with Nut(16) and Bolt(18) with Rubber Wrap (19) (pre-installed). Use 2 Nut(16) to clamp the Foot Plate(4) inside so you can adjust the foot plate for balance later.
- 3) Insert the Top Post (2) into the Bottom Post (7) then lock them together with the Horizontal Bar(8) with Bolt (13) and Lock Nut(12), Make sure one Horizontal Bar mounted on the left and another mounted on the right side of the post.
- 4) Connect the 2 post with Horizontal bars together with Middle Bar(3), lock them together with Bolt (9) and Nut(12).
- 5) Based on the size of your Kayak, choose the best location of the S Tube(1), make sure one kayak stay on the bottom post and another on the top post, use Bolt(10) and Nut(12) to lock the S Tubes(1) as picture shows, make sure the partner S Tubes are on the same level.
- 6) Rubber Wrap (19) has already been installed on to the S Tubes (1), Put on the large and small Plastic Caps (14)(15) as picture shows, you may need a rubber hammer for the installation.
- 7) Check and make sure all bolts and nuts are tightened.
- 8) Choose a solid level ground to store your kayak, you can slightly adjust the Bolt (18) and Foot plate (4) to make sure each support stays on the ground firmly.
- 9) Do not overload, be aware of the wind, put the rack against the wall to make sure its storage safety.

Welcome to visit our website and purchase our quality products!

Your suggestions and comments for COSTWAY are really important to us!
We sincerely solicit you to go back to our shop and leave a good rating in just a simple click. It would be quite encouraging if you could kindly do so like below:

★★★★★ Great products so far

February 24, 2019

Great products so far. Fast delivery, easy setup, and working without any issues.

**With your inspiring rating, COSTWAY will be more consistent to offer you
EASY SHOPPING EXPERIENCE, GOOD PRODUCTS and EFFICIENT SERVICE!**

US office: Fontana, California

UK office: Ipswich



- * Reward Points
- * Exclusive Customer Service
- * Personalized Recommendations
- * Permanent Shopping Cart
- * Order History

5 Star Rating



We would like to extend our heartfelt thanks to
all of our customers for taking time to assemble
this product and giving us valuable feedbacks.

THANK
you
😊