

**COSTWAY®**

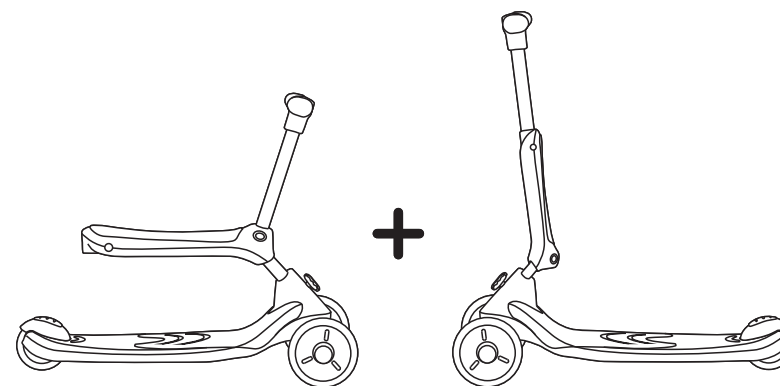

**USER'S MANUAL**  
**Kids Kick Scooter**  
**TY328062**

THIS INSTRUCTION BOOKLET CONTAINS **IMPORTANT** SAFETY INFORMATION. PLEASE READ AND KEEP FOR FUTURE REFERENCE.

**Please give us a chance to make it right and do better!**

Contact our friendly customer service department for help first.

Replacements for missing or damaged parts will be shipped ASAP!

**Follow Costway**

Visit us: [www.costway.com](http://www.costway.com)



# Contact Us!

## Do NOT return this item.

Contact our friendly customer service department for help first.



# Before You Start

Please read all instructions carefully and keep it for future reference.

### General Warnings:

- ⚠ **Danger!** Keep all small parts and packaging materials for this product away from babies and children, otherwise they may pose a choking hazard.
- ⚠ The product must be installed and used under the supervision of an adult.
- ⚠ Read through each step carefully and follow the proper order.
- ⚠ Remove all Packaging, separate and count all parts and hardware before Installation.
- ⚠ Please ensure that all parts are correctly installed, incorrect Installation can lead to a Danger.
- ⚠ We recommend that, where possible, all items are assembled near to the area in which they will be placed in use, to avoid moving the product unnecessarily once assembled.
- ⚠ Ensure a secure surface during construction, and place the product always on a flat, steady and stable surface.

## ⚠ WARNING ⚠

Protective equipment should be worn. Not suitable for children weighing more than 20 kg / 44 lbs (or 50 kg / 110 lbs).

**USE REMINDER:** Since the use of toy scooters requires good skills, toy scooters should be used with caution to prevent fall injuries and injuries to users and third parties.

When used vertically, the maximum load of this product is 50kg (110 LBS), suitable for children 3-6 years old. Use only under adult supervision.

When used in a sitting position, the maximum load of this product is 20kg (44 LBS), suitable for toddler 18-36 months old. Use only under adult supervision.

1. When children play with this product, adults must be nearby to ensure their safety.
2. It will be very dangerous when the scooter hits people or objects. Please make sure to play without obstacles.
3. Please do not use it on the uneven surface of the ramp, uneven sidewalks, ditches, near stairs, porches and places for the disabled, places near open flames and slopes, etc.
4. Do not use on roads or parking lots, otherwise it may cause traffic accidents.
5. This toy must be assembled by an adult.
6. Please be careful not to get your fingers, hair and clothes caught in the "wheel" and rotating parts.
7. This scooter only allows one child to ride.
8. Please pay attention! When braking, the brake parts will heat up.
9. Use protective equipment such as helmets, gloves, protective gear and elbow pads.
10. If the product is damaged, deformed or invalid, do not use this product.
11. Please don't put it in the rain, keep away from moisture and prevent moisture.
12. Product failure conditions may cause danger, guardians must regularly check whether the product is in good condition.
13. When using a scooter, you must ensure that all locking devices are locked.

## Parts

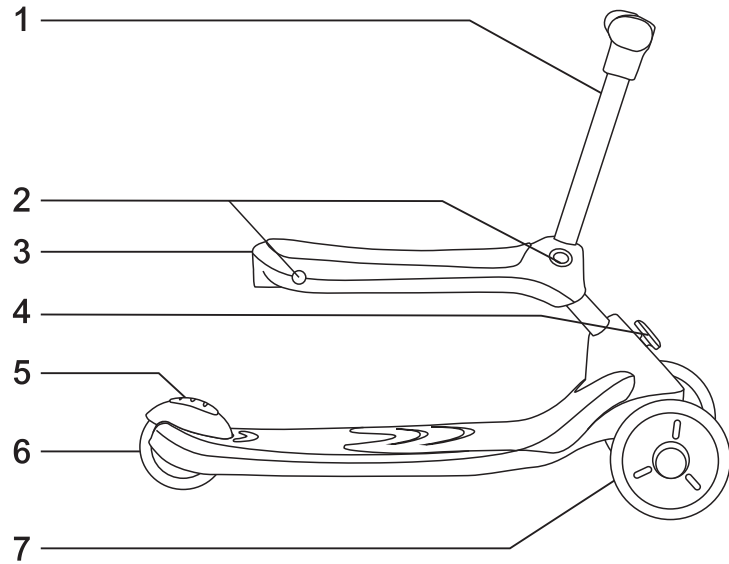

- |                          |               |
|--------------------------|---------------|
| 1.Handle                 | 5.Brake       |
| 2.Quickly Release Button | 6.Rear Wheel  |
| 3.Seat                   | 7.Front Wheel |
| 4.Screw                  |               |

## Parts

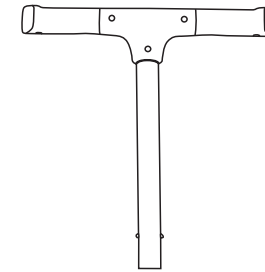

Handle



Screw

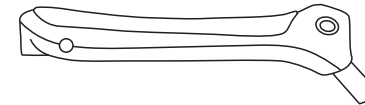

Seat

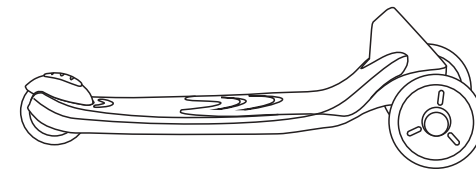

Platform



## User Instructions

### / install the seat /

/First insert the seat body sideways in the body, then lock nut.

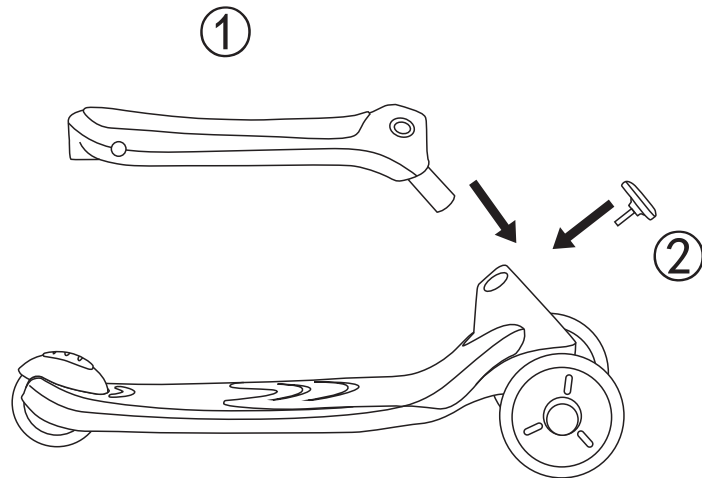

## User Instructions

### / Install and release the handle /

/Install the handle: Put the handle into the round hole of the main body until you hear a click.  
/To release the handle: Press and hold the quick release button, and then remove the handle.

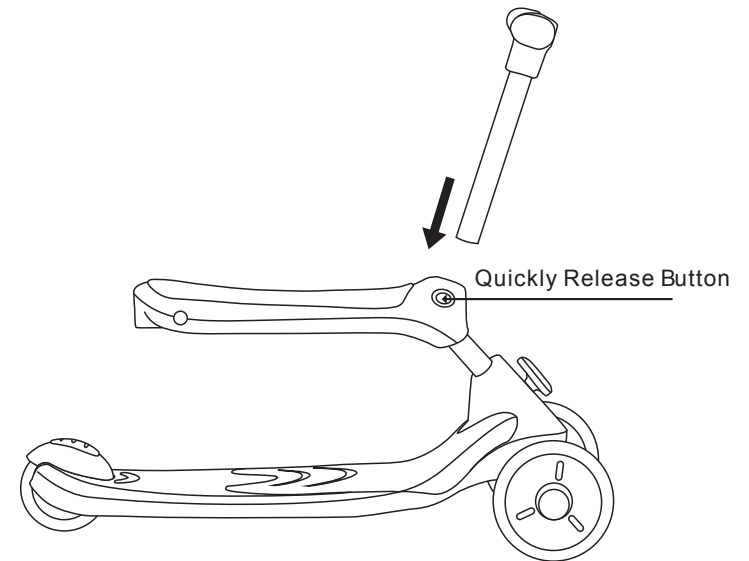

## User Instructions



### / install the seat /

/First insert the seat body vertically in the body, then lock nut.

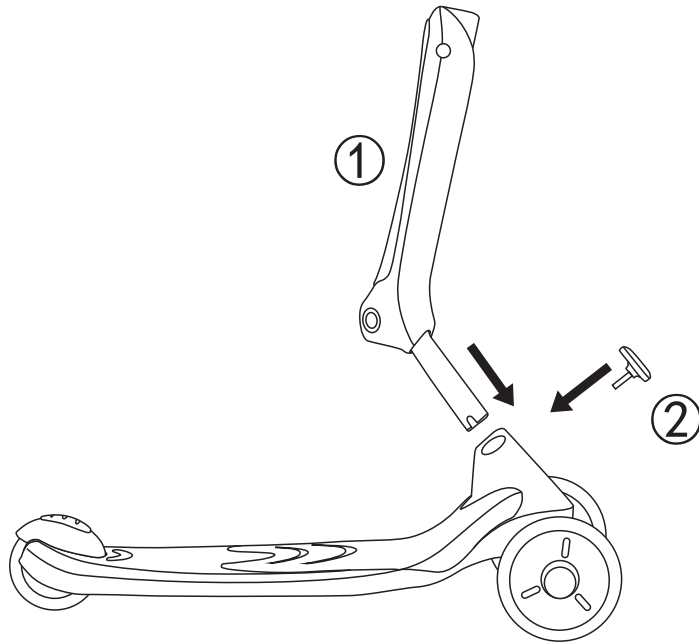

## User Instructions

### / Install and release the handle /

/Install the handle: Put the handle into the round hole of the main body until you hear a click.  
/To release the handle: Press and hold the quick release button, and then remove the handle.

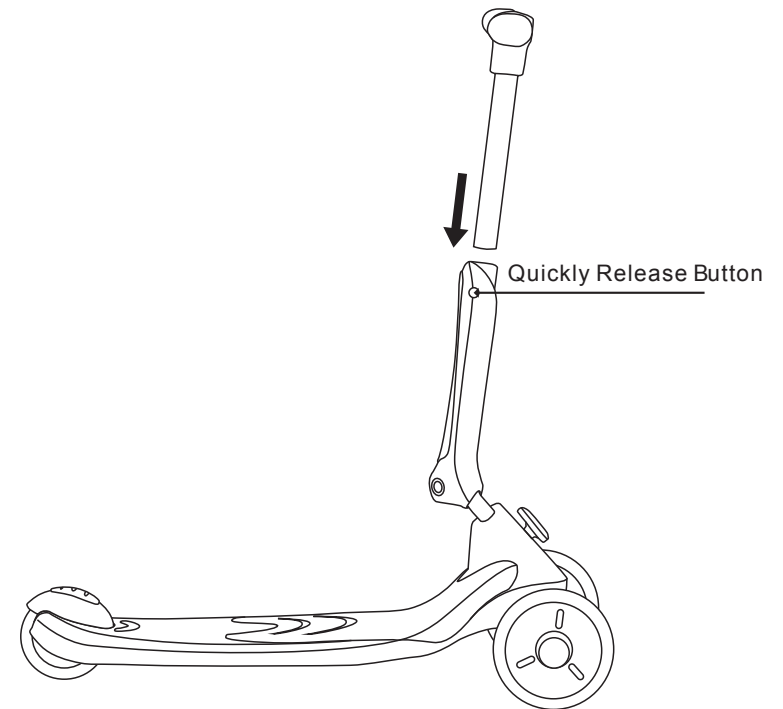

## Maintenance:

1. In order to ensure the normal use of this product and prevent accidental injuries to children, please check and maintain the scooter frequently.
2. Please regularly check whether the screws are loose and whether the parts are damaged.
3. When installing or using all parts, always check whether they are in good condition.
4. Please clean the product regularly.
5. Be careful not to rinse with water; it should be wiped with a soft damp cloth.

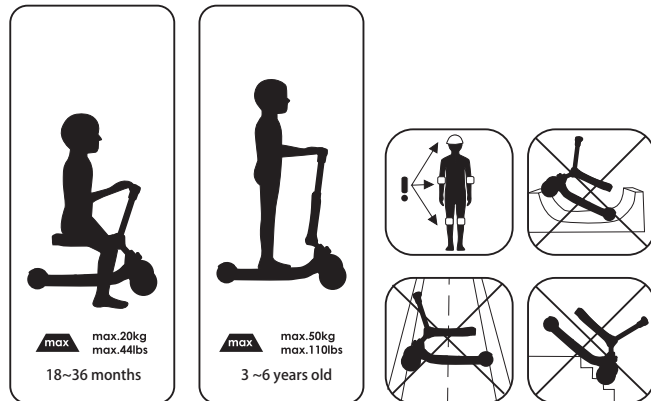

Welcome to visit our website and purchase our quality products!

With your inspiring rating, COSTWAY will be more consistent to offer you EASY SHOPPING EXPERIENCE, GOOD PRODUCTS and EFFICIENT SERVICE!

US office: Fontana, California

UK office: Ipswich



- \* Reward Points
- \* Exclusive Customer Service
- \* Personalized Recommendations
- \* Permanent Shopping Cart
- \* Order History

## 5 Star Rating



We would like to extend our heartfelt thanks to all of our customers for taking time to assemble this product and giving us valuable feedbacks.

THANK  
YOU  
(smiley face)