

PARTS LIST

- A PVC grip
- B Umbrella holder base
- C Scorecard holder
- D Handle tube
- E Push button system
- F Adjustable handle mechanism
- G Upper bag holder bracket
- H Joint
- I Connecting rods
- J Main upper frame tube
- K Leg bracket
- L 2 holes leg frame
- M 4 holes leg frame
- N Slippery connecting rods
- O Weight stabilizer
- P Anti-splay wire
- Q Right wheel locking mechanism
- Q1 Left wheel locking mechanism
- R Main lower frame tube
- S Adjustable bag elastic rope
- T Lower bag holder bracket
- U Front wheel assembly
- V Main wheel
- W Umbrella holder

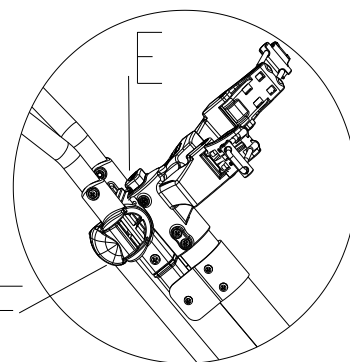
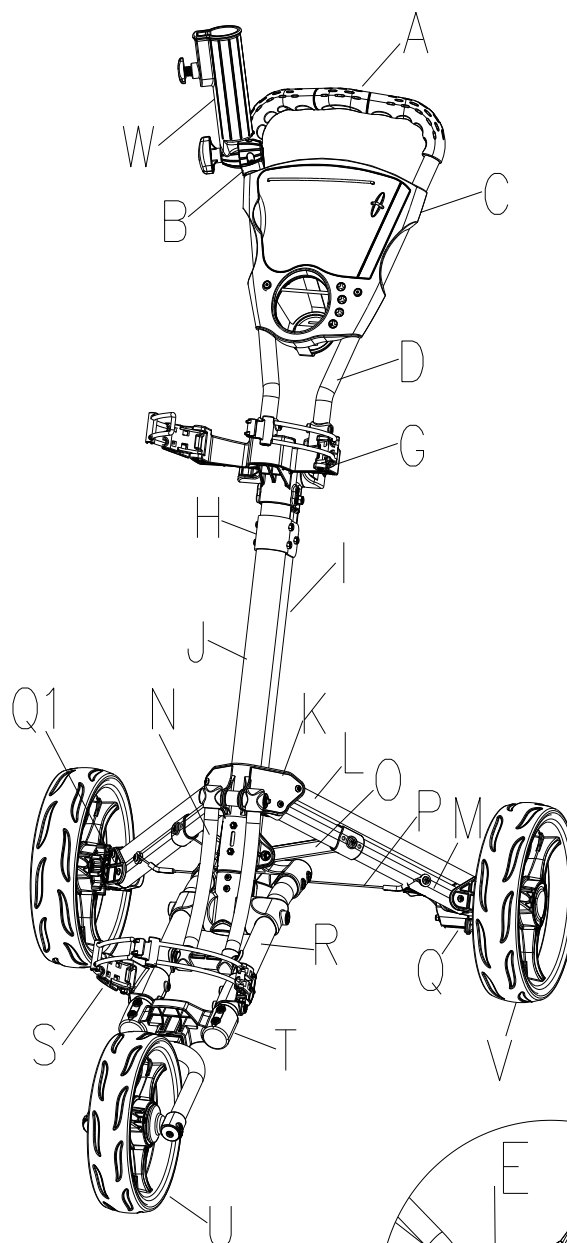

MAINTENANCE

To clean to the cart, wipe with a soft, dry cloth. Car polish may be used to maintain finish. Lubricate moving parts every 6 months.

Warning:

For your own safety, please read and understand these warnings and keep this user guide for future reference.

Always make sure the cart is fully extended and locked before use.

Always make sure the cart is folded and locked properly before lifting or transporting.

Do not run while using this product.

Do not use accessories other than those designed for use with this cart.

Keep all packing materials away from children and recycle where possible or where required by law.

338044

UNFOLDING

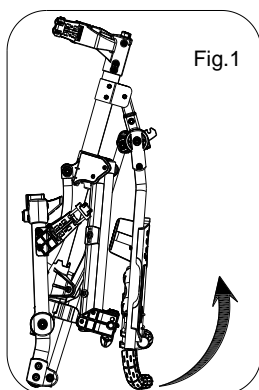

Pull the handle up until you hear the cart 'Click' as in Fig.1

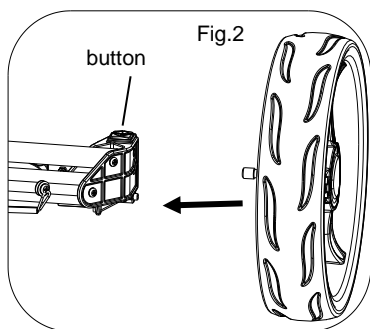

Press the red button and insert the rear wheels as in Fig.2

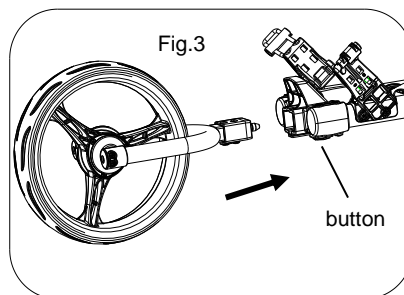

Press the red button and insert the front wheel as in Fig.3

FOLDING

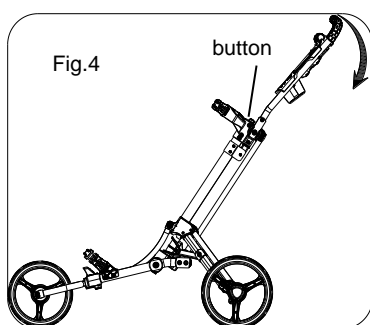

Press the red button and fold the cart in the direction of the arrow as in Fig.4

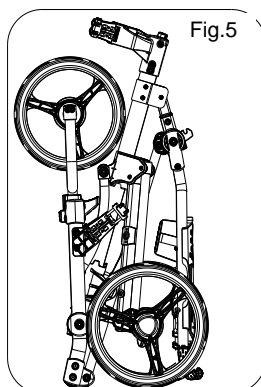
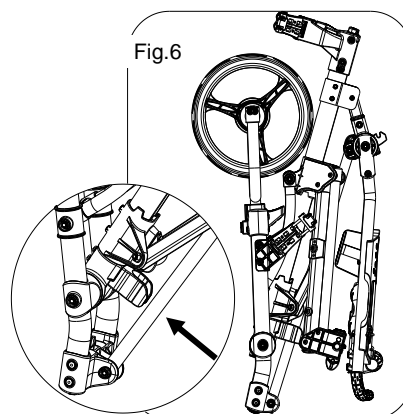
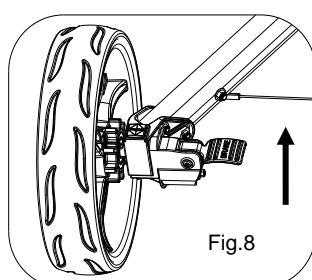
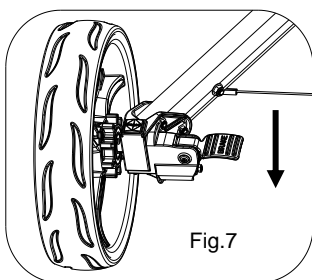

Fig.5 shows the folded position



The connecting rod will insert into the plastic bracket when folding is completed as Fig.6

Use the brake



push on the brake pedal to stop the rear wheel and pull off to release as in Fig.7 & 8.

Umbrella holder

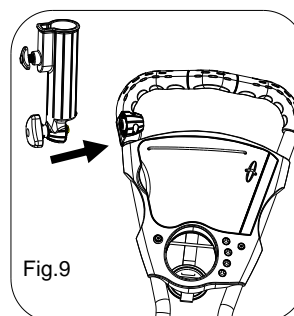

To put in use:
Simply attach the umbrella holder onto the cart as in Fig. 9

Front Wheel Adjustment Mechanism

If during use, you find that the cart alignment is off, please see the instructions below to correct this problem. In order for the cart to be perfectly aligned, the front wheel should be in the center of the fork as in Fig. 1

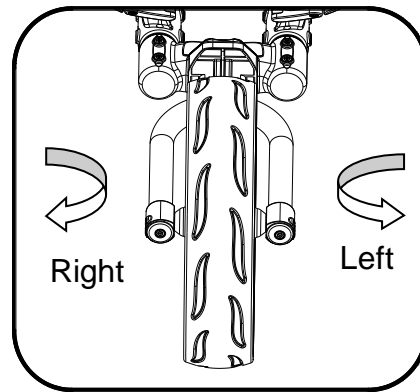

Fig .1

CART VEERING TO LEFT (Fig. 2)

If the cart veers to the left, face the front wheel and use the allen wrench provided to make the adjustments. You can either screw the left bolt clockwise, or the right bolt counterclockwise. Please continue doing so until the front wheel is centered between the front fork.

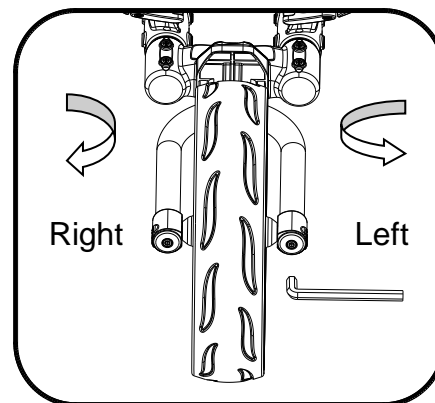

Fig .2

CART VEERING TO RIGHT (Fig. 3)

If the cart veers to the right, face the front wheel and use the allen wrench provided to make the adjustments. You can either screw the left bolt counterclockwise, or the right bolt clockwise. Please continue doing so until the front wheel is centered between the front fork.

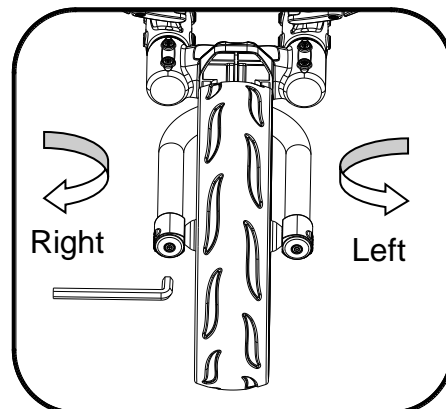

Fig .3