

COSTWAY®



USER'S MANUAL

Building Block Table HW70217

THIS INSTRUCTION BOOKLET CONTAINS **IMPORTANT** SAFETY INFORMATION. PLEASE READ AND KEEP FOR FUTURE REFERENCE.

Please give us a chance to make it right and do better!

Contact our friendly customer service department for help first.

Replacements for missing or damaged parts will be shipped ASAP!

Follow Costway

Visit us: www.costway.com



Contact Us!

Do NOT return this item.

Contact our friendly customer service department for help first.



Before You Start

Please read all instructions carefully and keep it for future reference.

Warning!

Attention: The Product is not suitable for the children under 3 years

Danger: Keep all small parts and packaging materials for this product away from babies and children, otherwise they may pose a choking hazard.



WARNING:
CHOKING HAZARD-Small parts.
Not for children under 3 years.

General Warnings:

- ⚠ The product must be installed and used under the supervision of an adult.
- ⚠ Read through each step carefully and follow the proper order.
- ⚠ Remove all packaging, separate and count all parts and hardware.
- ⚠ Please ensure that all parts are correctly installed, incorrect installation can lead to a danger.
- ⚠ We recommend that, where possible, all items are assembled near to the area in which they will be placed in use, to avoid moving the product unnecessarily once assembled.
- ⚠ Ensure a secure surface during construction, and place the product always on a flat, steady and stable surface.

INSTALLATION INSTRUCTIONS FOR THE BUILDING BLOCKS TABLE

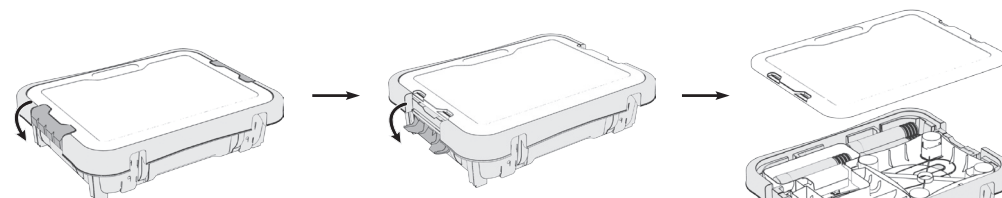

- 1 Open the two buckled ears outwards to open the table top and take out the accessories inside to be installed later.

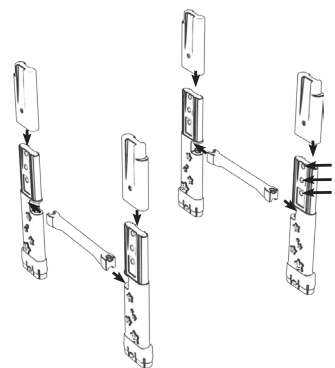

- 2 Install the table legs and links into the slots.
Three-level adjustable

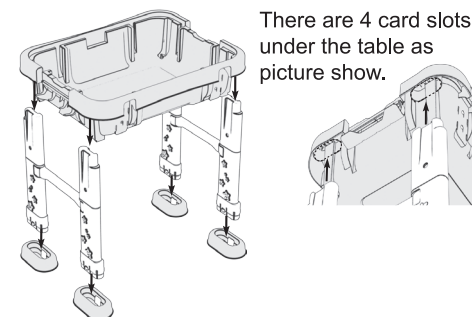

There are 4 card slots under the table as picture show.

- 3 Install the table legs, table bases and storage tank into their corresponding slots. There are four slots in the reverse of the table.

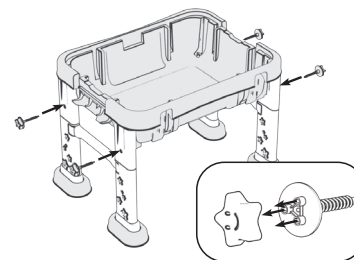

- 4 Take out four big screws and rotate them to fix the table legs and storage tank.

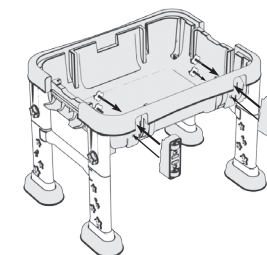

- 5 Pass the small screws through the four holes of the storage tank and rotate them until they click, indicating the securing of the casters.

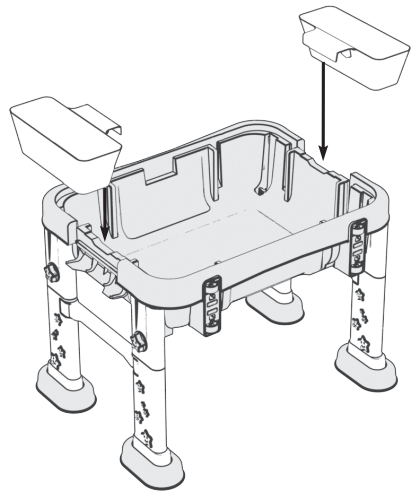

- 6** Hang two receivers on both outer sides of the storage tank.

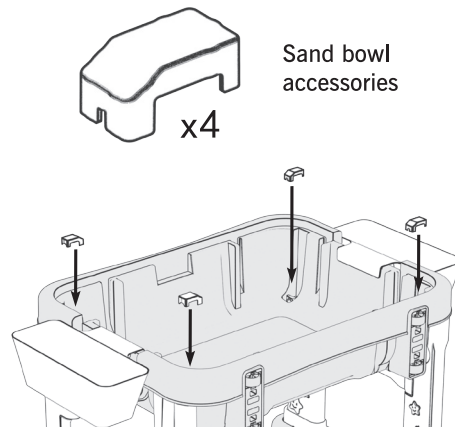

- 7** Install accessories into the four corners to turn the storage tank immediately into a sand bowl.

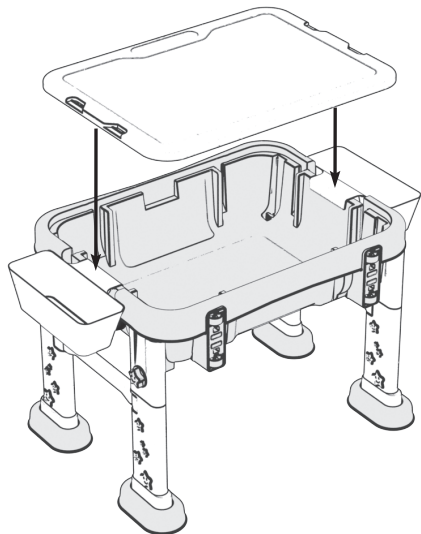

- 8** Cover the table top to finish the installation of block table.

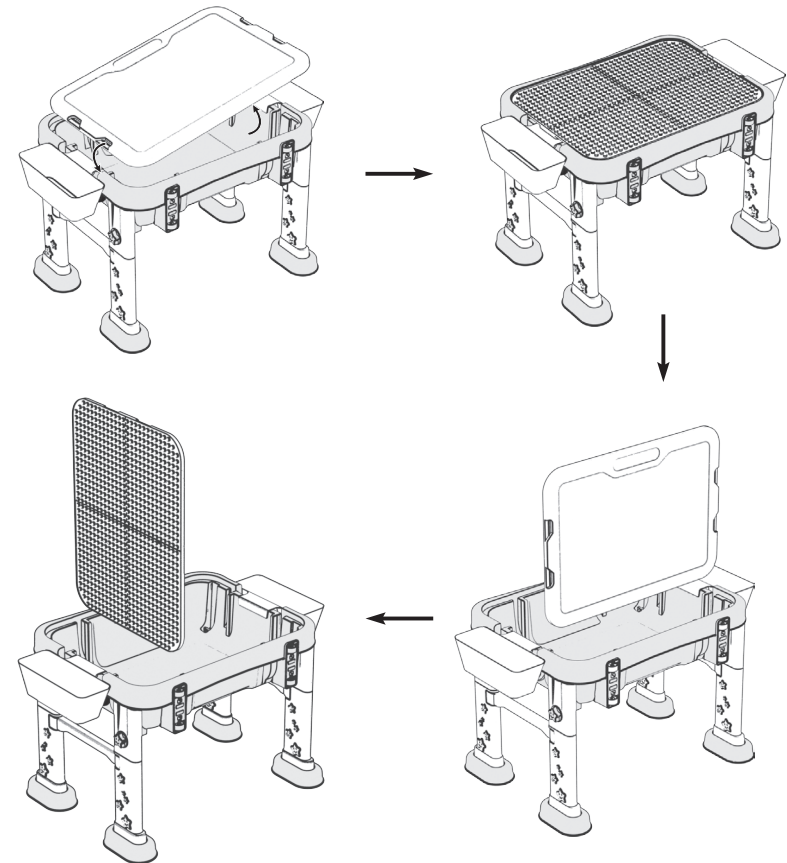

- 9** Upturn the table top to turn it immediately into a block table, and it can be installed both sideways and endways.

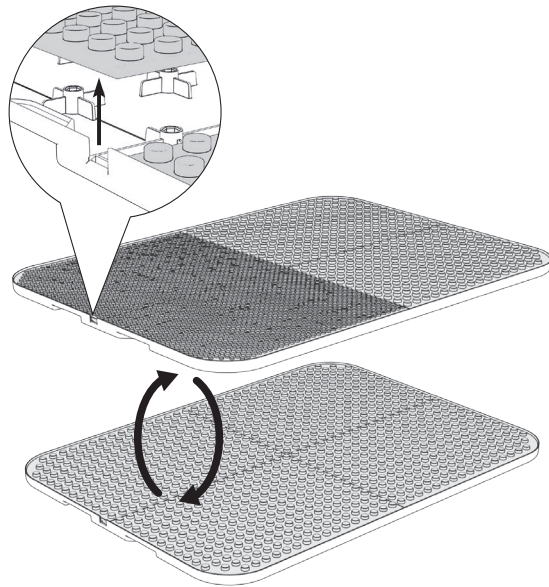

10 There is a die cut on one of the edges of the table top, which is used to change the granular soleplate.

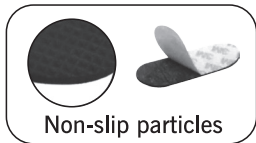

Non-slip particles

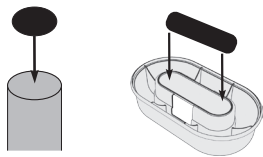

Notes: this product is equipped with a non-slip mat.
Take out the table legs and the chair bases, invert them to the reverse, tear the label off the non-slip mat and paste it as per figure.

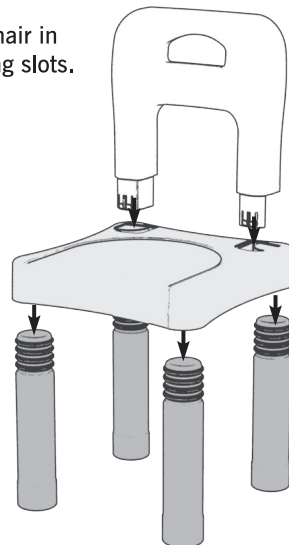

Welcome to visit our website and purchase our quality products!

Your suggestions and comments for COSTWAY are really important to us!
We sincerely solicit you to go back to our shop and leave a good rating in just a simple click. It would be quite encouraging if you could kindly do so like below:

★★★★★ Great products so far

February 24, 2019

Great products so far. Fast delivery, easy setup, and working without any issues.

With your inspiring rating, COSTWAY will be more consistent to offer you EASY SHOPPING EXPERIENCE, GOOD PRODUCTS and EFFICIENT SERVICE!

US office: Fontana, California

UK office: Ipswich



- * Reward Points
- * Exclusive Customer Service
- * Personalized Recommendations
- * Permanent Shopping Cart
- * Order History

5 Star Rating



We would like to extend our heartfelt thanks to all of our customers for taking time to assemble this product and giving us valuable feedbacks.

THANK
you
😊