

INSTRUCTION MANUAL

IMPORTANT! KEEP THE INSTRUCTION FOR FURTHER REFERENCE

ITEM NUMBER BB4822

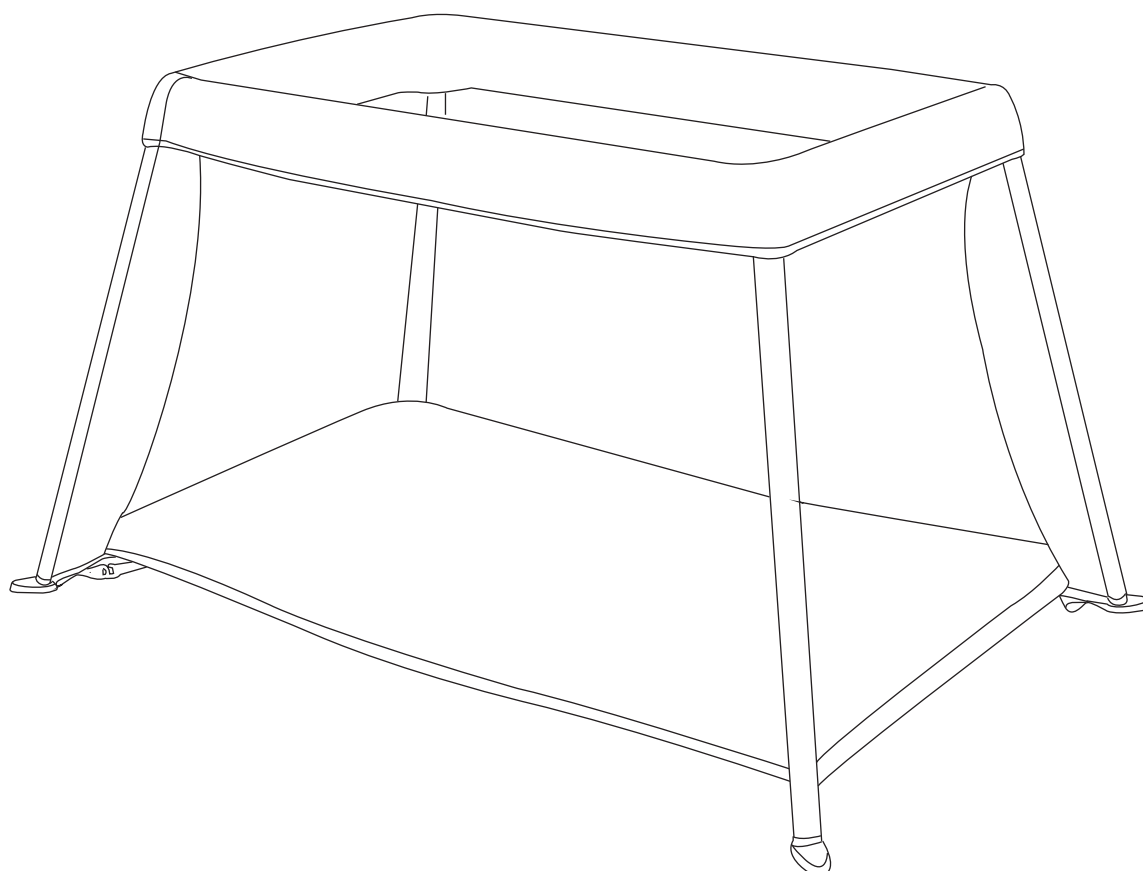

Dimensions

85CM(L)X55CM(D)X66CM(H)

Suitable from birth to 36 months, up to 15kgs

Important-Please read the instruction fully before starting assembly



Safety Information

Important-Please read the instruction before assembly and keep it for further reference



WARNING

BEFORE ASSEMBLING THIS COT, READ AND UNDERSTAND THE FOLLOWING INSTRUCTIONS

WARNING: Mattresses are included and are designed specifically for this cot.

WARNING: Do not use more than one mattress in the cot.

WARNING: Do not use any mattresses other than the ones supplied by the manufacturer.

WARNING: Only use accessories recommended by the manufacturer. Never use substitute parts.

WARNING: Ensure the top rails and the base are fully locked before use.

WARNING: Stop using this cot if any parts are broken, torn or missing.

WARNING: Failure to follow the warnings and instructions could result in serious injury or death.

WARNING: Contact the manufacturer for replacement parts or instructions if they are required.

WARNING: Keep children away while assembling/disassembling the cot.

WARNING: Do not leave anything on the folding cot (such as toys) that provide a foothold.

WARNING: Do not use the cot near naked heat sources, bar heaters, open fires or exposed flames.

WARNING: Keep the folding cot clear of trailing cables and hanging cords.

WARNING: Keep medications and small items that a child could choke on, away from the cot.

WARNING: Do not use the folding cot if fabric or padding on the side rails or end rails has been bitten through.

WARNING: FALL HAZARD - To prevent falls, DO NOT use the folding cot once the infant has reached the manufacturer's maximum weight of 15kgs or a height of 85cm tall.

WARNING: The travel cot should be placed on a horizontal floor.

WARNING: Never leave your child unattended.

WARNING: When a child is able to sit, kneel or to pull itself up, the travel cot shall not be used anymore for this child.

WARNING: Do not use the body of travel cot without its frame.

WARNING: Ensure that the cot is fully erected and all the locking mechanisms engaged before placing your child in this cot.

THIS PRODUCT IS MADE IN COMPLIANCE WITH EN716-1&-2:2008+A1:2013

Please check if you have all the parts listed below before starting assembly

Supplied loose in box:

- Carry bag
- Portable cot
- Mattress pad x 1
- Leg poles x 4

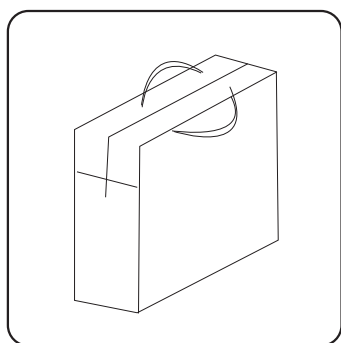

Carry bag

X 1

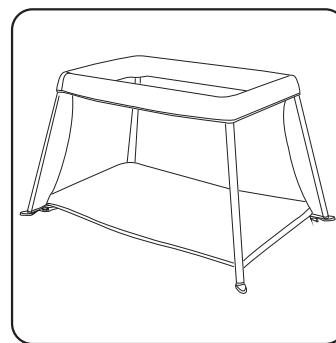

Portable cot

X 1

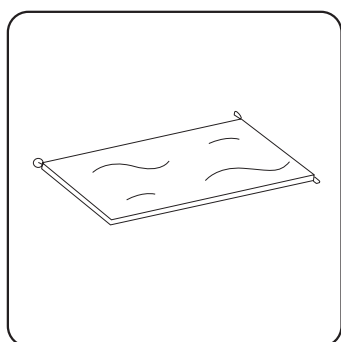

Mattress pad x 1

X 1

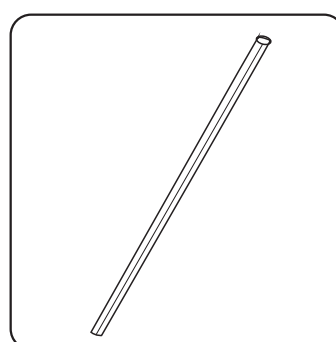

Leg poles x 4

X 4

Assembly Instructions

Step 1

Unzip the travel bag and open the mattress.

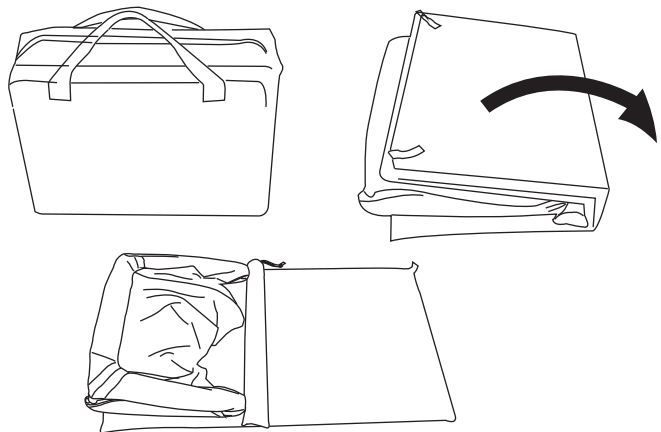

Step 2

Unfold and straighten the cot.
Ensure you hear it clicks/locks into place

Turn upside down

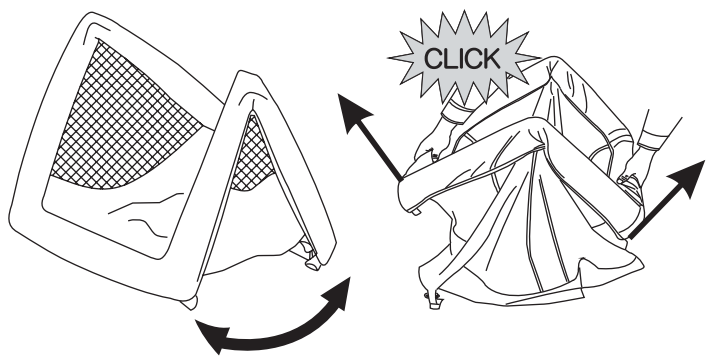

Step 3

Take out the 4 poles from the small bag.

Insert all 4 poles one by one.

Ensure the pop pins click into place.

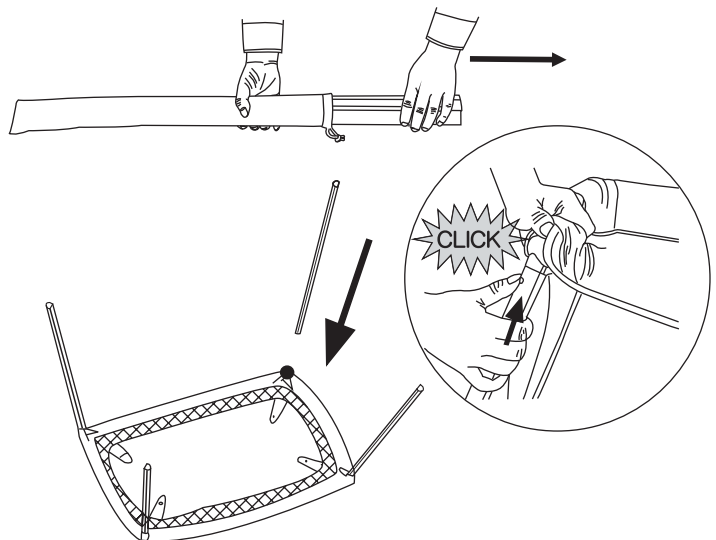

Assembly Instructions

Step 4

Attach the 4 feet into the holes of the poles.
Turn cot upright

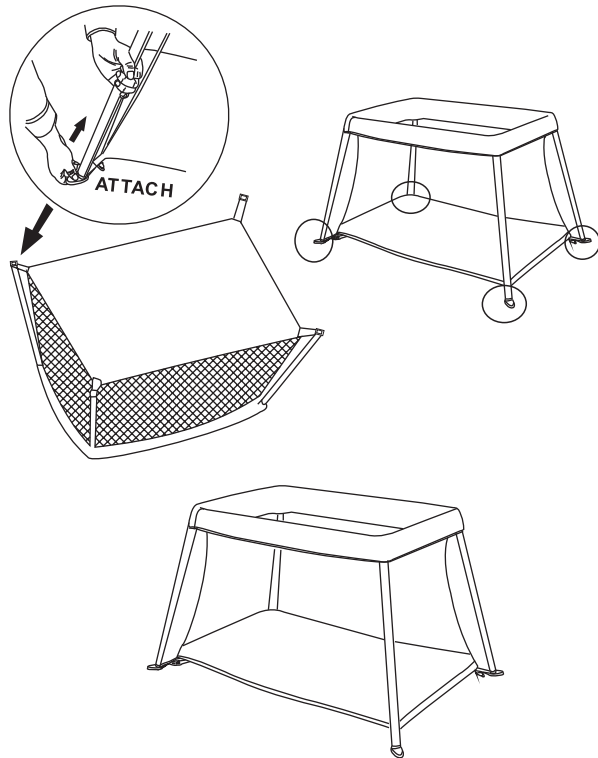

Step 5

Place mattress into the cot and then turn as per diagrams.
Find the straps under each mattress corner and pass the straps through the slit at the base of the cot.

Once done, connect them to the hook on each foot.

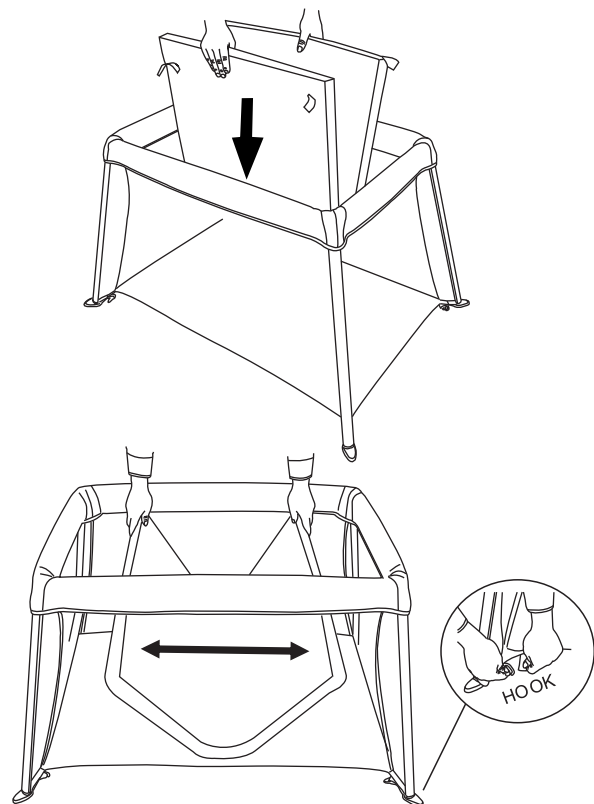

Note - The cot is ready for use, but only when the locking mechanisms are engaged. Check carefully that they are fully engaged before using the cot

Packing up the cot

Step 1

Unhook the mattress straps from each corner.
Fold the mattress in half.
Turn and lift the mattress from cot base.

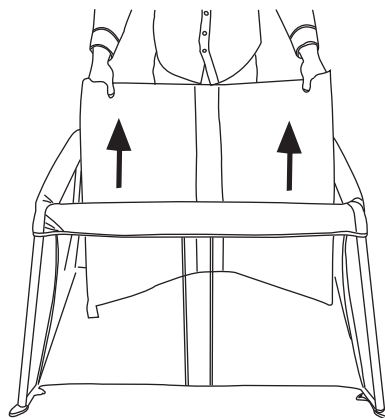
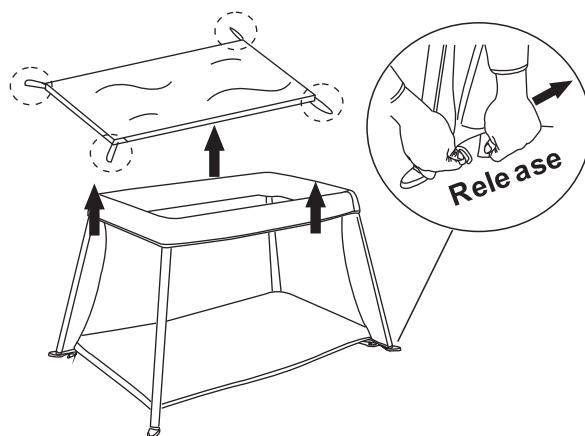

Step 2

Turn cot upside down.
Detach feet from poles on each corner.

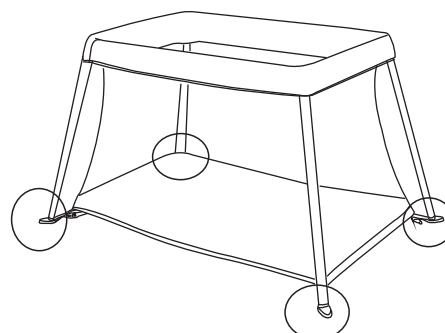
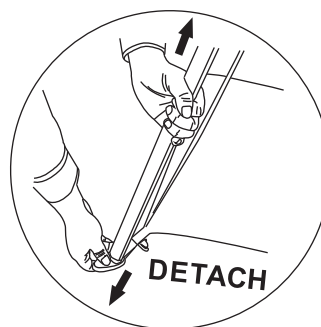

Packing up the cot

Step 3

Push in the release pin and remove the poles.
Place the 4 poles into the small bag.

Then turn cot upright.

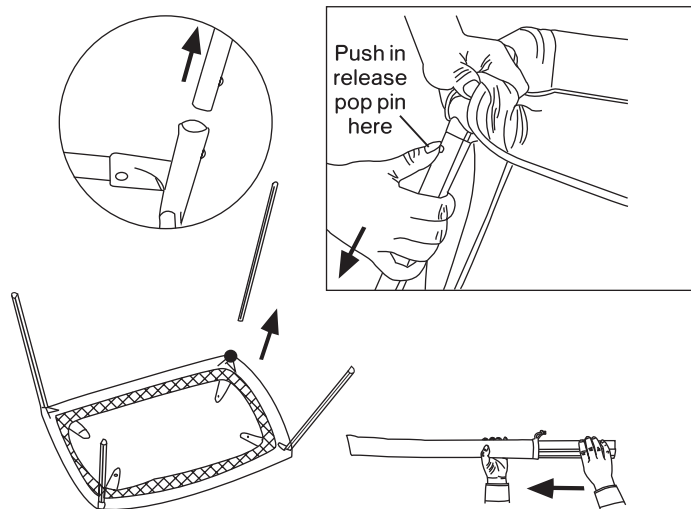

Step 4

Push the release buttons (in the middle of the long top rail) to unlock the cot and fold it in half.

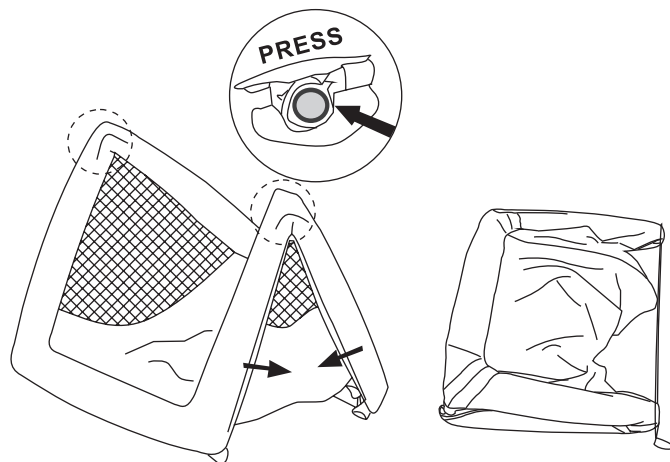

Step 5

Place frame and poles onto mattress, fold mattress into a U-shape and place into carry case .

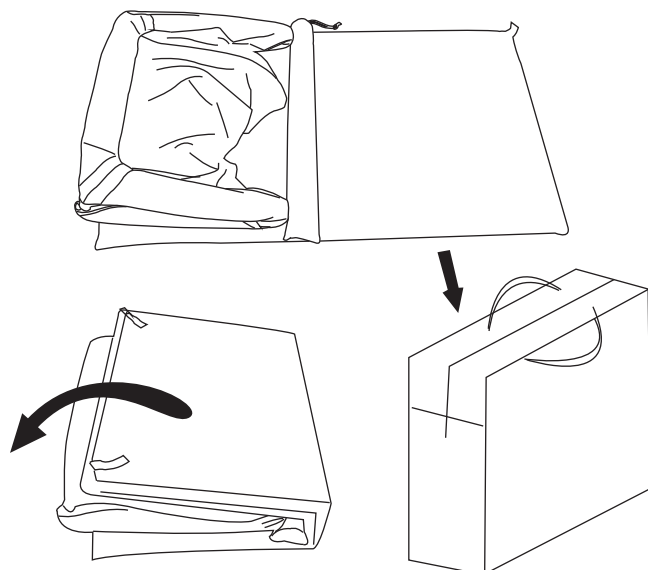

Care and Maintenance

Your child's safety is your responsibility

To clean the mattress base and travel cot fabric wipe it using a mild detergent and water. Never clean with abrasive, ammonia based, bleach based or spirit type cleaners. The travel cot must be dried thoroughly before use or storage.