

Care and Maintenance

This appliance is for household use purpose, there are no user serviceable parts inside. Do not try to open or change the parts by yourself.

Clean feet before use and use clean and soft water. Deposit will clog air jets and undermine the bubble effect

Drainage: After using, turn off the machine, to be sure the unit are unplugged then drainage

Clean: Rinse out with water, if there is any dirt on the strainer/medicine box, take the strainer out and remove the dirt, rinse out with more water. Never immerse the entire unit into water.

Storage: Before storage, please wipe off any residual moisture with the dry cloth or towel to avoid mold, then store it in a flat, clean and dry place.

Product Features

Automatic rotary massage: It can rotate automatic to stimulate the foot acupoints to relieve fatigue.

Kit: It can enhance the effect of foot bath when putting the medicinal herb

Temp.: Each press will reduce or increase 1°F, it can be adjusted from 86-119°F.

Handle: Make it more convenient to move and lift.

Pipe: Drainage pipe design, it can drain water through it which is more simple convenient

Universal wheels: Portable to move the product.

Heating: It uses PTC heater, to control and operate effectively a comfortable water temp

Timing: It can adjusted from 10-60mins. (30mins is the best working time)

Bubble: It can produce gas waves and generate water resonance, to stimulate the foot acupoints, to achieve the effect of soft massage

Safety Instructions

- ① If the liquid leaks from the machine, please do not use it so as to avoid electric shock.
- ② Do not trample deliberately on the machine and it is strictly prohibited to stand on it in order to avoid damage to the machine or cause electric shock and scalds.
- ③ Please do not move it during usage. Do not touch or pull the plug by wet hands
- ④ Please stop to use it if any parts or plug is broken. The power cables cannot be replaced or repaired and replace the entire unit if damaged
- ⑤ Please do not pull the water over 108°F directly into the foot spa. In order to avoid scald or deformation of product shape
- ⑥ The product can not be used in any liquid or water.
- ⑦ Do not use it on an empty stomach, drinking, after a big meal or an intense exercise
- ⑧ Person who is insensitive to heat, children and disabled must pay specially attention to use it, and under the care of normal adults
- ⑨ Pregnant women are prohibited to use the device
- ⑩ If you are receiving medical treatment or any of the following cases, please consult your doctor and use it in accordance with doctor's order.
Diabetic, severe hypertension, apoplexy, insensitive to heat, have difficulty getting about, hepatopath, injury to the foot, funicle, tumour, dermatosis, infectious, adenomyphitis, hematological disease, fracture and joint dislocation, cardiac pacemaker, A leg with a prosthesis or metal

◇ Thank you for purchasing our foot spa massager!
Please read the user manual carefully before using and pay special attention to safety instructions for proper operation.
This manual provides users with safe and efficient approaches of operation, so please properly retain it for future reference and inquiries after reading

Product Components

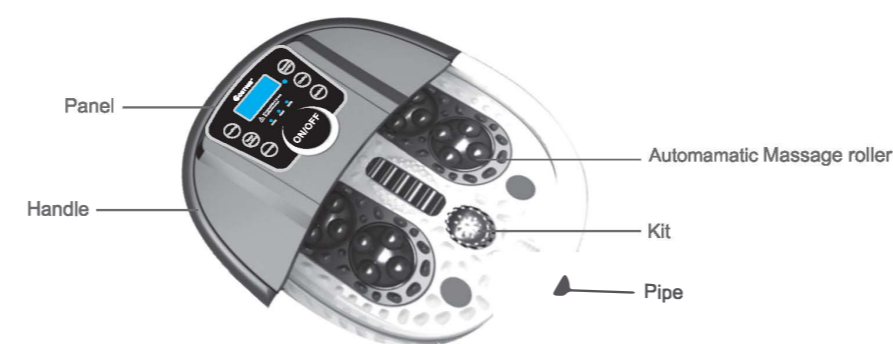

Kit: It can enhance the effect of foot bath when putting the medicinal herb in foot spa
▲ Notice: Please clean up the herbal medicine in time so as not to block the bubble hole.

Control Panel



Indications Of Buttons.

- All functions (bubble, massage and heating) will be turned on automatically at boot (Press ON/OFF BUTTON to boot)
- **ON/OFF Button:** Press once to start all functions under standby. The default working time is 60mins, default temp is 108°F, default power is 500W; press again to shut off.
 - **Heating Button:** After press the button of "ON/OFF", press "Heating" button once to close heating function, and press again to active the heating function
 - **Temp Setting Button:** Press once to display the current temp settings, each press will reduce or increase 1°F, it can be adjusted from 86-119°F.
 - **Massage Button:** After press the button of "ON/OFF", press once to close massage function, and press again to active the massage function
 - **Frequency Conversion Button:** After press the button of "ON/OFF", the power can be adjusted from 500W to 300W.
 - **Timing Button:** It displays the current remain time of work, each press will reduce 10mins, it can be adjusted from 10 - 60 minutes
 - **Bubble Button:** After press the button of "ON/OFF", press once to close bubble function, and press again to active the bubble function

Use Steps

- ① The unit should be positioned on a flat, balanced ground before use.
- ② Choose a comfortable chair to sit on while using the Foot Spa.
- ③ Fill Spa with "warm water" to water level (Before turn the machine on); during winter, warm water (of about 38°F) can be used in order to shorten the heating period.
- ④ Plug in and turn on the machine.
- ⑤ Set the timing on Count Down.
- ⑥ Set the temperature what you want.
- ⑦ Place feet in water, move your feet properly during foot bath massage (20-30 minutes is suggested), please do not close to the heating tub when moving your foot to avoid burns
- ⑧ Turn off the machine, to be sure the unit are unplugged then drainage.
- ⑨ Rinse out with water, if use essential oil or sea salt.
- ⑩ Please wipe off any residual moisture with the dry cloth or towel to avoid mold
- ⑪ Store it in a flat, clean and dry place

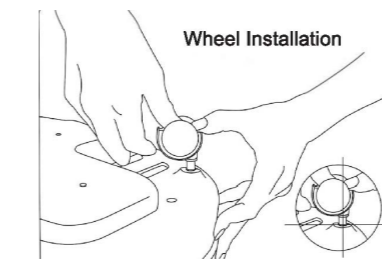

ATTENTION
Please place the foot spa massager upside down, then put the wheel vertically to the entrance of the hole and press into the hole.

Technical Parameters

Product Name	Foot Spa Massager
Rated Voltage	AC 110V
Rated Power	500W
Capacity	8L

Made In China