



With your inspiring rating, COSTWAY will be more consistent to offer you EASY SHOPPING EXPERIENCE, GOOD PRODUCTS and EFFICIENT SERVICE!

Mit Ihrer inspirierenden Bewertung wird COSTWAY konsistenter sein, um Ihnen EIN SCHÖNES EINKAUFSERLEBNIS, GUTE PRODUKTE und EFFIZIENTEN SERVICE zu bieten!

Avec votre évaluation inspirante, COSTWAY continuera à fournir une EXPÉRIENCE D'ACHAT PRATIQUE, des PRODUITS DE QUALITÉ et un SERVICE EFFICACE !

Con su calificación inspiradora, COSTWAY será más consistente para ofrecerle EXPERIENCIA DE COMPRA FÁCIL, BUENOS PRODUCTOS y SERVICIO EFICIENTE.

Con la tua valutazione incoraggiante, COSTWAY sarà più coerente per offrirti ESPERIENZA DI ACQUISTO FACILE, BUONI PRODOTTI e SERVIZIO EFFICIENTE!

Dzięki twojej opinii COSTWAY będzie mógł oferować jeszcze WYGODNIEJSZE ZAKUPY, LEPSZE PRODUKTY i SPRAWNIEJSZĄ OBSŁUGĘ KLIENTA.

US office: Fontana

UK office: Ipswich



DE office: FDS GmbH, Neuer Höltigbaum 36, 22143 Hamburg, Deutschland

FR office : 26 RUE DU VERTUQUET, 59960 NEUVILLE EN FERRAIN, FRANCE



USER'S MANUAL
Oil-filled Radiator
EP24919US

SAFETY TERMS USED IN THIS MANUAL

-  **Danger:** Indicates an imminently hazardous situation, which if not avoided, will result in death or serious injury.
-  **Warning:** Indicates a potentially hazardous situation, which, if not avoided, will result in death or serious injury.
-  **Caution:** Indicates a potentially hazardous situation, which, if not avoided, could result in death or serious injury.
- Notice:** Addresses practices not related to personal injury, such as product and/or property damage.

CONSUMER SAFETY INFORMATION

-  **Warning:** If the information in this manual is not followed exactly, an electric shock or fire may result causing property damage, personal injury or loss of life.
- Notice:** Do not store or use gasoline or other flammable vapors and liquids in the vicinity of this or any other appliance.
- Notice:** For Household use only.
- Notice:** Read all instructions before use.

PRODUCT SPECIFICATIONS

Voltage	Frequency	Wattage (Max)	Max. Amperage
120 V~	60 Hz	1500W	12.5A

IMPORTANT INSTRUCTIONS

When using electrical appliances, basic precautions should always be followed to reduce the risk of fire, electric shock, and injury to persons including the following:

READ ALL INSTRUCTIONS BEFORE USE.

1. Keep the product out of the reach of children and pets. This product is not intended for use by children. Extreme caution is necessary when any heater is used near children or the physically challenged and whenever the heater is left operating and unattended.
2. Do not let bare skin touch hot surfaces, as heater is hot! To avoid burns, use the handle when moving this heater. Keep combustible materials, such as furniture, pillows, bedding, papers, clothes, and curtains at least 3 feet (0.9m) from all sides of the heater.
3. Always unplug the heater when not in use.
4. Do not use this product in bathrooms, laundry areas, or similar damp/wet indoor locations. Do not place the product where it may fall into a bathtub or other water container.
5. Do not run the power cord under carpeting or cover it with throw rugs, runners, or similar coverings. Arrange the cord away from traffic areas where it will not be tripped over.
6. To disconnect the product from an electrical outlet, turn any controls to the off position, and then pull directly on the plug to remove it from the outlet; do not pull on the power cord.
7. Do not insert or allow foreign objects to enter any ventilation or exhaust opening of the product as this may cause electric shock or fire, or damage the heater.
8. Do not block air intakes or exhaust, as this may cause a risk of fire. Do not use the product on soft surfaces, such as a bed, where openings may become blocked.
9. Do not use this product in an area where gasoline, paint, or flammable liquids are used or stored, as this product has hot and arcing or sparking parts inside.
10. Do not place the product near a bed because objects, such as pillows or blankets, can fall off and be ignited by the product.
11. Use this product only as described in this manual. Any other use not recommended by the manufacturer may cause fire, electric shock, or injury to persons.
12. Do not immerse or expose the power cord, plug, or product to water or other liquids. If the product falls into water, immediately unplug it from the electrical outlet; do not touch or reach into the water. If water or other liquids reach any internal areas of this product, permanently discontinue its use.
13. Ensure the product is unplugged from the electrical outlet and allowed to cool before relocating or cleaning it.
14. Use the heater in a vertical position only.
15. Do not place the product in or near an open window. Rain, snow, or other weather elements could cause electrical short circuits in the product.
16. Do not use outdoors.
17. To disconnect heater, turn controls to the off position, then remove plug from outlet.

IMPORTANT INSTRUCTIONS

18. Do not plug into or unplug the product from the electrical outlet with a wet hand.
19. Do not operate this product if it has a damaged power cord or plug, if it malfunctions, or if it has been dropped or damaged. This product has no user-serviceable parts. Do not attempt to examine or repair this product yourself. Only qualified service personnel should perform any servicing; take the product to an appliance repair shop of your choice for inspection and repair.
20. This appliance is not intended for use by persons (included children) with reduced physical, sensory or mental capability, or lack of experience and knowledge, unless they have been given supervision or instruction concerning use of the appliance by a person responsible for their safety.
21. Children should be supervised to ensure that they do not play with the appliance.
22. This product is intended solely for indoor, non-commercial, non-industrial use in temporarily heating rooms. Do not use this product outdoors.
23. Do not operate the product continuously. Portable electric heaters are designed for finite space heating or as a supplementary heat source. They are not intended to be main sources of heat during the normal heating season.
24. Do not hang or wall-mount the product.
25. Place the product upright on a flat, level, stable, heat-resistant surface.

WARNING: This product is equipped with a polarized plug (one blade is wider than the other blade). To reduce the risk of electric shock, this plug will fit into a polarized outlet only one way. This is a safety feature. If you are unable to insert the plug into the electrical outlet, try reversing the plug. If the plug still does not fit, contact a qualified electrician. Always plug heaters directly into a wall outlet/receptacle. Never use with an extension cord or relocatable power tap, power strip.

SAVE THESE INSTRUCTIONS

INSTALLATION INSTRUCTIONS

NOTE: It is normal for the oil to move inside the radiator when moving the product.

1. Place the product upside down on a flat, stable surface, ensuring it will not tip over.

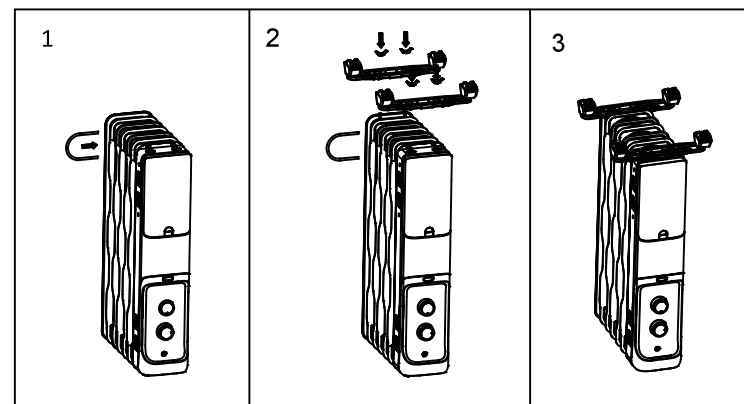

2. Remove the Wing Nuts from the U-Bolts.

3. Place a U-Bolt between the last and second-to-last Fin of the product, align the center holes in the rounded side of the Caster Bracket with the U-Bolt, and then tightly secure using the Wing Nuts (Figures 1-3).

NOTICE: Do not over-tighten the Wing Nuts.

4. Repeat Step 3 for the remaining U-Bolt/Caster Bracket between the first and second Fin, ensuring the holes in the side of the Bracket align with the protruding Bolts of the product.

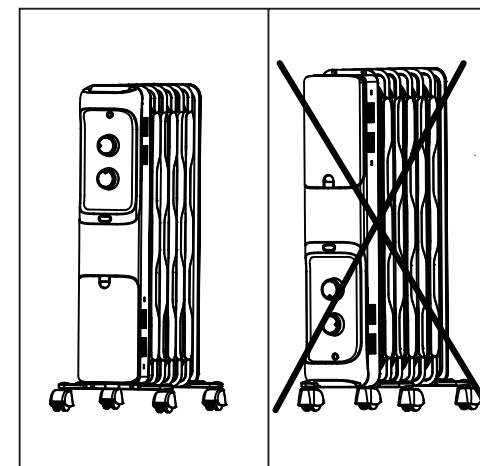

5. Set the product upright and wait at least three minutes for the oil to settle before turning on.

PRODUCT ORIENTATION

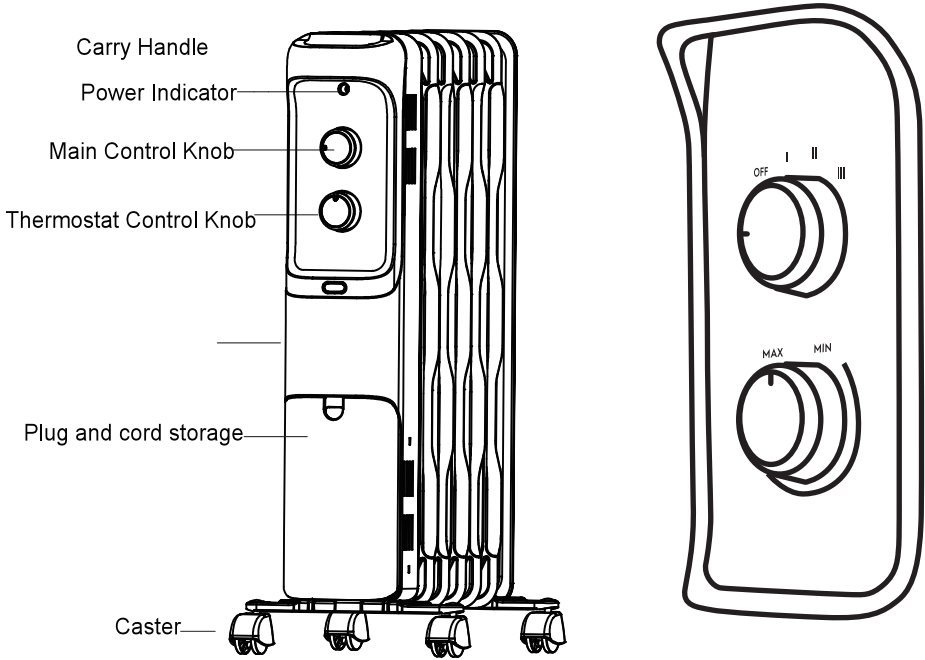

Figure A

Figure B

OPERATION INSTRUCTIONS

WARNING: Do not operate the product until fully assembled (including Casters).

1. Place the product upright on a flat, level, stable, heat-resistant surface, and then uncoil the Power Cord, removing it completely from the Cord Storage Spool. The power indicator will illuminate after plugged.
- WARNING:** Operate the product in an upright position only.
2. Turn the Thermostat Control Knob clockwise to its maximum range (Figure B).
3. Main Control Knob: Use this knob to set the heat setting (Figure B):
 - "I" – Low Heat Setting (600 Watts)
 - "II" – Medium Heat Setting (900 Watts)
 - "III" – High Heat Setting (1500 Watts)
4. When the desired ambient temperature is reached, slowly turn the Thermostat Knob back toward MIN until it clicks. The product will cycle on and off to maintain that setting.

- NOTE:** The product may emit an odor during first use; this is normal. Ventilate the area as needed.
5. Turn off the product by rotating the Main Control Knob to the "OFF" position, and then unplug the product from the electrical outlet.
- WARNING:** Always unplug the product when it will be left unattended or not in use.

SAFETY PROTECTION SYSTEMS

This product has protection safeguards that shut off the product when parts become excessively hot or if it tips over. If the product shuts off, immediately turn the Control to the "OFF" position and unplug it from the electric outlet.

If tipped over:
Place the product on a flat, level, stable surface in order to prevent the product from tipping over again.

TIP: Always install and maintain at least one smoke detector in good operating condition on each floor of your home. Periodically check and/or replace the battery in your smoke detector with a new battery.

CARE AND MAINTENANCE

- WARNING:** Do not attempt to disassemble this product for any reason, as incorrect re-assembly could cause a risk of fire or electric shock. Only qualified service personnel should perform any servicing.
- WARNING:** Always unplug the product from the electrical outlet and allow it to cool before cleaning or storing it.
- NOTICE:** This product is permanently lubricated at the factory before shipping and will not require further lubrication for the life of the product.
- Clean only the exterior surface by wiping with a soft, damp cloth, and allow the product to dry completely before storing or using. Dust can be removed from any vents using a small vacuum.
- WARNING:** Do not allow water or other liquids to enter the interior of the product.
- NOTICE:** Do not use abrasive cleaners/pads to clean the product.
- To store, wind and secure the power cord using a twist tie or rubber band, and then place the product in a cool, dry location.

TROUBLESHOOTING

PROBLEM	POSSIBLE CAUSE	CORRECTIVE ACTION
Your heater shuts off unexpectedly or fails to operate.	1. No electric power. 2. One of the safety features may have activated to prevent overheating, including the tip-over safety switch.	1. Be sure the power cord is plugged into a working electrical outlet. 2. Check your thermostat setting. The heater may be off because it has reached the desired temperature setting.