

## **USER'S MANUAL**

### **Gun Safe with Biometric Lock HW67044**

THIS INSTRUCTION BOOKLET CONTAINS **IMPORTANT** SAFETY INFORMATION. PLEASE READ AND KEEP FOR FUTURE REFERENCE.

**Please give us a chance to make it right and do better!**

Contact our friendly customer service department for help first.

Replacements for missing or damaged parts will be shipped ASAP!

**Follow Costway**



# Contact Us!

## **Do NOT return this item.**

Contact our friendly customer service department for help first.



## Before You Start

- ⚠ Please read all instructions carefully.
- ⚠ Retain instructions for future reference.
- ⚠ Separate and count all parts and hardware.
- ⚠ Read through each step carefully and follow the proper order.
- ⚠ We recommend that, where possible, all items are assembled near to the area in which they will be placed in use, to avoid moving the product unnecessarily once assembled.
- ⚠ Always place the product on a flat, steady and stable surface.
- ⚠ Keep all small parts and packaging materials for this product away from babies and children as they potentially pose a serious choking hazard.

# Features:

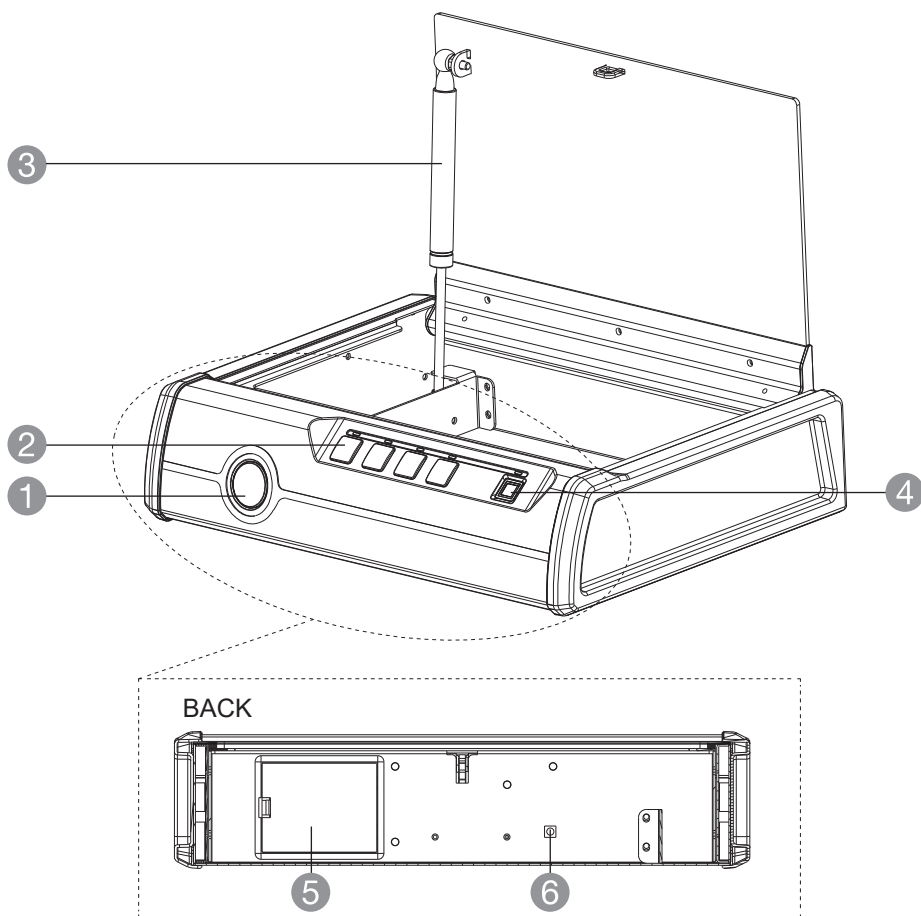

1 Emergency keyhole

4 Biometric scanner

2 Buttons

5 Battery compartment

3 Pneumatic rod

6 Reset button

# IMPORTANT SAFEGUARDS



Read these instructions carefully and retain them for future use. If this product is passed to a third party, then these instructions must be included.

When using electrical appliances, basic safety precautions should always be followed to reduce the risk of fire, electric shock, and/or injury to persons including the following:

## Battery Warnings

- Always insert batteries correctly with regard to polarity (+ and -) as marked on the battery and the product.
- Exhausted batteries should be immediately removed from product and properly disposed.

## SAVE THESE INSTRUCTIONS

### Before First Use

- Check for transport damages.
- Clean the product before first use.

**⚠ DANGER** Risk of suffocation! Keep any packaging materials away from children – these materials are a potential source of danger, e.g. suffocation.

## Opening the Safety Device the First Time

- Insert the emergency key and turn it clockwise. The safety device is now open.

## Battery Installation

- After opening the door using the emergency key, install 4 X AA batteries (not included). To install the batteries, locate the battery compartment (5). Clip in the batteries and place in the battery compartment. Pay attention to the "+" and "-" signs. Replace battery compartment cover. Repeat above steps for battery replacement.

**⚠ WARNING** Do not mix old and new batteries.

**⚠ WARNING** Do not mix alkaline, standard (carbon-zinc), or rechargeable (ni-cad, ni-mh, etc) batteries.

**⚠ WARNING** Use, care and maintenance information, as well as disposal of batteries information.

# Registering Fingerprints (Maximum Storage of 50 Fingerprints)

To register your fingerprint, locate the “Reset” button (6).

- a. Press and hold the reset button until all lights flash blue once with a beep.
- b. Press your finger to the biometric scanner, then remove your finger after the scanner light flashes blue once with a beep.
- c. Repeat step B 3 times. Then the scanner light will flash blue twice with two beeps. Now your fingerprint has been successfully registered.
- d. If the scanner light flashes red 5 times with 5 beeps, it means registration has failed and you must repeat the above steps.

## NOTICE

You cannot register more than 50 fingerprints. If the red light flashes 5 times with 5 beeps when you press the reset button, it means the fingerprint storage capacity is full.

# Deleting the Registered Fingerprint

1. Press and hold the reset button.
2. You will hear a beep together with all lights flash blue once.
3. Keep holding the reset button until you hear another two beeps with the scanner light flashes twice, then release it.
4. Now all registered fingerprints are erased.

# Programming Security Code

The safety device will accept a 4 to 6 digit code. To program your personal code locate the “Reset” button (6).

- a. Press and hold the reset button until all lights flash blue once with a beep.
- b. Enter your 4 to 6 digit personal code and press the “Reset” button again to store your new personal code.
- c. If your new personal code has been accepted, the button lights will flash blue twice and then turn off. You will also hear two audible beeps.
- d. If the button lights flash red 5 times with 5 beeps, it means the safety device failed to set the new personal code. Repeat the steps above until successful.

Please record your new personal code in a safe place.

## Opening Safety Device with Security Code

- With your correct personal code entered (factory pre-set code is 1-2-3-4), the button lights will light up blue and the safety device will automatically open. If the code is entered incorrectly, the button lights will flash red five times with five audible beeps.

## Opening Safety Device with Registered Fingerprint

- Press your registered finger to the biometric scanner, the scanner light will light up blue and the safety device will automatically open. If the fingerprint is invalid, the scanner light will flash red five times with five audible beeps.

## Entering the Wrong Code or Invalid Fingerprint

- If the wrong code or invalid fingerprint is entered five consecutive times, the safety device will go into a lock-down mode for five minutes. During this period all lights will flash red when pressing any buttons and the electronic keypad will be temporarily disabled. The safety device may still be opened using the emergency key override. After a five-minute period the safety device will automatically resume normal operation.

## Turning off the Audible Sound

- To silence the audible sound of the electronics, hold the button "1" until all lights flash blue once. To unmute the keypad, repeat above step.

## Low Battery Warning

- If the 4 AA batteries drop below the required voltage, after entering the correct personal code or valid fingerprint, the lights will light up blue once when the door is open, then flash yellow five times with five beeps.
- In this case, you will need to replace the batteries.

## Securing the Safety Device

Select a stable, dry and secure location for your safety device.

### If bolting to the concrete surface:

1. Place the safety device on the selected location. Use a pencil to mark the mounting holes on the surface.
2. Move the safety device and drill 1.6-inch- deep mounting holes (~40mm) using a 9mm drill bit.
3. Insert the plastic fasteners (included) inside the mounting holes.

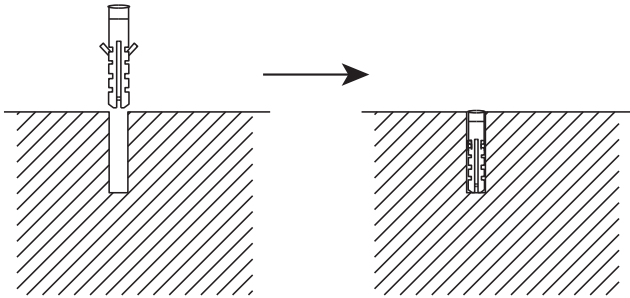

4. Move the safety device back in place, aligning the safety device over the holes. Then secure the safety device with the tapping screws (included).

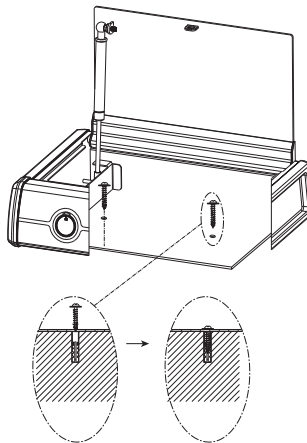

**Welcome to visit our website and purchase our quality products!**

With your inspiring rating, COSTWAY will be more consistent to offer you  
**EASY SHOPPING EXPERIENCE, GOOD PRODUCTS and EFFICIENT SERVICE!**

US office: Fontana, California

UK office: Ipswich



- \* Reward Points
- \* Exclusive Customer Service
- \* Personalized Recommendations
- \* Permanent Shopping Cart
- \* Order History

*5 Star Rating*



We would like to extend our heartfelt thanks to  
all of our customers for taking time to assemble  
this product and giving us valuable feedbacks.

THANK  
you  
😊



