



USER'S MANUAL

Kids Electric Ride on UTV Truck TQ10013

THIS INSTRUCTION BOOKLET CONTAINS **IMPORTANT** SAFETY INFORMATION. PLEASE READ AND KEEP FOR FUTURE REFERENCE.

Please give us a chance to make it right and do better!

Contact our friendly customer service department for help first.

Replacements for missing or damaged parts will be shipped ASAP!

Follow Costway



Contact Us!

Do NOT return this item.

Contact our friendly customer service department for help first.



Before You Start

Please read all instructions carefully and keep it for future reference.

Warnings:

Attention! Use it with protective equipment.

Attention! Not use it in the traffic.

Attention! The product is not suitable for the children under 3 years.

General Warnings:

- ⚠ The product must be installed and used under the supervision of an adult.
- ⚠ Read through each step carefully and follow the proper order.
- ⚠ Remove all packaging, separate and count all parts and hardware.
- ⚠ Please ensure that all parts are correctly installed, incorrect installation can lead to a danger.
- ⚠ We recommend that, where possible, all items are assembled near to the area in which they will be placed in use, to avoid moving the product unnecessarily once assembled.
- ⚠ Ensure a secure surface during construction, and place the product always on a flat, steady and stable surface.
- ⚠ Please use the product carefully, as the product requires great skill, avoid accidents by the user or others, by fall or collision.
- ⚠ Please wear suitable protective equipment during use, e.g. protective helmet, gloves, knee pads, elbow pads etc.

CHILDREN'S ELECTRONIC TOY RIDE-ON

- Suitable for 3+ Years
- Maximum user weight: 110 lbs.

**WARNING**

Must be assembled by an adult.

OWNERS MANUAL

with Assembly Instructions

Read and understand this entire manual before using!

Please keep this manual for future reference as it contains important information. Before first time use, charge the battery for at least 4-6 hours, but no more than 10 hours.

On the purchase of your new Ride-On.

This ride-on car will provide your child with many miles of riding of enjoyment. To help assure you and your rider a safe ride we ask you to please read this manual carefully, and keep it for future reference.

Follow the recommendations in this manual, they are designed to improve the safety and operation of your ride-on car and its rider.

Specification

| | |
|---------|-------------------------|
| | 12V 2WD |
| Battery | 12V10AH X1 |
| Charger | 12V900 mA |
| input | Depend on local voltage |
| Motor | 555-20000 |

- Suitable age: 3+ Years
- Charge time: 8-12 hours
- Load capacity: Under 110 lbs.
- Size of car:v 56.5” x 36.2” x 33.5”
- Speed: 3-8 km/h



BATTERY INFORMATION

- Non-rechargeable batteries are not to be recharged.
- If removable rechargeable batteries are used, the are only to be charged under adult supervision.
- Remove rechargeable batteries from the product before charging.
- Do not mix old and new batteries. Do not mix different types of batteries: alkaline, standard (carbon-zinc) or rechargeable (nickel-cadmium).
- Insert batteries as indicated inside the battery compartment, anode to anode, cathode to cathode.
- Remove batteries during long periods of non-use. Always remove exhausted batteries from the product. Battery leakage and corrosion can damage this product. Dispose of batteries safely.
- Never short circuit the battery terminals.

| NO. | PART NAME | Q'TY (PCS) | REMARK |
|-----|---------------------|------------|----------------------------|
| | | 2WD | |
| 1 | Vehicle body | 1 | |
| 2 | Driving wheel | 2 | |
| 3 | Front wheel | 2 | |
| 4 | M10 lock nut | 4 | |
| 5 | M8 lock nut | 2 | |
| 6 | Ø12 washer | 2 | |
| 7 | Ø10 washer | 4 | |
| 8 | Ø8 washer | 2 | |
| 9 | Wheel cover | 4 | |
| 10 | Ø4x12 screws | 6 | |
| 11 | Rear axle | 1 | |
| 12 | Steering wheel | 1 | |
| 13 | M5x38 machine screw | 1 | |
| 14 | Lock nut | 1 | |
| 15 | Seat back | 1 | |
| 16 | Seat | 1 | |
| 17 | Windshield | 1 | |
| 18 | Rear roll bar | 1 | |
| 19 | M10 Socket wrench | 2 | |
| 20 | M8 Socket wrench | 2 | |
| 21 | Charger | 1 | |
| 22 | Remote controller | 1 | If equipped |
| 23 | Front gear box | \ | Not shown in parts diagram |
| 24 | Split pin | 2 | |

HINT: Some parts shown are assembled on both sides of vehicle

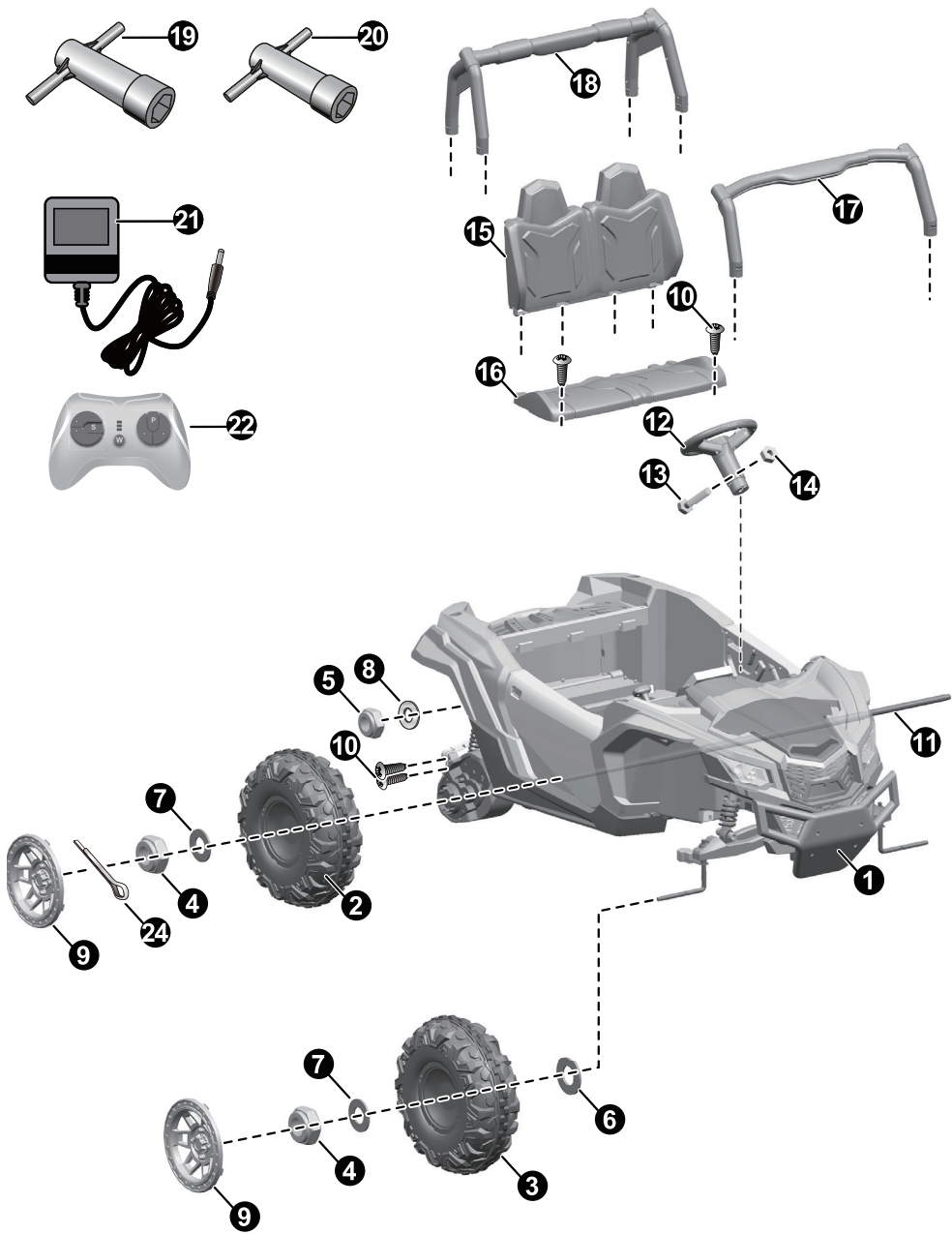

**PREVENT INJURIES AND DEATHS:**

- **NEVER LEAVE CHILD UNATTENDED. ADULT DIRECT SUPERVISION IS REQUIRED.** Always keep child in view when child is in vehicle.
- This toy should be used with caution since skill is required to avoid falls or collisions causing injury to the user or third parties.
- Protective equipment should be worn.
- Never use in roadways, near cars, or on near steep inclines or steps, swimming pools or other bodies of water.
- Always wear shoes, always sit on the seat.
- Not to be used in traffic.
- This toy is unsuitable for children under 36 months due to its maximum speed; Maximum user weight is 110 lbs.
- This toy has no brake.

**WARNING:**

- **CHOKING HAZARD!** Not suitable for children under 36 months.
- **Must be assembled by an adult.**

Rules for Safe Riding

- Keep Children within Safe Riding Areas:
 - Never use in roadway, near motor vehicles, on lawn space, on or near steep inclines or steps, swimming pools or other bodies of water;
- Use the toy only on flat surfaces. Such as inside your house, garden or playground.
- Never use in the dark. A child could encounter unexpected obstacles and have an accident. Operate the vehicle only in the daytime or a well-lit area.
- It is prohibited to change the circuit or add other electric parts
- Inspect wires and connections of the vehicle periodically.
- Do not let any child touch the wheels or be near them when the car is moving .
- This vehicle has adjustable play seat belts. Please instruct children how to tie the safety belt before using, guarantee the security.

Rear bottom View

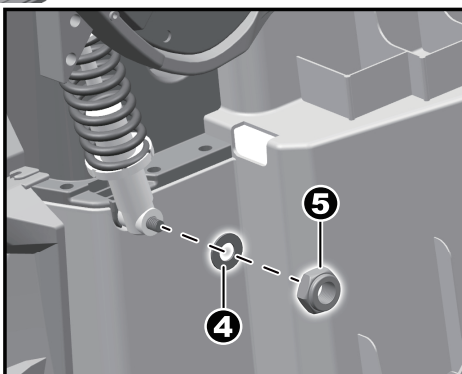
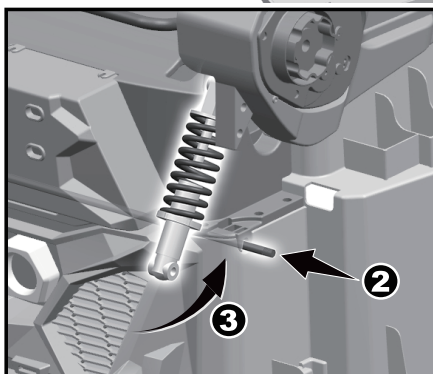
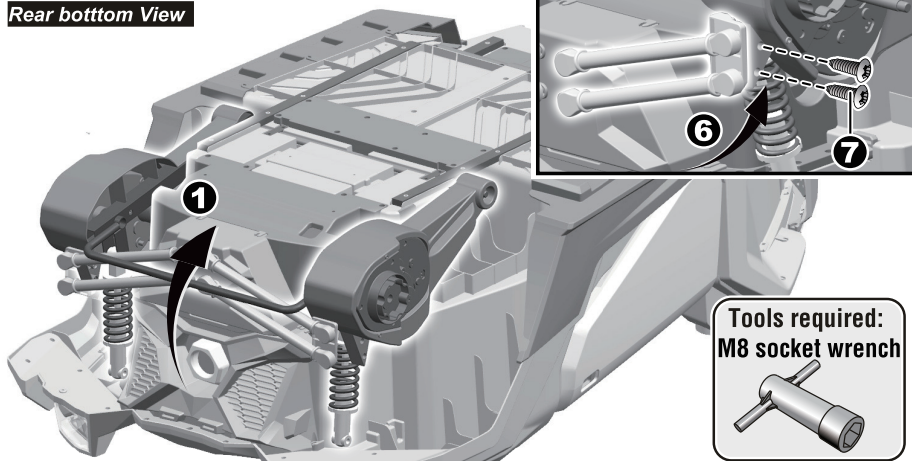

Turn the vehicle body upside down. Cut off the plastic tie on the rear gear box frame with scissors. And remove the Ø8 nut and Ø8 plastic washer from the shock axle with a M8 socket wrench.

1. Lift up the rear gear box frame.

2-3. Move the shock axle till the shock absorber can be fitted in the correct position.

4-5. Slide a Ø8 plastic washer, and tighten a Ø8 nut to the end of the shock axle with a M8 socket wrench.

Repeat steps 2-5 to attach other shock absorber.

6-7. Align the holes on the rear gear box frame with the holes on the frame linkage, insert two Ø4x12 screws and tighten with a screwdriver. Repeat for the other side.

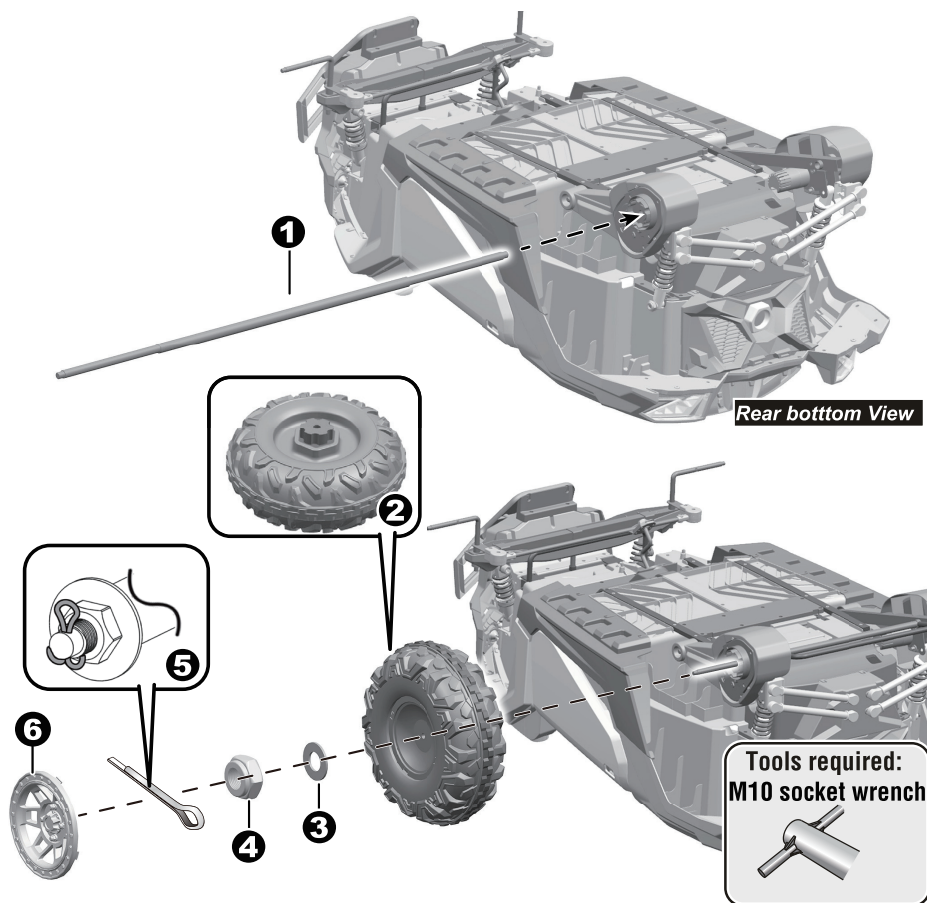

1. Insert the rear axle through the gear box on one side of the vehicle body, and out through the gear box on the other side of the vehicle body.
 2. Slide a rear wheel onto the rear axle.
 3. Slide a **Ø10 washer** onto the rear axle.
 4. Tighten a **Ø10 locknut** to the end of the rear axle with a **M10 socket wrench**.
 5. Insert a split pin into the hole on the each end of the rear axle. Bend the ends of split pins back using a long nose pliers (not included).
- Repeat for the other rear wheel.
6. "Snap" the wheel covers to the wheels.

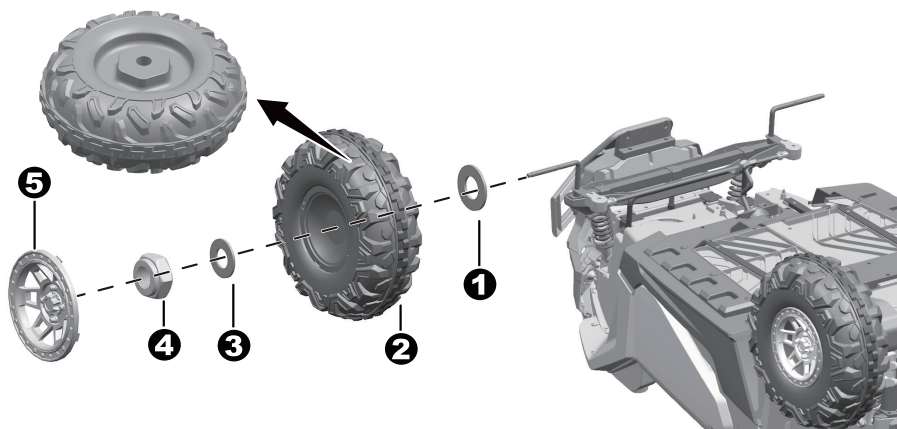
2WD*Front bottom View*

Remove all the parts from the front axle.

1. Slide a **Ø12** washer onto the front axle.
2. Slide a front wheel onto the front axle.
3. Slide a **Ø10** washer onto the front axle.
4. Tighten a lock nut to the end of the front axle with a spanner. DO NOT over tighten.
5. "Snap" the hubcap to the wheel.

Repeat the above procedure to assemble the other rear wheel.

Tools required:
M10 socket wrench



Attach the Steering Wheel & Connect the Power Supply **COSTWAY**

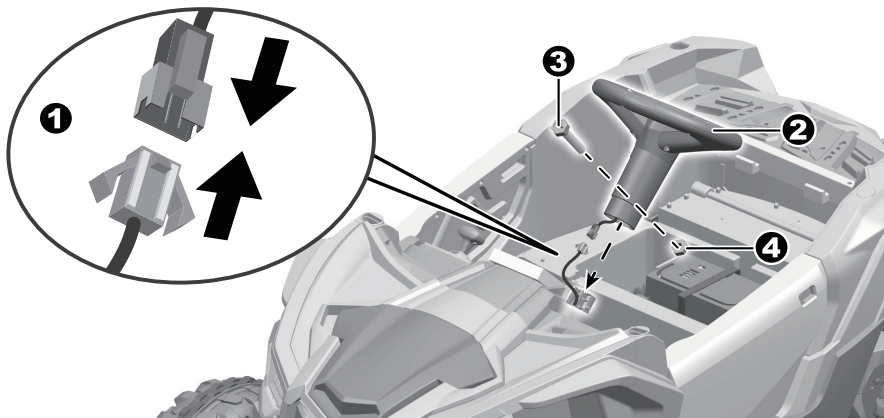

1. Plug the sound unit connector on the steering wheel into the connector on the vehicle body.
2. Fit the steering wheel to the steering wheel base on the vehicle body, and hide the plugged connectors into the steering wheel.
3. Line up the holes on the steering wheel with the holes on the steering column, insert the M5x38 machine screw.
4. Fasten a nut on the opposite end of the screw with a screwdriver.

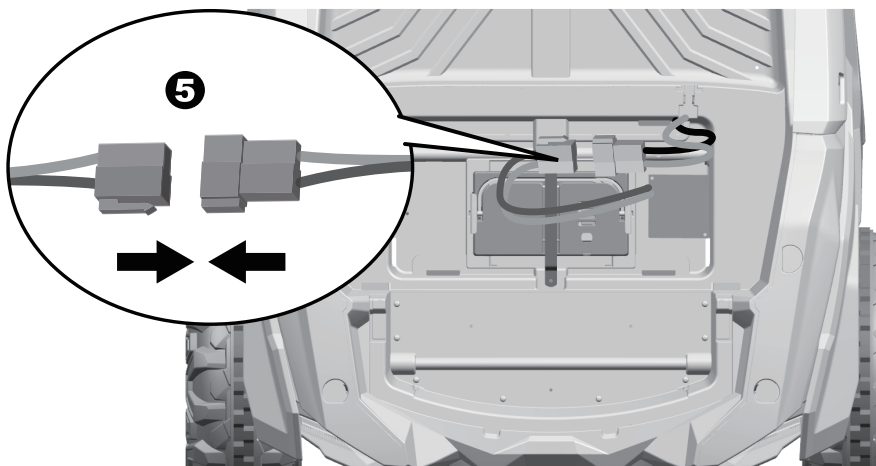

5. Plug the red connector on the vehicle body into the red connector on the battery.

1. Fit the seat back to the vehicle body.
2. Fit the seat to the vehicle body.
3. Insert the two $\varnothing 4 \times 12$ screws through the seat and into the vehicle body, tighten them with a screwdriver.

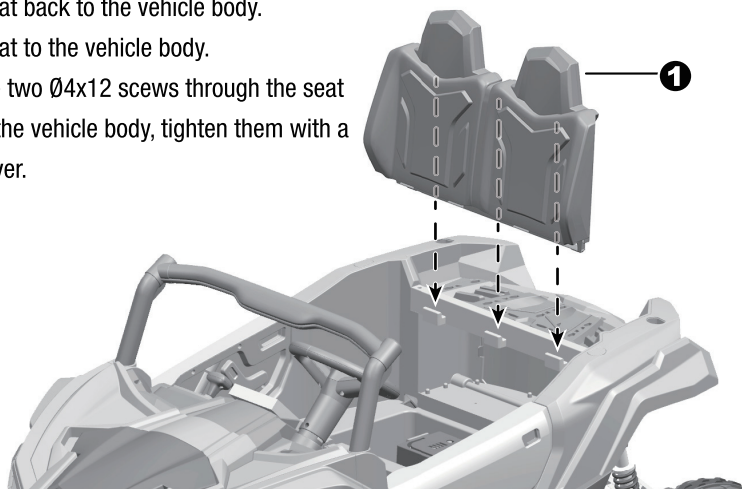

HINT: After assembling the seat, you need to connect the safety belt.

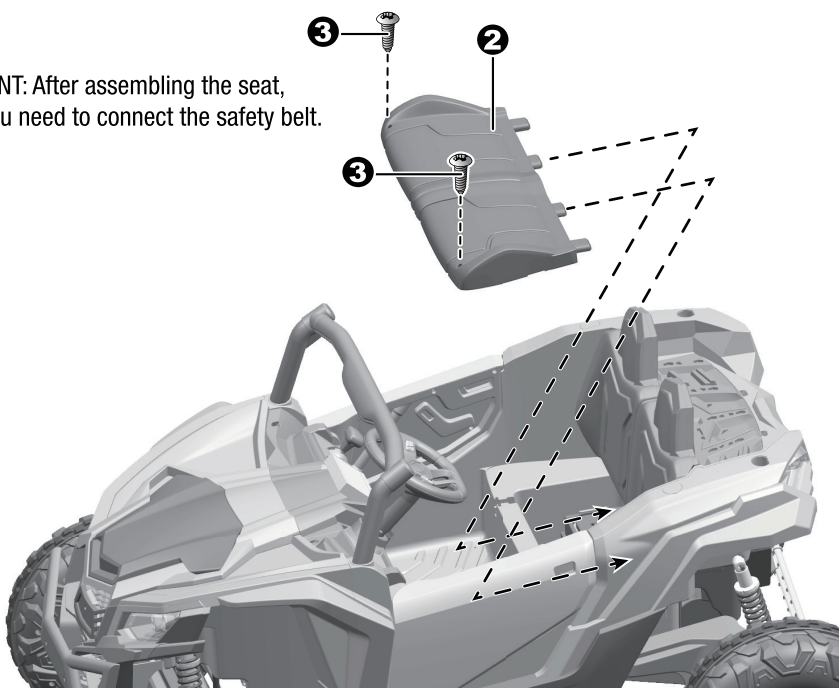

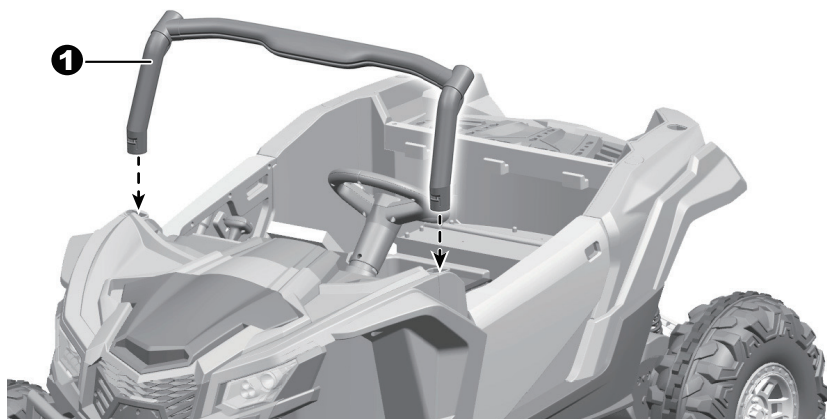

1. Insert the tabs on the windshield into the grooves on the vehicle body, push until you hear it “click” into place.
2. Insert the tabs on the hood into the grooves on the vehicle body, push until you hear it “click” into place.

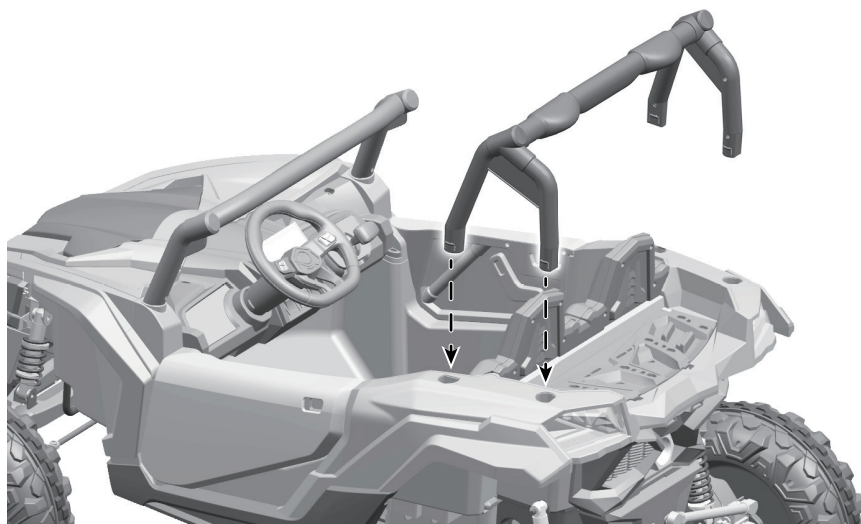

There is a door lock inside each door, you can operate it inside and outside

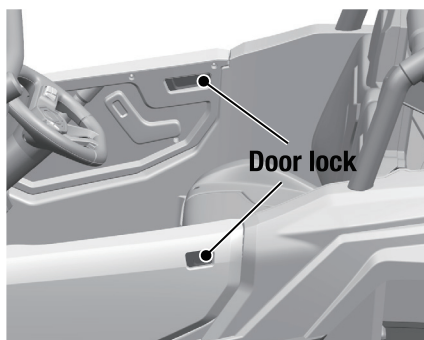

Use The Handle

1. There is a handle hidden under the rear trunk.
2. You can drag the product with the handle.

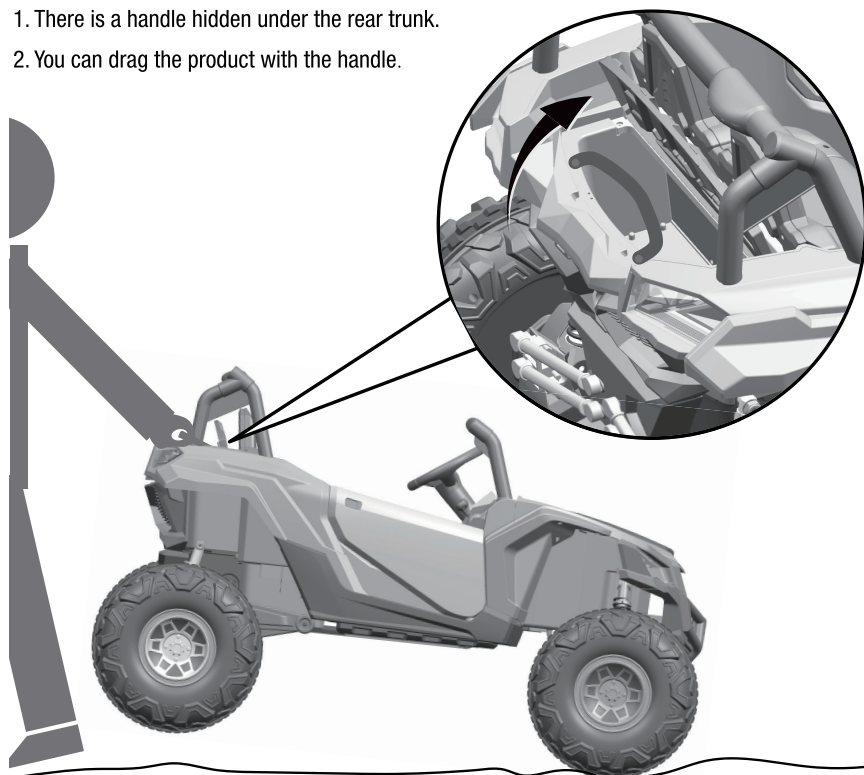

! IMPORTANT!

Always stop vehicle when changing the speed or direction to avoid damaging the gears and motor.

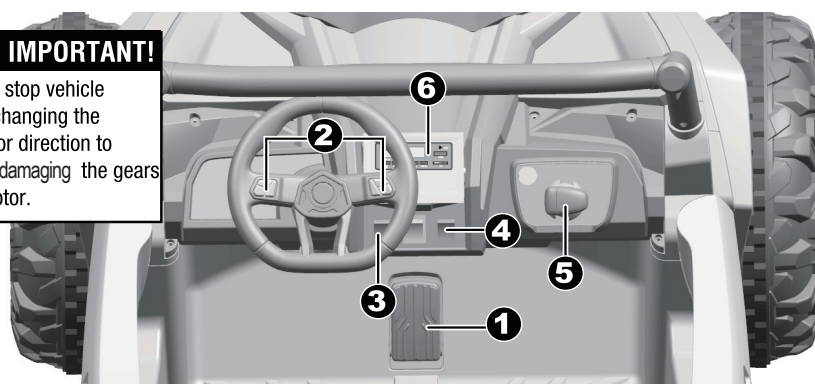

1. **Foot pedal:** • To move the vehicle, press the pedal down.
• To brake or slow down, release pressure from the pedal.
2. **Horn button:** Press for horn playing.
3. **Power switch:** Turns the vehicle on and off.
4. **Light switch:** Turns the lights on and off.
5. **High / Low speed switch:** Changes the direction that vehicle moves from forward to reverse. The vehicle equipped with 2 speeds in forward: high speed / low speed.

HINT: The vehicle is designed to operate in low speed only in reverse mode .

6. Muti-function mp3 player:

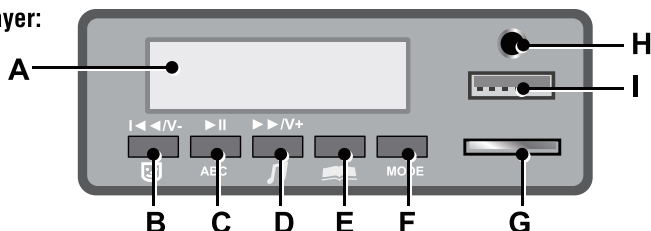

- A. **Display screen:** It displays the power level of the battery when the vehicle stops. When the numerical value is less than 12, recharge the battery please.
- B. Previous / decrease volume
- C. Play / Pause
- D. Next / Increase volume
- E. Storytelling mode
- F. Change the audio input from the FM radio (if equipped), USB, TF card , AUX and bluetooth(if equipped)
In the FM radio mode, long press button C (play/pause) for radio searching.
- G. TF card slot.
- H. 3.5mm AUX input: Allow the audio from your portable music player or phone to be played through the vehicle speakers. MP3 format ONLY.
- I. USB interface: Allow the audio from your portable device to be played through the vehicle speakers. MP3 format ONLY.

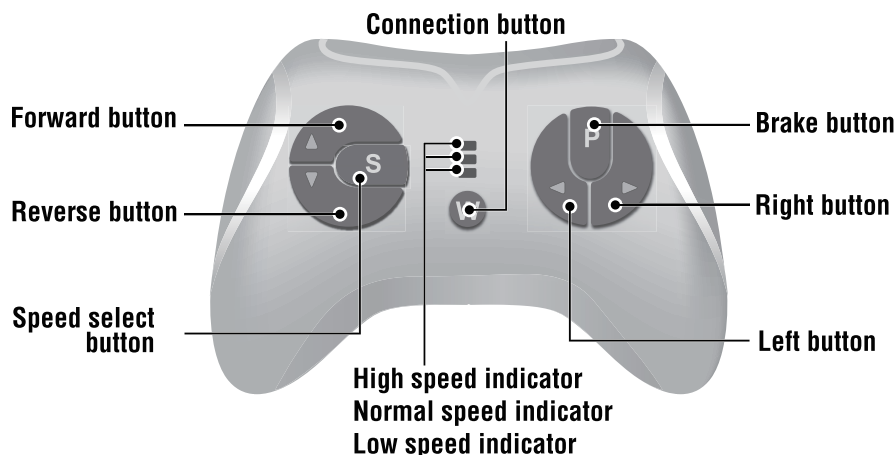

Attach the batteries of controller

Lift the battery compartment door on the back of the controller and insert two AAA(LR03) batteries.

HINT: Batteries not included.

1. Connection button (Build connection)

Long press the Connection buttons for 3 seconds, and the low speed indicator flashes. Then power on the vehicle, the low speed indicator goes to long bright, means the connection successful. If the low speed indicator no response, means the connection failed. Replace the batteries and retry.

2. Brake button

Press the button to stop the vehicle, press it again to release the brake.

3. Speed select button

The switch operates the vehicle to move in low, normal and high speed.

HINT: This switch won't work while your vehicle moves reverse.

NOTE:

- Leave the remote controller idling for about 10 seconds, it will shut down automatically.
- Rebuild connection when you replace the batteries of the remote controller.

**WARNING!**

ONLY AN ADULT CAN CHARGE AND RECHARGE THE BATTERY!

**WARNING!**

This product with Charging Protection: when charging, all functions will be cut off! Only an adult can charge and recharge the battery!

- The POWER SWITCH must be turned in OFF position when charging.
- Before the first use, you should charge the battery for 4-6 hours. Do not recharge the battery for more than 10 hours to avoid overheating the charger.
- When the vehicle begins to run slowly, recharge the battery.
- After each use or once a month minimum recharge time as 8 to 12 hours, less than 20 hours at most.
- Use the only rechargeable battery and charger supplied with your vehicle. NEVER substitute the battery or the charger with another brand. Using another battery or charger may cause a fire or explosion.
- Do not use the battery or charger for any other product.

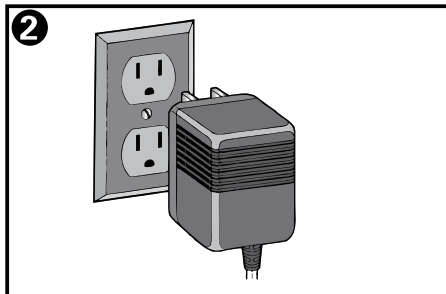
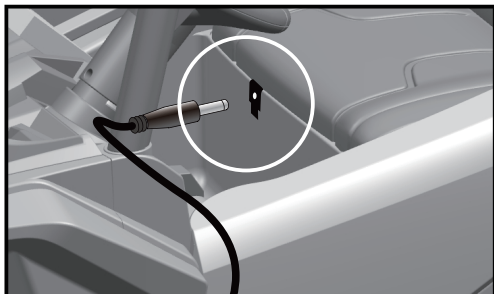

1. Plug the charger port into the input socket. (below the seat)
2. Plug the charger plug into a wall outlet. The battery will begin charging.

| Problem | Possible Cause | Solution |
|--|--|--|
| Vehicle does not run | Battery low on power | Recharge battery. |
| | Thermal fuse has tripped | Reset fuse, see <Fuse> |
| | Battery connector or wires are loose | Check that the battery connectors are firmly plugged into each other. If wires are loose around the motor contact our customer service please. |
| | Battery is dead | Replace battery, contact our customer service please. |
| | Electrical system is damaged | contact our customer service please. |
| | Motor is damaged | contact our customer service please. |
| Vehicle does not run very long | Battery is under charged | Check that the battery connectors are firmly plugged into each other when recharging |
| | Battery is old | Replace battery, contact our customer service please. |
| Vehicle runs sluggishly | Battery low on power | Recharge battery. contact our customer service please. |
| | Battery is old | Replace battery, contact our customer service please. |
| | Vehicle is overload | Reduce weight on vehicle. |
| | Vehicle is being used in harsh conditions | Avoid using vehicle in harsh conditions ,see <Safety>. |
| Vehicle needs a push to go forward | Poor contact of wires or Connectors | Check that the battery connectors are firmly plugged into each other. If wires are loose around the motor, contact our customer service please. |
| | “Dead Spot” on motor | A dead spot means the electric power is not being delivered to the terminal connection and the vehicle needs repair. contact our customer service please. |
| Difficult shifting from forward to reverse or vice-versa | Attempting to shift while the vehicle is in motion | Completely stop the vehicle and shift, see <Use Your New Vehicle> |
| Loud grinding or clicking noises coming from motor or gear box | Motor or gears are damaged | contact our customer service please. |
| Battery will not recharge | Battery connector or adapter connector is loose | Check that the battery connectors are firmly plugged into each other. |
| | Charger not plugged in | Check that the battery charger is plugged into a working wall outlet. |
| | Charger is not working | contact our customer service please. |
| Charger feels warm when recharging | This is normal and not a cause for concern | |

Completely read through this manual and the troubleshooting guide table before calling. If you still need help resolving the problem **contact our customer service please.**

- It is parents' responsibility to check main parts of the toy before using, must regularly examine for potential hazard, such as the battery, charge, cable or cord, plug, screws are fastening enclosure of other parts and that in the event of such damage, the toy must not be used until that damage had been properly removed.
- Make sure the plastic parts of the vehicle are not cracked or broken.
- Occasionally use a lightweight oil to lubricate moving parts such as wheels.
- Park the vehicle indoors or cover it with a tarp to protect it from wet weather.
- Keep the vehicle away from sources of heat, such as stoves and heaters. Plastic parts may melt.
- Recharge the battery after each use. Only an adult can handle the battery. Recharge the battery at least once a month when the vehicle is not being used.
- Do not wash the vehicle with a hose. Do not wash the vehicle with soap and water. Do not drive the vehicle in rainy or snowy weather. Water will damage the motor, electric system and battery.
- Clean the vehicle with a soft, dry cloth. To restore shine to plastic parts, use a non-wax furniture polish. Do not use car wax. Do not use abrasive cleaners.
- Do not drive the vehicle in loose dirt, sand or fine gravel which could damage the moving parts, motors or the electric system.
- When not using, all the electrical source should be turned off. Turn off the power switch and disconnect the battery connection.

Lights & Mp3 Fuse

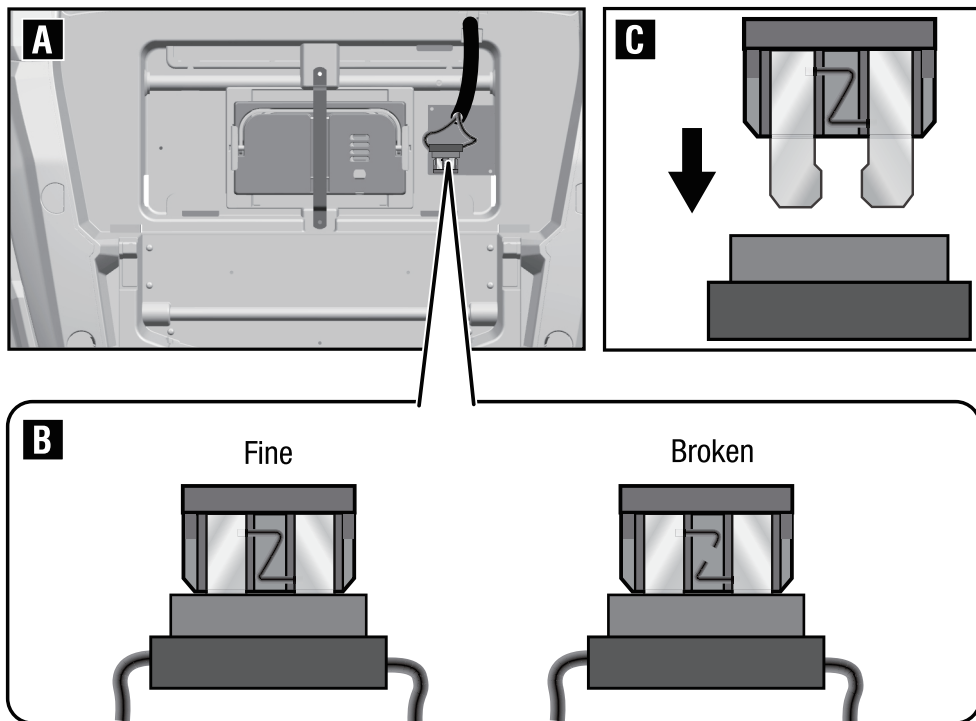

When the vehicle lights and Mp3 won't work, please check the fuse first and see whether it is broken. If the fuse is broken (fig B), please change with a new one (fig C), there is a spare fuse in the assembly package. The fuse is under the seat (fig A).

Battery Fuse

The battery features a thermal fuse with a reset fuse that will automatically trip and cut all power to the vehicle if the motor, electric system or battery is overloaded. The fuse will reset and power will be restored after the unit is turned OFF for 20 seconds and then turned ON again. If the thermal fuse trips repeatedly during normal use, the vehicle may need repair. Contact your distributor please.

To avoid losing power, follow these guidelines:

- Do not overload the vehicle.
- Do not tow anything behind the vehicle.
- Do not drive up steep slopes.
- Do not drive into fixed objects, which may cause the wheels to spin, causing the motor to overheat.
- Do not drive in very hot weather, components may overheat.
- Do not allow water or other liquids to come in contact with the battery or other electric components.
- Do not tamper with the electric system. Doing so may create a **short-circuit**, causing the fuse to trip.



- Your sealed lead-acid battery must be recycled or disposed of in an environmentally sound manner.
- Do not dispose of your lead-acid battery in a fire. The battery may explode or leak.
- Do not dispose of a lead-acid battery in your regular, household trash. The incineration, land filling or mixing of sealed lead-acid batteries with household trash is prohibited by law.

Our products are suitable for ASTM F963; GB6675; EN71 and EN62115 standard.

