



COSTWAY®

**Please give us a chance to make it right and do better !**

Contact our friendly customer service department for help first.  
Replacements for missing or damaged parts will be shipped ASAP !

US office: Fontana    UK office: Ipswich    AU office: Truganina

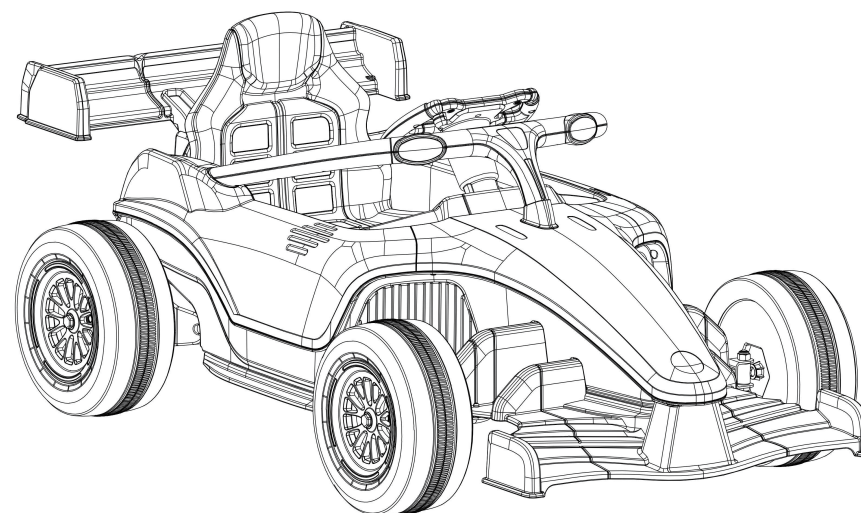

## Contact Us !

**Do NOT return this item.**

Contact our friendly customer service department for help first.



US: cs.us@costway.com  
UK: cs.uk@costway.com  
AU: cs.au@costway.com

## USER'S MANUAL

### 12V Ride On Race Car TQ10081US

THIS INSTRUCTION BOOKLET CONTAINS **IMPORTANT** SAFETY INFORMATION. PLEASE READ AND KEEP FOR FUTURE REFERENCE.



## Before You Start

Please read all instructions carefully and keep it for future reference.

### Warnings:

Attention! Use it with protective equipment.

Attention! Not use it in the traffic.

Attention! The product is not suitable for the children under 3 years.

### General Warnings:

- ⚠ The product must be installed and used under the supervision of an adult.
- ⚠ Read through each step carefully and follow the proper order.
- ⚠ Remove all packaging, separate and count all parts and hardware.
- ⚠ Please ensure that all parts are correctly installed, incorrect installation can lead to a danger.
- ⚠ We recommend that, where possible, all items are assembled near the area in which they will be placed in use, to avoid moving the product unnecessarily once assembled.
- ⚠ Ensure a secure surface during installation, and place the product always on a flat, steady and stable surface.
- ⚠ Please use this product with caution. The use of this product requires superb skills to avoid accidents to the user or others due to a fall or collision.
- ⚠ Please wear suitable protective equipment during use, e.g. protective helmet, gloves, knee pads, elbow pads etc.

(Weight Limit 66LBS)

This toy is unsuitable for children under 3 years.

WARNING: ASSEMBLY SHOULD BE DONE BY ADULTS



### WARNING!

- To reduce the risk of injury, adult supervision is required. Never use it in roadways, around motor vehicles, steep inclines or steps, swimming pools or other water bodies. Always wear shoes and helmets.
- **Limited to one person.**
- **TO PREVENT FIRE AND ELECTRIC SHOCK:**
  - Only use batteries and chargers provided or specified by the manufacturer. Using the wrong type of batteries or chargers could cause a fire or explosion.
  - **DO NOT** use the batteries or chargers on any other product. Or overheating, fire or explosion could occur.
  - **NEVER** modify the circuit system. Alterations could cause a shock, fire or explosion.
  - **DO NOT** pour any type of liquid on the batteries or other components.  
Explosive gases are produced during charging.
  - **DO NOT** charge near heat or flammable materials. Charge in a well-ventilated area ONLY. Charge in a dry area ONLY.
  - **DO NOT** open the batteries. Batteries contain lead and other toxic and corrosive materials.
  - **DO NOT** open the chargers. Exposed wiring and circuitry may cause electric shock



- **ONLY ADULTS** can handle or charge the batteries. NEVER allow child to handle or charge the batteries. Batteries are heavy and contain lead acid (electrolyte).
- **DO NOT** drop the batteries. Otherwise permanent damage or other serious injury to the batteries would occur.
- Before charging, check the wear and damage of the battery, charger and the connectors.
- **DO NOT** charge the battery if any damage to parts has occurred. Please contact the manufacture to replace the parts ONLY.
- **DO NOT** allow the battery to drain completely; charge the battery after each use or at least once a month if not used regularly.
- **DO NOT** charge battery upside down.
- Always make sure that the battery is fixed with the bracket. Otherwise, battery can fall out and even injure a child if the vehicle tips over. Risk of fire. Do not bypass.
- **If a battery leaks**, avoid it from contacting with the leaking acid and put the damaged battery into a plastic bag. Refer to information in "Disposal of Battery "for proper disposal.
- **If acid comes in contact with skin or eyes, rinse** with cool water for at least 15 minutes and call for a doctor.
- **If mistakenly take a large number of** acid, take a large amount of water, milk of magnesia or egg-white immediately. Call a physician.

## Specification Instruction

Name	Specification
Battery	12V7AH*1
Fuse	10A
Motor	12V*2
Applicable age	3-7 years old
Maximum load	66LBS
Charge time	Charge 8-12 hours
Charger	Input: AC120V 60Hz; Output: 12V 0.9A
Speed	1.2-3.1Mph

※ Above parameters are selected for customers, the specific parameters is based on the actual parameter.

## Parts Diagram

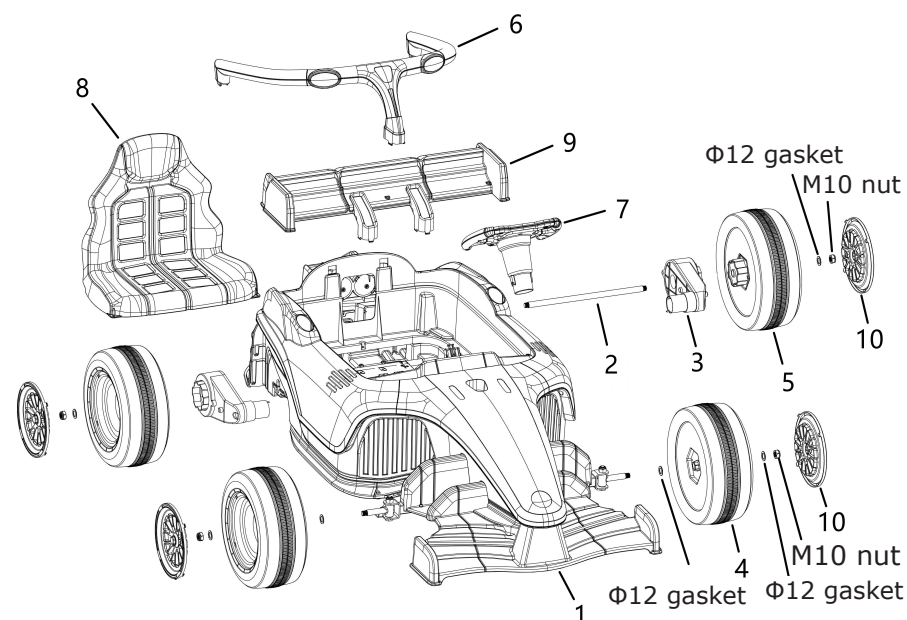

## Parts List

No.	Name of accessory	Qty.	Remark
1	Car body	1	
2	Rear axle	1	The rear axle has two M10 nuts on both ends
3	Driven motor	2	L:left; R:right
4	Front wheel	2	
5	Drive rear wheel	2	The rear wheel is equipped with driven ring
6	Bracket	1	
7	Steering wheel	1	
8	Seat	1	
9	Rear wing	1	
10	Wheel cover	4	
11	Remote controller	1	
12	Charger	1	
13	Instruction	1	
14	Part package	1	Φ12 gasket: 6 4*12 flat head screw: 2 M10 socket wrench: 2

The tool required for installation: cross screwdriver (not included)

**WARNING: ASSEMBLY SHOULD BE DONE BY ADULTS**



## Installation Instructions

### 1. Install front wheel and drive rear wheel

- ① Remove the M10 nuts on both sides of the front and rear axles for spare (4 pcs).
- ② Install a Φ12 gasket onto the front axle, then put in a front wheel, a Φ12 gasket, and a M10 nut on the front axle with a socket wrench.
- ③ Install the front wheel on the other side in the same way.
- ④ Put the rear axle through the car body, install a driven motor to the rear axle (motor L corresponds to the left side of the body, motor R corresponds to the right side of the body), then put in a drive rear wheel (with driving ring), a Φ12 gasket, and a M10 nut.
- ⑤ Install the drive rear wheel on the other side in the same way. (Tips: Tighten the nuts on both sides of the rear axle with two socket wrenches in opposite directions at the same time)
- ⑥ Finally, clip the wheel covers onto the four wheels.

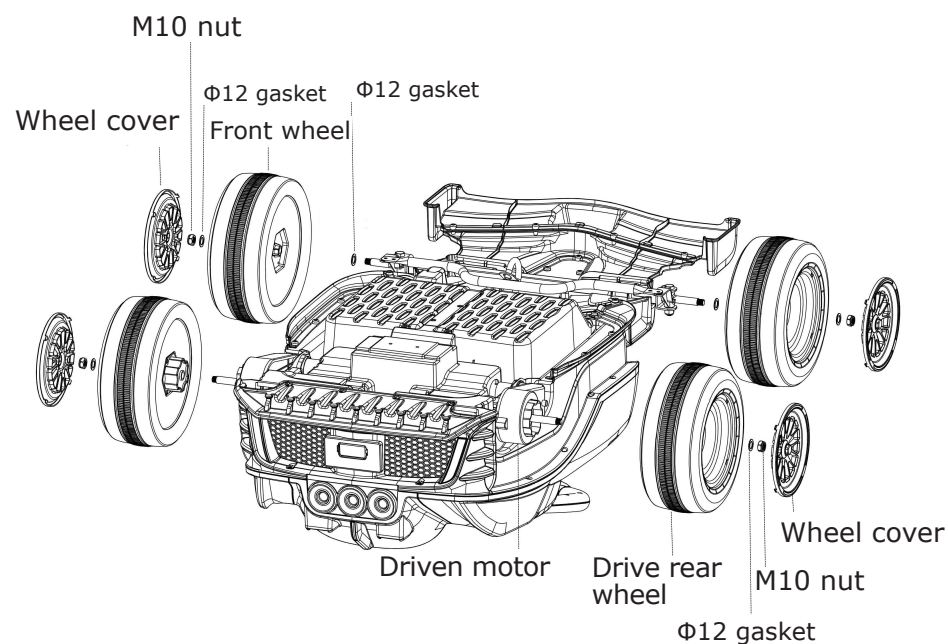

## 2. Install steering wheel

- ① Connect the music plug-in on the steering wheel to the music plug-in beside the steering wheel column, then put the connected plug-in into the hole on the lower side of the steering wheel.
- ② Align the steering wheel with the steer wheel column, and adjust the steering wheel clamping groove, then press hard to fix the steering wheel after alignment.

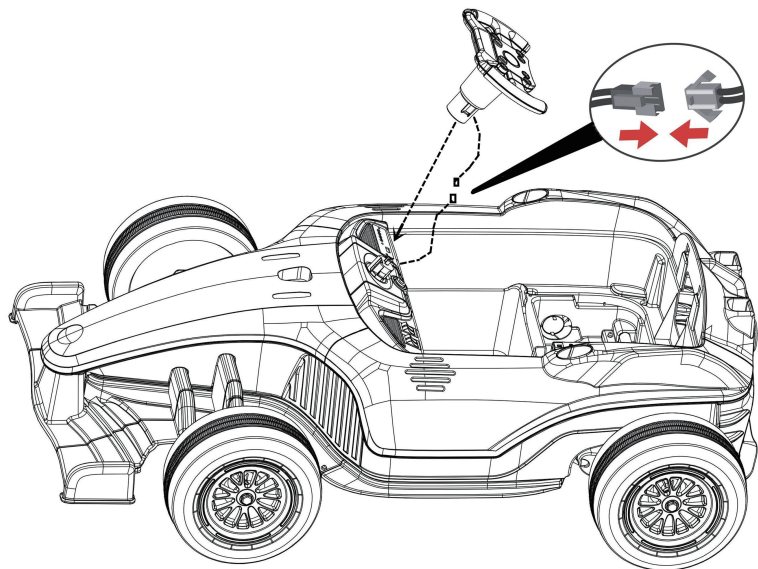

## 3. Install bracket

- ① Connect the lamp plug-in on the bracket to the lamp plug-in on the front engine.
- ② Adjust the buckle of the bracket to align with the body clamping groove and press hard to fix it.

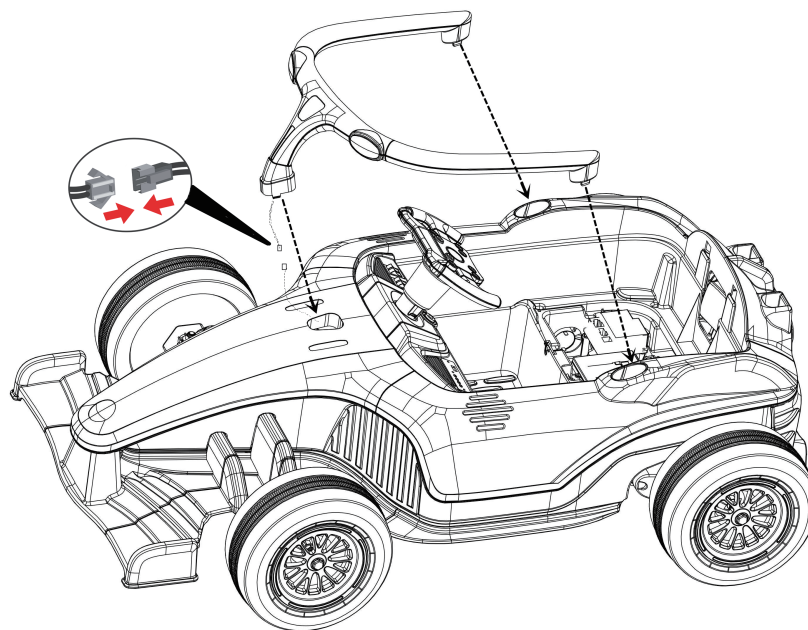



#### 4. Install rear wing

- ① Align the rear wing buckle with the clamping groove at the rear.

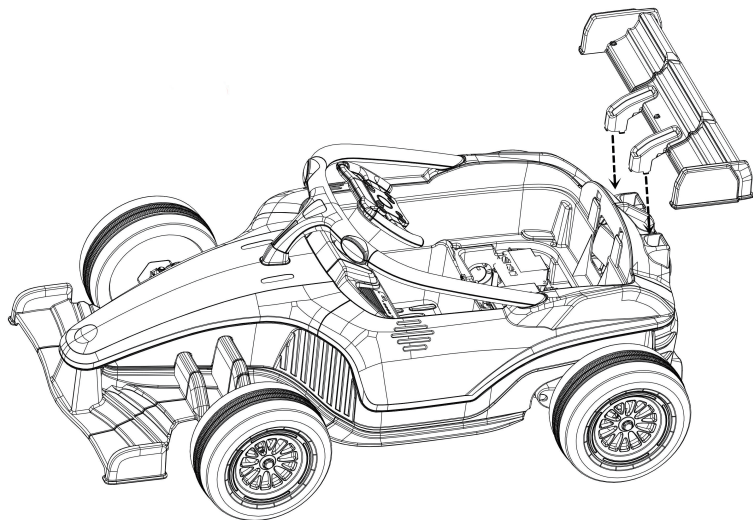

#### 5. Connect motor wires

- ① Connect the left and right motor plug-in under the seat.

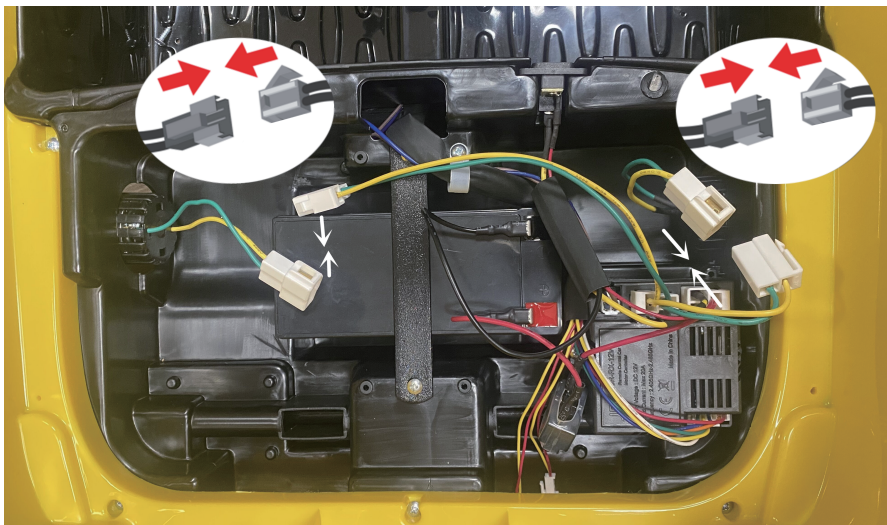

#### 6. Connect the battery

- ① At the bottom of the seat, take off the protecting bush (white plastic) of battery connector, plug in the wire (red line with red line, black line with black line), then storage battery is on.

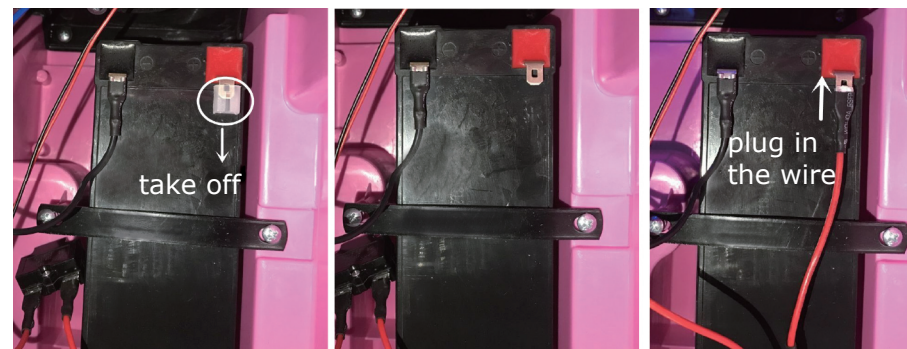

#### 7. Install seat

- ① Align the buckle on the back side of the seat with the body clamping groove, and then use two 4\*12 flat head screws to fix it to the body.

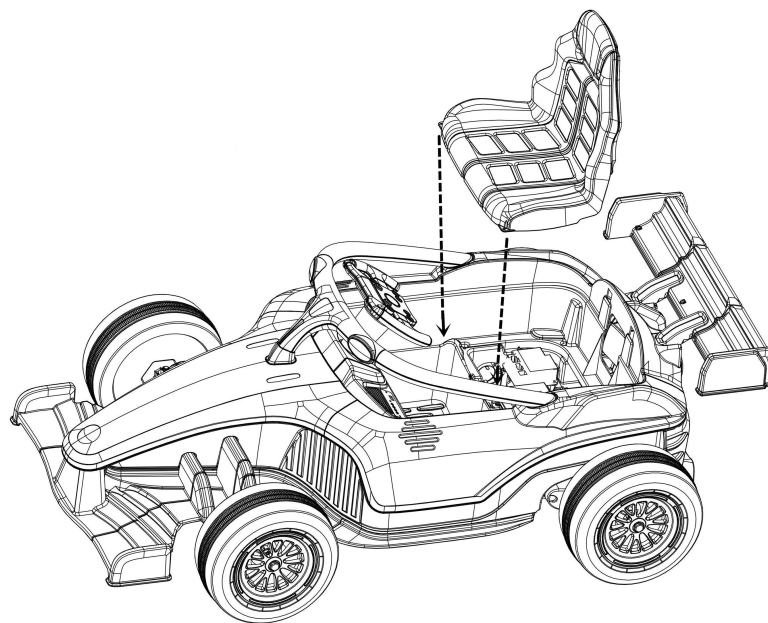

## 8. Battery charging

- ① Insert the charger plug into the charging hole (charging hole is located under the seat).
- ② Insert the charger into the power outlet.

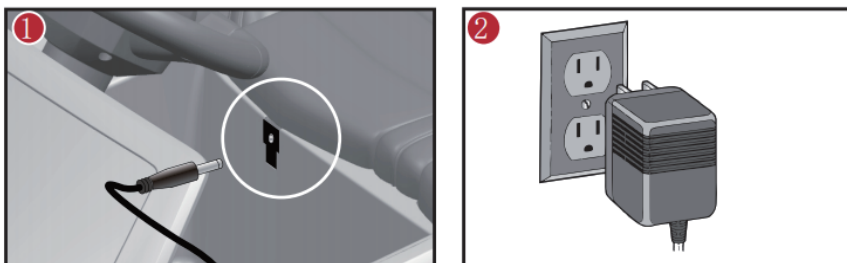

Please charge the storage battery in time when the battery is low. (Pay attention that the car can't be operated in the charging state. Charging should be supervised by the adult)

## 9. Function

- ① Power switch :After the driver is seated and fastened the seat belt, press the power switch and the car instrument light will light up and make a start sound (2-5 seconds).
- ② Using method of manual control/ remote control:
  - a. Press the switch in "Forward" (means forward push) and step on the pedal switch, the car moves forward;Release the pedal, the car stops. Press the switch in the "Stop" (means middle position), the car can not move; Press switch in "Back" (means backward pull) and step on the pedal switch, the car moves backward; Release the pedal, the car stops.
  - b. Remote control always takes precedence over manual control (i.e. remote control can be controlled manually).

- c. Press "P" key of remote control, the car brakes urgently (Now is manual control, the going forward function of remote control is invalid), press "P" key again to release the emergency brake.
- ③ Light switch: turns light on or off.
- ④ Fast and slow speed switch: switch speed mode, there are high speed and low speed.
- ⑤ MP3 player : It can play different music. Press "V+" for a long time to add volume. Press "V-" for a long time to lower volume.
- ⑥ Steering wheel: Steering wheel controls the left/right direction. It will make different sounds if you press different keys. Left is the horn button, press it to play the horn sound. Right is music button, press it to play music.

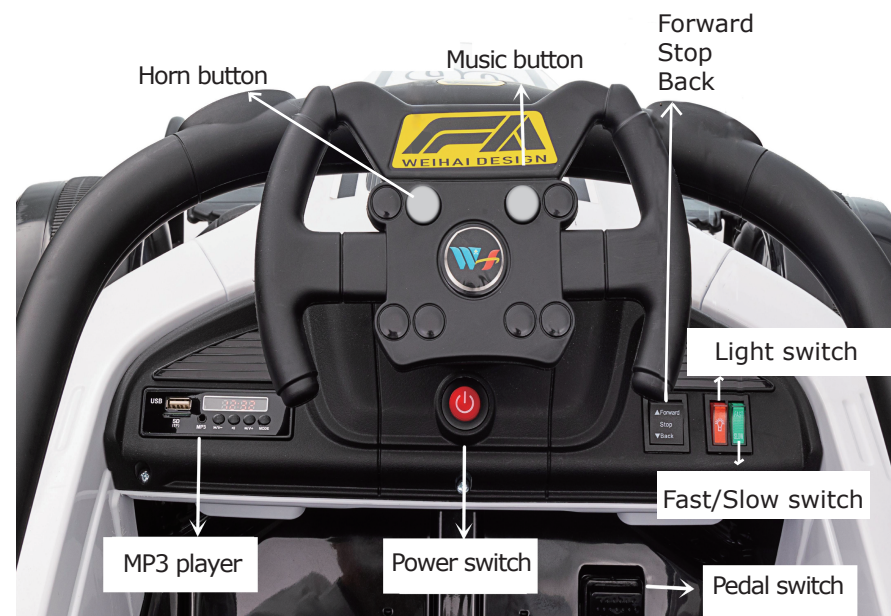

## 10. Installation and using of the storage battery of remote controller

① Install battery: open the battery cover of the remote controller, install two pieces of AAA (1.5V) (#7) dry batteries (not included), pay attention to the polarity of battery before installing. Put on the battery cover and use screw to fix.

Note:

Please follow the steps above to replace the battery. Only adults can replace it.

Please don't mix the new and old batteries or different batteries. Please take away the exhausted batteries from the toys in time.

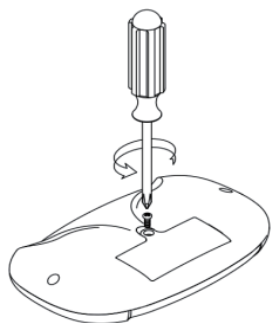

Loosen a screw

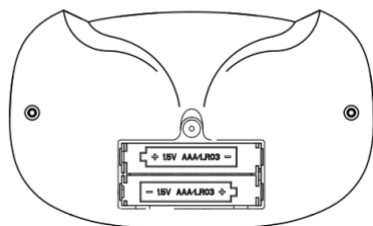

Load two AAA(1.5V) batteries

② Use method:

- Use for the first time needs to match code. This product has storage function. Replacing the battery or restart don't need to match code.
- Press "▲" & "▼" keys for 3 seconds at the same time to start matching code, The first LED flickers.
- Turn the car body power on now, The first LED lights up, Match code Succeeds.
- Press any key of the Remote controller for 10 seconds. If it doesn't run it will be stand-by, then press any key to wake it up.

e. Keys caption: "▲" Forward, "▼" Back, "◀" Left, "▶" Right, "S" Speed, "P" Brake. Press "S" key to accelerate (1 LED lit up is low speed, 2 LED lit up is medium speed, 3 LED lit up is high speed). Back the car only in low speed. Press "P" key to brake, All LED flicker.

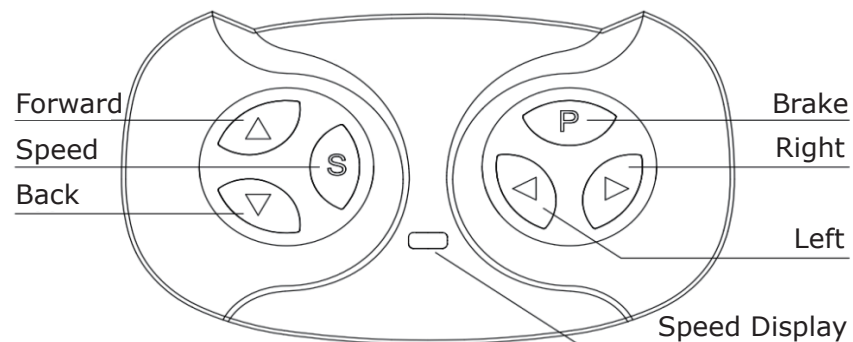

## WARNING!

- Not for children under 3 years old. Small parts. Choking hazard.
- The remote controller only can be used with adult's guidance.
- Load two AAA(1.5V) batteries (not included) according to the diagram.
- Non-rechargeable batteries are not to be recharged.
- Different types of batteries or new and used batteries are not to be mixed.
- Batteries are to be inserted with the correct polarity.
- Exhausted batteries are to be removed from the toy.
- The supply terminals are not to be short-circuited.
- Should take away the exhausted batteries from the toys, and handle well, prevent played by children to cause harm.
- The packaging must be retained since it contains important information.



### 11. Use of the recoverable type fuse

This car uses 10A recoverable type fuse, it will automatically shut off the power supply when the current exceeds 10A, and automatically recover after 5-10 seconds.



### **WARNING!**

#### **To make your baby drive safely, you must pay attention to the warnings below:**

1. Assembly and adjustment of products must be done by adult, please keep children far away from the motion parts.
2. Small parts in it, not suitable to be used by the children under 3 years old!
3. Must correctly use the safety belt when child sits on the car. Don't close to fire!
4. The children must use this product under the guidance of adults, and the guardian can't leave during the using process!
5. Don't allow the children to stand or play on the foot pedal (or in the electric car).
6. Charging the storage battery must be done by adults. Please charge at first before using this product!
7. To avoid hurting children, please make the package materials like plastic bag far away from the children! Asphyxiation hazard!
8. Strictly forbidden to use any accessories which are not provided by manufacturer.
9. Don't use charger as toy.
10. The maximum load of this car is 66LBS. Do not overload.
11. The suitable age scope of this car: 3-7 years old.
12. The product can't connect to power supply which exceeds the recommended power.
13. The toy (complete car) can't be operated during charging.

## **Notices for Charging**

1. When using the electric car for the first time, the user must guarantee the positive and negative pole of power supply have already correctly connected (the storage battery installed in the engine plate at the front of car, pay attention to different positive/negative poles when connecting, needs red to red, black to black). Must guarantee that storage battery is charged for 8 hours, otherwise, it will perpetually damage the storage battery which can't recover.
2. Plug the DC plug of charger into the charge hole at first, then plug the charger into power outlet.
3. Must charge in time after using about one hour each time, the normal charge time is from 8 to 12 hours, and each charge time can not exceed 20 hours.
4. During the charging process, it is normal for the charger temperature to be lower than 140°F, and normal for the storage battery temperature to be lower than 113°F.
5. If there is stagnant water in the connect/plug part, it can't charge, otherwise it may cause short circuit.
6. This electric car must use the charger and storage battery configured with this car to avoid damaging the charger and storage battery or electric circuit.
7. Charge at least once a month. If don't use the electric car for a long time, please plug out the connect/plug part of storage battery.



## Use Notices

1. Please check whether all parts are installed in place, tightly connect before use.
2. Can't use in the dangerous area like streets, roads, slopes and ditches, etc.
3. Please don't use it on smooth ground, for example marbles, ground tiles, etc.
4. Don't shift forward/backward switches when the electric car is running. Please note that don't allow children to stand on the seat.
5. Don't change the circuit and additional electrical devices of this car.
6. The remote controller and electric car can't be used in rain or water, don't pour the water or other liquid on the car or other places to make it soaking and make it far away from the fire source to avoid causing circuit damage.
7. Electrical car stops running when it touches hinder, please run after leaving the hinder.
8. Don't use in room to avoid cracking up the furniture or even making the children tumble.
9. When the battery of the remote control is low, the whole car can only be remote controlled forward, not the left and right directions, the remote control distance is shortened and vibration occurs, please replace the battery in time.
10. Please turn off the power supply switch when not using it, please plug out the connect/plug part of storage battery.
11. This product limits to one people, can't be overloaded, the maximum load is 66LBS.

Note: the product picture, functions and introductions in this manual are for reference only, project to the physical entity.

## Maintenance

1. To guarantee that your baby will not be hurt unexpectedly, please frequently check and maintain this car.
2. Check if package assemblies are complete before assembling, contact us immediately if there is a lack.
3. Periodically check whether screws are loose or components are damaged.
4. Please frequently check whether it is intact when each part is installed or used.
5. When disassembling, please operate according to the installation instructions carefully to avoid causing unnecessary damage.
6. Please check the product and charger regularly, check whether the wiring, plug, outer shell and other parts are damaged. Stop using immediately if any damage is found, until it is repaired well.
7. Please do cleaning for this product at a regular time, fill lubricating oil into rotating parts. Be careful not to damage the electric elements, don't use water to wash, use dry cloth to wipe.